

## Description

The SMB name derives from SubMiniature B (the second subminiature design). Developed in the 1960's, this sub miniature interface has snap-on coupling. Amphenol's SMB connectors conform to the requirements of MIL-C-39012, and the interface is in compliance with MIL-STD-348. Available in 50  $\Omega$  and 75  $\Omega$ , the SMB provides broadband capability through 4 GHz with a snap-on connector design and utilizes die cast components on non-critical areas to provide a low-cost solution.

The SMC name derives from SubMiniature C (the third subminiature design). The SMC design was developed in the 1960's. SMC has threaded coupling with 10-32 threads. Available in 50  $\Omega$  impedance, the SMC Series utilizes die cast components on non-critical areas to provide a low cost solution.

## Features/Benefits

### SMB

- Broadband performance with low reflection DC to 4 GHz provides low cost connector combined with high quality.
- Quick connect/disconnect snap-on mating reduces installation time.
- Various plating options in nickel, gold, and tin. Selective plating provides corrosion resistance finish as well as good solderability characteristics.
- SMB PCB slide-on plug and jack allows board-to-board mounting with a low insertion force. This is ideal for mating a high number of connectors on a pair of PCB's.

### SMC

- Broadband performance with low reflection DC to 10 GHz
- Conforms to the interface dimensions of MIL-STD-348
- 10-32 screw-on (threaded) coupling mechanism allows performance to 10GHz with low reflection.
- Right Angle connectors available in one piece construction

## Applications

### SMB

- Automotive
- Base Stations
- Cable Assemblies
- Components
- Instrumentation
- PC/LAN
- Process Controls
- Radio Boards
- Surge Protection
- Telecom
- Test and Measurement
- Video Systems

### SMC

- Antennas
- Automotive (GPS)
- Base Stations
- Cable Assemblies
- Instrumentation
- Video Systems
- Process Controls
- Radio Boards
- Telecom
- Test and Measurement

## 50 Ω SMB Specifications

**Electrical**

|                                   |  |
|-----------------------------------|--|
| Impedance                         | 50 Ω   |
| Frequency Range                   | 0-4 GHz with low reflection; usable to 10.0 GHz  |
| Voltage Rating for RG-188/U Cable | 335 volts at sea level and 85 volts at 70,000 feet   |
| Dielectric Withstanding Voltage   | RG-196: 750 VRMS; RG-188: 1,000 VRMS   |
| VSWR                              | Straight connector, RG-196/U: 1.30 + .04 f (GHz)<br>Right angle connector, RG-196/U: 1.45 + .06 f (GHz)<br>Straight connector, RG-188/U: 1.25 + .04 f (GHz)<br>Right angle connector, RG-188/U: 1.35 + .04 f (GHz) |
| Contact Resistance                | Center contact: 6.0 mΩ initial, 8.0 after environmental;<br>Outer contact: 1.0 mΩ initial, 1.5 after environmental;<br>Braid to body: 1.0 mΩ initial, after environmental N/A                                      |
| Insulation Resistance             | 1,000 MΩ minimum   |
| Insertion Loss                    | Straight connector: 0.30 dB @ 1.5 GHz<br>Right angle connector: 0.60 dB @ 1.5 GHz  |
| RF Leakage                        | -55 dB minimum @ 2-3 GHz   |

**Mechanical**

|                                  |   |
|----------------------------------|---|
| Mating                           | Snap-on coupling per MIL-STD-348  |
| Braid/Jacket Cable Affixment     | Hex crimp   |
| Center Conductor Cable Affixment | Solder  |
| Contact Captivation              | All types unless noted otherwise  |
| Cable Retention                  | Equal to breaking strength of cable employed  |
| Engagement Forces                | Engagement: 14 lbs maximum<br>Disengagement: 2 lbs minimum<br>After 500 matings, 14 lbs maximum engagement and disengagement<br>500 mating cycles minimum |
| Connector Durability             |   |

**Material**

|                       |   |
|-----------------------|---|
| Center Contact        | Female: beryllium copper, gold-plated<br>Male: brass or beryllium copper, gold-plated |
| Outer Contact Plating | Nickel or gold plating as indicated   |
| Body                  | Brass per QQB-626, or zinc per ASTM B86-71  |
| Body Plating          | Nickel or gold plating as indicated   |
| Insulator             | TFE   |
| Crimp Ferrule         | Annealed copper alloy   |

**Environmental**

|                   |  |
|-------------------|--|
| Temperature Range | -65°C to + 165°C   |
| Thermal Shock     | MIL-STD-202 method 107, test condition B (except high temperatures @ 200°C)                  |
| Shock             | MIL-STD-202 method 202, method 13, snap-on, test condition B; 75 G's @ 6 milliseconds ½ sine |
| Vibration         | MIL-STD-202 method 204, snap-on, test condition B; (15 G's)                                  |
| Corrosion         | MIL-STD-202 method 101, test condition B. 5% salt solution                                   |

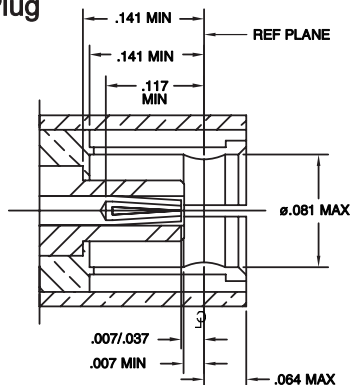
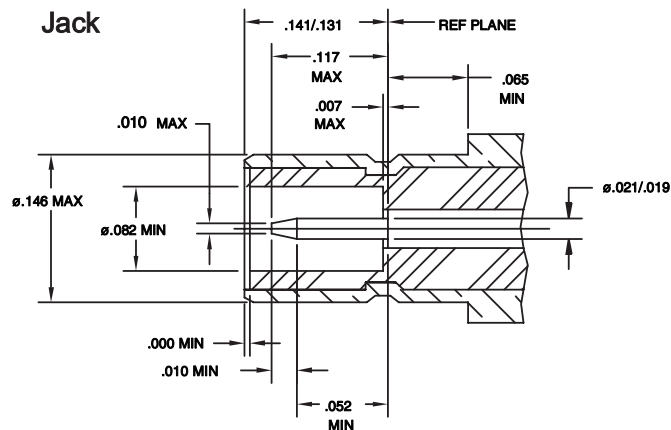
**Plug****Jack**

**SMC Specifications**

**Electrical**

|  |  |
|--|--|
| Impedance                              | 50 Ω   |
| Frequency Range                        | 0-4 GHz with low reflection; usable to 10.0 GHz  |
| Voltage Rating                         | Sea level: 335 volts<br>70,000 feet: 85 volts  |
| Dielectric Withstanding Voltage (max). | 750 VRMS RG-196<br>1000 VRMS for RG-188 type   |
| VSWR                                   | RG-196/U series:<br>Straight connector, 1.30 + .04 f (GHz)<br>Right angle connector, 1.45 + .06 f (GHz)<br>RG-188/U series:<br>Straight connector, 1.25 + .04 f (GHz)<br>Right angle connector, 1.35 + .06 f (GHz) |
| Contact Resistance                     | Center contact:<br>Initial, 6.0 mΩ<br>After environmental, 8.0 mΩ<br>Outer contact:<br>Initial, 1.0 mΩ<br>After environmental, 1.5 Ω<br>Braid to body:<br>Initial, 1.0 mΩ<br>After environmental, N/A              |
| Insulation Resistance                  | 1,000 MΩ minimum   |
| Insertion Loss                         | Straight connectors:<br>0.30 dB @ 1.5 GHz<br>Right angle connectors:<br>0.60 dB @ 1.5 GHz  |
| RF Leakage                             | -55 dB minimum @ 2-3 GHz   |

**Mechanical**

|                 |  |
|-----------------|--|
| Bodies          | Brass per QQB-626 or zinc per ASTM B86-71, as specified, nickel or gold plated as listed |
| Center Contacts | Female: beryllium copper, gold plated.<br>Male: brass or beryllium copper, gold plated   |
| Outer Contact   | Nickel or gold plated as listed  |
| Crimp Ferrules  | Annealed copper alloys   |
| Insulator       | TFE  |

**Environmental**

|                   |                                    |
|-------------------|------------------------------------|
| Temperature Range | -65°C to + 165°C                   |
| Thermal Shock     | MIL-STD-202 method 107 condition C |
| Vibration         | MIL-STD-202 method 204 condition D |
| Shock             | MIL-STD-202 method 213 condition C |
| Corrosion         | MIL-STD-202 method 101 condition B |

Plug

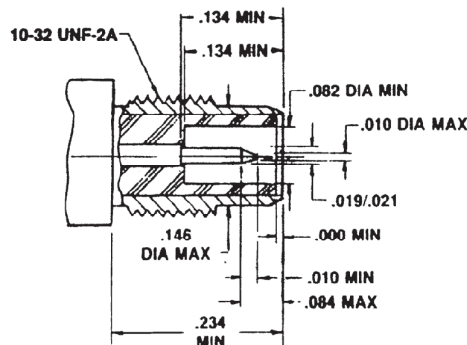

Jack

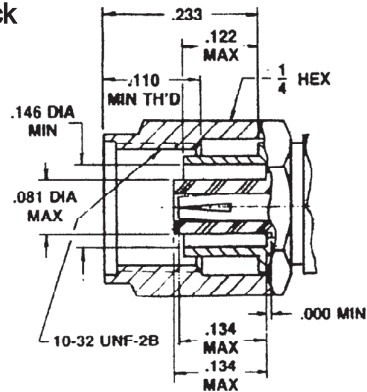

## SMB/SMC Coaxial Connectors

## Straight Crimp Plug - Standard and Miniature Cable

| P.N.                                  | Cable Group | Pit.   | Ins.   | Imp. | Crimp Tool |
|---------------------------------------|-------------|--------|--------|------|------------|
| SMB6121A2-NT30G-1-50                  | 01          | Nickel | Teflon | 50   | 3 or 4     |
| SMB6121A2-3GT30G-1-50                 | 01          | Gold   | Teflon | 50   | 3 or 4     |
| SMB6121A2-NT30G-1A-50                 | 01A         | Nickel | Teflon | 50   | 3 or 4     |
| SMB6121A2-3GT30G-1A-50                | 01A         | Gold   | Teflon | 50   | 3 or 4     |
| SMB6121A1-NT30G-5-50                  | 05          | Nickel | Teflon | 50   | 1 or 2     |
| SMB6121A1-3GT30G-5-50                 | 05A         | Gold   | Teflon | 50   | 1 or 2     |
| SMB6121A1-NT30G-5A-50                 | 05A         | Nickel | Teflon | 50   | 2          |
| SMB6121A1-3GT30G-5A-50                | 05A         | Gold   | Teflon | 50   | 2          |
| SMB6121A1-NT30G-14-50                 | 14          | Nickel | Teflon | 50   | 1 or 2     |
| SMB6121A1-3GT30G-14-50                | 14          | Gold   | Teflon | 50   | 1 or 2     |
| SMB6121AA-3GT30G-19-75<br>Mini 75 Ohm | 19          | Gold   | Teflon | 75   | 3          |
| <b>SMC Connectors</b>                 |             |        |        |      |            |
| SMC6121A2-3GT30G-1-50                 | 01          | Gold   | Teflon | 50   | 3 or 4     |
| SMC6121A1-NT30G-5-50                  | 05          | Nickel | Teflon | 50   | 1 or 2     |
| SMC6121A1-3GT30G-5-50                 | 05          | Gold   | Teflon | 50   | 1 or 2     |
| SMC6121A1-3GT30G-5A-50                | 05A         | Gold   | Teflon | 50   | 2          |

Note: Female center contact

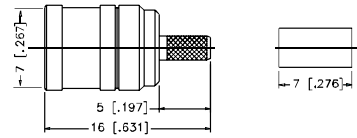

Assembly Instruction J - page 236

## Straight Solder Plug - Semi-Rigid Cable

| P.N.                   | Cable Group | Pit. | Ins.   | Imp. | Crimp Tool |
|------------------------|-------------|------|--------|------|------------|
| SMB6181A1-3GT30G-11-50 | 11          | Gold | Teflon | 50   | N/A        |
| SMB6181A1-3GT30G-13-50 | 13          | Gold | Teflon | 50   | N/A        |

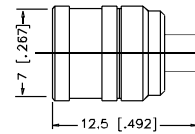
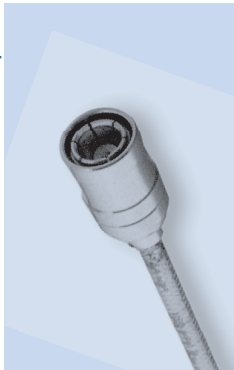

SMB6181A1-3GT30G-13-50

Note: Female center contact

Assembly Instruction C - page 229  
Assembly Instruction E - page 231

## Right Angle crimp Plug - Snap Lock - Flexible Cable

| P.N.                      | Cable Group | Pit.   | Ins.   | Imp. | Crimp Tool |
|---------------------------|-------------|--------|--------|------|------------|
| SMB6112L1-N/3GT30G-16-50  | 16          | Nickel | Teflon | 50   | 3          |
| SMB6112L1-N/3GT30G-16A-50 | 16A         | Nickel | Teflon | 50   | 3          |

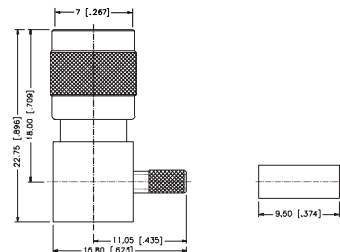

Assembly Instruction I - page 235

## Straight Crimp Jack - Standard and Miniature Cable

| P.N.                   | Cable Group | Pit.   | Ins.   | Imp. | Crimp Tool |
|------------------------|-------------|--------|--------|------|------------|
| SMB1121A1-NT30G-5-50   | 05          | Nickel | Teflon | 50   | 1 or 2     |
| SMB1121A1-3GT30G-5-50  | 05          | Gold   | Teflon | 50   | 1 or 2     |
| SMB1121A1-NT30G-5A-50  | 05A         | Nickel | Teflon | 50   | 2          |
| SMB1121A1-3GT30G-5A-50 | 05A         | Gold   | Teflon | 50   | 2          |
| SMB1121A1-NT30G-14-50  | 14          | Nickel | Teflon | 50   | 1 or 2     |
| SMB1121A1-3GT30G-14-50 | 14          | Gold   | Teflon | 50   | 1 or 2     |
| <b>SMC Connectors</b>  |             |        |        |      |            |
| SMC1121G1-NT30G-5-50   | 05          | Nickel | Teflon | 50   | 1 or 2     |
| SMC1121G1-3GT30G-5-50  | 05          | Gold   | Teflon | 50   | 1 or 2     |

Note: Male center contact

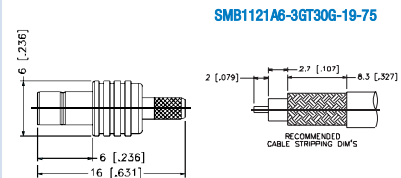
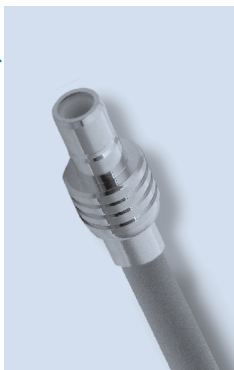

SMB1121A6-3GT30G-19-75

Assembly Instruction J - page 236

**Straight Solder Jack - Semi-Rigid Cable**

| P.N.                   | Cable Group | Plt. | Ins.   | Imp. | Crimp Tool |
|------------------------|-------------|------|--------|------|------------|
| SMB1181A1-3GT30G-11-50 | 11          | Gold | Teflon | 50   | N/A        |
| SMB1181A1-3GT30G-13-50 | 13          | Gold | Teflon | 50   | N/A        |

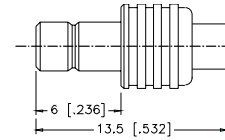

Note: Male center contact

Assembly Instruction E - page 231  
Assembly Instruction C - page 229

**Right Angle Crimp Plug - Standard and Miniature Cable**

| P.N.                   | Cable Group | Plt.   | Ins.   | Imp. | Crimp Tool |
|------------------------|-------------|--------|--------|------|------------|
| SMB6112A1-NT30G-1-50   | 01          | Nickel | Teflon | 50   | 3 or 4     |
| SMB6112A1-NT30G-1-50   | 01          | Gold   | Teflon | 50   | 3 or 4     |
| SMB6112D1-NT30G-5-50   | 05          | Nickel | Teflon | 50   | 1 or 2     |
| SMB6112D1-3GT30G-5-50  | 05          | Gold   | Teflon | 50   | 1 or 2     |
| SMB6112A1-NT30G-5A-50  | 05A         | Nickel | Teflon | 50   | 2          |
| SMB6112A1-3GT30G-5A-50 | 05A         | Gold   | Teflon | 50   | 2          |
| SMB6112A1-NT30G-14-50  | 14          | Nickel | Teflon | 50   | 1 or 2     |
| SMB6112A1-3GT30G-14-50 | 14          | Gold   | Teflon | 50   | 1 or 2     |
| SMB6112AG-3GT30G-19-75 | 19          | Gold   | Teflon | 75   | 3          |
| Mini 75 Ohm            |             |        |        |      |            |
| <b>SMC Connectors</b>  |             |        |        |      |            |
| SMC6112A1-NT30G-5-50   | 05          | Nickel | Teflon | 50   | 1 or 2     |
| SMC6112A1-3GT30G-5-50  | 05          | Gold   | Teflon | 50   | 1 or 2     |

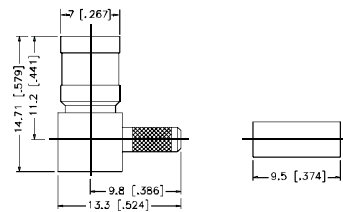

Note: Female center contact

Assembly Instruction I - page 235

**Right Angle Solder Plug - Semi-Rigid Cable**

| P.N.                   | Cable Group | Plt. | Ins.   | Imp. | Crimp Tool |
|------------------------|-------------|------|--------|------|------------|
| SMB6182A1-3GT30G-11-50 | 11          | Gold | Teflon | 50   | N/A        |
| SMB6182A1-3GT30G-13-50 | 13          | Gold | Teflon | 50   | N/A        |

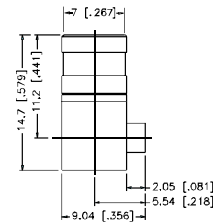
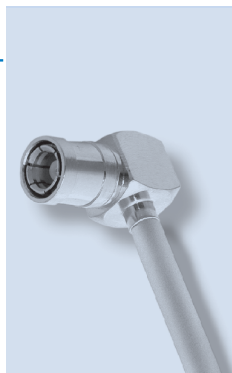

Note: Female center contact

Assembly Instruction F - page 232

**Bulkhead Feedthrough Crimp Jack - Standard and Miniature cable**

| P.N.                     | Cable Group | Plt.   | Ins.   | Imp. | Crimp Tool |
|--------------------------|-------------|--------|--------|------|------------|
| SMB1421A1-002-NT30G-5-50 | 05          | Nickel | Teflon | 50   | 1 or 2     |
| SMB1421A1-NT30G-3-50     | 03          | Nickel | Teflon | 50   | 1 or 2     |
| SMB1421A1-3GT30G-5-50    | 05          | Gold   | Teflon | 50   | 1 or 2     |
| SMB1421A1-NT30G-5-50     | 05          | Nickel | Teflon | 50   | 1 or 2     |
| SMB1421A1-3GT30G-5A-50   | 05A         | Gold   | Teflon | 50   | 2          |
| SMB1421A1-NT30G-14-50    | 14          | Nickel | Teflon | 50   | 1 or 2     |
| SMB1421A1-3GT30G-14-50   | 14          | Gold   | Teflon | 50   | 1 or 2     |
| <b>SMC Connectors</b>    |             |        |        |      |            |
| SMC1421G1-NT30G-5-50     | 05          | Nickel | Teflon | 50   | 1 or 2     |
| SMC1421A1-3GT30G-5-50    | 05          | Gold   | Teflon | 50   | 1 or 2     |

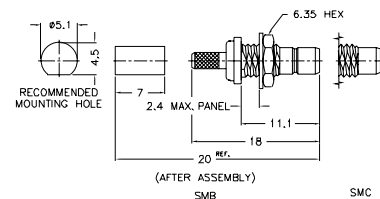

Note: Male center contact

Assembly Instruction J - page 236

### Right Angle Crimp Jack - Miniature Cable

| P.N.                  | Cable Group | Pit.   | Ins.   | Imp. | Crimp Tool |
|-----------------------|-------------|--------|--------|------|------------|
| SMB1112A1-NT30G-5-50  | 05          | Nickel | Teflon | 50   | 1 or 2     |
| SMB1112A1-3GT30G-5-50 | 05          | Gold   | Teflon | 50   | 1 or 2     |

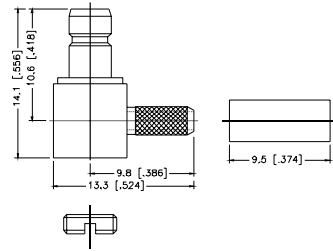

Note: Male center contact

Assembly Instruction I - page 235

### Right Angle Bulkhead Crimp Jack - Standard and Miniature Cable

| P.N.                      | Cable Group | Pit.   | Ins.   | Imp. | Crimp Tool |
|---------------------------|-------------|--------|--------|------|------------|
| SMB1412A1-NT30G-1-50      | 01          | Nickel | Teflon | 50   | 3 or 4     |
| SMB1412A1-3GT30G-1-50     | 01          | Gold   | Teflon | 50   | 3 or 4     |
| SMB1412A2-3GT30G-1A-50    | 01A         | Gold   | Teflon | 50   | 3 or 4     |
| SMB1412A1-001-NT30G-5-50  | 05          | Nickel | Teflon | 50   | 1 or 2     |
| SMB1412A1-001-3GT30G-5-50 | 05          | Gold   | Teflon | 50   | 1 or 2     |
| SMB1412A1-NT30G-5A-50     | 05A         | Nickel | Teflon | 50   | 2          |
| SMB1412A1-3GT30G-5A-50    | 05A         | Gold   | Teflon | 50   | 2          |
| SMB1412A1-3GT30G-14-50    | 14          | Gold   | Teflon | 50   | 1 or 2     |

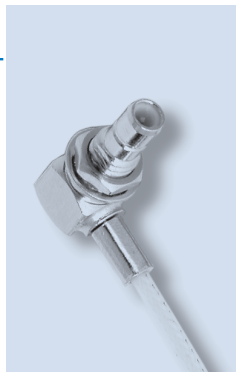

SMB1412A1-NT30G-1-50, SMB1412A1-3GT30G-1-50, SMB1412A2-NT30G-1A-50, SMB1412A2-NT30G-1A-50

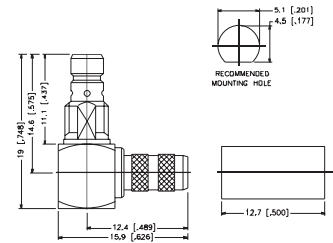

Note: Male center contact

Assembly Instruction I - page 235

### Right Angle Solder Jack - Miniature Semi-Rigid Cable

| P.N.                   | Cable Group | Pit. | Ins.   | Imp. | Crimp Tool |
|------------------------|-------------|------|--------|------|------------|
| SMB1112A1-3GT30G-13-50 | 13          | Gold | Teflon | 50   | N/A        |

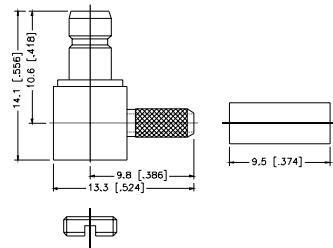

Note: Male center contact

Assembly Instruction F - page 232

### Straight Clamp plug - Miniature Cable

| P.N.                  | Cable Group | Pit.   | Ins.   | Imp. | Crimp Tool |
|-----------------------|-------------|--------|--------|------|------------|
| SMB6141C1-NT30G-5-50  | 05          | Nickel | Teflon | 50   |            |
| SMB6141C1-3GT30G-5-50 | 05          | Gold   | Teflon | 50   |            |

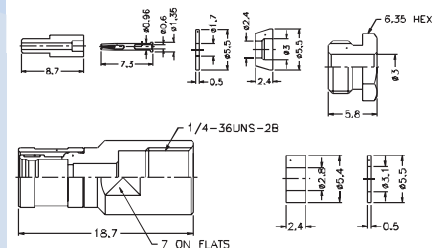
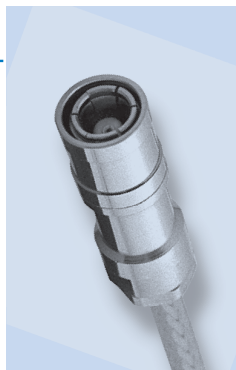

Note: Female center contact

Assembly Instruction M - page 239



**Straight Plug for P.C. Board**

| P.N.                                    | Cable Group | Pit.   | Ins.   | Imp. | Crimp Tool |
|---|-------------|--------|--------|------|------------|
| SMB6251B1-NT30G-50                      | N/A         | Nickel | Teflon | 50   | N/A        |
| SMB6251B1-3GT30G-50                     | N/A         | Gold   | Teflon | 50   | N/A        |
| SMB6251B4-001-NT30G-50<br>Surface Mount | N/A         | Gold   | Teflon | 50   | N/A        |
| <b>SMC Connectors</b>                   |             |        |        |      |            |
| SMC6251B1-NT30G-50                      | N/A         | Nickel | Teflon | 50   | N/A        |
| SMC6251B1-3GT30G-50                     | N/A         | Gold   | Teflon | 50   | N/A        |

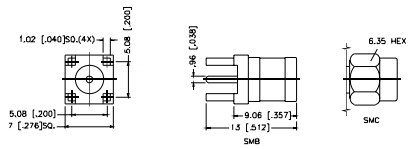
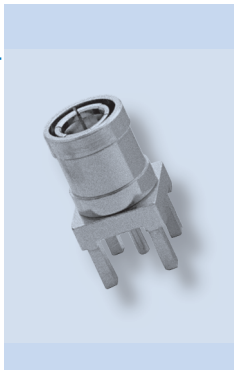

**Straight Jack for P.C. Board**

| P.N.   | Cable Group | Pit.   | Ins.   | Imp. | Crimp Tool |
|--|-------------|--------|--------|------|------------|
| SMB1251B1-NT30G-50                                       | N/A         | Nickel | Teflon | 50   | N/A        |
| SMB1251B1-3GT30G-50                                      | N/A         | Gold   | Teflon | 50   | N/A        |
| SMB1251A1-3GT30G-50<br>Low cost version                  | N/A         | Gold   | Teflon | 50   | N/A        |
| SMB1251B4-3GT30G-50                                      | N/A         | Gold   | Teflon | 50   | N/A        |
| SMB1251B4-001-3GT30G-50<br>Surface Mount                 | N/A         | Gold   | Teflon | 50   | N/A        |
| SMB1251A4-3GT30G-50<br>Surface Mount<br>Low cost version | N/A         | Gold   | Teflon | 50   | N/A        |
| SMS1251B1-3GT30G-50<br>Slide-On                          | N/A         | Gold   | Teflon | 50   | N/A        |
| <b>SMC connectors</b>                                    |             |        |        |      |            |
| SMC1251B1-NT30G-50                                       | N/A         | Nickel | Teflon | 50   | N/A        |
| SMC1251B1-3GT30G-50                                      | N/A         | Gold   | Teflon | 50   | N/A        |

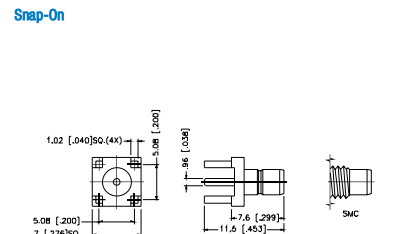
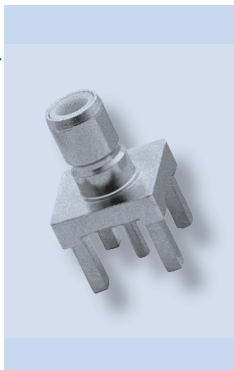

Snap-On

Note: Male center contact  
Slide-On

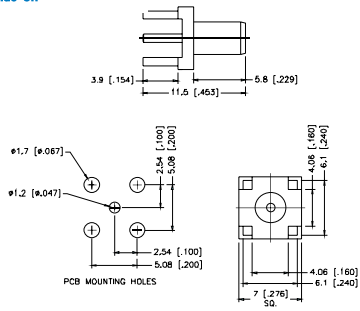

Low cost version

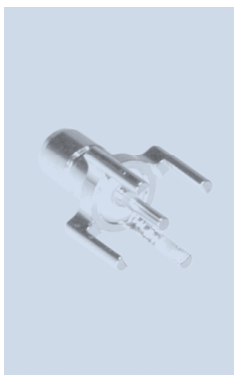

Low cost version

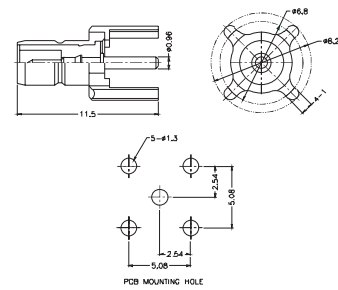

SMB1251A4-3GT30G-50

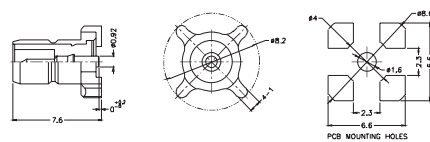

Low cost version



**Straight Bulkhead Jack for P.C. Board**

| P.N.                               | Cable Group | Pit.   | Ins.   | Imp. | Crimp Tool |
|------------------------------------|-------------|--------|--------|------|------------|
| SMB1451B1-004-NT30G-50<br>Slide-On | N/A         | Nickel | Teflon | 50   | N/A        |
| SMB1451B1-003-NT30G-50             | N/A         | Nickel | Teflon | 50   | N/A        |
| SMB1451B1-003-3GT30G-50            | N/A         | Gold   | Teflon | 50   | N/A        |

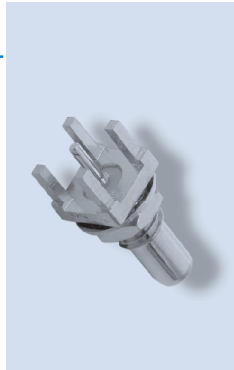

Assembly Instruction B - page 228

Note: Male center contact

**Snap-On**

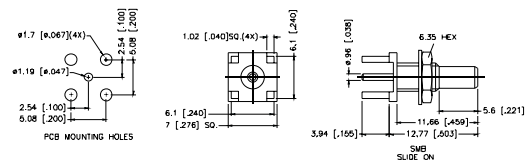

**Slide-On**

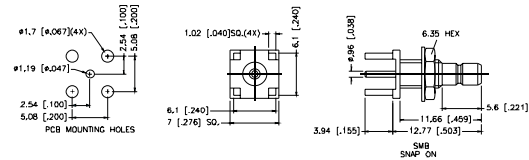

**Right Angle Plug for P.C. Board**

| P.N.                | Cable Group | Pit.   | Ins.   | Imp. | Crimp Tool |
|---------------------|-------------|--------|--------|------|------------|
| SMB6252B1-NT30G-50  | N/A         | Nickel | Teflon | 50   | N/A        |
| SMB6252B1-3GT30G-50 | N/A         | Gold   | Teflon | 50   | N/A        |
| SMC Connectors      |             |        |        |      |            |
| SMC6252B1-NT30G-50  | N/A         | Nickel | Teflon | 50   | N/A        |
| SMC6252B1-3GT30G-50 | N/A         | Gold   | Teflon | 50   | N/A        |

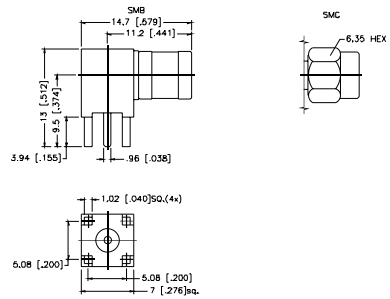
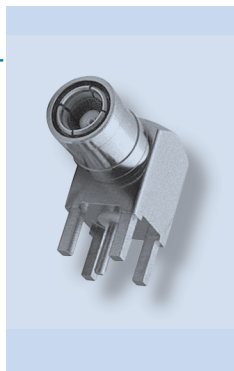

**Right Angle Jack for P.C. Board**

| P.N.                | Cable Group | Pit.   | Ins.   | Imp. | Crimp Tool |
|---------------------|-------------|--------|--------|------|------------|
| SMB1252B1-NT30G-50  | N/A         | Nickel | Teflon | 50   | N/A        |
| SMB1252B1-3GT30G-50 | N/A         | Gold   | Teflon | 50   | N/A        |
| SMB1252B1-TT30G-50  | N/A         |        | Teflon | 50   | N/A        |
| SMC Connectors      |             |        |        |      |            |
| SMC1252B1-NT30G-50  | N/A         | Nickel | Teflon | 50   | N/A        |
| SMC1252B1-3GT30G-50 | N/A         | Gold   | Teflon | 50   | N/A        |

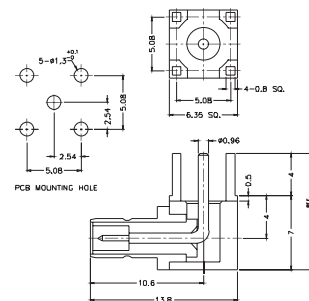
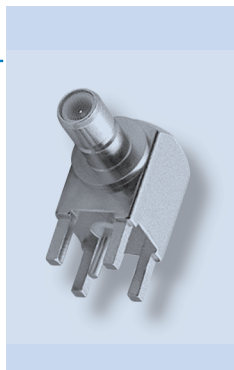

**Right Angle Bulkhead Jack for P.C. Board**

| P.N.                   | Cable Group | Pit. | Ins.   | Imp. | Crimp Tool |
|------------------------|-------------|------|--------|------|------------|
| SMB74971-001-3GT30G-50 | N/A         | Gold | Teflon | 50   | N/A        |

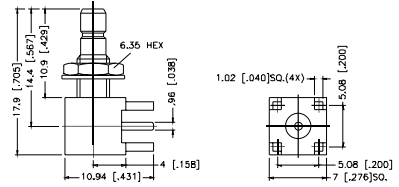
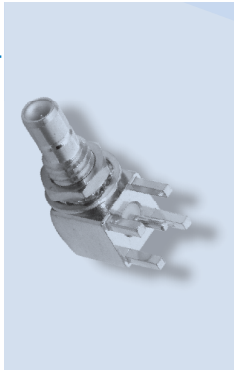

Note: Male center contact

**SMT Jack Edge-Card**

| P.N.                | Cable Group | Pit. | Ins.   | Imp. | Crimp Tool |
|---------------------|-------------|------|--------|------|------------|
| SMB1251S1-3GT30G-50 | N/A         | Gold | Teflon | 50   | N/A        |

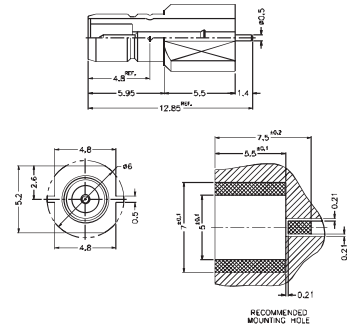

**Bulkhead Jack Receptacle - Front Mount**

| P.N.                  | Cable Group | Pit.   | Ins.   | Imp. | Crimp Tool |
|-----------------------|-------------|--------|--------|------|------------|
| SMB1351B1-NT30G-50    | N/A         | Nickel | Teflon | 50   | N/A        |
| SMB1351B1-3GT30G-50   | N/A         | Gold   | Teflon | 50   | N/A        |
| <b>SMC Connectors</b> |             |        |        |      |            |
| SMC1351B1-NT30G-50    | N/A         | Nickel | Teflon | 50   | N/A        |
| SMC1351B1-3GT30G-50   | N/A         | Gold   | Teflon | 50   | N/A        |

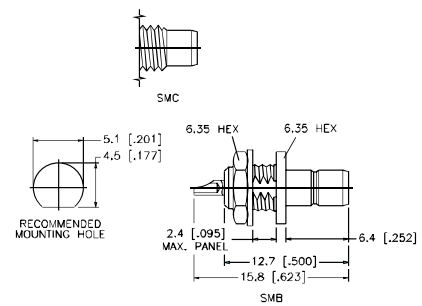
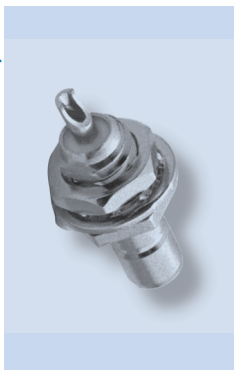

Note: Male center contact

**Bulkhead Jack Receptacle - Rear Mount**

| P.N.                  | Cable Group | Pit.   | Ins.   | Imp. | Crimp Tool |
|-----------------------|-------------|--------|--------|------|------------|
| SMB1451B1-NT30G-50    | N/A         | Nickel | Teflon | 50   | N/A        |
| SMB1451B1-3GT30G-50   | N/A         | Gold   | Teflon | 50   | N/A        |
| <b>SMC Connectors</b> |             |        |        |      |            |
| SMC1451B1-NT30G-50    | N/A         | Nickel | Teflon | 50   | N/A        |
| SMC1451B1-3GT30G-50   | N/A         | Gold   | Teflon | 50   | N/A        |

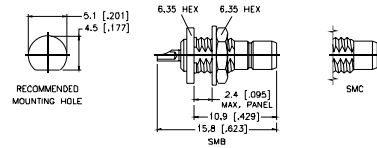

Note: Male center contact

**Bulkhead Recessed Jack Receptacle**

| P.N.                | Cable Group | Pit.   | Ins.   | Imp. | Crimp Tool |
|---------------------|-------------|--------|--------|------|------------|
| SMB1351B9-NT30G-50  | N/A         | Nickel | Teflon | 50   | N/A        |
| SMB1351B9-3GT30G-50 | N/A         | Gold   | Teflon | 50   | N/A        |

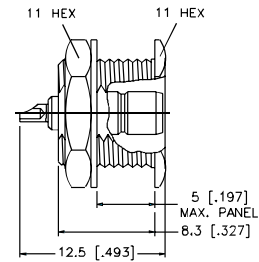
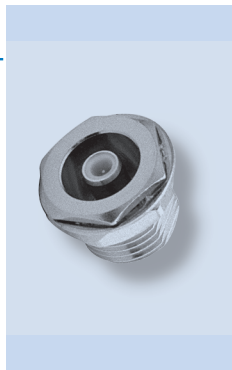

Note: Male center contact

**Push Fit Jack Receptacle**

| P.N.                    | Cable Group | Pit. | Ins.   | Imp. | Crimp Tool |
|-------------------------|-------------|------|--------|------|------------|
| SMB1051A2-003-3GT30G-50 | N/A         | Gold | Teflon | 50   | N/A        |

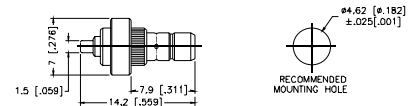

**Panel Mount Jack Receptacle - 4 Hole Square Flange**

| P.N.                  | Cable Group | Pit.   | Ins.   | Imp. | Crimp Tool |
|-----------------------|-------------|--------|--------|------|------------|
| SMB1551A1-NT30G-50    | N/A         | Nickel | Teflon | 50   | N/A        |
| SMB1551A1-3GT30G-50   | N/A         | Gold   | Teflon | 50   | N/A        |
| <b>SMC Connectors</b> |             |        |        |      |            |
| SMC1551A1-NT30G-50    | N/A         | Nickel | Teflon | 50   | N/A        |
| SMC1551A1-3GT30G-50   | N/A         | Gold   | Teflon | 50   | N/A        |

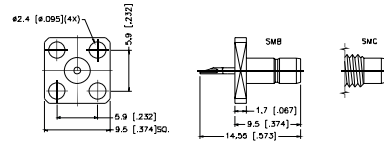
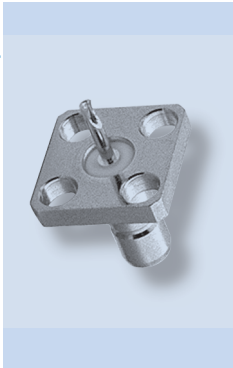

Note: Male center contact

**Panel Mount Jack Receptacle - 2 Hole Flange**

| P.N.                  | Cable Group | Pit.   | Ins.   | Imp. | Crimp Tool |
|-----------------------|-------------|--------|--------|------|------------|
| SMB1551B1-NT30G-50    | N/A         | Nickel | Teflon | 50   | N/A        |
| SMB1551B1-3GT30G-50   | N/A         | Gold   | Teflon | 50   | N/A        |
| <b>SMC Connectors</b> |             |        |        |      |            |
| SMC1551B1-NT30G-50    | N/A         | Nickel | Teflon | 50   | N/A        |
| SMC1551B1-3GT30G-50   | N/A         | Gold   | Teflon | 50   | N/A        |

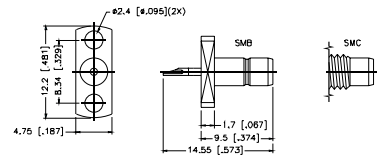
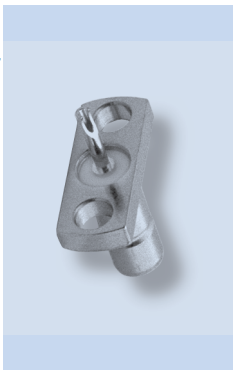

Note: Male center contact

**Plug-to-Plug Adapter**

| P.N.                | Cable Group | Pit.   | Ins.   | Imp. | Crimp Tool |
|---------------------|-------------|--------|--------|------|------------|
| SMB7071A1-NT30G-50  | N/A         | Nickel | Teflon | 50   | N/A        |
| SMB7071A1-3GT30G-50 | N/A         | Gold   | Teflon | 50   | N/A        |

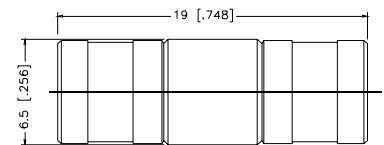

Note: Female center contact

### Jack-to-Jack Adapter

| P.N.                | Cable Group | Pit.   | Ins.   | Imp. | Crimp Tool |
|---------------------|-------------|--------|--------|------|------------|
| SMB2071A1-NT30G-50  | N/A         | Nickel | Teflon | 50   | N/A        |
| SMB2071A1-3GT30G-50 | N/A         | Gold   | Teflon | 50   | N/A        |

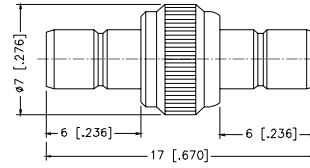
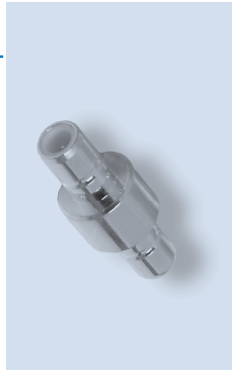

Note: Male center contact

### Plug-to-Jack Adapter - Right Angle

| P.N.                | Cable Group | Pit.   | Ins.   | Imp. | Crimp Tool |
|---------------------|-------------|--------|--------|------|------------|
| SMB5072A1-NT30G-50  | N/A         | Nickel | Teflon | 50   | N/A        |
| SMB5072A1-3GT30G-50 | N/A         | Gold   | Teflon | 50   | N/A        |

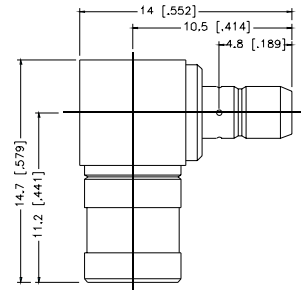

### Jack-to-Jack Adapter - Bulkhead

| P.N.                | Cable Group | Pit.   | Ins.   | Imp. | Crimp Tool |
|---------------------|-------------|--------|--------|------|------------|
| SMB2471A1-NT30G-50  | N/A         | Nickel | Teflon | 50   | N/A        |
| SMB2471A1-3GT30G-50 | N/A         | Gold   | Teflon | 50   | N/A        |

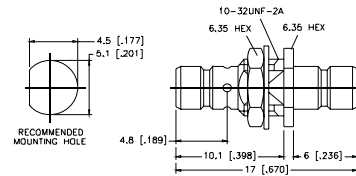
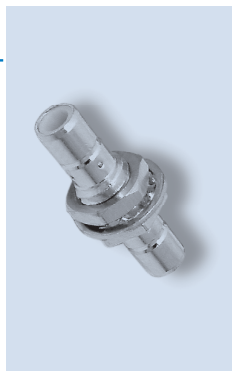

Note: Male center contact