

PRODUCT NO. 70243-101LF  
70243-111LF

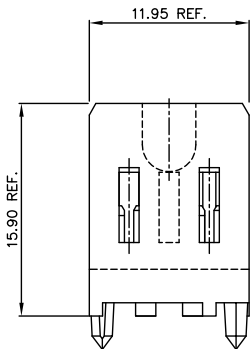

These hole are required when a shroud is used

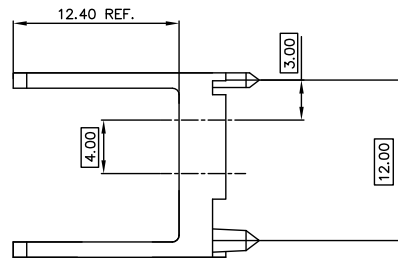
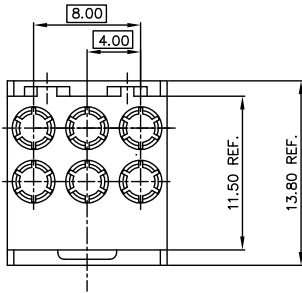
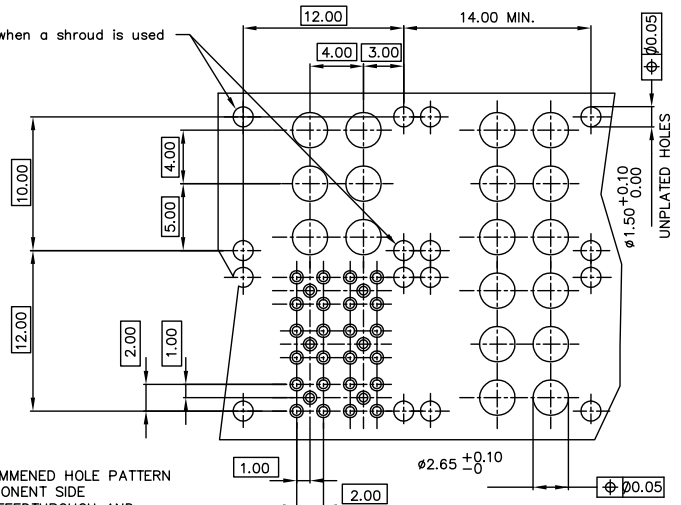

NOTE:  
1) MATERIAL:  
LIQUID CRYSTAL POLYMER  
30% GLASS  
FLAME RETARDANT ACC. UL 94-V0  
COLOR NATURAL.

2) WHEN USING THIS PRODUCT IN A STRAIGHT TO BOARD APPLICATION THE FOLLOWING MUST BE TAKEN INTO ACCOUNT.  
-101LF HOUSING IS TO BE USED FOR THE SOLDER TO BOARD INSERT 88980-00Z.  
-111LF HOUSING IS TO BE USED FOR THE PRESS-FIT TO BOARD INSERT 88978-001.

3) THIS PRODUCT WITH "LF" SUFFIX MEETS EUROPEAN UNION DIRECTIVES AND OTHER COUNTRY REGULATIONS AS DESCRIBED IN GS -22-008.  
4) THE HOUSING WILL WITHSTAND EXPOSURE TO 260 DEGREE PEAK TEMPERATURE FOR 10 SECONDS IN A WAVE SOLDER APPLICATION WITH A 1.6mm MINIMUM THICK CIRCUIT BOARD.

RECOMMENDED HOLE PATTERN  
COMPONENT SIDE  
FOR FEEDTHROUGH AND  
SOLDER TO BOARD.

mat'l. code	tolerances unless otherwise specified	CUSTOMER COPY	projection	title
SEE NOTE 1.				MINI COAX
ltr ecn no dr date				S.T. MALE CONNECTOR
A H10290 DAN 910912 linear				product family METRAL(tm)
B H10402 DAN 911229				code
C H20795 DAN 921124 angles				size dwg no
D H40801 RVL 941208 dr D Andrews 910912				scale
E H90489 HME 990818 enh D Andrews 941208				sheet
F 905-003 Cui 050927 chr A v Zanten 910912				1 of 1
sheet revision F				
part sheet				

PDM: Rev.P STATUS: Released

Printed: May 19, 2011