

| PRODUCT NUMBER | QUANTITY PER REEL | PACKAGING |
|----------------|-------------------|----------------|
| 76785-Y01(LF) | 15000 | CARDBOARD REEL |
| 76785-Y11(LF) | 3000 | CARDBOARD REEL |

WHEN NEEDED, SUFFIX LETTER "LF" INDICATES THE PRODUCT IS RoHS COMPATIBLE, SEE NOTE 3

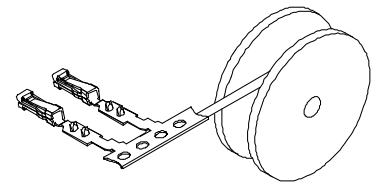

REELING AFTER STAMPING

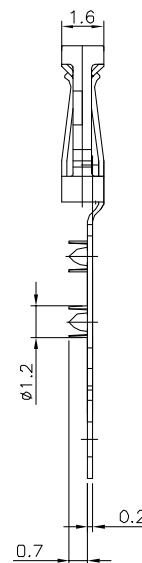
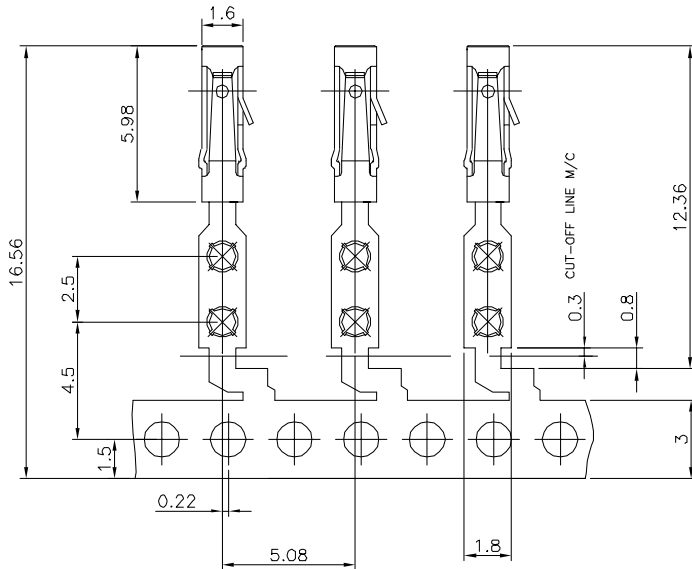

NOTES:

- 1 - MATERIAL: PHOSPHOR BRONZE, EXTRA HARD
 - 2 - FOR APPLICATION DATA, SEE TA 338
 - 3 - RoHS COMPATIBLE PRODUCT SPECIFICATIONS
 - a - PLATING:
 - "LF" MEANS THE PRODUCT IS LEAD-FREE, 2µm MINIMUM MATTE TIN OVER 1.27µm MINIMUM NICKEL UNDERPLATE.
 - b - LABELING:
 - MEETS PACKAGING SPECS AS PER GS-14-920
 - c - LEGAL STATEMENT: SEE GS-22-008
- THE PRODUCT IS NOT INTENDED TO BE EXPOSED TO A MANUFACTURING SOLDER PROCESS.

| | | | |
|---------------------|-----------------------------------|--------------|--|
| 76785-3XXLF | 0.75µm Au MIN. OVER 1.3µm Ni MIN. | Sn OVER Ni | 0.3 N MIN 0.6 N MAX |
| 76785-4XXLF | 5µm Sn MIN. OVER 1.27µm Ni MIN. | Sn OVER Ni | 0.3 N MIN 0.6 N MAX |
| 76785-3XX | 0.75µm Au MIN. OVER 1.3µm Ni MIN. | SnPb OVER Ni | 0.3 N MIN 0.6 N MAX |
| 76785-4XX | 5µm SnPb MIN. OVER 0.1µm Ni MIN. | SnPb OVER Ni | 0.3 N MIN 0.6 N MAX |
| PLATING CODE | CONTACT AREA | SOLDER TAIL | WITHDRAWAL FORCE USING SQUARE PIN 0.61 |
| PLATING EXPLANATION | | | |

| matl. code | SEE NOTE | surface | tolerance | projection | product family |
|-------------|----------------|--------------|--------------|--------------|----------------|
| lit locn no | date | date | date | date | DUFLEX |
| M F05-0285 | DLE 05.11.07 | DLE 05.11.07 | DLE 05.11.07 | DLE 05.11.07 | DUFLEX |
| N F06-0198 | DLE 06.06.13 | DLE 06.06.13 | DLE 06.06.13 | DLE 06.06.13 | DUFLEX |
| dr | D LEONARDI | 06.06.12 | 06.06.12 | 06.06.12 | DUFLEX |
| engr | P NIZZI | 06.06.12 | 06.06.12 | 06.06.12 | DUFLEX |
| chr | D LE | 06.06.12 | 06.06.12 | 06.06.12 | DUFLEX |
| DDP | P NZ | 06.06.12 | 06.06.12 | 06.06.12 | DUFLEX |
| sheet index | revision sheet | | | | |