

1N5624 1N5626  
1N5625 1N5627

**SILICON  
GLASS PASSIVATED RECTIFIERS  
5.0 AMP, 200 THRU 800 VOLT**



**Central**  
Semiconductor Corp.

[www.centrasemi.com](http://www.centrasemi.com)

**DESCRIPTION:**

The CENTRAL SEMICONDUCTOR 1N5624 series types are silicon rectifiers mounted in a hermetically sealed, glass passivated package, designed for general purpose applications where high reliability is required.

**MARKING: FULL PART NUMBER**

**MAXIMUM RATINGS:** ( $T_A=25^\circ\text{C}$  unless otherwise noted)

	SYMBOL	1N5624	1N5625	1N5626	1N5627	UNITS
Peak Repetitive Reverse Voltage	$V_{RRM}$	200	400	600	800	V
DC Blocking Voltage	$V_R$	200	400	600	800	V
RMS Reverse Voltage	$V_{R(RMS)}$	140	280	420	560	V
Average Forward Current ( $T_A=75^\circ\text{C}$ )	$I_O$			3.0		A
Average Forward Current	$I_O$			5.0		A
Peak Forward Surge Current, $t_p=8.3\text{ms}$	$I_{FSM}$			100		A
Operating and Storage Junction Temperature	$T_J, T_{stg}$			-65 to +200		$^\circ\text{C}$

**ELECTRICAL CHARACTERISTICS:** ( $T_A=25^\circ\text{C}$  unless otherwise noted)

SYMBOL	TEST CONDITIONS	MIN	MAX	UNITS
$I_R$	$V_R=\text{Rated } V_{RRM}$		5.0	$\mu\text{A}$
$V_F$	$I_F=3.0\text{A}$		1.0	V

R1 (9-April 2013)

1N5624 1N5626  
1N5625 1N5627

SILICON  
GLASS PASSIVATED RECTIFIERS  
5.0 AMP, 200 THRU 800 VOLT



GPR-4AM CASE - MECHANICAL OUTLINE

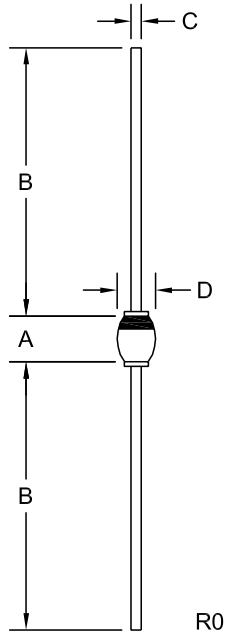

SYMBOL	INCHES		MILLIMETERS	
	MIN	MAX	MIN	MAX
A	0.165	0.189	4.20	4.80
B	1.024	--	26.00	--
C	0.037	0.042	0.95	1.06
D	0.130	0.175	3.30	4.45

GPR-4AM (REV: R0)

R1 (9-April 2013)