

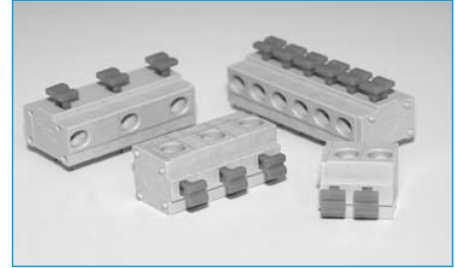

**TERMINAL BLOCKS**

**5, 5.08, 7.5, 7.62, 10 AND 10.16mm SCREWLESS**

- 5, 5.08, 7.5, 7.62, 10 and 10.16mm pitch
- 1-36 poles on 5 & 5.08mm pitch
- 1-24 poles on 7.5 & 7.62mm pitch
- 1-18 poles on 10 & 10.16mm pitch
- Breakable to desired number of poles
- 0.3-1.5mm<sup>2</sup> wire acceptance
- UL/ VDE/ CE approved
- Flame retardant material



**SPECIFICATION**

	<b>5/5.08</b>	<b>7.5/7.62/10/10.16</b>
<b>Rating:</b>	12/250V	12A/750V
<b>Dielectric Strength:</b>	≥2.5KV/60sec	≥3KV/60sec
<b>Insulation Resistance:</b>	≥5MΩ	
<b>Working temperature:</b>	-20°C to 125°C	
<b>Short Period:</b>	160°	
<b>Moulding:</b>	UL94V-0 flame retardant PA66	
<b>Pin/terminal:</b>	5μ tinned, phosphor bronze	
<b>Spring:</b>	Zinc plated steel	
<b>Recommended PCB hole size:</b>	ø1.1mm	

**OUTLINE DRAWING**

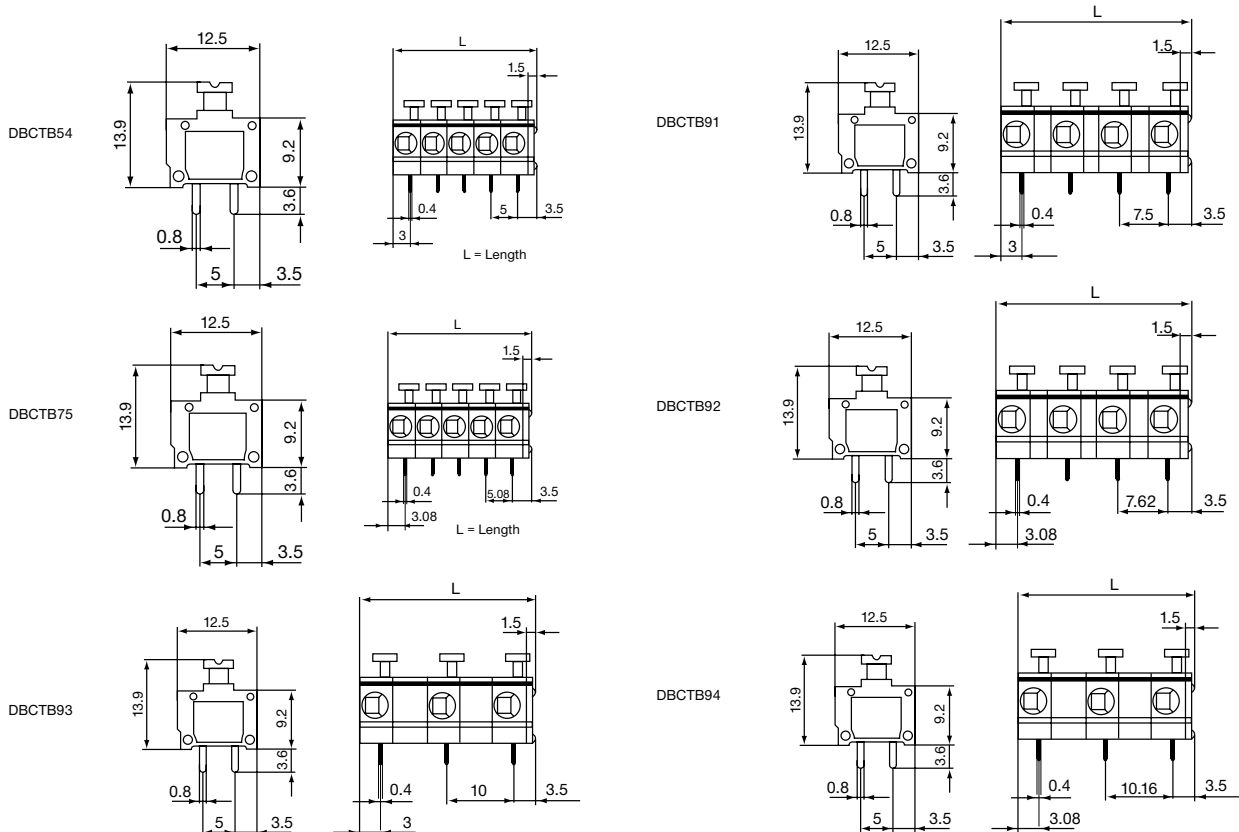

SECTION 18

**ORDERING INFORMATION**

DBC	TB	54	/2
Dubilier Connectors	Series Terminal Block	Style 54 -5mm 75-5.08mm 91-7.5mm 92-7.62mm 93-10mm 94-10.16mm	Nº of Ways 2 = 2 ways 3 = 3 ways
		* Other Number of ways are available up to 12 Please consult office for further details	

**How to calculate lengths**

5mm pitch	No.Poles Multiply by 5mm + 1.5mm
5.08mm pitch	No.Poles Multiply by 5.08mm + 1.5mm
7.5mm pitch	No.Poles Multiply by 7.5mm - 1mm
7.62mm pitch	No.Poles Multiply by 7.62mm - 1.04mm
10mm pitch	No.Poles Multiply by 10mm - 3.5mm
10.16mm pitch	No.Poles Multiply by 10mm - 3.58mm