

TERMINAL BLOCKS

- 7.5mm Pitch
- Rising Clamp Terminal
- 2 - 12 pole interlocking
- 2.5mm² wire acceptance
- UL/CE/VDE approved
- Colour green

7.5MM PITCH 18 POLE RISING CLAMP

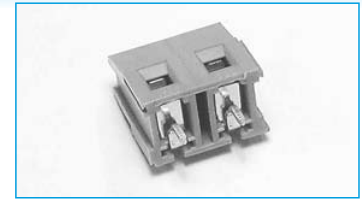

SPECIFICATION

Electrical Characteristics

Rating Current: 20A/750V
Dielectric Voltage: ≥ 3kV/60sec
Insulation Resistance: ≥ 5MΩ
Operating Temperature: -20°C to +125°C
Short Period: 160°C

Moulding: UL94-V0 flame retardant PA66
Pin/terminal: 5μ tinned, nickel plated brass
Wire clamp: Nickel plated brass
Screw/torque: M3 steel, 6μ zinc colour passivated and tropicalised/0.5Nm
Recommended PCB hole size: ø1.3mm

OUTLINE DRAWING

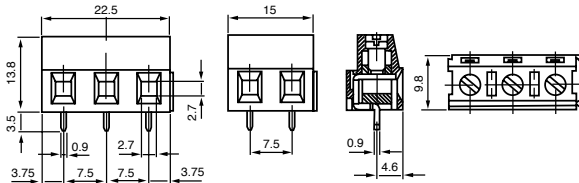

ORDERING INFORMATION

DBC	TB	33	/2
Dubilier Connectors	Series Terminal Blocks	Style	No of Ways
			2 = 2ways 3 = 3ways
* other number of ways are available Please consult the office for further details			

TERMINAL BLOCKS

- 7.5mm pitch
- Flame retardant material
- 2.5mm² wire acceptance
- Interlocking
- Professional rising clamp
- UL/ CSA approved



7.5mm PITCH 90° MOUNT



SPECIFICATION

Rating: 20A/750V
Dielectric Strength: ≥3KV/60sec
Insulation Resistance: ≥5MΩ
Working temperature: -20°C to 125°C
Short Period: 160°
Moulding: UL94V-0 flame retardant PA66
Pin/terminal: 5μ tinned, nickel plated brass

Wire clamp: Nickel plated brass
Screw/torque: M3 steel, 6 μ zinc colour passivated and tropicalised/0.5Nm
Recommended PCB hole size: ø1.3mm

OUTLINE DRAWING

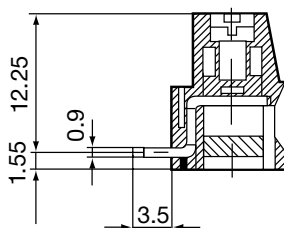

ORDERING INFORMATION

DBC	TB	88	/2
Dubilier Connectors	Series Terminal Block	Style	N° of Ways
			2 = 2 ways 3 = 3 ways
* Other Number of ways are available up to 12 Please consult office for further details			