

10 9 8 7 6 5 4 3 2 1

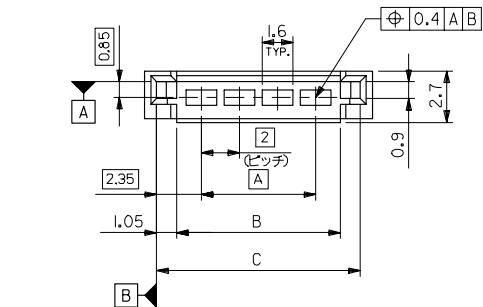

- 注記**
- 嵌合相手: 51005
MATE WITH: 51005
 - 適合ターミナル: 50012
APPLICABLE TERMINAL: 50012
 - ELV 及び RoHS 適合品
ELV AND RoHS COMPLIANT.

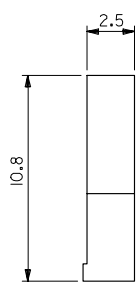
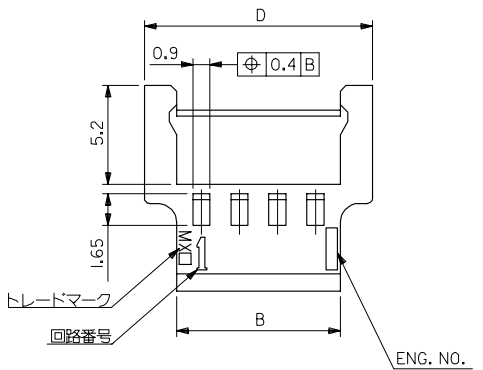

14	12.7	10.6	8	51006-0500	5
12	10.7	8.6	6	↑ - 0400	4
10	8.7	6.6	4	↓ - 0300	3
8	6.7	4.6	2	51006-0200	2
D	C	B	A	MATERIAL NO.	極致

MATERIAL
PBTP (UL94V-0)

REVISED EC NO: J2008-0075 DRAWN: H. H. 2007/07/16 CHKD: HARUYAMA 2007/07/17 APPR: NUKITA 2007/07/17	GENERAL TOLERANCES (UNLESS SPECIFIED)		DIMENSION STYLE MM ONLY		SCALE 5:1	DESIGN UNITS METRIC	MODEL NO. 51006-xx00
	10 UNDER	±0.2	DRAWN BY S. MOCHIZUKI	DATE '89/08/22	TITLE 2.0 WIRE TO WIRE CONN. PLUG HOUSING		
	10 OVER 30 UNDER	±0.25	CHECKED BY H. H.	DATE '90/05/16	THIRD ANGLE PROJECTION		
	30 OVER	±0.3	APPROVED BY M. ENOMOTO	DATE '90/05/16	MOLEX INCORPORATED		
	ANGULAR ±3 °	DRAFT WHERE APPLICABLE MUST REMAIN WITHIN DIMENSIONS		MATERIAL NO.	DOCUMENT NO. SD-51006-001	SHEET NO. 1 OF 1	
		SEE TABLE		THIS DRAWING CONTAINS INFORMATION THAT IS PROPRIETARY TO MOLEX INCORPORATED AND SHOULD NOT BE USED WITHOUT WRITTEN PERMISSION			