

SEZ. A-A

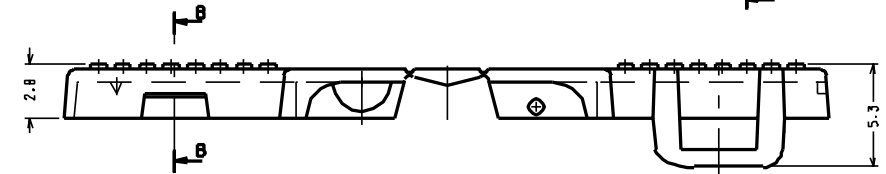
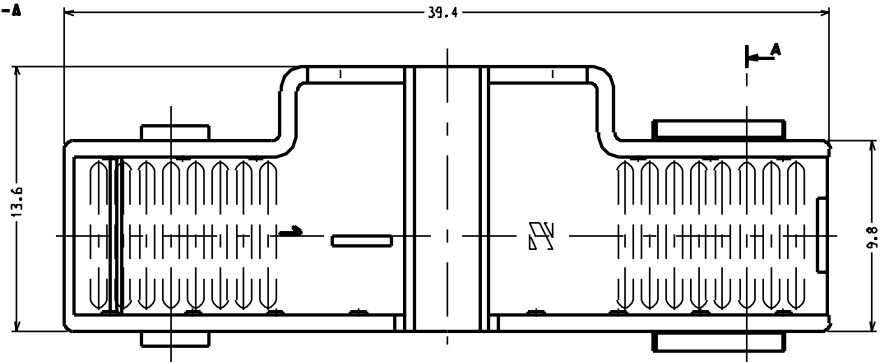

CONFEZIONE:  
20.000 PEZZI ALL'INTERNO DI UN SACCHETTO IN  
SCATOLA DI CARTONE. S.P.O.

CODE TABLE		
PART NUMBER	MATERIALE	COLORE
94090-4030		NATURALE
94090-4031	NYLON 66 V2 UL94	NERO
94090-4032		ROSSO

Std. Descr. "HSG FOR FEMALE TERM R/A 1 CKT"

EC NO. Z2001-0159 DRAWING IN 01/06/14 CINA NESTAGU01/06/14 APPROVATUKCOI/06/14	QUALITY SYMBOLS MAJOR W = SIGNIF. S = CRITICAL C =	GENERAL TOLERANCES* (UNLESS SPECIFIED) <table border="1"> <tr> <th></th> <th>MM</th> <th>INCH</th> </tr> <tr> <td>4 PLACES</td> <td>±0.2</td> <td>±.</td> </tr> <tr> <td>3 PLACES</td> <td>±0.</td> <td>±.</td> </tr> <tr> <td>2 PLACES</td> <td>±0.1</td> <td>±.</td> </tr> <tr> <td>1 PLACE</td> <td>±0.2</td> <td>±.</td> </tr> </table> ANGULAR: ± 2° DRAFT WHERE APPLICABLE MUST REMAIN WITHIN DIMENSIONS		MM	INCH	4 PLACES	±0.2	±.	3 PLACES	±0.	±.	2 PLACES	±0.1	±.	1 PLACE	±0.2	±.	SCALE 5:1 DESIGN UNITS <input checked="" type="checkbox"/> mm <input type="checkbox"/> INCH	DRAWN BY & DATE EFASLO 96/11/22 CHECKED BY & DATE APPROVED BY & DATE MPREVIAT 96/11/22	DIMENSIONS: <input type="checkbox"/> mm <input type="checkbox"/> INCH <input checked="" type="checkbox"/> mm ONLY	SHT REV REVISE ON CAD ONLY
				MM	INCH																
4 PLACES	±0.2	±.																			
3 PLACES	±0.	±.																			
2 PLACES	±0.1	±.																			
1 PLACE	±0.2	±.																			
CAD FILENAME Z904305	TITLE <b>COPRI CAPOCORDA A BANDIERA          PER CAPOCORDA FEMMINA Z 630</b> <b>MOLEX INCORPORATED</b>	MATERIAL NO. VEDI TAB.	DRAWING NO. <b>SD-94090-020</b>	SHEET NO. 1/1	SIZE A3																

THIS DRAWING CONTAINS INFORMATION THAT IS PROPRIETARY TO MOLEX INCORPORATED AND SHOULD NOT BE USED WITHOUT WRITTEN PERMISSION.