

REVISED IEC NO: SH2010-0043 DRAWING: 2009/08/07 CHKD: JISONG APPR: RZHANG 2009/08/10 2009/09/13	DESCRIPTION HIGH SPEED CONNECTOR 1.27MM PITCH VERTICAL SMT SOLDER TAIL	QUALITY SYMBOLS	GENERAL TOLERANCES (UNLESS SPECIFIED)	DIMENSION STYLE	SCALE	DESIGN UNITS	THIRD ANGLE PROJECTION
		$\nabla=0$ $\nabla=0$	mm INCH 4 PLACES ± --- ± --- 3 PLACES ± --- ± --- 2 PLACES ± 0.15 ± --- 1 PLACE ± 0.25 ± --- ANGULAR ± 1°	MM ONLY	5:1	METRIC	
		DRAFT WHERE APPLICABLE MUST REMAIN WITHIN DIMENSIONS	DRAWN BY: GRATE MA DATE: 2004/02/02 CHECKED BY: DATE: APPROVED BY: YA JUN DATE: 2004/02/02 SAM	TITLE			
		MATERIAL NO. SEE SHEET 2 MOLEX INCORPORATED DOCUMENT NO. SD-67800-005 SHEET NO. 1 OF 2					

10 9 8 7 6 5 4 3 2 1

NOTES:

1. MATERIAL:

HOUSING: HIGH TEMPERATURE THERMAL PLASTIC, GLASS FILLED,
UL94V-0, COLOR: REFER TO CHART.

TERMINAL: BRASS
POST: BRASS

2. TERMINAL PLATING:

CONTACT AREA: (a) GOLD FLASH
(b) GOLD, THICKNESS=0.76 MICRON MINIMUM
(c) GOLD, THICKNESS=0.38 MICRON MINIMUM

SOLDER TAIL: TIN, THICKNESS=1.27 MICRON MINIMUM
UNDER PLATE: NICKEL PLATED, THICKNESS=1.27 MICRON MINIMUM

3. POST PLATING: UNDER PLATE: NICKEL, THICKNESS=1.25 MICRON MINIMUM
TIN, THICKNESS=1.9 MICRON MINIMUM OVER ALL

4. PACKAGING: PK-67800-001

5. PRODUCT SPECIFICATION REFER TO PS-67491-001

6. RECOMMENDED SOLDERING PROCESS: IR PROCESS

⚠ METAL POSTS TO BE SOLDERED TO PCB

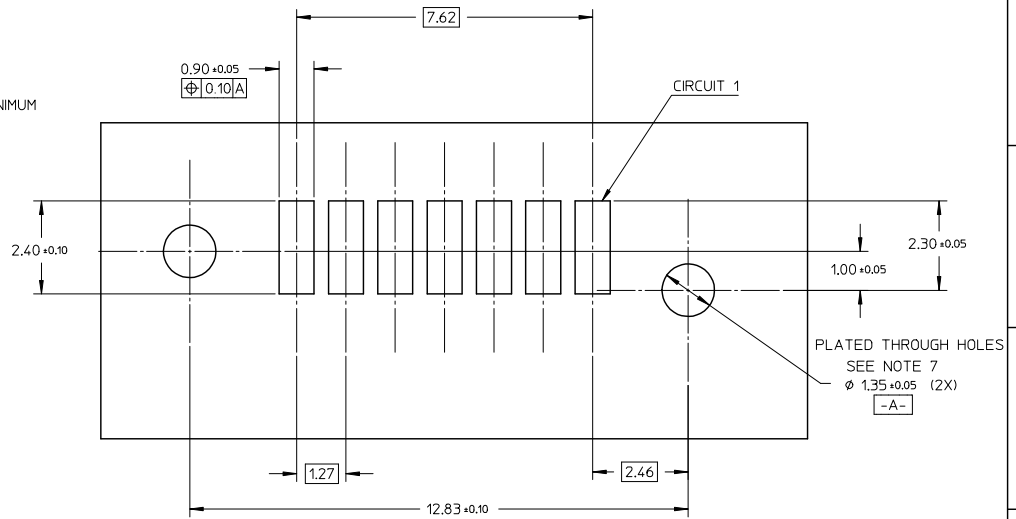

RECOMMENDED P.C.B LAYOUT
CONNECTOR SIDE

678005025	SEE NOTE2(c)			PURE TIN
678005022	SEE NOTE2(b)	BLACK	3.45	
678005021	SEE NOTE2(g)			
678005015	SEE NOTE2(c)			
678005012	SEE NOTE2(b)	BLACK	3.05	
678005011	SEE NOTE2(a)			
678005005	SEE NOTE2(c)	BLACK	2.65	
678005004	SEE NOTE2(c)	YELLOW		
678005003	SEE NOTE2(c)	BLUE		
678005002	SEE NOTE2(b)			
678005001	SEE NOTE2(g)	BLACK		

MATERIAL NO	PLATING TYPE	HOUSING COLOR	DIM A	REMARK
678005025	SEE NOTE2(c)			

REVISED IEC NO: SH2010-0043 DRAWING: 2009/08/07 CHK: XJ/SONG APPR: ZHANG 2009/09/13	DESCRIPTION REV	QUALITY SYMBOLS	GENERAL TOLERANCES (UNLESS SPECIFIED)	DIMENSION STYLE	SCALE	DESIGN UNITS	THIRD ANGLE PROJECTION															
		$\nabla=0$ $\nabla=0$	<table border="1"> <tr> <th></th> <th>mm</th> <th>INCH</th> </tr> <tr> <td>4 PLACES</td> <td>± ---</td> <td>± ---</td> </tr> <tr> <td>3 PLACES</td> <td>± ---</td> <td>± ---</td> </tr> <tr> <td>2 PLACES</td> <td>± 0.15</td> <td>± ---</td> </tr> <tr> <td>1 PLACE</td> <td>± 0.25</td> <td>± ---</td> </tr> </table>		mm	INCH	4 PLACES	± ---	± ---	3 PLACES	± ---	± ---	2 PLACES	± 0.15	± ---	1 PLACE	± 0.25	± ---	MM ONLY	5:1	METRIC	
			mm	INCH																		
		4 PLACES	± ---	± ---																		
3 PLACES	± ---	± ---																				
2 PLACES	± 0.15	± ---																				
1 PLACE	± 0.25	± ---																				
DRAFT WHERE APPLICABLE MUST REMAIN WITHIN DIMENSIONS	DRAWN BY: GRATE MA DATE: 2004/02/02 CHECKED BY: YAJUN DATE: 2004/02/02 APPROVED BY: SAM DATE: 2004/02/02	TITLE: HIGH SPEED CONNECTOR 1.27MM PITCH VERTICAL SMT SOLDER TAIL	MOLEX INCORPORATED																			
		MATERIAL NO: SEE CHART SIZE: A3	DOCUMENT NO: SD-67800-005 SHEET NO: 2 OF 2																			

10 9 8 7 6 5 4 3 2 1

tb_frame_A3_P_AM.T
Rev. E 2006/04/15