

13 12 11 10 9 8 7 6 5 4 3 2 44432

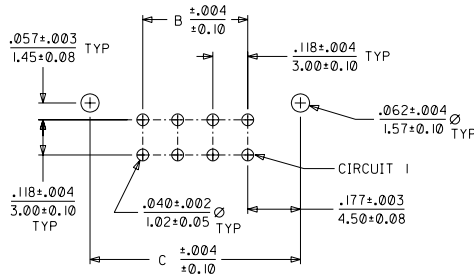
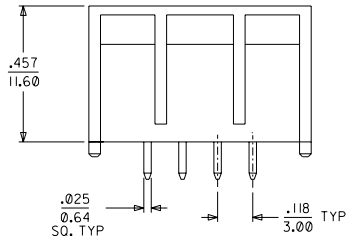
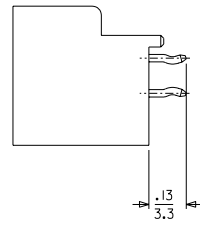
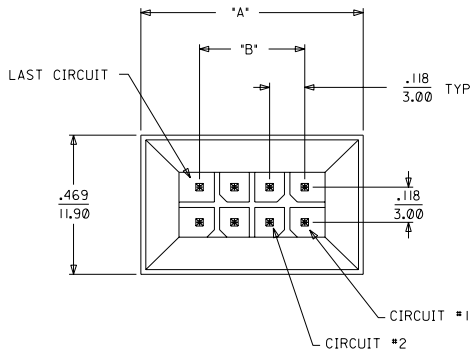

CIRCUIT SIZE	*A*	*B*	C
04	.512 13.00	.118 3.00	.472 12.00
06	.630 16.00	.236 6.00	.590 15.00
08	.748 19.00	.354 9.00	.709 18.00
10	.866 22.00	.472 12.00	.827 21.00
12	.984 25.00	.590 15.00	.945 24.00
14	1.102 28.00	.709 18.00	1.063 27.00
16	1.220 31.00	.827 21.00	1.181 30.00
18	1.338 34.00	.945 24.00	1.299 33.00
20	1.457 37.00	1.063 27.00	1.417 36.00
22	1.575 40.00	1.181 30.00	1.535 39.00
24	1.693 43.00	1.299 33.00	1.653 42.00

NOTES :

- MATERIALS -
HOUSING : NYLON , GLASS-FILLED, UL94V-0 COLOR - BLACK
TERMINAL : BRASS ALLOY
- FINISH:
A= .000200/(0.0051) TIN OVER .000050/(0.0013) NICKEL.
B= .000015/(0.00038) MIN GOLD IN SELECTIVE AREA;
.000050/(0.0013) MIN TIN-LEAD (90/10) ON SOLDER TAILS
BOTH OVER .000050/(0.0013) NICKEL.
C= .000030/(0.00076) MIN GOLD IN SELECTIVE AREA;
.000050/(0.0013) MIN TIN-LEAD (90/10) ON SOLDER TAILS
BOTH OVER .000050/(0.0013) NICKEL.
- PRODUCT SPECIFICATION : PS-44300-001
- PACKAGING SPECIFICATION : PK-44432-001
- THIS ASSEMBLY MATES WITH MOLEX BMI PANEL MOUNT RECEPTACLE
(SEE DRAWING SD-44133-001) & FEMALE CRIMP TERMINAL (SEE DRAWING SD-43030-****)
- SEE SHEET 2 FOR PART NUMBER CHART.

PCB LAYOUT: COMPONENT SIDE
RECOMMENDED PCB THICKNESS .062/157

ADD POARIZATION EC NO. UCP2003-1965 DRN: MUELLER 03/03/14 CHK: MUELLER 03/03/14 APPR: MARCOLIS 02/05/14	QUALITY SYMBOLS MAJOR CRITICAL	GENERAL TOLERANCES: (UNLESS SPECIFIED)		SCALE 4 : 1	DESIGN UNITS mm INCH	THIRD ANGLE PROJECTION	DIMENSIONS: mm INCH mm INCH	SHT I	REV C
		4 PLACES ±0.	3 PLACES ±0.	2 PLACES ±0.25	1 PLACE ±0.38	ANGULAR: ±1 °	DRAFT WHERE APPLICABLE MUST REMAIN WITHIN DIMENSIONS	THIS DRAWING CONTAINS INFORMATION THAT IS PROPRIETARY TO MOLEX INCORPORATED AND SHOULD NOT BE USED WITHOUT WRITTEN PERMISSION.	
REV C	DESCRIPTION	DRAWN BY & DATE MUELLER 99/11/29		CHECKED BY & DATE MUELLER 99/11/29		APPROVED BY & DATE R EDGLEY 99/11/30		TITLE: MICRO-FIT (3.0) DUAL ROW VERTICAL BMI HEADER - ASS'Y	
		MATERIAL NO. SEE CHART		DRAWING NO. SD-44432-001		MOLEX INCORPORATED		SHEET NO. 1 OF 2	

L: BORD.DGN REV A 96/06/12 LEVEL 5 12 11 10 9 8 7 6 5 4 3 2 1

44432

MATERIAL NUMBER	NUMBER OF POSITIONS	PLATING OPTION
44432-0401	04	A
44432-0402	04	B
44432-0403	04	C
44432-0601	06	A
44432-0602	06	B
44432-0603	06	C
44432-0801	08	A
44432-0802	08	B
44432-0803	08	C
44432-1001	10	A
44432-1002	10	B
44432-1003	10	C
44432-1201	12	A
44432-1202	12	B
44432-1203	12	C
44432-1401	14	A
44432-1402	14	B
44432-1403	14	C
44432-1601	16	A
44432-1602	16	B
44432-1603	16	C
44432-1801	18	A
44432-1802	18	B
44432-1803	18	C
44432-2001	20	A
44432-2002	20	B
44432-2003	20	C
44432-2201	22	A
44432-2202	22	B
44432-2203	22	C
44432-2401	24	A
44432-2402	24	B
44432-2403	24	C

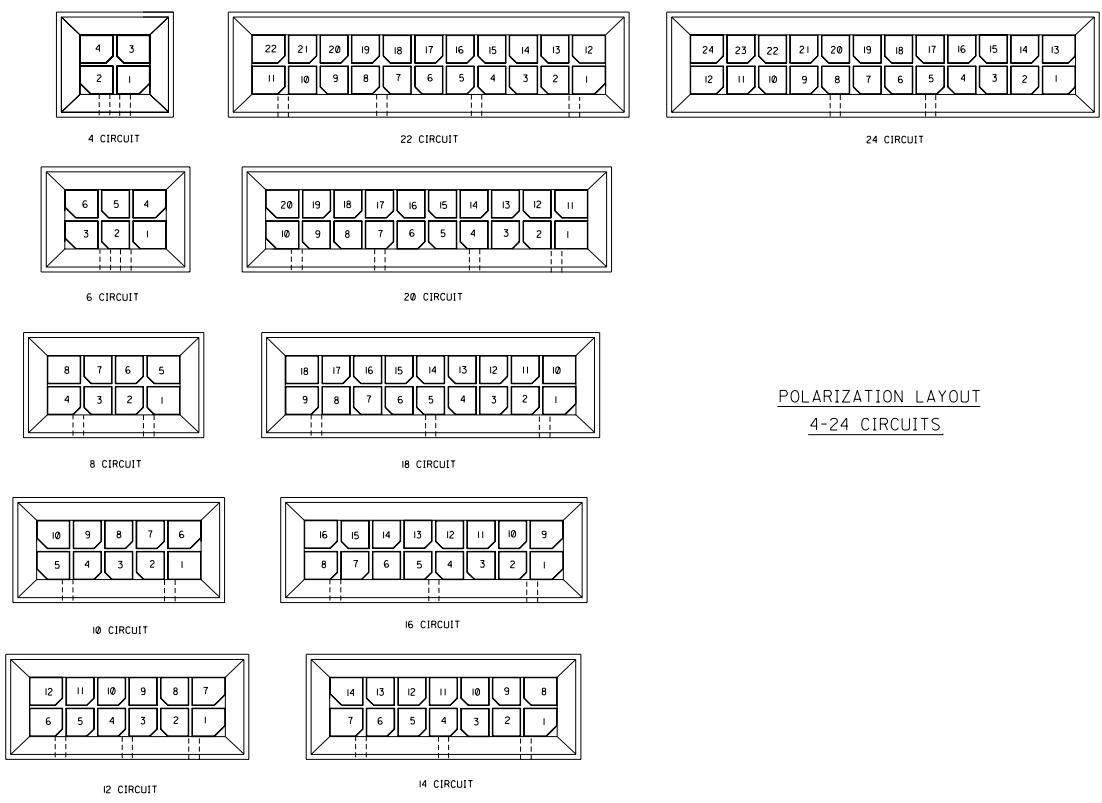

SEE SHEET 1 EC NO. C DRAWN: / CHKS: / APPR: / REV: /	QUALITY SYMBOLS MAJOR CRITICAL DESCRIPTION REV: /	GENERAL TOLERANCES: (UNLESS SPECIFIED)	SCALE 4 : 1	DESIGN UNITS <input checked="" type="checkbox"/> mm <input type="checkbox"/> INCH	THIRD ANGLE PROJECTION <input checked="" type="checkbox"/> THIRD ANGLE <input type="checkbox"/> FIRST ANGLE	DIMENSIONS: <input type="checkbox"/> mm <input checked="" type="checkbox"/> INCH <input type="checkbox"/> mm ONLY	SHT REV
		4 PLACES ±0.15 3 PLACES ±0.25 2 PLACES ±0.36 1 PLACE ±0.50 ANGULAR: ±1°	DRAWN BY & DATE MUELLER 99/11/29 CHECKED BY & DATE MUELLER 99/11/29 APPROVED BY & DATE R EDGLEY 99/11/30	TITLE: MICRO-FIT (3.0) DUAL ROW VERTICAL BMI HEADER - ASS'Y	MATERIAL NO. SEE CHART	DRAWING NO. SD-44432-001	SHEET NO. 2

DRAFT WHERE APPLICABLE MUST REMAIN WITHIN DIMENSIONS

THIS DRAWING CONTAINS INFORMATION THAT IS PROPRIETARY TO MOLEX INCORPORATED AND SHOULD NOT BE USED WITHOUT WRITTEN PERMISSION.