

NOTES :

1- MATERIAL:

-HOUSING: LCP FIBER GLASS FILLED UL 94-V0
COLOR BLACK.

-TERMINAL: PHOSPHOR BRONZE.

PLATING :

POST PLATE 0.00127-0.00152/.000050-.000060 GOLD IN CONTACT AREA , 0.00190/.000075 MIN PURE TIN IN TAIL AREA BOTH OVER 0.00127/.000050 MIN NICKEL OVERALL.

2- JACK FOR MATING WITH F.C.C. 68 PLUGS (90075 MOLEX SERIES).

3- PRODUCT SPECIFICATION PS-95503-001 AND PS-85505-001 (SECTION 5.2).

4- MANUFACTURING I.D. CAN BE MG, MXF OR MXI.

5- PACKAGING SPECIFICATION PK-95003 SHEET 1:
(TRAY PACKAGING).

6- EXCEEDS CATEGORY 5E PERFORMANCE.

7- APPLICATION SPECIFICATION: AS-85513-001

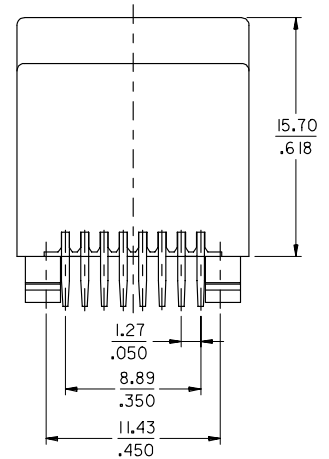
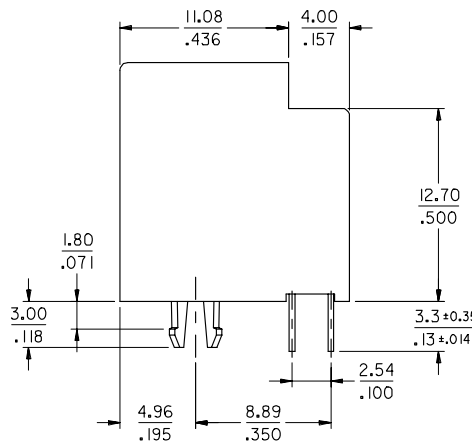
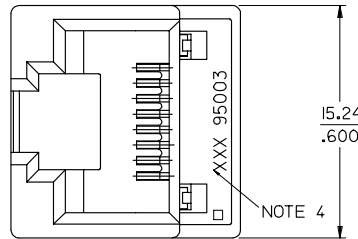

P.C.B. MOUNTING PATTERN
(see from component side)

SCALE 2:1

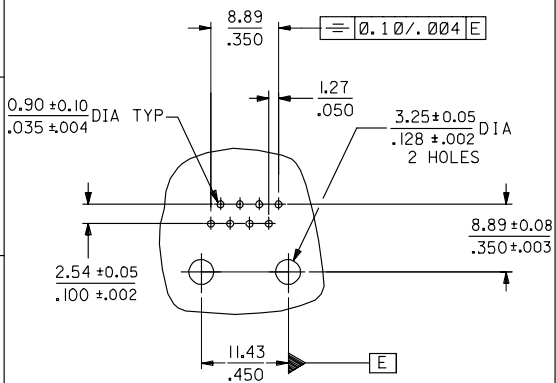

ORIGINAL LCP EC NO: E2007-0837 DRAWN BY: 2007/04/02 CHKD: 2007/04/02 APPR: 2007/04/02	QUALITY SYMBOLS	GENERAL TOLERANCES (UNLESS SPECIFIED) 4 PLACES ± --- ± --- 3 PLACES ± --- ± .006 2 PLACES ± 0.15 ± .010 1 PLACE ± 0.25 ± --- ANGULAR ± 1/2°	DIMENSION STYLE	SCALE	DESIGN UNITS	THIRD ANGLE PROJECTION TITLE: HIGH SPEED MODULAR JACK TOP ENTRY LOW PROFILE THROUGH HOLE 8 CKTS MOLEX INCORPORATED	
	▽=0 ▽=0		MM/IN	4:1	METRIC		
	DRAWN BY: HB CHECKED BY: ER APPROVED BY: FB		DATE: 99/08/18 DATE: 99/08/18 DATE: 99/08/18	MATERIAL NO.	DOCUMENT NO.		SHEET NO.
	DRAFT WHERE APPLICABLE MUST REMAIN WITHIN DIMENSIONS		SIZE: A3 THIS DRAWING CONTAINS INFORMATION THAT IS PROPRIETARY TO MOLEX INCORPORATED AND SHOULD NOT BE USED WITHOUT WRITTEN PERMISSION	85511-5001	SD-85511-501		1 OF 1