

PART NO. SEE CHART
 DIM. NO. SDAE-3003-N*

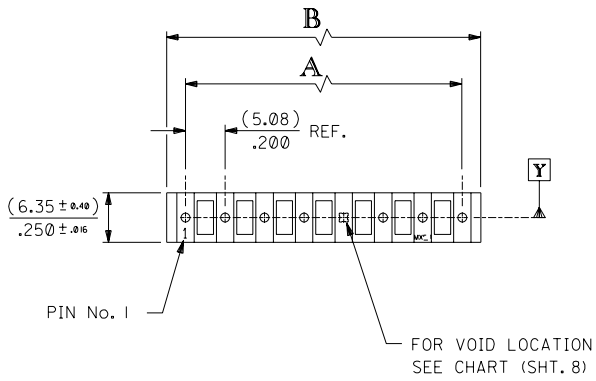

3003-N * - *
 BASE No. VOID CODE
 No. OF CCTS. *
 VERSION * - *

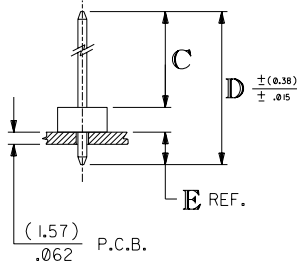
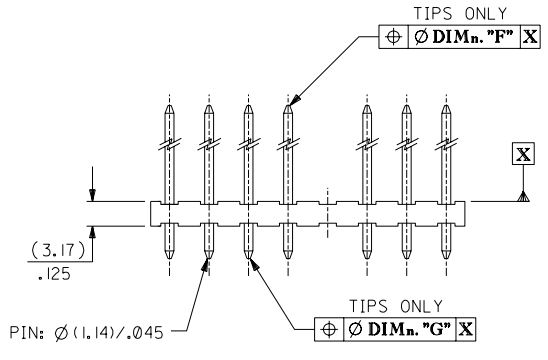
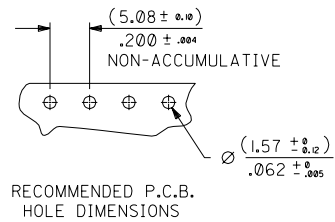

No. OF CCTS.	DIMn. A	DIMn. B
2	(5.08 ± 0.05) .200 ± .002	(9.91 ± 0.15) .390 ± .006
3	(10.16 ± 0.08) .400 ± .003	(14.99 ± 0.15) .590 ± .006
4	(15.24 ± 0.08) .600 ± .003	(20.07 ± 0.18) .790 ± .007
5	(20.32 ± 0.08) .800 ± .003	(25.15 ± 0.20) .990 ± .008
6	(25.40 ± 0.10) 1.000 ± .004	(30.23 ± 0.23) 1.190 ± .009
7	(30.48 ± 0.13) 1.200 ± .005	(35.31 ± 0.25) 1.390 ± .010
8	(35.56 ± 0.20) 1.400 ± .008	(40.39 ± 0.28) 1.590 ± .011
9	(40.64 ± 0.20) 1.600 ± .008	(45.47 ± 0.30) 1.790 ± .012
10	(45.72 ± 0.20) 1.800 ± .008	(50.55 ± 0.30) 1.990 ± .012
11	(50.80 ± 0.20) 2.000 ± .008	(55.63 ± 0.33) 2.190 ± .013
12	(55.88 ± 0.25) 2.200 ± .010	(60.71 ± 0.33) 2.390 ± .013
13	(60.96 ± 0.25) 2.400 ± .010	(65.79 ± 0.36) 2.590 ± .014
14	(66.04 ± 0.25) 2.600 ± .010	(70.87 ± 0.36) 2.790 ± .014
15	(71.12 ± 0.35) 2.800 ± .014	(75.95 ± 0.42) 2.990 ± .017
16	(76.20 ± 0.35) 3.000 ± .014	(81.03 ± 0.42) 3.190 ± .017
17	(81.28 ± 0.40) 3.200 ± .016	(86.11 ± 0.51) 3.390 ± .020
18	(86.36 ± 0.40) 3.400 ± .016	(91.19 ± 0.53) 3.590 ± .021
19	(91.44 ± 0.50) 3.600 ± .020	(96.27 ± 0.53) 3.790 ± .021
20	(96.52 ± 0.50) 3.800 ± .020	(101.35 ± 0.53) 3.990 ± .021

NOTES:

1. MATERIAL: WAFER, NYLON, 94V-2, COLOUR - NATURAL PINS, BRASS (FOR PLATING SEE CHARTS)
2. FOR DIMns. "A","B","C","D","E","F" AND VERSIONS, SEE CHARTS ON SHEET 2 & SUBSEQUENT SHEETS.
3. FOR VERSIONS WITH VOIDS SEE SHEET 8.
4. PIN PUSH OUT FORCE: (1.36Kg)/3lbs MIN.
5. PIN MUST MEET MOLEX SOLDERABILITY SPEC. ES-152.
6. MAX BOW (0.38)/.015 OVER (25.4)/1.00

MODIFIED TOOLS EC NO. 2003-0542 DRW:DBYRNES 02/11/22 CHK: / / / / / APPR: / / / / / REV: BL	QUALITY SYMBOLS MAJOR CRITICAL	GENERAL TOLERANCES: (UNLESS SPECIFIED) mm INCH 4 PLACES ±0.--- ±.--- 3 PLACES ±0.--- ±.010 2 PLACES ±0.25 ±.014 1 PLACE ±0.35 ±.--- ANGULAR: ± 1/2°	SCALE 2 : 1 DESIGN UNITS <input checked="" type="checkbox"/> mm <input type="checkbox"/> INCH DRAWN BY & DATE DBYRNES 02/11/22 CHECKED BY & DATE BMAGUIRE 02/11/22 APPROVED BY & DATE MWILHITE 02/11/22 CAD FILENAME	DIMENSIONS: <input checked="" type="checkbox"/> mm <input type="checkbox"/> INCH <input type="checkbox"/> mm ONLY <input type="checkbox"/> INCH <input type="checkbox"/> mm	SHT REV REVISE ON CAD ONLY	
		THIRD ANGLE PROJECTION	TITLE: 5.08 mm KK Hdr V+ RPin	MATERIAL NO. SEE CHART	DRAWING NO. SDAE-3003-N*	SHEET NO. 1 OF 8
		MOLEX INCORPORATED		THIS DRAWING CONTAINS INFORMATION THAT IS PROPRIETARY TO MOLEX INCORPORATED AND SHOULD NOT BE USED WITHOUT WRITTEN PERMISSION.		SIZE B
		DRAFT WHERE APPLICABLE MUST REMAIN WITHIN DIMENSIONS		THIS DRAWING CONTAINS INFORMATION THAT IS PROPRIETARY TO MOLEX INCORPORATED AND SHOULD NOT BE USED WITHOUT WRITTEN PERMISSION.		SIZE B

7132-1283

INDEX: FOR FULL DIMENSIONS SEE RELEVANT SHEET.

ENG. No.	PLATING	DIM. C	DIM. D	SHT. No.
AE-3003-NA	(102)			3
AE-3003-NAG	(501)	(11.94) / .470	(19.05) / .750	6
AE-3003-NA(503)	(503)			6
AE-3003-NB	(102)	(16.69) / .657	(23.80) / .937	3
AE-3003-NC	(102)			3
AE-3003-NCG	(501)	(23.04) / .907	(30.48) / 1.200	6
AE-3003-ND	(102)			3
AE-3003-NDG	(501)	(27.81) / 1.095	(34.92) / 1.375	6
AE-3003-NF	(102)			3
AE-3003-NFG	(501)	(32.56) / 1.282	(39.68) / 1.562	6
AE-3003-NI	(102)	(13.51) / .532	(20.32) / .800	4
AE-3003-NJ	(102)	(21.46) / .845	(28.58) / 1.125	4
AE-3003-NK	(102)			4
AE-3003-NS	(501)	(18.29) / .720	(25.40) / 1.000	7
AE-3003-NM	(102)	(11.89) / .468	(23.80) / .937	4
AE-3003-NU	(102)	(11.18) / .440	(17.45) / .687	4
AE-3003-NV	(102)	(11.94) / .470	(18.29) / .720	5
AE-3003-NY	(102)	(10.90) / .430	(17.45) / .687	5

FOR VOID VERSIONS SEE SHEET 8.

FOR PREVIOUS DRAWING ISSUES SEE MRI.

BM SEE SHEET 1. LTR REVISIONS	DIMENSIONS SHOWN (METRIC) INCH UNLESS OTHERWISE SPECIFIED TOLERANCES: ANGULAR #2 INCH (METRIC)	DRWG BY GCH	REVISE ONLY ON CAD SYSTEM SH. REV.
	3 PLACE # . # 2 PLACE # . # 1 PLACE # #	CHK'D BY	CAD/DM FILENAME SA3003X2 DGN
	DRAFT WHERE APPLICABLE MUST REMAIN WITHIN DIMENSIONS	APP'D BY	THIS DRAWING CONTAINS INFORMATION THAT IS PROPRIETARY TO MOLEX INC. & SHOULD NOT BE USED WITHOUT WRITTEN PERMISSION
	DESIGN DIMENSION (PRIMARY) <input type="checkbox"/> (MM) EQUIVALENT DIMENSION (SECONDARY) <input type="checkbox"/> (MM) <input type="checkbox"/> IN.	SCALE	TITLE 5.08 mm KK Hdr V+ RPIn
		SHEET NO. DATE 20F 29/8 /86	PART NO. DWG NO. SIZE SEE CHART SDAE-3003-N * B

PART NO. SEE CHART
DWG. NO. SDAE-3003-N*

ENG. NO.	AE-3003-NA		AE-3003-NB		AE-3003-NC		AE-3003-ND		AE-3003-NF		
DIMN. "C"	(11.94 ± 0.51) .470 ± .020		(16.69 ± 0.51) .657 ± .020		(23.04 ± 0.51) .907 ± .020		(27.81 ± 0.51) 1.095 ± .020		(32.56 ± 0.51) 1.282 ± .020		
DIMN. "D"	(19.05) / .750		(23.80) / .937		(30.48) / 1.200		(34.92) / 1.375		(39.68) / 1.562		
DIMN. "E"	(3.94) / .155		(3.94) / .155		(4.27) / .168		(3.94) / .155		(3.94) / .155		
DIMN. "F"	(1.02) / .040		(1.02) / .040		(1.02) / .040		(1.02) / .040		(1.02) / .040		
DIMN. "G"	(1.02) / .040		(1.02) / .040		(1.02) / .040		(1.02) / .040		(1.02) / .040		
PLATING	(102) TIN (5.0µM)/.000200 MIN. OVER COPPER (2.5µM)/.000100 MIN.		(102) TIN (5.0µM)/.000200 MIN. OVER COPPER (2.5µM)/.000100 MIN.		(102) TIN (5.0µM)/.000200 MIN. OVER COPPER (2.5µM)/.000100 MIN.		(102) TIN (5.0µM)/.000200 MIN. OVER COPPER (2.5µM)/.000100 MIN.		(102) TIN (5.0µM)/.000200 MIN. OVER COPPER (2.5µM)/.000100 MIN.		
	PART NO.	ENG NO.	PART NO.	ENG NO.	PART NO.	ENG NO.	PART NO.	ENG NO.	PART NO.	ENG NO.	
	2	10-08-1021	AE-3003-2A	10-08-1022	AE-3003-2B	10-08-1023	AE-3003-2C	10-08-1024	AE-3003-2D	10-08-1026	AE-3003-2F
	3	↑ -1031	↑ -3A	↑ -1032	↑ -3B	↑ -1033	↑ -3C	↑ -1034	↑ -3D	↑ -1036	↑ -3F
	4	↑ -1041	↑ -4A	↑ -1042	↑ -4B	↑ -1043	↑ -4C	↑ -1044	↑ -4D	↑ -1046	↑ -4F
	5	↑ -1051	↑ -5A	↑ -1052	↑ -5B	↑ -1053	↑ -5C	↑ -1054	↑ -5D	↑ -1056	↑ -5F
	6	↑ -1061	↑ -6A	↑ -1062	↑ -6B	↑ -1063	↑ -6C	↑ -1064	↑ -6D	↑ -1066	↑ -6F
	7	↑ -1071	↑ -7A	↑ -1072	↑ -7B	↑ -1073	↑ -7C	↑ -1074	↑ -7D	↑ -1076	↑ -7F
	8	↑ -1081	↑ -8A	↑ -1082	↑ -8B	↑ -1083	↑ -8C	↑ -1084	↑ -8D	↑ -1086	↑ -8F
	9	↑ -1091	↑ -9A	↑ -1092	↑ -9B	↑ -1093	↑ -9C	↑ -1094	↑ -9D	↑ -1096	↑ -9F
	10	↑ -1101	↑ -10A	↑ -1102	↑ -10B	↑ -1103	↑ -10C	↑ -1104	↑ -10D	↑ -1106	↑ -10F
	11	↑ -1111	↑ -11A	↑ -1112	↑ -11B	↑ -1113	↑ -11C	↑ -1114	↑ -11D	↑ -1116	↑ -11F
	12	↑ -1121	↑ -12A	↑ -1122	↑ -12B	↑ -1123	↑ -12C	↑ -1124	↑ -12D	↑ -1126	↑ -12F
	13	↑ -1131	↑ -13A	↑ -1132	↑ -13B	↑ -1133	↑ -13C	↑ -1134	↑ -13D	↑ -1136	↑ -13F
	14	↑ -1141	↑ -14A	↑ -1142	↑ -14B	↑ -1143	↑ -14C	↑ -1144	↑ -14D	↑ -1146	↑ -14F
	15	↑ -1151	↑ -15A	↑ -1152	↑ -15B	↑ -1153	↑ -15C	↑ -1154	↑ -15D	↑ -1156	↑ -15F
	16	↑ -1161	↑ -16A	↑ -1162	↑ -16B	↑ -1163	↑ -16C	↑ -1164	↑ -16D	↑ -1166	↑ -16F
	17	↑ -1171	↑ -17A	↑ -1172	↑ -17B	↑ -1173	↑ -17C	↑ -1174	↑ -17D	↑ -1176	↑ -17F
	18	↑ -1181	↑ -18A	↑ -1182	↑ -18B	↑ -1183	↑ -18C	↑ -1184	↑ -18D	↑ -1186	↑ -18F
	19	↑ -1191	↑ -19A	↑ -1192	↑ -19B	↑ -1193	↑ -19C	↑ -1194	↑ -19D	↑ -1196	↑ -19F
	20	10-08-1201	AE-3003-20A	10-08-1202	AE-3003-20B	10-08-1203	AE-3003-20C	10-08-1204	AE-3003-20D	10-08-1206	AE-3003-20F

NO. OF CIRCUITS

FOR PREVIOUS
DRAWING ISSUES
SEE MRI.

BK SEE SHEET 1.

THIRD ANGLE PROJECTION		REVISE ONLY ON CAD SYSTEM		SH. REV.
DIMENSIONS SHOWN (METRIC) INCH UNLESS OTHERWISE SPECIFIED TOLERANCES: ANGULAR #2 INCH (METRIC) 3 PLACE ± # 2 PLACE ± # 1 PLACE ± # DRAFT WHERE APPLICABLE MUST REMAIN WITHIN DIMENSIONS DESIGN DIMENSION <input type="checkbox"/> (MM) (PRIMARY) <input type="checkbox"/> IN. EQUIVALENT DIMENSION <input type="checkbox"/> (MM) (SECONDARY) <input type="checkbox"/> IN.		DRWG BY GCH CHK'D BY APP'D BY SCALE	CAD FILE NAME SA3003X3 DGN THIS DRAWING CONTAINS INFORMATION THAT IS PROPRIETARY TO MOLEX INC. & SHOULD NOT BE USED WITHOUT WRITTEN PERMISSION TITLE 5.08 mm KK Hdr V+ RPIN	SHEET NO. DATE 30F 29/8 /86
PART NO. SEE CHART		DWG NO. SDAE-3003-N*		SIZE B

7132-1283