

**D-4000 Series (Wire-to-Board, Wire-to-Panel and Wire-to-Wire)**

**Product Facts**

- 20A of current is achievable with the use of 3-position connectors
- Newly designed contacts with four contact points
- Dynamic 4000 Series achieved a 50% or greater improvement in current values compared with the Dynamic 3000 Series. At the same time, mating height increased only approximately 14%
- Current capacity per unit volume is also higher by approximately 32%
- Wire-to-board type (2-, 3- and 4-position) and wire-to-wire type (3-position). This flexible line-up will help meet customer demands. Sequential pins are also available.

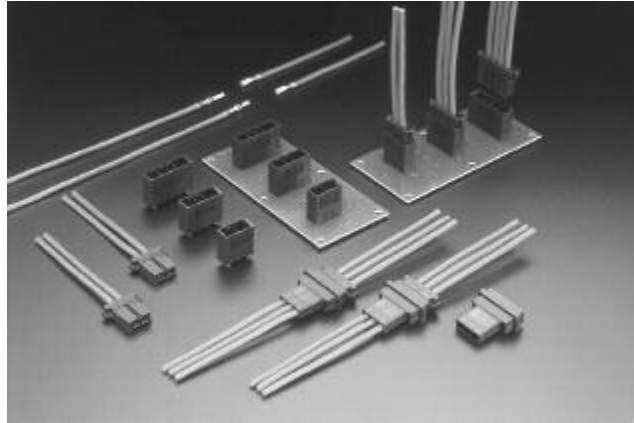

**Material and Finish**

**Receptacle Contact** — Phosphor bronze or copper alloy, gold plated with 0.38 µm nickel underplate

**Tab Contact** — Phosphor bronze or copper alloy, gold plated with 0.38 µm nickel underplate

**Tab Post** — Phosphor bronze or copper alloy, tin plated on contact area and gold plated with nickel underplate

**Housing** — Glass filled polyester (PBT), UL 94V-0

**Performance Characteristics**

**Pitch** — 6.35 mm (250 mils)

**Voltage Rating** — 600 V (rms)

**Current Rating** — 2-position: 24 A; 3-position: 23 A; 4-position: 22 A (when using #12 AWG wire)

**Contact Resistance** — 10 mΩ Max.

**Dielectric Withstanding Voltage** — 2,500 V (1 minute)

**Operating Temperature** — -55°C ~ +105°C

**Technical Documents**

**Product Specification**  
108-78182

**Application Specification**  
114-5362

D-4000 Series

**D-4 Contact**

0.38µm thick gold plating

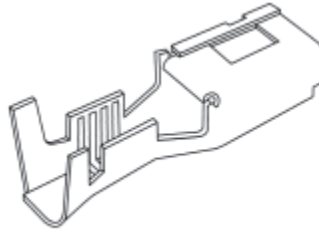

**Receptacle Contact**  
(Used in Receptacle Housing)

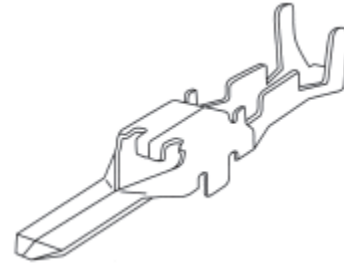

**Tab Contact**  
(Used in Tab Housing)

Applicable Wire Range		Ins. Dia. Range mm	Wire Range Mark	Contact Part Numbers			Application Tooling	
AWG	mm <sup>2</sup>			Receptacle	Tab	Sequential Long Tab	Mini-Applicator	Hand Tool
16	1.25	2.0~3.75	M	ST. 1747418-2	1747419-2	1-1747419-2	1762120-2	—
14	2.20			LP. 1747499-2	1747501-2	1-1747501-2	—	1762130-1
14	2.20	2.9~4.1	L	ST. 1747415-2	1747416-2	1-1747416-2	1762119-2	—
12	3.50			LP. 1747498-2	1747500-2	1-1747500-2	—	1762129-1

**Notes:** Minimum order quantity for tooling is one.  
Extraction Tool Part Number 1762461-1 (411-78186)  
Mini-Applicator is for use on Automachine.  
Strip Form contacts are used with Mini-Applicator and Loose-Piece contacts are with hand tools.

**D-4000 Series** (Continued)

**D-4200**

**Mating Dimensions**

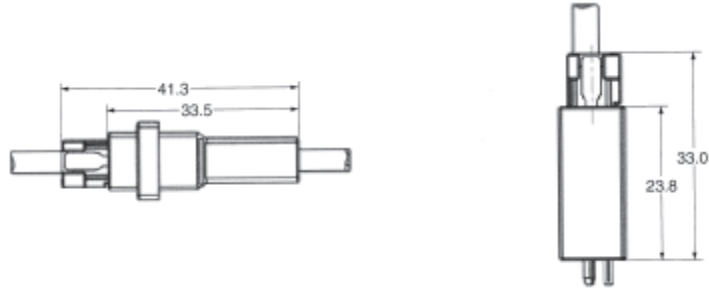

**Receptacle Housing**

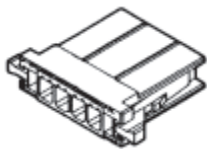

**Mating Tab Housings**

**Part Number:**

□-1747535-□

□-1747414-□

□-1747277-□

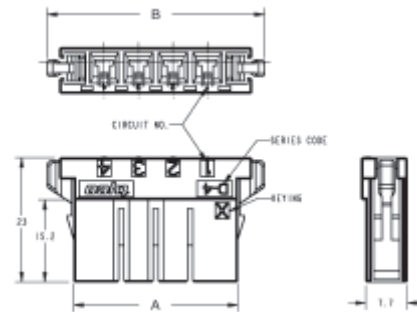

No. of Pos.	Part Number		Dimensions	
	Keying : X	Keying : Y	A	B
2	1-1747276-2	2-1747276-2	17.55	27.35
3	1-1747276-3	2-1747276-3	23.90	33.70
4	1-1747276-4	2-1747276-4	30.25	40.05

**Tab Housing**

**Free-hanging Type**

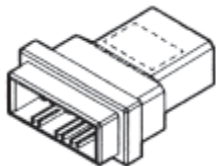

**Mating Receptacle Housing**

**Part Number:**

□-1747276-□

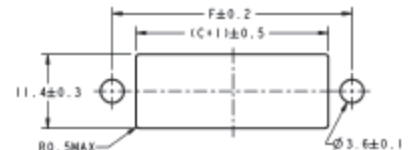
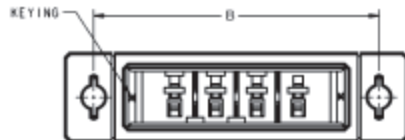

**Panel Cutout**

**Panel Type**

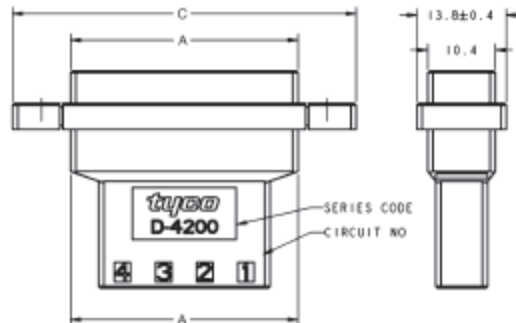
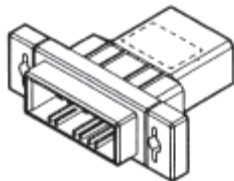

No. of Pos.	Part Number Keying : X		Part Number Keying : Y		Dimensions		
	Panel Type	Free-hanging Type	Panel Type	Free-hanging Type	A	B	C*
3	1-1747535-3	1-1747414-3	2-1747635-3	2-1747414-3	28.7	32.7	46.0

\*Applicable to Panel Type only.

**D-4000 Series** (Continued)

**D-4200** (Continued)

**Board-mounting Tab Header  
(Vertical Type)**

**Mating Receptacle Housing  
Part Number:  
□-1747276-□**

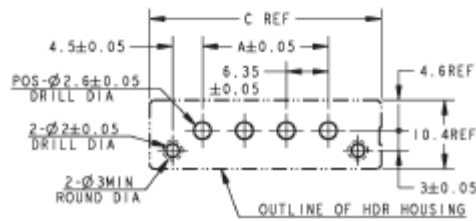
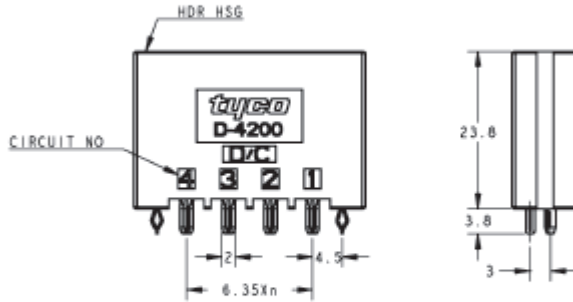
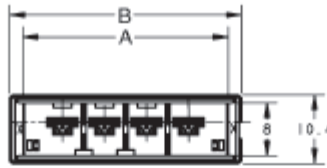
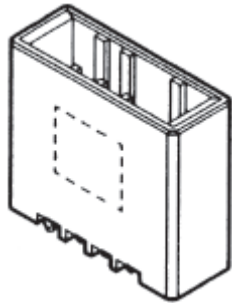

**PC Board Layout**  
Acceptable Board Thickness:  
1.6-2.4

No. of Pos.	Part Number		Dimensions	
	Keying : X	Keying : Y	A	B
2	1-1747277-2	2-1747277-2	18.35	22.35
3	1-1747277-3	2-1747277-3	24.70	28.70
4	1-1747277-4	2-1747277-4	31.05	35.05

D-4000 Series

**D-5200 Series (Wire-to-Board, Wire-to-Panel and Wire-to-Wire)**

**D-5200S**

High-Pressure  
1-Row Type

List of Dynamic Series Products by Application

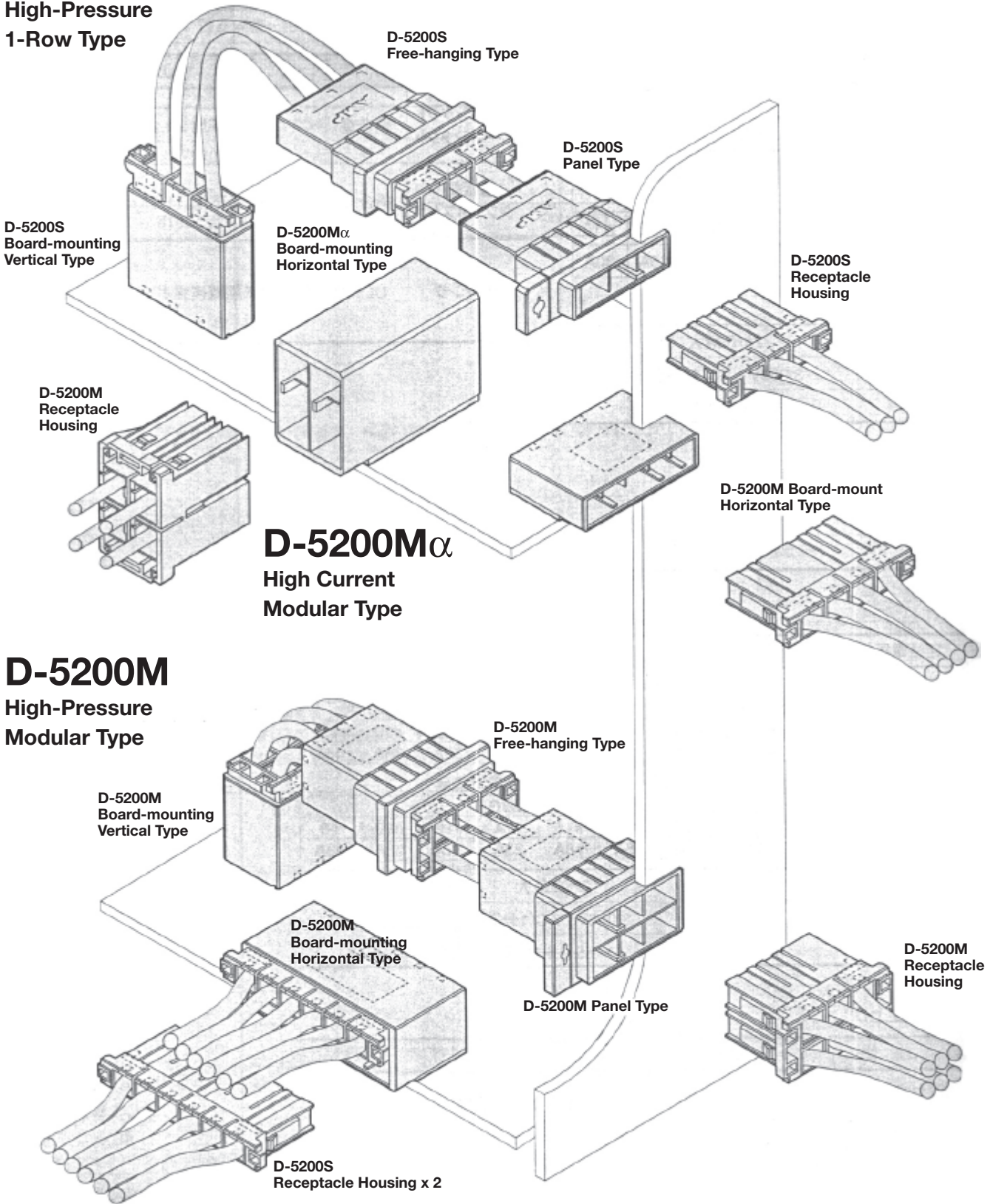

**D-5200M**

High-Pressure  
Modular Type

**D-5200Mα**

High Current  
Modular Type

D-5000 Series

**D-5200 Series** (Continued)

**Performance Characteristics and Specifications**
**D-5200S/M Performance Characteristics**

Pitch	400mils (10.16mm)														
<b>Description</b>															
<b>Voltage Rating</b>	630V AC														
<b>Current Rating</b>	<table border="1"> <thead> <tr> <th rowspan="2">Wire</th> <th colspan="4">AWG</th> </tr> <tr> <th>#16</th> <th>#14</th> <th>#12</th> <th>#10</th> </tr> </thead> <tbody> <tr> <td>Current</td> <td>16A</td> <td>19A</td> <td>25A</td> <td>30A</td> </tr> </tbody> </table> 6 position max.	Wire	AWG				#16	#14	#12	#10	Current	16A	19A	25A	30A
Wire	AWG														
	#16	#14	#12	#10											
Current	16A	19A	25A	30A											
<b>Contact Resistance</b>	2mΩ Max.														
<b>Dielectric Withstanding Voltage</b>	3,000V AC (1 minute)														
<b>Operating Temperature</b>	-55°~+105°C														

**Material and Finish**

Description	Material	Finish
<b>Receptacle Contact Tab Contact</b>	Copper alloy	Gold plating with underplated nickel
<b>Tab Post</b>	Copper alloy	Gold plating with underplated nickel
<b>Housing</b>	UL 94V-0 rated, glass filled polyester (PBT)	

**D-5200M $\alpha$  Performance Characteristics**

Pitch	400mils (10.16mm)																																														
<b>Description</b>																																															
<b>Voltage Rating</b>	630V AC																																														
<b>Current Rating</b>	Current for 3-pos. silver-plated contacts <table border="1"> <thead> <tr> <th rowspan="2">Wire</th> <th colspan="7">AWG</th> </tr> <tr> <th>#20</th> <th>#18</th> <th>#16</th> <th>#14</th> <th>#12</th> <th>#10</th> <th>#8</th> </tr> </thead> <tbody> <tr> <td>Current</td> <td>12A</td> <td>16A</td> <td>20A</td> <td>25A</td> <td>33A</td> <td>38A</td> <td>45A</td> </tr> </tbody> </table> Current for 4-pos. silver-plated contacts <table border="1"> <thead> <tr> <th rowspan="2">Wire</th> <th colspan="7">AWG</th> </tr> <tr> <th>#20</th> <th>#18</th> <th>#16</th> <th>#14</th> <th>#12</th> <th>#10</th> <th>#8</th> </tr> </thead> <tbody> <tr> <td>Current</td> <td>12A</td> <td>15A</td> <td>18A</td> <td>23A</td> <td>31A</td> <td>35A</td> <td>43A</td> </tr> </tbody> </table>	Wire	AWG							#20	#18	#16	#14	#12	#10	#8	Current	12A	16A	20A	25A	33A	38A	45A	Wire	AWG							#20	#18	#16	#14	#12	#10	#8	Current	12A	15A	18A	23A	31A	35A	43A
Wire	AWG																																														
	#20	#18	#16	#14	#12	#10	#8																																								
Current	12A	16A	20A	25A	33A	38A	45A																																								
Wire	AWG																																														
	#20	#18	#16	#14	#12	#10	#8																																								
Current	12A	15A	18A	23A	31A	35A	43A																																								
<b>Contact Resistance</b>	2mΩ Max.																																														
<b>Dielectric Withstanding Voltage</b>	3,000V AC (1 minute)																																														
<b>Operating Temperature</b>	-55°~+105°C																																														

**Material and Finish**

Description	Material	Finish
<b>Receptacle Contact Tab Contact</b>	Copper alloy	Silver plating with underplated nickel
<b>Tab Post</b>	Copper alloy	Silver plating with underplated nickel
<b>Housing</b>	UL 94V-0 rated, glass filled polyester (PBT)	

**D-5200 Series** (Continued)

**Performance Characteristics and Specifications** (Continued)

**Technical Documents Specifications and Instruction Sheets**

<b>Product Specification</b>		108-5453
<b>Test Report</b>		501-5188
<b>Application Specification</b>		114-5206
<b>Hand Tool Instruction Sheets</b>	Crimping Tool P/N : <b>234170-1</b>	411-5712
	Crimping Tool P/N : <b>234171-1</b>	411-5713
	Crimping Tool P/N: <b>1366656-1</b>	411-5969
	Crimping Tool P/N: <b>1366044-1</b>	411-5976
<b>Extraction Tool (Part Number 409158-1) Instruction Sheet</b>		411-5774

\*Don't fail to obtain Instruction Sheets and other appropriate papers when you adopt our products.

**Safety Specifications**

The following safety specifications are applicable to specific Part Numbers. Contact Technical Support to check if approval is given for each Part Number you are using. Note that there are instances where values differ from those given in Tyco Electronics Performance Data.

	D-5200 Series (400 mil, 10.16mm pitch)			D-5200M $\alpha$ Series		
	Voltage Rating	Current Rating	Temperature Rating	Voltage Rating	Current Rating	Temperature Rating
<b>Specification 108-5453</b>	630V AC	See preceding page	-55°~+105°C	—	See preceding page	-55°~+105°C
<b>UL File No. E28476 (Recognized Component)</b>	Determined by requirements of equipment in use.	Determined by requirements of equipment in use.	—	—	Determined by requirements of equipment in use.	—
<b>CSA Report No. LR7189</b>	600V AC	AWG	—	—	—	—
		A				
		16 13				
		14 18				
	12 25					
	10 30					
<b>TÜV License No. R9650368 IP Protection IP-10 Overvoltage Classification (II) Number of repeated insertions and withdrawals allowed: 50 times.</b>	600V AC	AWG	-30°~+105°C	—	Pos.	-30°~+105°C
		A				
		16 15				
		14 20				
		12 25				
		10 30				
		20 12.5 12.5				
		18 17.5 16				
	16 21 19.5					
	14 26 24					
	12 33 31					
	10 40 37.5					
	8 48 46					

**D-5200 Series** (Continued)

**Crimp Type Contacts**

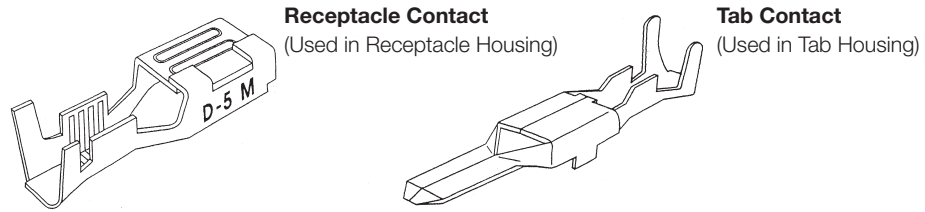

**D-5 Contacts**

Wire Range		Ins. Dia. Range mm	Wire Range Mark	Contact Part Numbers*			Application Tooling		
AWG	mm <sup>2</sup>			Receptacle	Tab	Sequential Tab	Mini-Applicator	Hand Tool	
16	1.25	3~3.8	S	ST.	179955-□	917802-□	84696-1	**	—
14	2.20			LP.	316040-□	917804-□	—	—	234170-1
12	3.50	4~5.2	M	ST.	179956-□	917803-□	84695-1	**	—
10	5.50			LP.	316041-□	917805-□	—	—	234171-1

Note: Enter the following plating code in Part Number suffix-□:  
 -2 = 0.38 μm thick gold plating, -3 = 0.76μm thick gold plating,  
 -6 = 2.54 μm thick silver plating

\* Strip Form contacts are used with Mini-Applicator and Loose-Piece contacts are with hand tools.

\*\*Mini-Applicator is for use on Automachines. (See next page. Contact Technical Support for details.)

**D-5α Contacts (Silver Plating)**

Wire Range		Ins. Dia. Range mm	Wire Range Mark	Contact Part Numbers*		Application Tooling	
AWG	mm <sup>2</sup>			Receptacle	Mini-Applicator	Hand Tool	
20	0.50	1.8~3.23	SS	ST.	1318985-6	**	—
16	1.25			LP.	1318986-6	—	91596-1
16	1.25	3~3.80	S	ST.	179955-6	**	—
14	2.20			LP.	316040-6	—	234170-1
12	3.50	4~5.2	M	ST.	179956-6	**	—
10	5.50			LP.	316041-6	—	234171-1
8	8.00	4.9~7.8	L	ST.	1318696-6	**	—
				LP.	1318697-6	—	1366044-1

Note: The contact part numbers with "-6" are silver plated with 2.54 μm thickness.

\* Strip Form contacts are used with Mini-Applicator and Loose-Piece contacts are with hand tools.

\*\*Mini-Applicator is for use on Automachines. (See next page. Contact Technical Support for details.)

**Application Tooling**

**Extraction Tool**  
**Part Number: 409158-1**  
 Instruction Sheet 411-5774

- Used to extract contacts from wire type tab / receptacle housing.  
 (Take care when inserting tool as the lance section of D-5 is turned upside down to that of D-3.)
- With D-5 contacts only, it is possible to extract using a small-size slotted screwdriver.

**• How to Use Extraction Tool**

- 
- ① Insert Extraction Tool in the direction as shown, insert into the narrow lower section of Housing's reverse convex hole. (make sure that you are holding tool in proper position, top and bottom.)
- \* Take care not to insert tool into contact section. If you've inserted by error, replace the contact with a new one before proceeding.

**When Using D-5 Extraction Tool**

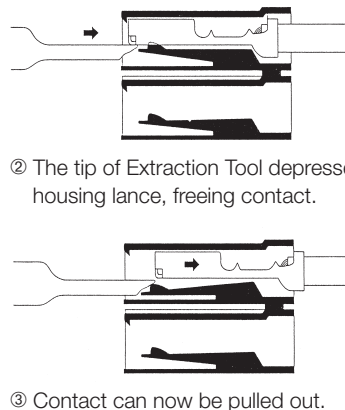

**When Using Slotted Screwdriver**

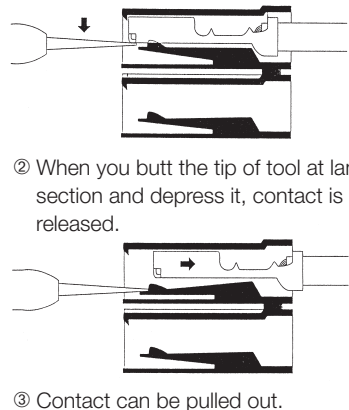

**D-5200 Series** (Continued)

**Application Tooling**

(Continued)

**AMP-3K/40 and AMP-5K/40 Terminating Machines**

The AMP-3K/40 and AMP-5K/40 Terminators are designed for customers that require the increased output and quality of a semi-automatic machine at a competitive price. By incorporating the most commonly requested features as standard and offering a long list of optional equipment, these terminators offer flexibility to meet the specific needs of various applications at the lowest possible cost.

- 3,000 lb. [1361 kg] max. crimp force (AMP-3K/40)
- 5,000 lb. [2268 kg] max. crimp force (AMP-5K/40)
- Toolless removal of applicators and guards
- Jog capability
- Quiet, fast operation — 80/76 dBA and cycle time less than 0.400 seconds
- Accepts Heavy Duty Mini style applicators
- Wide range of optional equipment such as toolless precision crimp height adjust, batch counter, CQM capability and work light
- Order Catalog 1654856 for specifications and part numbers

**Hand Tool**

The crimping section incorporates Straight Action construction for improved reliability as with automachine.



**Part No.:**

See the preceding page.

**Minimum order quantity: 1**



Mini-Applicator

**Part Number:** Contact Technical Support

**Minimum order quantity: 1**

**AMP-O-LECTRIC Model G Terminating Machine**

The Model "G" Terminator is the most advanced design in the long-standing series of AMP-O-LECTRIC machines for terminating wire using reeled terminals and contacts. It features a reliable direct motor drive system. Its modular construction enables it to be used either as a bench-top unit, or in combination with fully-automatic lead-making equipment. For operator convenience, access to and lighting in the target area has been improved and the Crimp Quality Monitor (CQM) has been moved to eye level for bench-top use. The Model "G" is also quieter, plus improved guarding meets applicable European and domestic safety requirements.

- Quieter
- Improved guarding and lighting
- Toolless changeover of applicators
- Precision manual- or auto-adjust for crimp height
- Total and batch counter
- Accepts all existing Tyco Electronics miniature applicators, with minor modifications
- Reduced maintenance requirements
- Request Catalog 65828 for specifications and part numbers



Mini-Applicator

**Part Number:** Contact Technical Support.

**Minimum order quantity: 1**

**Mounting Hardware**

**Attachment**

**Sequential Clip**

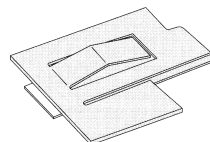

**Part Number: 179993-1**

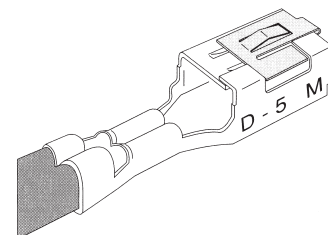



**D-5200 Series** (Continued)

**D-5200S — Standard 1-Row Type**

**Appearance** Board mounting pitch: 400mils (10.16mm)  
Dielectric Withstanding Voltage: 3,000V (for one minute)  
Voltage Rating: 630V AC

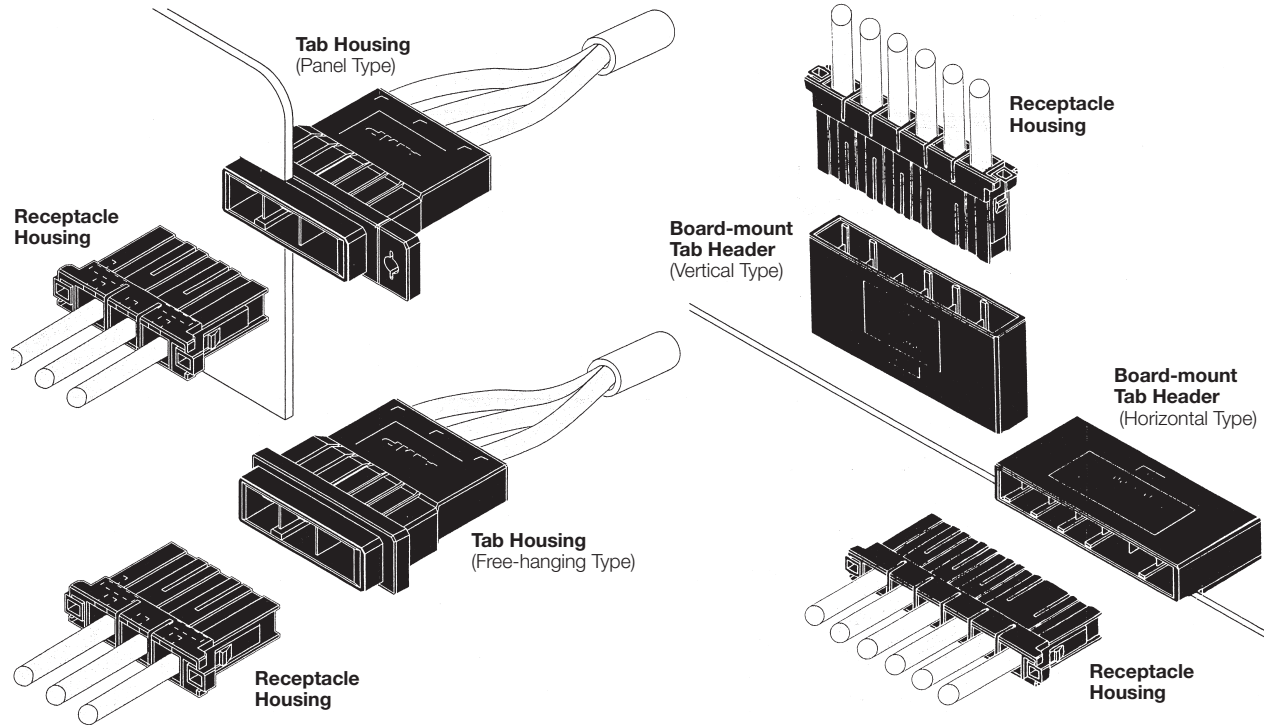

D-5000 Series

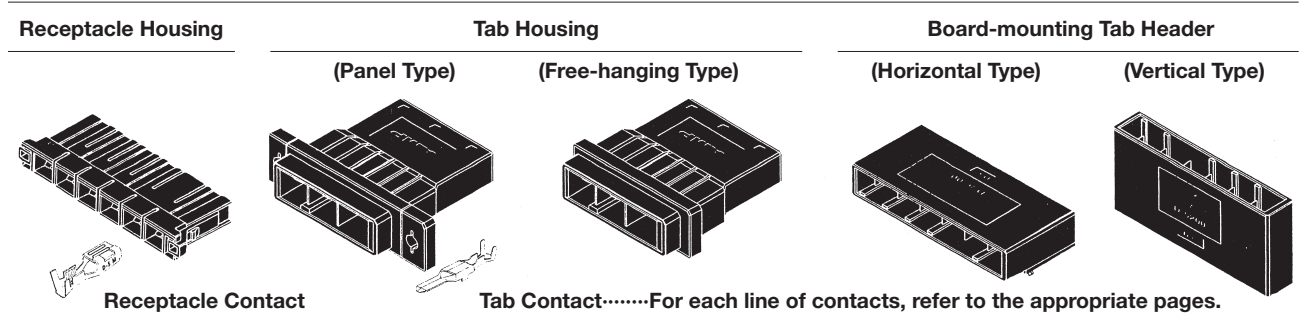

Receptacle Contact

Tab Contact.....For each line of contacts, refer to the appropriate pages.

No. of Pos.	Keying	Part Number of Receptacle Housings	Part Number of Tab Housings		Part Number Board-mounting Tab Headers				
			Panel Type	Free-hanging Type	Horizontal Type	Sequential Type	Vertical Type	Sequential Type	
2	X	1-179958-2	1-353047-2	1-353046-2	1-353079-□	—	1-353080-□	—	
	Y	2-179958-2	2-353047-2	2-353046-2	2-353079-□	—	2-353080-□	—	
3	X	1-179958-3	1-353047-3	1-353046-3	1-353081-□	8-350381-2	1-353082-□	8-353082-2	
	Y	2-179958-3	2-353047-3	2-353046-3	2-353081-□	9-350381-2	2-353082-□	9-353082-2	
4	X	1-179958-4	Use low 4- and 6-position D-5200MS, 4- and 6-position Panel and Free-hanging Types.		1-917541-□	8-917541-2	1-917542-□	8-917542-2	
	Y	2-179958-4			2-917541-□	9-917541-2	2-917542-□	9-917542-2	
5	X	—			—	—	—	—	—
	Y	—			—	—	—	—	—
6	X	1-179958-6			1-179959-□	—	1-179960-□	—	—
	Y	2-179958-6			2-179959-□	—	2-179960-□	—	—

**Note:** Enter the following plating code in Part Number suffix-□  
-2 = 0.38 μm thick gold plating  
-3 = 0.76 μm thick gold plating

**D-5200 Series** (Continued)

**D-5200S — Standard**  
**1-Row Type** (Continued)

**Keying**

Keying is provided with this product (D-5200S) to help prevent misinsertion. Two types, X and Y, are available. (Shown below is the mated interface of Tab Header.)



**Application**

**Servomotor / servodriver—Typical Application**

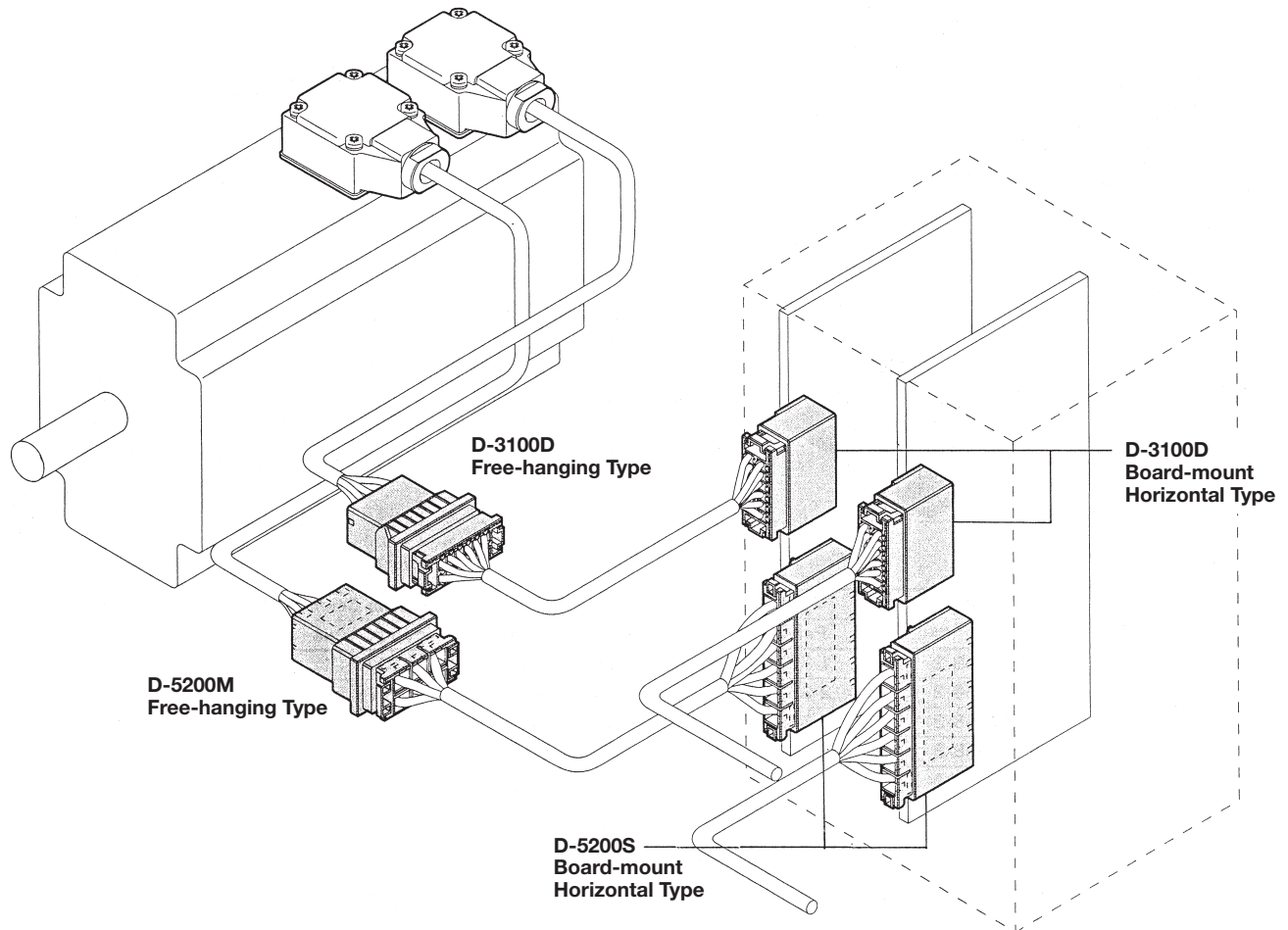

D-5000 Series

**D-5200 Series** (Continued)

**D-5200S — Standard**  
**1-Row Type** (Continued)

**Mating Dimensions**

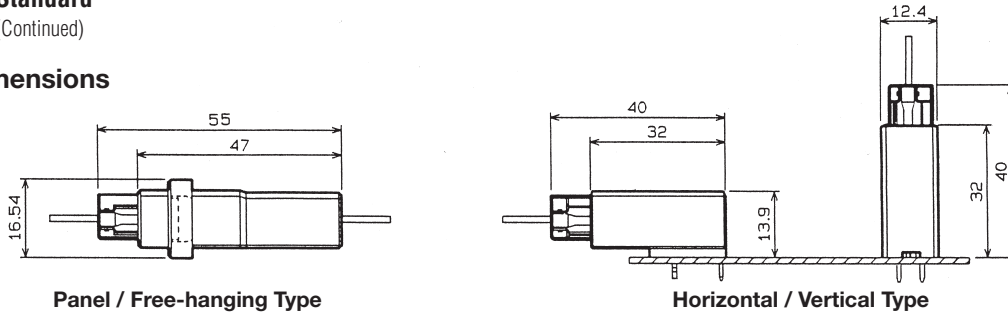

**External Dimensions**  
**Receptacle Housing**

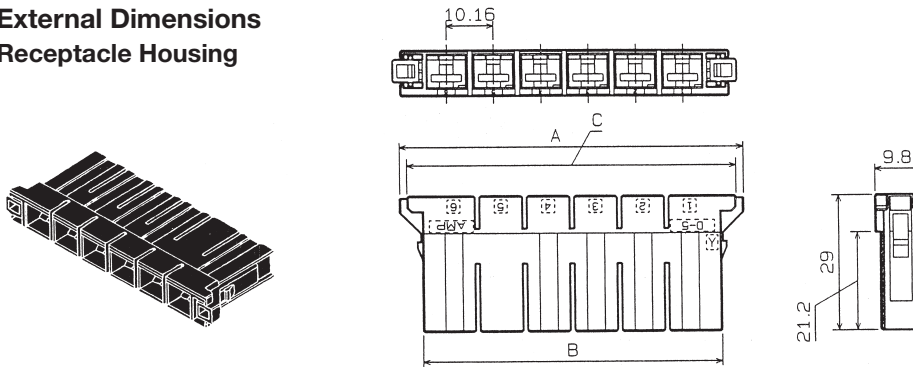

**Mating Tab Connector**  
**Part Number:**

- 353047-□
- 353046-□
- 353079-□
- 353081-□
- 917541-□
- 179959-□
- 353080-□
- 353082-□
- 917542-□
- 179960-□

No. of Positions	Part Number of Receptacle Housing	Dimensions	
		A	B
2	□-179958-2	35.76	23.76
3	□-179958-3	45.92	33.92
4	□-179958-4	53.68	44.08
5	—	—	—
6	□-179958-6	74.00	64.40

**Tab Housing**

**Panel Type**

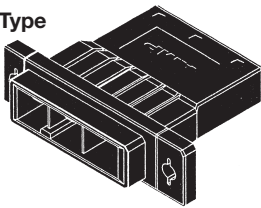

**Mating Receptacle Housing**  
**Part Number:**  
□-179958-□

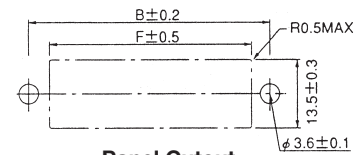
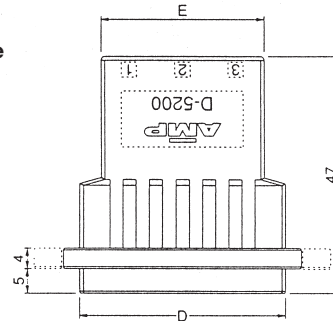

**Panel Cutout**

When mounting panel from the front, apply clamping torque of less than 49N [11 lbf].

**Free-hanging Type**

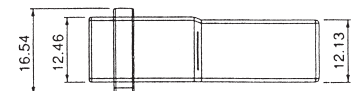
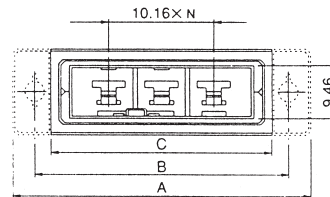
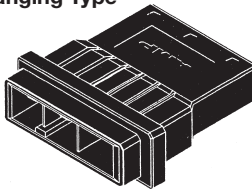

No. of Pos.	Part Number of Tab Housing		Dimensions					
	Panel Type	Free-hanging Type	A	B	C	D	E	F
2	□-353047-2	□-353046-2	47	38	33.44	29.36	21.11	30.4
3	□-353047-3	□-353046-3	57	48	43.6	39.52	31.27	40.5

**D-5200 Series (Continued)**

**D-5200S — Standard 1-Row Type (Continued)**

**Board-mount Tab Header (Horizontal Type)**

Mating Receptacle Housing  
Part Number:  
□-179958-□

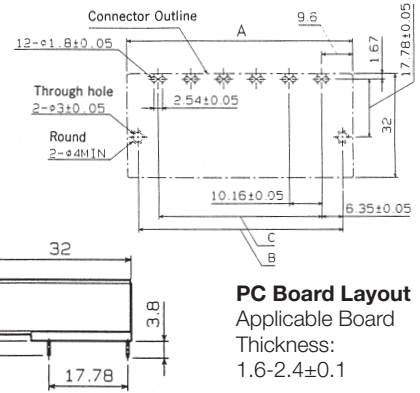
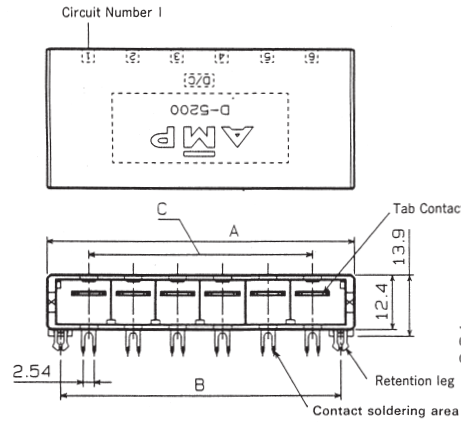
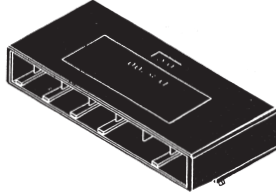

**PC Board Layout**  
Applicable Board  
Thickness:  
1.6-2.4±0.1

No. of Pos.	Part Number of Tab Header	Dimensions		
		A	B	C
2	□-353079-□	29.36	22.86	10.16
3	□-353081-□	39.52	33.02	20.32
4	□-917541-□	49.68	43.18	30.48
5	—	—	—	—
6	□-179959-□	70.00	63.50	50.80

**Tube Package Dimensions (Ref.)**

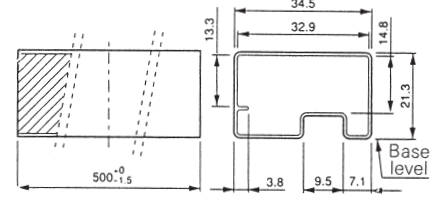

**Board-mount Tab Header (Vertical Type)**

Mating Receptacle Housing  
Part Number:  
□-179958-□

**PC Board Layout**  
Applicable Board  
Thickness: 1.6-2.4±0.1

**Standard Type**

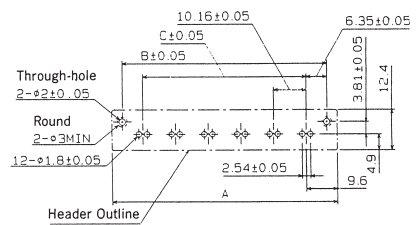
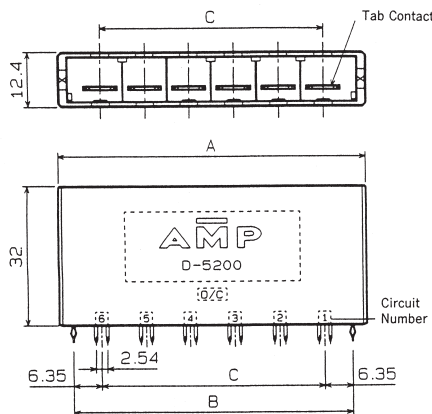
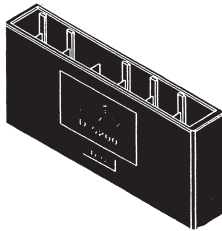

**Sequential Type**

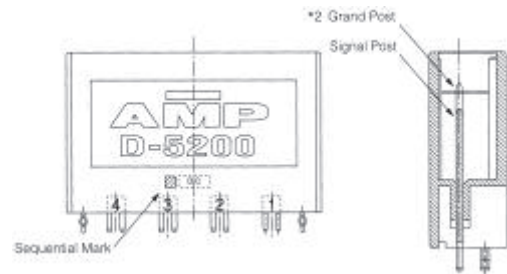

No. of Pos.	Part Number		Dimensions		
	Standard Type	Sequential Type	A	B	C
2	□-353080-□	—	29.36	22.86	10.16
3	□-353082-□	□-353082-2*1	39.52	33.02	20.32
4	□-917542-□	□-917542-2*1	49.68	43.18	30.48
5	—	—	—	—	—
6	□-179960-□	—	70.00	63.50	50.80

**Tube Package Dimensions (Ref.)**

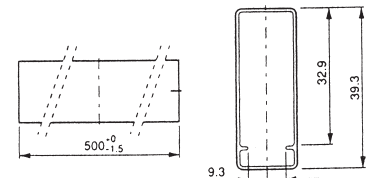

\*1 In the of the sequential type, enter 8- for X type, and enter 9- for Y type.  
\*2 For the 3 pos. connector assembly, the sequential post is inserted in the circuit No. 3.  
For the 4 pos. connector assembly, the sequential post is inserted in the circuit No. 4.

**D-5200 Series** (Continued)

**D-5200M — Modular Type**

**D-5200M—Can be used for modular application in conjunction with D-5200S. Also used for power distribution.**

Board mounting pitch: 400x400mils (10.16x10.16mm)  
 Dielectric Withstanding Voltage: 3,000V (for one minute)  
 Voltage Rating: 630V AC (when one connector is used)

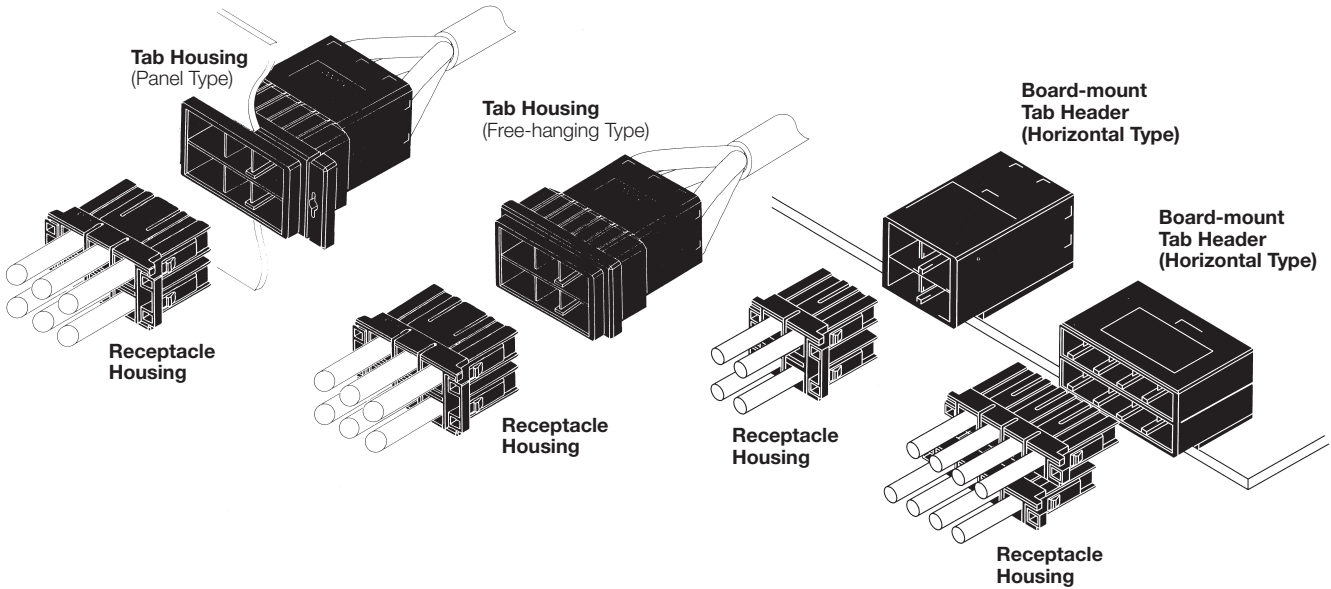

D-5000 Series

**Receptacle Housing**

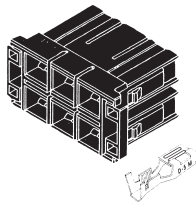

**Receptacle Contact**

**Tab Housing**

(Panel Type)

(Free-hanging Type)

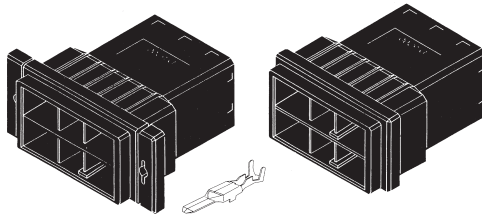

**Tab Contact.....For each line of contacts, refer to the appropriate page.**

**Board-mounting Tab Header**

(Horizontal Type)

4 Pos.

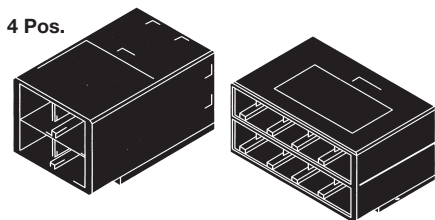

8 Pos.

No. of Pos.	Keying	Part Number of Receptacle Housings	Part Number of Tab Housing		Board-mounting Tab Header	
			Panel Type	Free-hanging Type	Horizontal Type	Sequential Type
4	XX	1-917807-2	1-917809-2	1-917808-2	1-1123309-□	8-1123309-2
	YY	2-917807-2	2-917809-2	2-917808-2	2-1123309-□	9-1123309-2
	XY	3-917807-2	3-917809-2	3-917808-2	3-1123309-□	5-1123309-2
6	XX	1-917807-3	1-917809-3	1-917808-3	—	—
	YY	2-917807-3	2-917809-3	2-917808-3	—	—
	XY	3-917807-3	3-917809-3	3-917808-3	—	—
8	XX	—	—	—	1123829-1*	—

**Note:** Enter the following plating code in Part Number suffix-□ :  
 -2 = 0.38 μm thick gold plating  
 -3 = 0.76 μm thick gold plating

\*This connector is made by 2 pieces of 4 pos. connectors.

**D-5200 Series** (Continued)

**D-5200M — Modular Type**

(Continued)

**Keying**

Keying is provided with this product (D-5200M) to help prevent misinsertion. Three types, XX, YY, and XY, are available. (Shown below is the mated interface of Tab Header.)

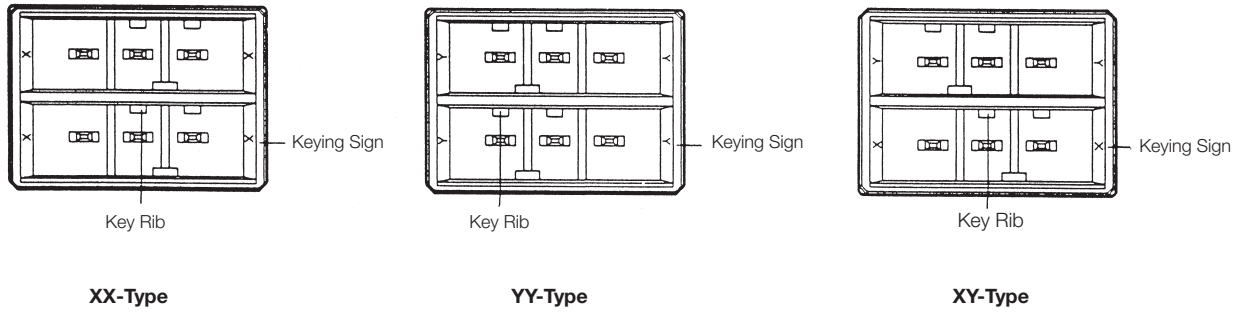

**Table of Mating Combinations**

Receptacle Housing		Tab Housing		Board-mount Tab Header	
1 Row (D-5200S)  *	X-Type		X-Type Panel Type	1 Row (D-5200S) Horizontal Type	X-Type Horizontal Type
	Y-Type		Free-hanging Type		Vertical Type
2 Row	XX-Type		XX-Type Panel Type	2 Rows Horizontal Type	XX-Type Horizontal Type
	YY-Type		Free-hanging Type		YY-Type Horizontal Type
	XY-Type		XY-Type Panel Type		XY-Type Horizontal Type

\*D-5200S Series

**D-5200 Series** (Continued)

**D-5200M — Modular Type**

(Continued)

**Mating Dimensions**

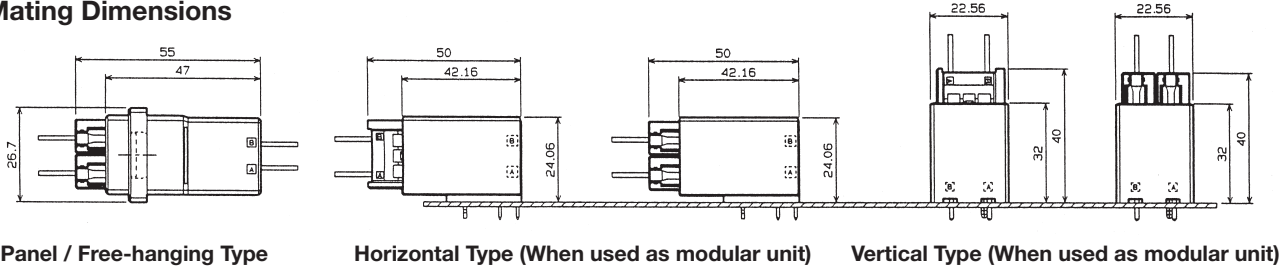

**Receptacle Housing**

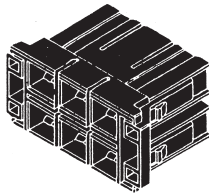

**Mating Tab Connector Part Number:**

- 917809-□
- 917808-□
- 1123829-1
- 1123309-□

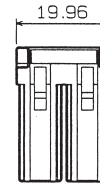
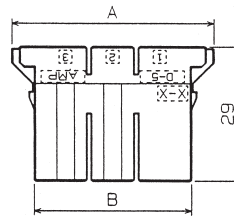
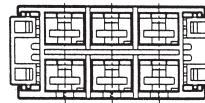

No. of Positions	Part Number of Receptacle Housing	Dimensions	
		A	B
4	□-917807-2	33.36	23.76
6	□-917807-3	43.52	33.92

**Tab Housing**

**Panel Type**

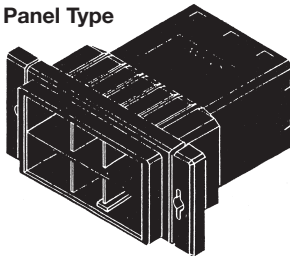

**Mating Receptacle Housing Part Number:**  
□-917807-□

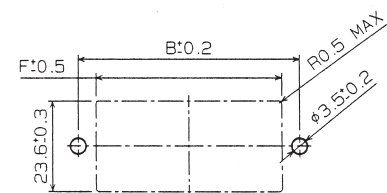
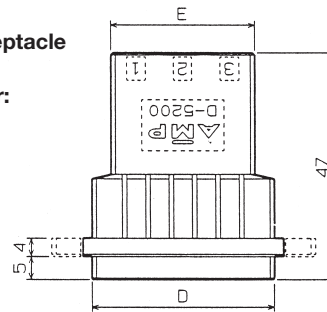

**Panel Cutout**

When mounting panel from the front, apply clamping torque of less than 49N [11 lbf].

**Free-hanging Type**

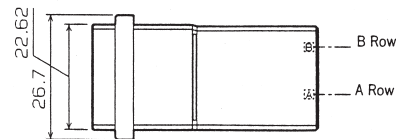
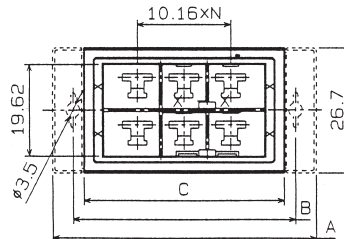
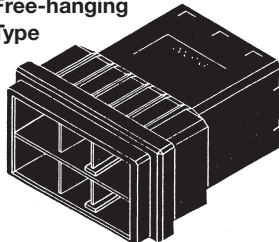

No. of Pos.	Part Number of Tab Housing		Dimensions					
	Panel Type	Free-hanging Type	A	B	C	D	E	F
4	□-917809-2	□-917808-2	47	38	33.44	29.36	21.11	30.40
6	□-917809-3	□-917808-3	57	48	43.60	39.52	31.27	40.50

**D-5200 Series** (Continued)

**D-5200M — Modular Type**

(Continued)

**Board-mount Tab Header (Horizontal Type)**

**Mating Receptacle Housing**  
Part Number:  
□-917807-□

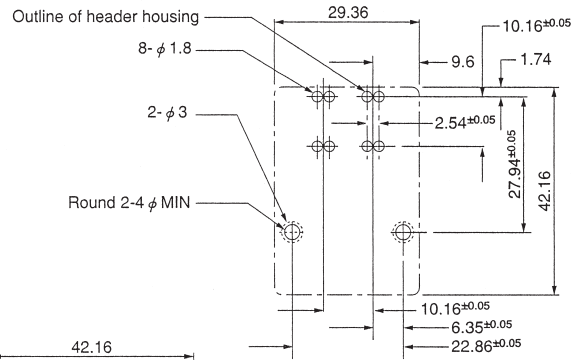
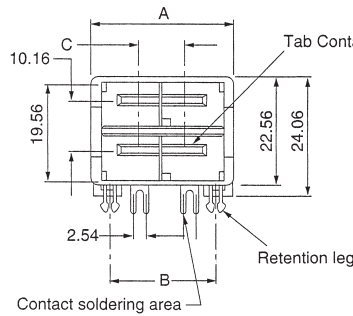
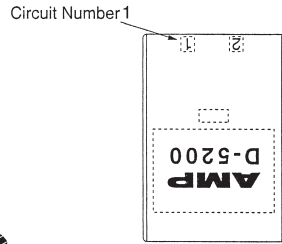
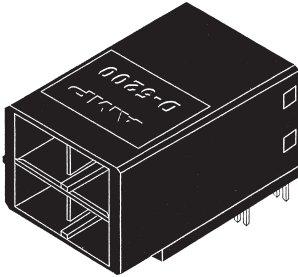

**PC Board Layout**  
Applicable Board Thickness:  
1.6-2.4±0.1

No. of Pos.	Part Number of Tab Header	Dimensions		
		A	B	C
4	□-1123309-□	29.36	22.86	10.16

**Board-mount Tab Header (Horizontal Type)**

**Mating Receptacle Housing**  
Part Number:  
□-917807-□

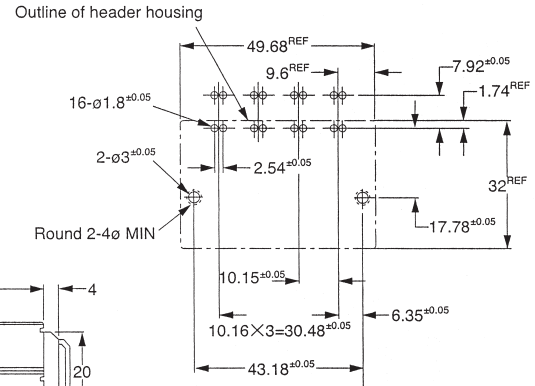
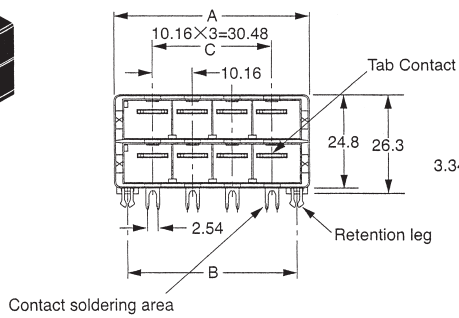
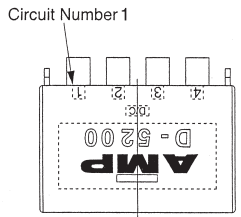
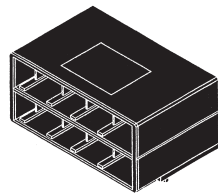

**PC Board Layout**  
Applicable Board Thickness:  
1.6-2.4±0.1

No. of Pos.	Part Number of Tab Header	Dimensions		
		A	B	C
8	1123829-1	49.68	43.18	30.48



**D-5200 Series** (Continued)

**D-5200M $\alpha$  — High Current Type**

**Appearance** Board mounting pitch: 400mils (10.16mm)  
 Dielectric Withstanding Voltage: 3,000V (for one minute)  
 Voltage Rating: 630V AC

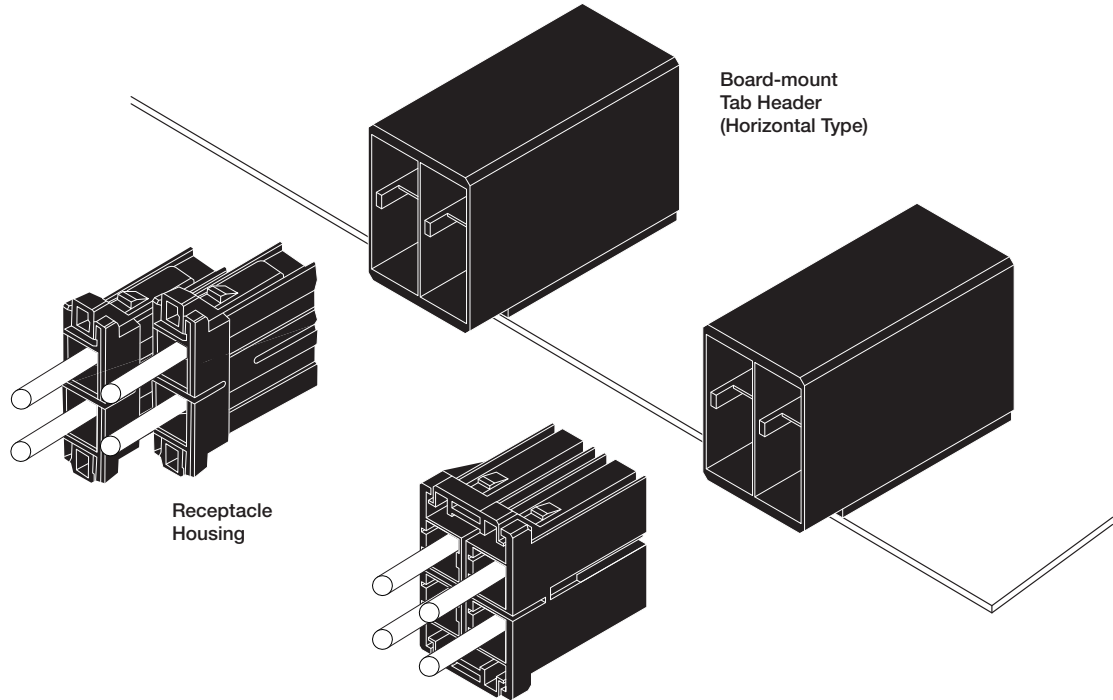

**Receptacle Housing**

**Board-mount Tab Header (Horizontal Type)**

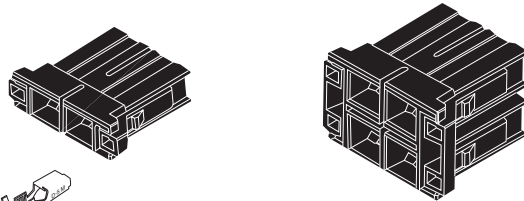

Receptacle Contact, refer to the appropriate pages

**Part Number Chart**

No. of Pos.	Keying	Part Number of Receptacle Housings	Part Number of Board-mounting Tab Headers (Horizontal Type)
2	X	1-179958-2	—
	Y	2-179958-2	—
4	XX	1-917807-2	1-1318983-6
	YY	2-917807-2	2-1318983-6
	XY	3-917807-2	3-1318983-6

\* The 2 pos. receptacles use same 2 pos. housing of D-5200S Series.  
 The 4 pos. receptacles use same 4 pos. housing of D-5200M Series.  
 The contacts, however, are D-5 $\alpha$  (Silver plated type).

**Keying**

Keying is provided with this product (D-5200M $\alpha$ ) to help prevent misinsertion. Three types, XX, YY, and XY, are available.

**D-5200 Series** (Continued)

**D-5200M $\alpha$  — High Current Type** (Continued)

**Mating Dimensions**

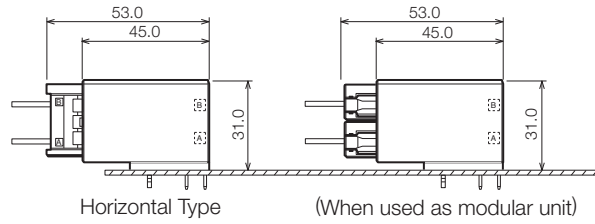

**External Dimensions**

**Receptacle Housing (2 Pos.)**

Mating Tab Header  
Part Number:  
□-1318983-□

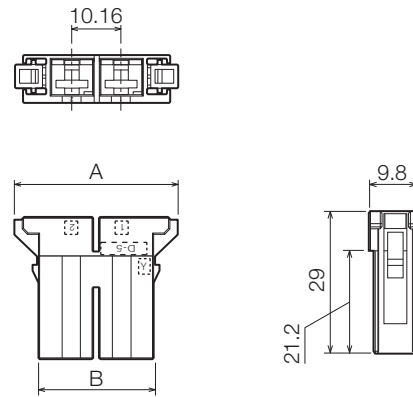
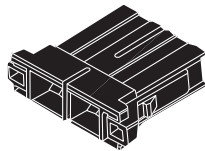

No. of Positions	Keying	Part Number of Receptacle Housing	Dimensions	
			A	B
2	X	1-179958-2	35.76	23.76
	Y	2-179958-2		

**Receptacle Housing (4 Pos.)**

Mating Tab Header  
Part Number:  
□-1318983-□

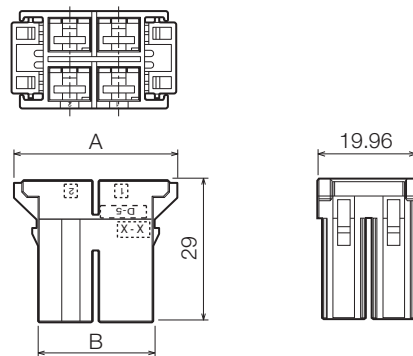
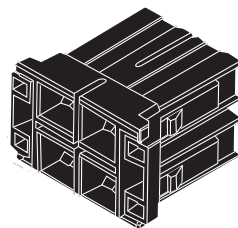

No. of Positions	Keying	Part Number of Receptacle Housing	Dimensions	
			A	B
4	XX	1-917807-2	33.36	23.76
	YY	2-917807-2		
	XY	3-917807-2		

**D-5200 Series** (Continued)

**D-5200M $\alpha$  — High Current Type** (Continued)

**Board-mount Tab Header (Horizontal Type)**

**Mating Receptacle Housing**

**Part Number:**

□-179958-□

□-917807-□

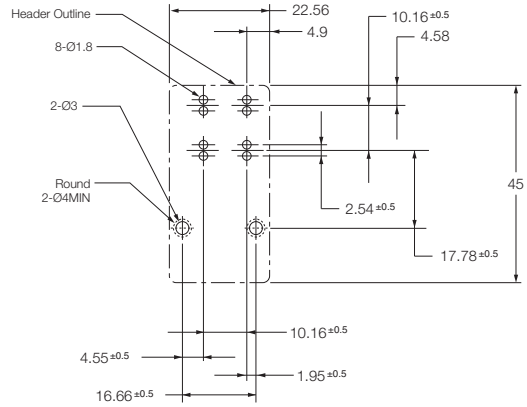
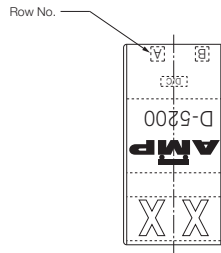
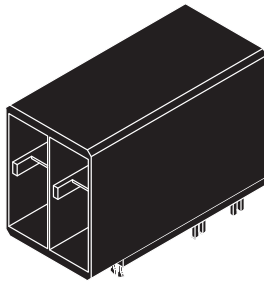

**PC Board Layout**  
Applicable Board  
Thickness: 1.6~2.4±0.1

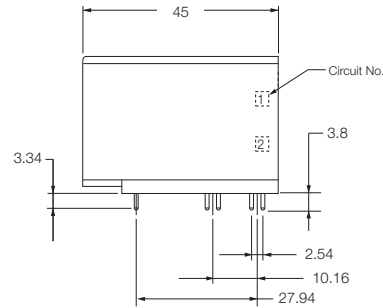
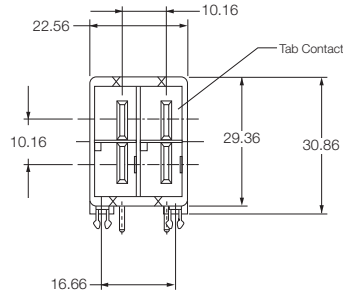

No. of Positions	Keying	Part Number of Tab Header
4	XX	<b>1-1318983-6</b>
	YY	<b>2-1318983-6</b>
	XY	<b>3-1318983-6</b>

D-5000 Series

**DZ-5200 Series (Board-to-Board)**

**DZ-5200 Series**

High-current board-to-board connectors with 30A per contact are useful for cableless control boards.

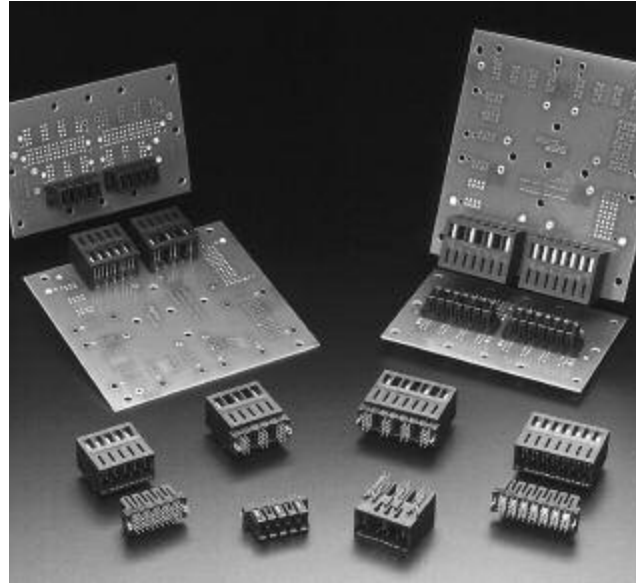

**Material and Finish**

**Receptacle Contact** — Phosphor bronze or copper alloy, gold plated with 1.27 μm nickel underplate

**Tab Contact** — Phosphor bronze or copper alloy, gold plated with 1.27 μm nickel underplate

**Tab Post** — Copper alloy, tin plated and gold plated with 1.27 μm nickel underplate

**Housing** — Glass filled polyester (PBT), UL 94V-0

**Performance Characteristics**

\*When connectors are used singly

**Pitch** — 5.08mm/10.16mm

**Voltage Rating** —  
5.08mm pitch: 250 V (rms);  
10.16mm pitch: 600 V (rms)

**Current Rating** —  
5.08mm pitch: 20A;  
10.16mm pitch: 30A

**Contact Resistance** — 10 mΩ max.

**Dielectric Withstanding Voltage** — 1,500 V (1 minute)

**Operating Temperature** — -55°C ~ +105°C

**Technical Documents**

**Product Specification**  
108-78186

**Receptacle Header**

**Mating Tab Header**  
**Part Number:**  
□-1747145-□

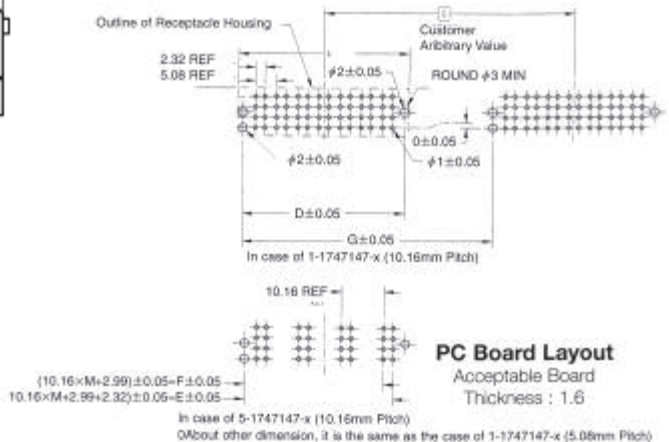
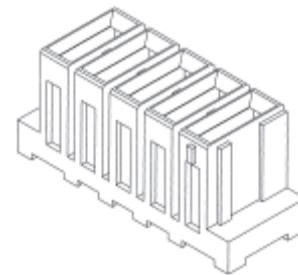
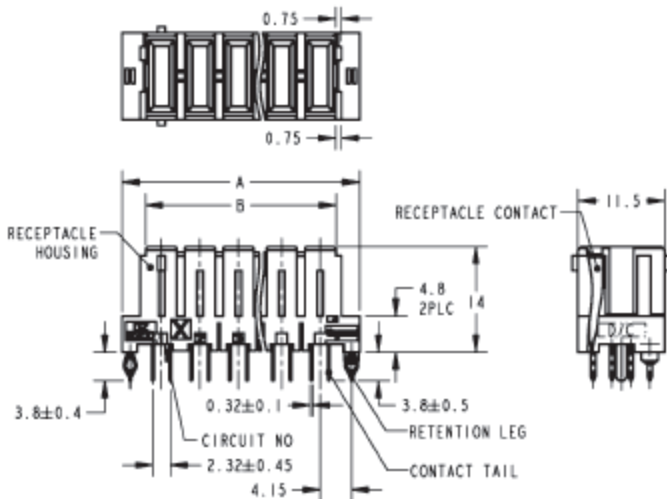

No. of Pos.	Pitch mm	Part Number	Dimensions	
			A	B
3	10.16	5-1747147-3	30.76	24.56
4		5-1747147-4	40.92	34.72
5	5.08	1-1747147-5	30.76	24.56
7		1-1747147-7	40.92	34.27

**DZ-5200 Series** (Continued)

**DZ-5200 Series** (Continued)

**Tab Header**

**Mating Receptacle Header**

**Part Number:**

□-1747147-□

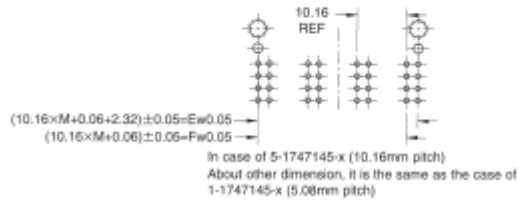
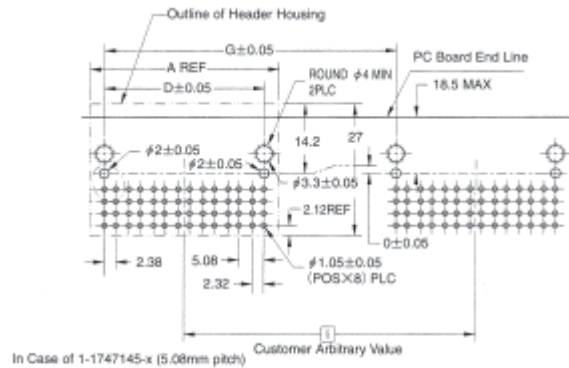
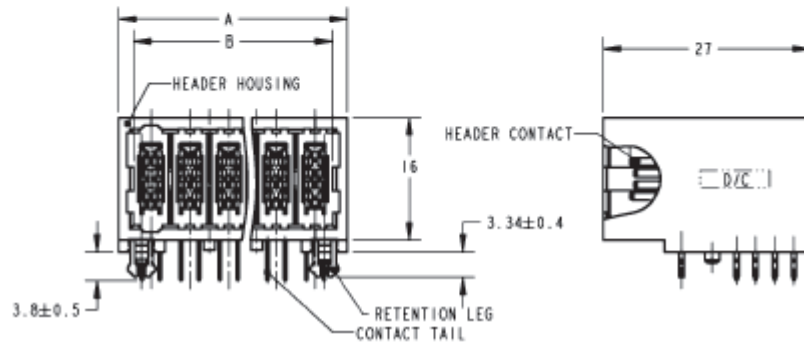
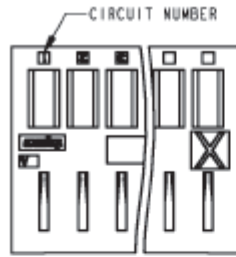
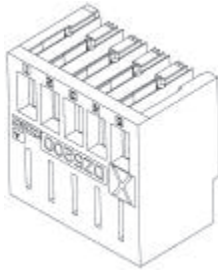

**PC Board Layout**  
Acceptable Board Thickness: 1.6

No. of Pos.	Pitch mm	Part Number	Dimensions	
			A	B
3	10.16	<b>5-1747145-3</b>	28.76	24.86
4		<b>5-1747145-4</b>	38.92	35.02
5	5.08	<b>1-1747145-5</b>	28.76	24.86
7		<b>1-1747145-7</b>	38.92	35.02

## D-5300 Series (Wire-to-Panel and Wire-to-Wire)

### D-5300 Series Reverse Mount Type

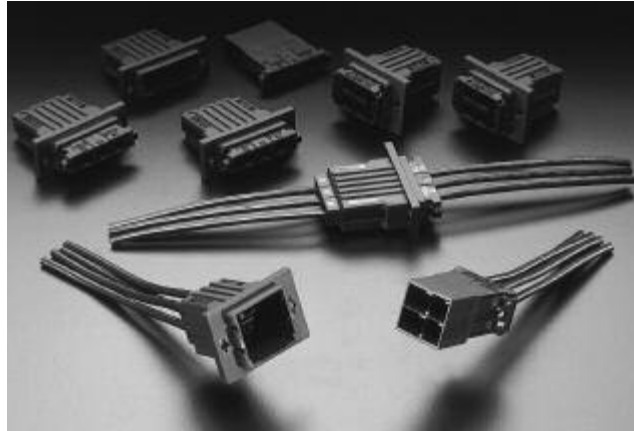

#### Reverse mount type allows Dynamic Series receptacle contact to be used on panel mount side.

The Dynamic D-5300 Series supports receptacle contact storage demand to conductor housing and such applications where safety standards are important. The receptacle contact satisfies the IP20 rating, which contributes to equipment safety. Plus, a new addition

to the lineup are long tab contacts so contact is made in advance when mating and retains current until completely unmated.

Also, because it uses the D-5000 Series high-current contacts, which have a good reputation in industry, it not only keeps costs for new equipment to a minimum, it also really helps to shorten initial evaluation times.

#### Material and Finish

**Receptacle Contact** — Copper alloy, gold plated or silver plated over nickel underplate

**Tab Contact** — Copper alloy, gold plated or silver plated over nickel underplate

**Housing** — Glass filled polyester (PBT), UL 94V-0

#### Performance Characteristics

\*When connectors are used singly

**Pitch** — 400 mil (10.16mm)

**Voltage Rating** — 630 VAC

**Current Rating** —  
#10: 30A; #12: 25A; #16: 16A

**Contact Resistance** — 2 mΩ max.

**Dielectric Withstanding Voltage** —  
3,000 V (1 minute)

**Operating Temperature** —  
-55°C ~ +105°C

#### Related Product Data

D-5 Contact (Refer to page 84)

**D-5300 Series** (Continued)

**D-5300 Series** (Continued)

**Mating Dimensions**

**Keying**

This product (D-5300) is provided with keying to help prevent mismatching of the connector halves. Keying is available in five types—X Type, Y Type, XX Type, YY Type and XY Type.

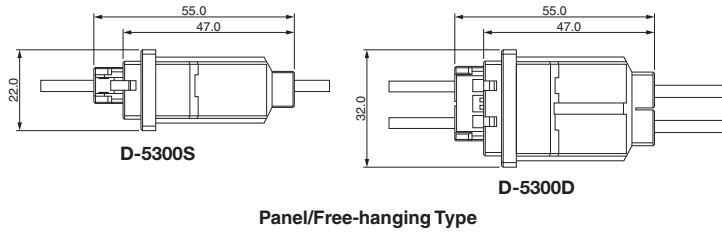

**Dimensions**

**Tab Housing**

**Panel Mount Type**

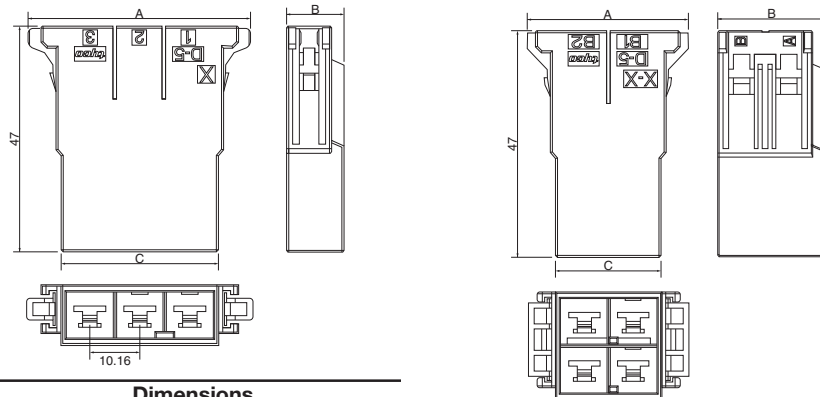

No. of Pos.	Keying	Part Number	Dimensions		
			A	B	C
3	X	<b>1-1747819-3</b>	46.48	12.46	32.68
	Y	<b>2-1747819-3</b>	46.48	12.46	32.68
4	XX	<b>1-1747820-2</b>	33.84	22.62	22.46
	YY	<b>2-1747820-2</b>	33.84	22.62	22.46
	XY	<b>3-1747820-2</b>	33.84	22.62	22.46

**Receptacle Housing**

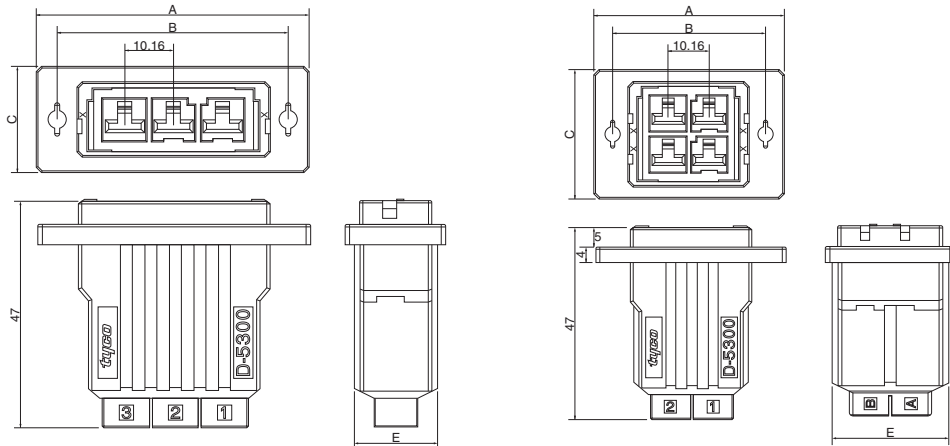

No. of Pos.	Keying	Part Number	Dimensions					
			A	B	C	D	E	F
3	X	<b>1-1747821-3</b>	57	48	22	41.1	18.16	16.8
	Y	<b>2-1747821-3</b>	57	48	22	41.1	18.16	16.8
4	XX	<b>1-1747822-2</b>	47	38	32	30.6	28.32	26.9
	YY	<b>2-1747822-2</b>	47	38	32	30.6	28.32	26.9
	XY	<b>3-1747822-2</b>	47	38	32	30.6	28.32	26.9

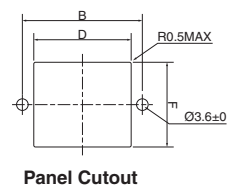

**Panel Cutout**

D-5000 Series

**AMP Dynamic with HTS Connectors (Wire-to-Panel and Wire-to-Wire)**

**2800/3800 Series**

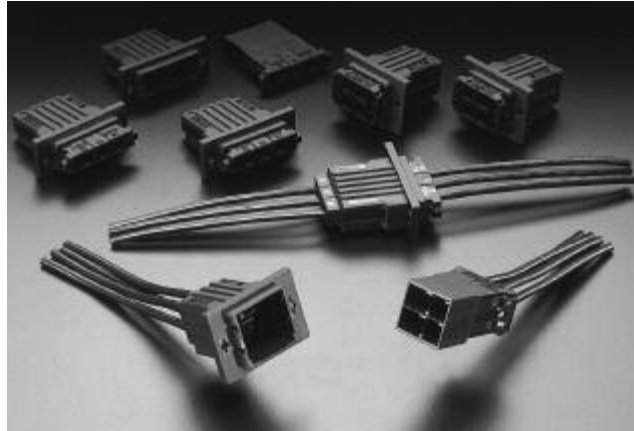

**This Series is a combination of the proven HTS series rectangular connectors and the popular Dynamic Series connector line.**

Metal hoods and frames of HTS connectors, which offers many choices depending on sizes and mounting styles are employed. Sizes and number of positions can be selected to meet the appli-

cation needs. It is also suitable for high-current applications.

Sequential terminals are available to enable termination with automatic crimping machines. Termination time can be substantially reduced.

Approximately 30% higher density mounting is possible compared to the high density HTS connectors.

**Material and Finish**

**Receptacle Contact** — Phosphor bronze or copper alloy, gold plated with 1.27 µm nickel underplate

**Tab Contact** — Phosphor bronze or copper alloy, gold plated with 1.27 µm nickel underplate

**Housing** — Glass filled polyester (PBT), UL 94V-0

**Performance Characteristics**

**Voltage Rating** —

D-2800 Series: 250 V;  
D-3800 Series: 600 V

**Current Rating** —

D-2800 Series: 5A (#18 AWG);  
D-3800 Series: 15A (#16 AWG)

**Contact Resistance** — 10 mΩ max.

**Dielectric Withstanding Voltage** — 1,500 V (1 minute)

**Operating Temperature** — -55°C ~ +105°C

**Technical Documents**

**Product Specifications**

108-78284  
108-78285

**Application Specifications**

114-5258  
114-5148

**Contact**

Contacts of proven Dynamic Series, as well as the existing special tools and applicators, can continue to be used.

**D-2 Contact**

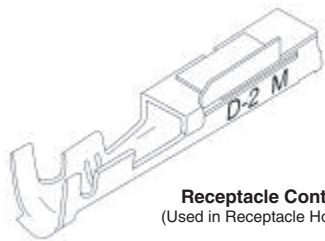

**Receptacle Contact**  
(Used in Receptacle Housing)

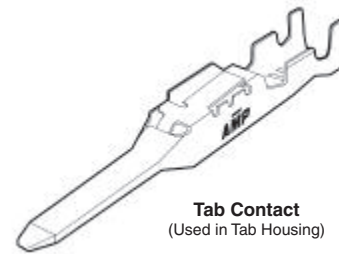

**Tab Contact**  
(Used in Tab Housing)

**D-3 Contact**

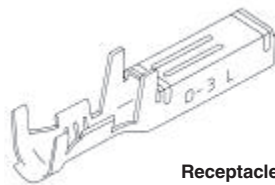

**Receptacle Contact**  
(Used in Receptacle Housing)

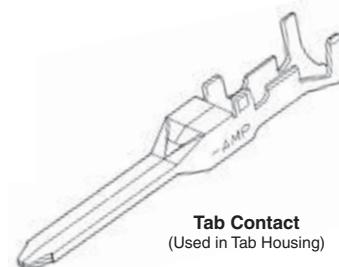

**Tab Contact**  
(Used in Tab Housing)



**AMP Dynamic with HTS Connectors (Wire-to-Panel and Wire-to-Wire) (Continued)**

**2800 Series**

**Receptacle Housing**

No. of Pos.	Part Number
30	1747365-1

**Mating Tab Housing**  
Part Number:  
1747366-1

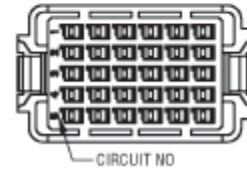
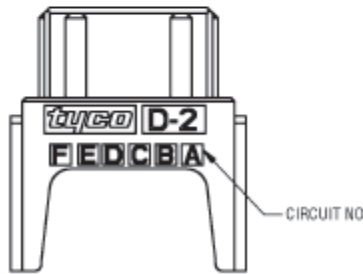
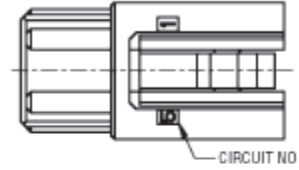
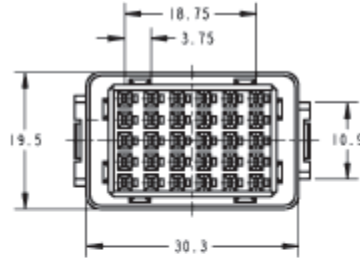

**Tab Housing**

No. of Pos.	Part Number
30	1747366-1

**Mating Receptacle Housing**  
Part Number:  
1747365-1

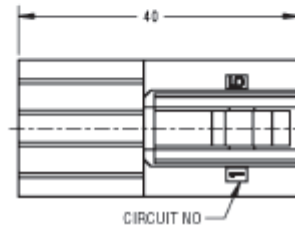
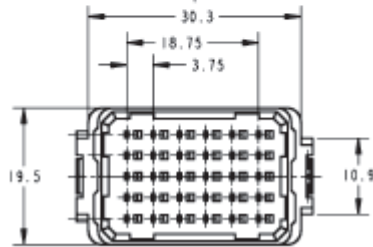
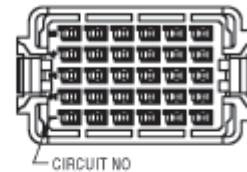
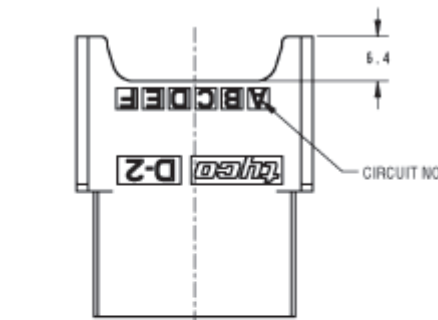

**AMP Dynamic with HTS Connectors (Wire-to-Panel and Wire-to-Wire) (Continued)**

**3800 Series**

**Receptacle Housing**

No. of Pos.	Part Number
12	1747363-1

**Mating Tab Housing**  
Part Number:  
1747364-1

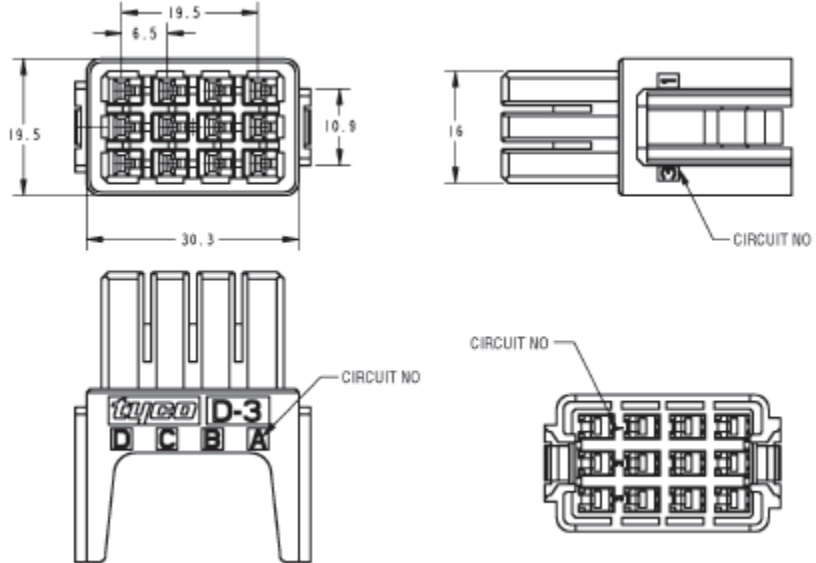

**Tab Housing**

No. of Pos.	Part Number
12	1747364-1

**Mating Receptacle Housing**  
Part Number:  
1747363-1

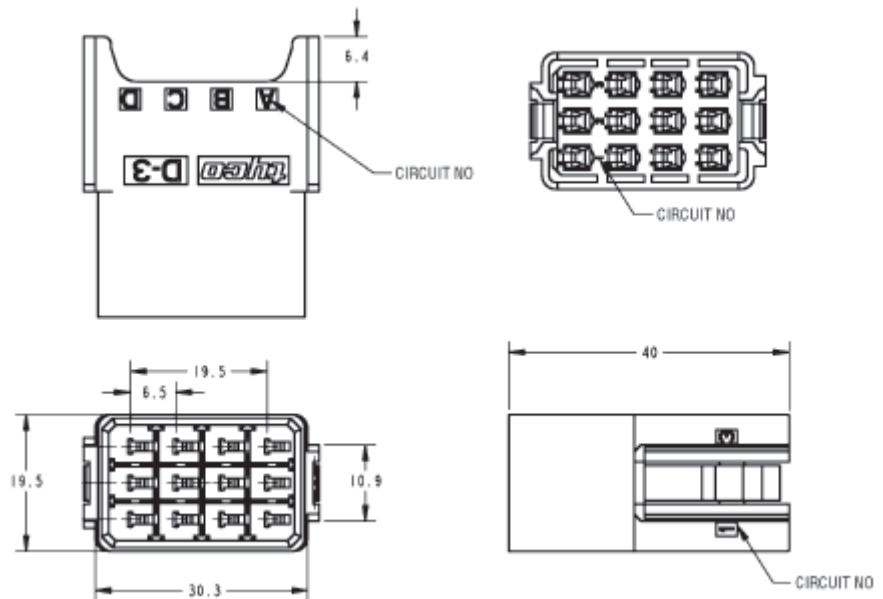

**AMP Dynamic with HTS Connectors (Wire-to-Panel and Wire-to-Wire) (Continued)**

**Frames and Metal Housings**

	Frame	Applicable Metal Housing
<b>Size 3 (1 Module Type)</b>		Refer to HTS Catalog 889745-2

Part Number: **1108784-1**

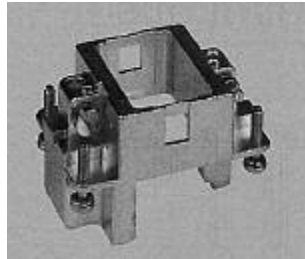

Refer to HTS Catalog 889745-2

**Size 4 (2 Module Type)**

Part Numbers:  
**1108783-1** (Male)  
**1108783-2** (Female)

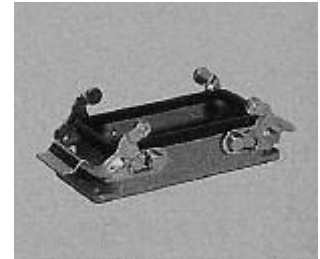
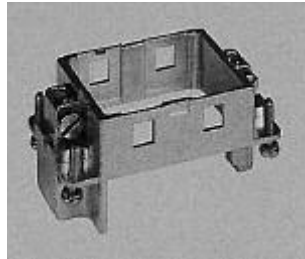

Refer to HTS Catalog 889745-2

**Size 6 (3 Module Type)**

Part Numbers:  
**1108782-1** (Male)  
**1108782-2** (Female)

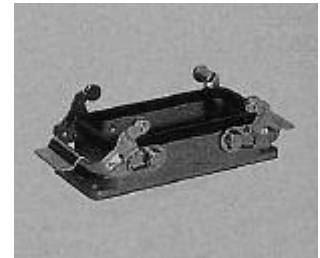
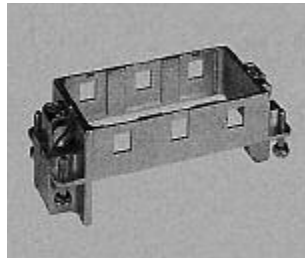

Refer to HTS Catalog 889745-2

**Size 8 (4 Module Type)**

Part Numbers:  
**1108780-1** (Male)  
**1108780-2** (Female)

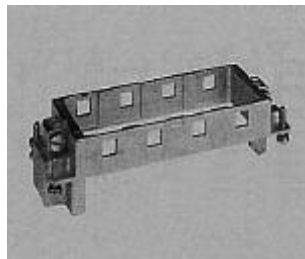

Refer to HTS Catalog 889745-2

AMP Dynamic with HTS Connectors

**AMP Dynamic with HTS Connectors (Wire-to-Panel and Wire-to-Wire) (Continued)**

**Cable Fittings**

**Plastic Type**

Gland fitting IP 68 plastic

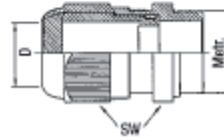
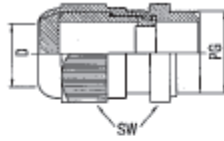

PG	D		SW	Designation	Part Number
	Min.	Max.			
11	5	10	22	HUT.11.P	1-1106005-7
13.5	6	12	24	HUT.13.P	2-1106005-7
16	10	14	27	HUT.16.P	3-1106005-7
21	13	18	33	HUT.21.P	4-1106005-7
29	18	25	42	HUT.29.P	5-1106005-7
36	22	32	53	HUT.36.P	6-1106005-7
42	32	38	60	HUT.42.P	7-1106005-7

Metr.	D		SW	Designation	Part Number
	Min.	Max.			
M16	4	8	20	HUT.M16.P	1-1102771-6
M20	6	12	24	HUT.M20.P	2-1102771-0
M25	10	14	29	HUT.M25.P	2-1102771-5
M32	13	18	36	HUT.M32.P	3-1102771-2
M40	18	25	46	HUT.M40.P	4-1102771-0
M50	22	32	55	HUT.M50.P	5-1102771-0

**Metal Type**

Gland fitting IP 68 brass, nickel plated neoprene sealing insert and O-ring at connection thread.

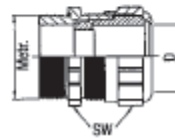
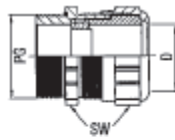

PG	D		SW	Designation	Part Number
	Min.	Max.			
11	5	10	20	HUT.11.MS	1-1106006-9
13.5	6	12	22	HUT.13.MS	2-1106006-9
16	10	14	24	HUT.16.MS	3-1106006-9
21	13	18	30	HUT.21.MS	4-1106006-9
29	18	25	40	HUT.29.MS	5-1106006-9
36	22	32	50	HUT.36.MS	6-1106006-9
42	32	38	57	HUT.42.MS	7-1106006-9

Metr.	D		SW	Designation	Part Number
	Min.	Max.			
M16	5	10	17	HUT.M16.P	1-1102770-6
M20	6	12	22	HUT.M20.P	2-1102770-0
M25	13	18	27	HUT.M25.P	2-1102770-5
M32	18	25	34	HUT.M32.P	3-1102770-2
M40	22	32	43	HUT.M40.P	4-1102770-0
M50	32	38	55	HUT.M50.P	5-1102770-0

**Note:** Variable options are available other than those listed above. Please refer to HTS Catalog 889745-2.

**Power Connector for Board-to-Board Application**

Can be used for tab contact connection.  
Besides, board can be directly inserted into this connector.

<b>Material &amp; Finish</b>	<b>Housing:</b> Glass-filled thermoplastic, blue <b>Contact:</b> Copper alloy, plated gold (1.27 µm thick) on contact area and tin on post area <b>Tab Contact:</b> Brass, 1.27 µm plated gold
<b>Current Rating</b>	20A
<b>Operating Temperature</b>	-55°C ~ +85°C
<b>Insertions and Extractions</b>	30 times

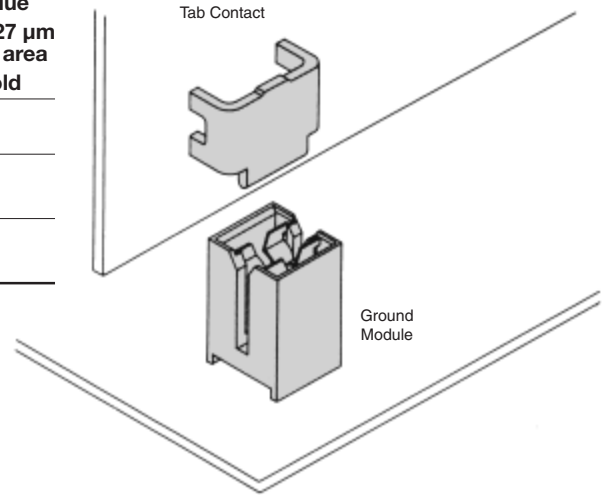

Ground Module



**Part Number**  
119341-1

Tab Contact

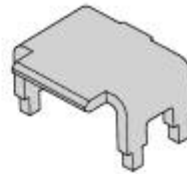

**Part Number**  
175145-2

**Application**

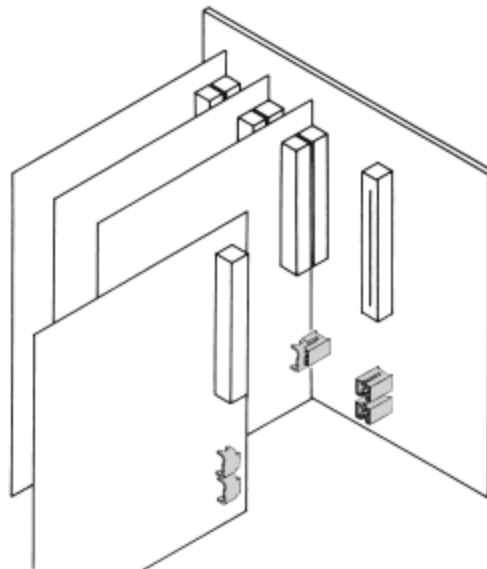

**Power Connector for Board-to-Board Application** (Continued)

**Mating Dimensions**

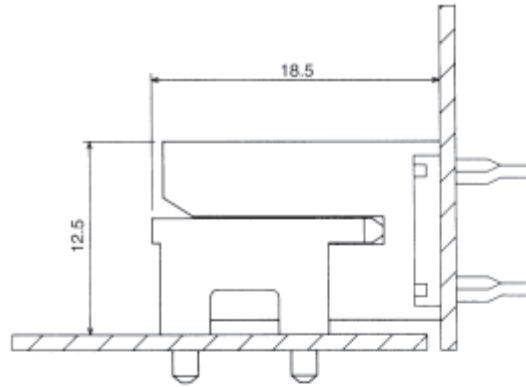

**External Dimensions**

**Ground Module**

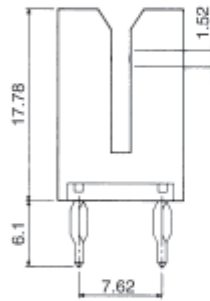
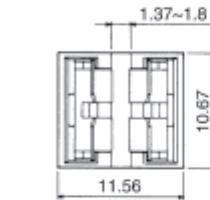
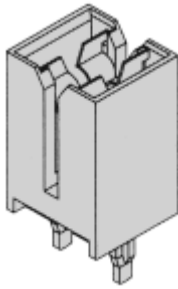

Applicable Board Thickness: 1.37~1.8

**Part Number**  
**119341-1**

**Tab Contact**

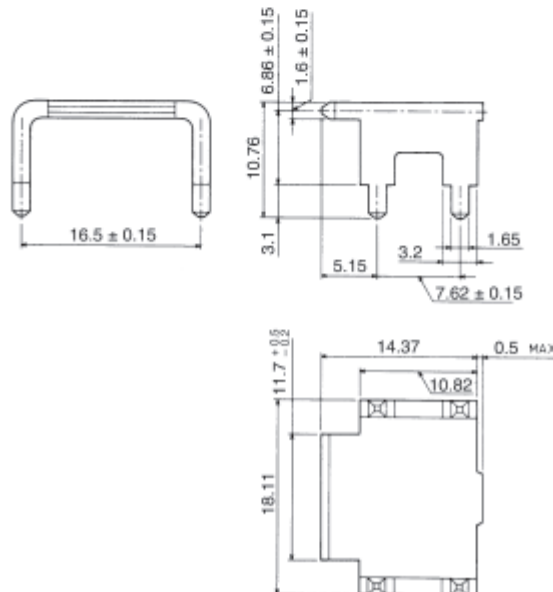
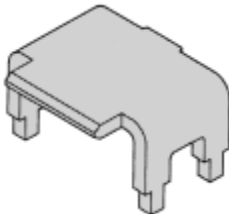

**Part Number**  
**175145-2**

## Dyna-Tap Connectors (Wire-to-Panel and Wire-to-Wire)

### Product Facts

- As many Dyna-Tap Connectors will be fixed on casings where dust protection will be needed, dust covers are incorporated into the design. With the dust cover, this connector can be applied in various environments

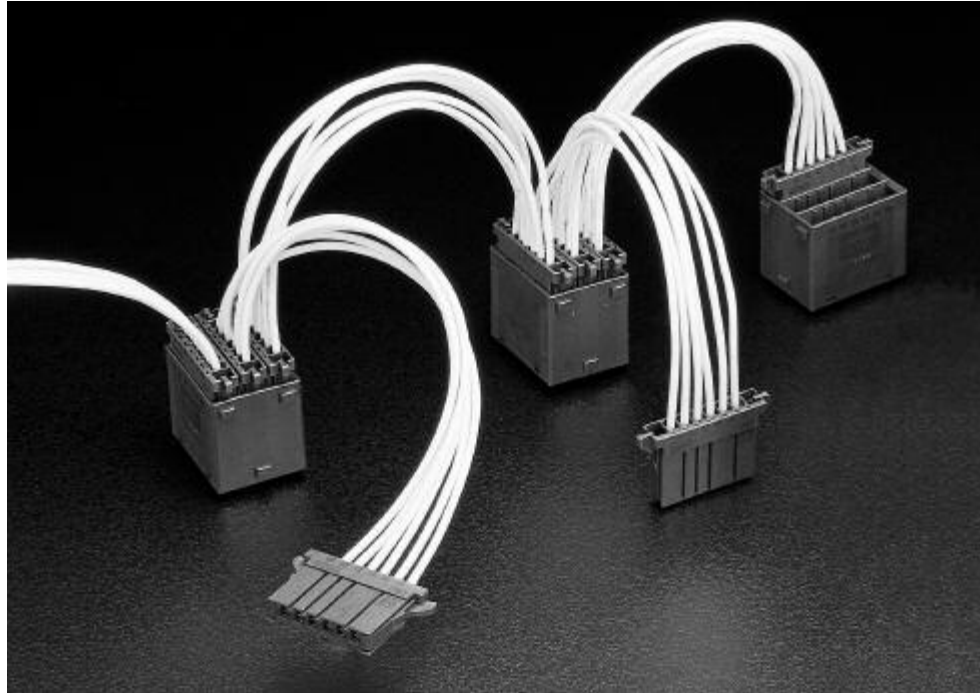

Many pieces of FA equipment are produced by assembling sub-units with divided functions in the final assembly line. Power for each sub-unit of conventional equipment is branched from the power supply bus line over a printed circuit board. In order to save valuable printed circuit board space, Tyco Electronics has developed Dyna-Tap Connectors from which power can be tapped without printed circuits.

Dyna-Tap Connectors are a part of Dynamic Series, which are developed as power supply connectors. Dyna-Tap Connectors are optimized for branching power from the power supply bus line.

In order to cope with three power systems, which are the most popular in the industry, 6-position connectors are specified.

### Product Lineup

Free-hanging type and panel mount type are available. The part number of the mating connector is 1-178288-6.

### Applications

- Power taps in elevator towers
- Power taps for power protective relays
- Power taps among sub-units of semiconductor producing equipment
- Power supplies for equipment on production lines

### Performance Characteristics

**Voltage Rating** — 250 VAC

**Current Rating** — 8A (18-position, with AWG#14)

**Position** — 6 pos. x 3 = 18 pos.

**Durability** — 500 cycles

### Technical Document

**Product Specification**  
108-5754

**Dyna-Tap Connectors (Wire-to-Panel and Wire-to-Wire) (Continued)**

**Mating Dimensions**

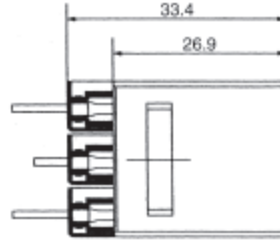

**Tab Housings (18-Position)**

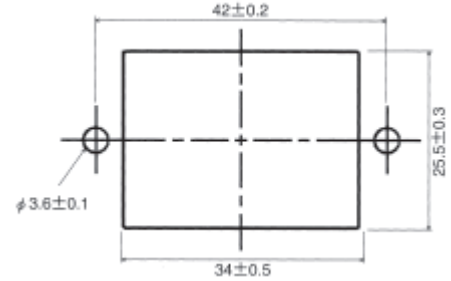

**Free-Hanging Type Part Number 1376807-1**

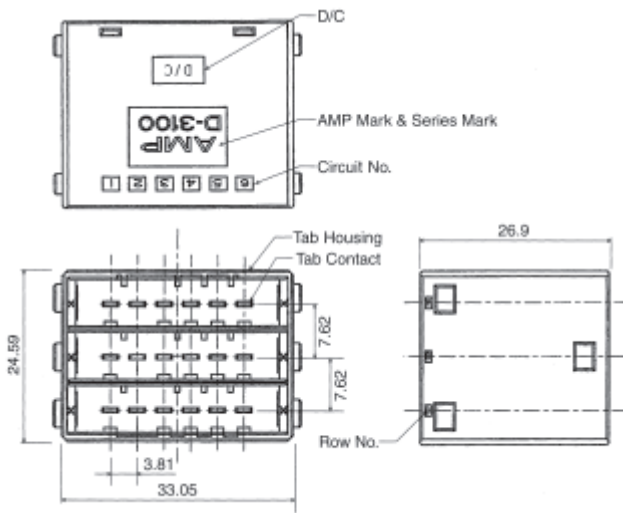

**Panel Mount Type Part Number 1376807-2**

**Panel Cutout**  
When mounting panel from the front, apply clamping torque of less than 49N [11 lbf].

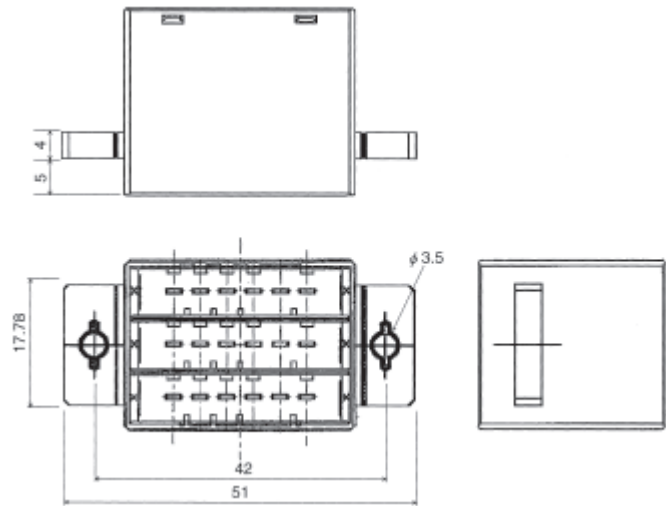

**Mating Receptacle Housing (6-Position)**

Part Number 1-178288-6

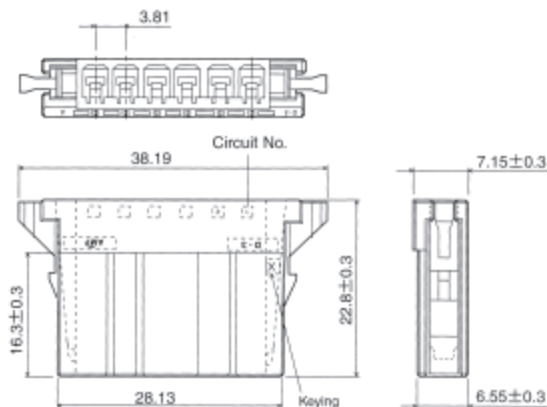
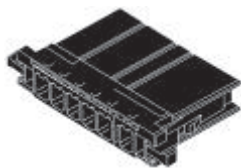

**Caution:**

Dynamic Series contacts are available either with gold plating or tin plating. However, Dyna-Tap Contacts are only available with 0.38 μm thick gold plating. Mating gold plated contacts with tin plated contacts will cause electrolytic corrosion. Therefore, please choose gold plated contacts for the mating Dyna-Tap Connectors.



**Dyna-Tap Connectors (Wire-to-Panel and Wire-to-Wire) (Continued)**

**D-3000 Series**  
**D-3200 Series Dyna-Tap**  
**24P (4P x 6 Row)**

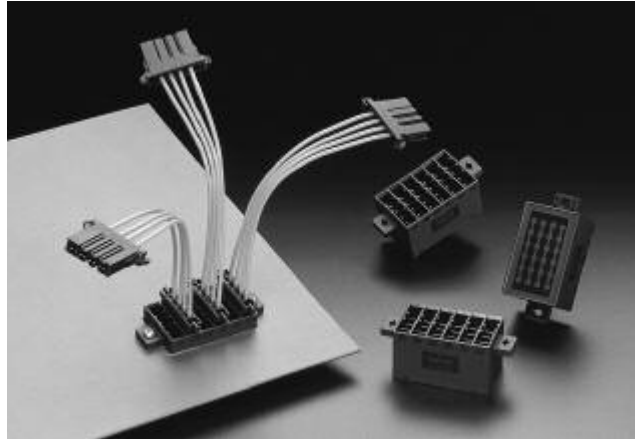

**D-3200 4P common series are lined up in six rows.**

**Issues about branching maintenance and cost are handled with connectors.**

The Dynamic Series power supply tap is known for its superior contact reliability. Compared to a terminal block it is possible to reduce installation and maintenance costs. Also, because the circuits are electronically commoned, circuit board and connector do not need to be mounted. This leads to reductions in number of components and man hours as well as an overall decrease in costs.

**Material and Finish**

**Receptacle Contact** — Copper alloy, plated gold or tin over nickel underplate

**D-3 Contact** — Copper alloy, plated gold or tin over nickel underplate

**Tab Post** — Copper alloy, plated 0.38 µm gold or 2.0 µm tin over 1.3 µm nickel underplate

**Housing** — Glass filled polyester (PBT), UL 94V-0

**Performance Characteristics\***

**Pitch** — 200 mil (5.08 mm)

**Voltage Rating** — 600 VAC

**Current Rating** —  
24-position: 10 A Max.

**Contact Resistance** — 10 mΩ Max.

**Dielectric Withstanding Voltage** —  
2,200 VAC (1 minute)

**Operating Temperature** —  
-55°C ~ +105°C

\*When connectors are used singly.

**Related Product Data**

D-3 Contact (Refer to page 101)

**Dyna-Tap Connectors (Wire-to-Panel and Wire-to-Wire) (Continued)**

**D-3200 Series Dyna-Tap  
24P (4P x 6 Row) (Continued)**

**Mating Dimensions**

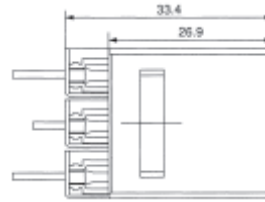

Panel/Free-hanging Type

**Dimensions  
Receptacle Housing**

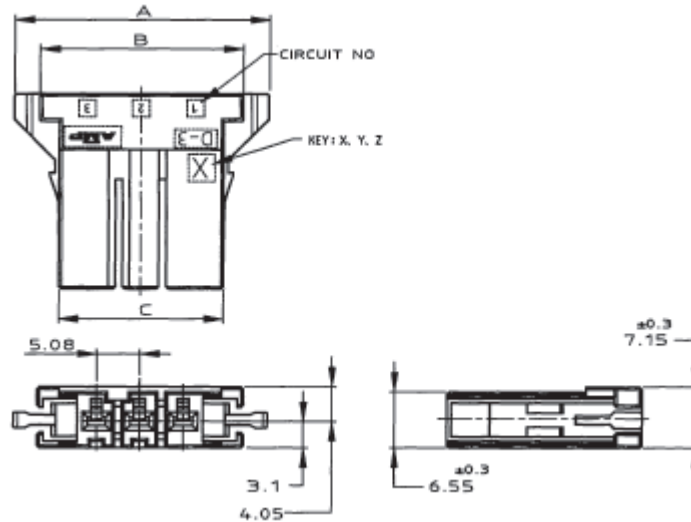

No. of Pos.	Part Number	Dimensions		
		A	B	C
3	1-178128-3	29.70	24.10	19.24

**Tab Housing**

**Panel Mount Type**

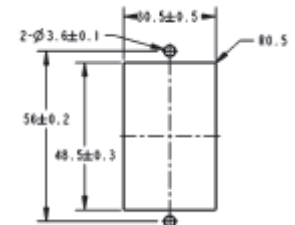
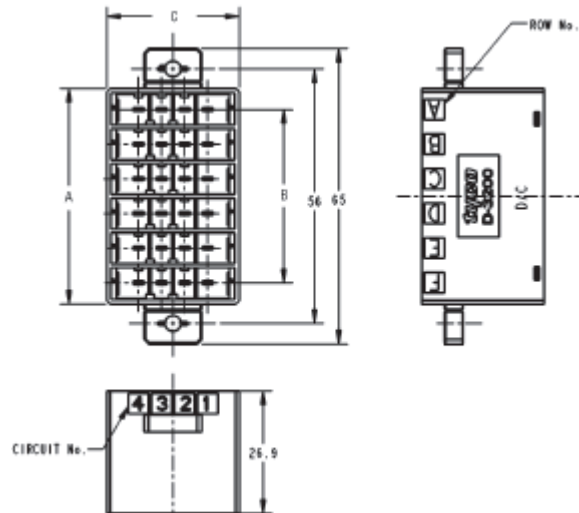

Panel Cutout

**Free-hanging Type**

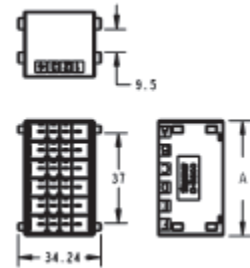

No. of Pos.	Plating	Part Number		Dimensions		
		Panel Mount Type	Free-hanging Type	A	B	C
24	0.38 $\mu$ m Gold	1827691-2	1827691-1	47.45	38.1	29.24
	2.0 $\mu$ m Tin	1-1827691-2	1-1827691-1			

## Dyna-Clamp Kit (Wire-to-Board, Wire-to-Panel and Wire-to-Wire)

Most connectors mounted outside of many pieces of FA equipment are made of metal because of their robustness. Connectors made of metal have a very high performance level.

However, connectors made of metal are more costly than connectors made of plastics.

Tyco Electronics has added a cable clamp function to the existing Dynamic Series. With this new design, the robustness of Dynamic Series connectors made of plastic has been improved remarkably.

This lower cost connector can contribute to the total cost reduction of end products.

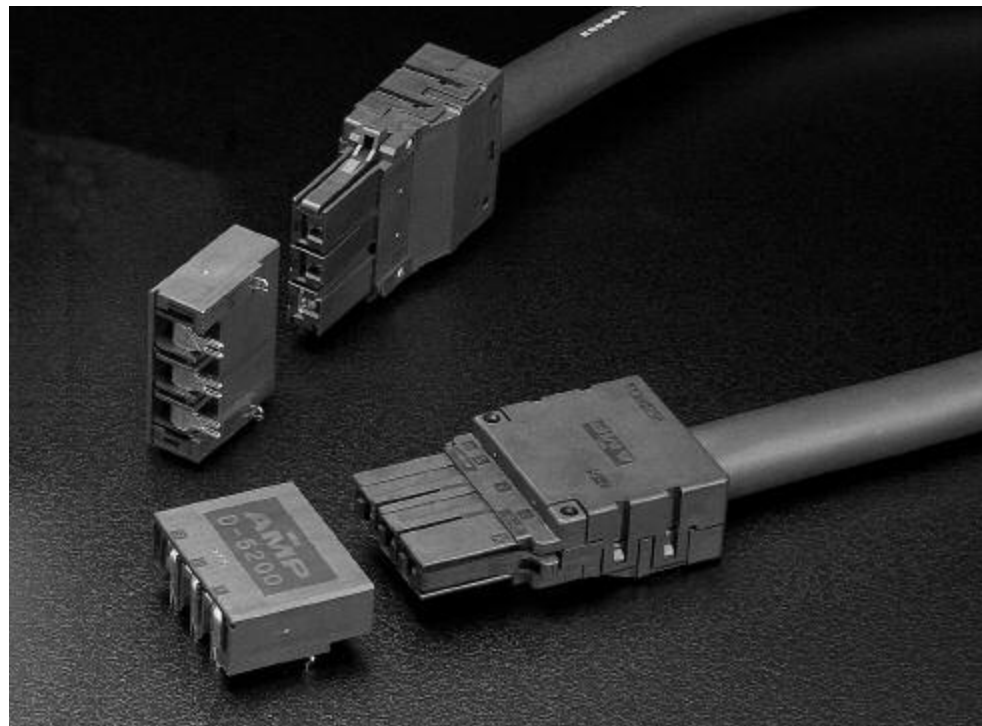

### Applications

- Power supply I/Os among sub-units of semiconductor producing equipment
- Power supply I/Os for control panels
- Power supply I/Os for power control panels
- Power supply I/Os for robots

### Product Lineup

This 3-position connector was developed from the Dynamic Connector 5200 as its basis to realize low-cost 30 A class power distribution for FA equipment. The existing contacts can be used, which means the existing production method such as crimping tools or automatic machines can be utilized without any change.

### Support for Obtaining UL, TÜV Approvals

It is more favorable to obtain UL and TÜV approvals with this connector than with metal connectors because of the following reasons:

#### Made of Plastic

Because of the plastic connector, ground wire at power supply is not necessary. This simplifies wirings of FA equipment and leads to lowering the total cost.

### Sequential Structure

A sequential structure is designed so that the ground wire is always electrically connected before power lines.

### Performance Characteristics

**Voltage Rating** — 6300 VAC

**Current Rating** — 30 A

**Position** — 3 pos.

**Durability** —

With 0.38 μm contact: 50 cycles  
With 0.76 μm contact: 100 cycles

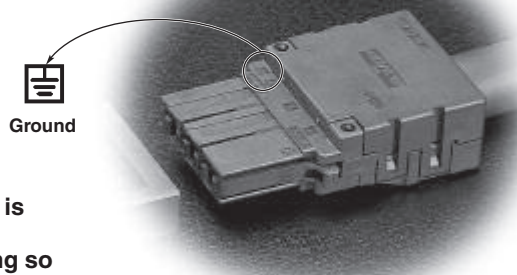

  
Ground

The ground mark is embossed on the connector housing so that operators can see it.

**Dyna-Clamp Kit (Wire-to-Board, Wire-to-Panel and Wire-to-Wire) (Continued)**

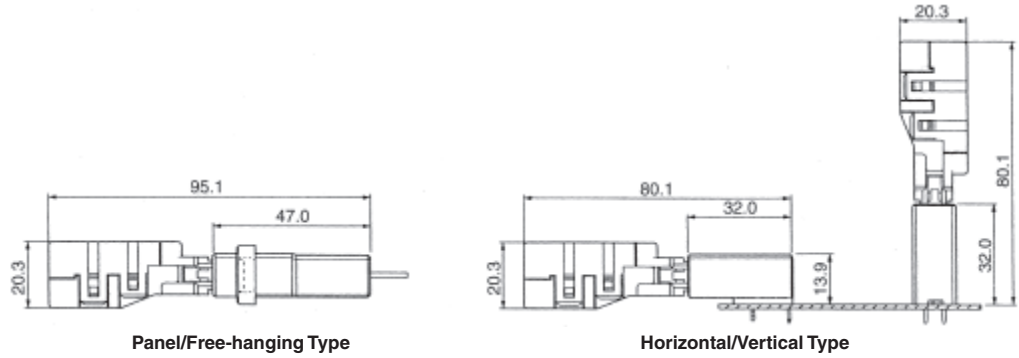

**Cable Kit**

Part Number 1473668-1

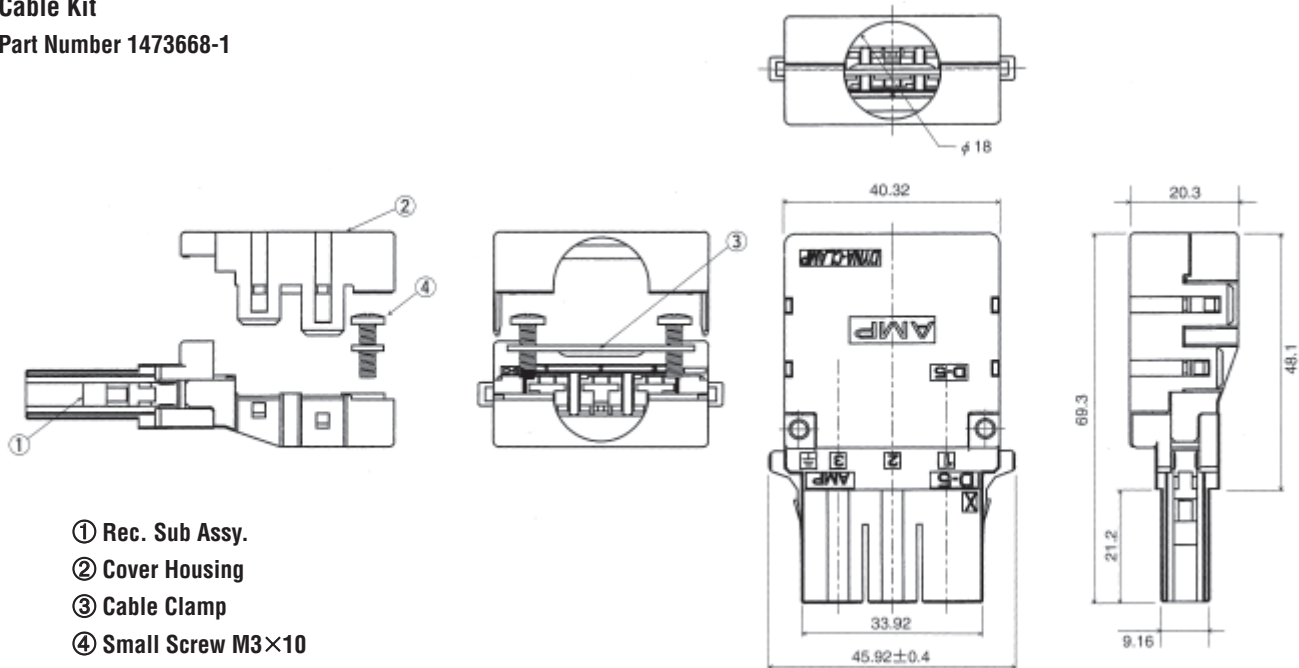

- ① Rec. Sub Assy.
- ② Cover Housing
- ③ Cable Clamp
- ④ Small Screw M3×10

**Mating Connectors**

**Tab Housing**

**Board Mounting Tab Header**

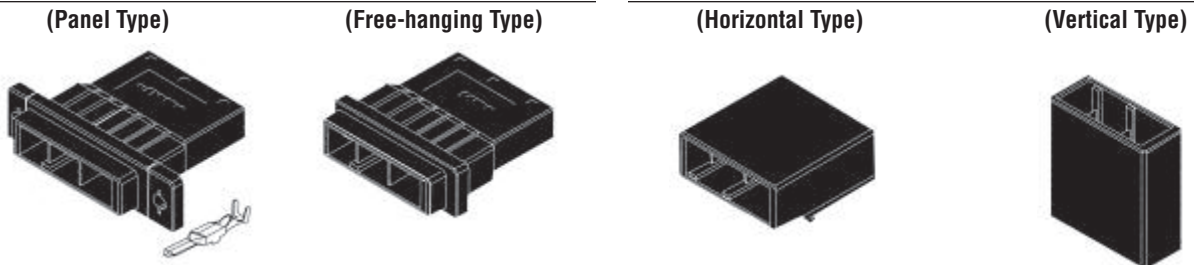

Tab Contact.....For each line of contacts, refer to the appropriate page

No. of Pos.	Part Number of Tab Housing		Board Mounting Tab Header	
	Panel Type	Free-hanging Type	Horizontal Type	Vertical Type
3	1-353047-3	1-353046-3	1-353081-□	1-353082-□

**Note:** Enter the following plating codes in -□ after Part Numbers:  
 -2 = 0.38 μm thick gold plating, -3 = 0.76 μm thick gold plating

## Part Number Index

**Note:** This index lists all cataloged parts by base no. only. Complete part nos. (with prefixes and/or suffixes) are shown on the page(s) indicated.

Part No.	Page	Part No.	Page	Part No.	Page
84695	84	178328	49-51	917804	84
84696	84	178802	43, 45	917805	84
119341	106, 107	178803	49, 50	917807	90, 92-96
175145	106, 107	178964	49, 50	917808	90, 92
175194	38	179129	64	917809	90, 92
175195	38	179188	47, 48	1102770	105
175196	38	179276	56, 58, 59	1102771	105
175216	38	179277	56, 58, 59	1106005	105
175217	38	179552	56, 58	1106006	105
175218	38	179553	56, 58	1108780	104
175284	38	179554	62, 64, 66, 67	1108782	104
175285	38	179555	62, 64, 66, 67	1108783	104
175286	38	179955	84	1108784	104
175287	38	179956	84	1123309	90, 92, 93
175288	38	179958	86, 88, 89, 94-96	1123624	69
175289	38	179959	86, 88, 89	1123829	90, 92, 93
175362	73, 74, 75	179960	86, 88, 89	1318095	73, 74, 75
175363	73, 74, 75	179993	85	1318105	19
175365	73, 74, 75	316040	84	1318106	19
176346	76, 77	316041	84	1318107	19
177555	73, 75	316080	62, 64, 65	1318108	19
177555	74	316081	62, 64, 65	1318109	19
177648	43, 45	316130	56, 58, 59	1318110	19
177662	47, 48	316131	56, 58, 59	1318111	19
177665	47, 48	316132	56, 58, 59	1318112	19
177988	47	316133	56, 58, 59	1318114	24, 26
178127	52-55	316516	73-75	1318115	24, 26
178128	56, 58-61, 69, 111	316517	73-75	1318116	20, 22
178129	62, 64, 65	350381	86	1318117	20, 22
178136	56, 58, 59	353046	86, 88, 113	1318118	24, 26, 27
178137	52-55	353047	86, 88, 113	1318119	24, 26, 27
178138	56, 58, 59	353079	86, 88, 89	1318120	20, 22, 23
178139	62, 64-68	353080	86, 88, 89	1318123	20, 22, 23
178140	62, 64-68	353081	86, 88, 89, 113	1318124	24, 26, 27
178141	52, 53-55	353082	86, 88, 89, 113	1318125	24, 26, 27
178214	70-72	353715	38	1318126	24, 26, 27
178216	70-72	353716	38	1318127	24, 26, 27
178288	43, 45-48, 53, 109	353717	38	1318577	28-30
178289	49-51	353718	38	1318578	28, 29, 31
178293	43, 45, 46, 53	900121	42	1318579	28-30
178294	43, 45, 46	900128	42	1318696	84
178295	43, 45, 46	900167	28, 30, 66	1318697	84
178296	43, 45, 46	917226	67	1318983	94-96
178297	43, 45, 46	917241	73, 74	1318985	84
178298	43, 45, 46	917242	73, 74	1318986	84
178303	49-51	917249	70-72	1376009	24, 26, 27
178304	50	917251	70-72	1376020	24, 26, 27
178305	49-51	917266	66-68	1376059	28, 30
178306	49-51	917337	56, 58, 59	1376072	28, 29, 31
178307	49-51	917338	56, 58, 59	1376073	28, 31
178308	49-51	917389	60, 61	1376133	73-75
178313	43, 45, 46, 53	917484	38	1376135	20, 22, 23
178314	43, 45, 46	917485	38	1376136	24, 26, 27
178315	43, 45, 46	917511	38	1376137	24, 26, 27
178316	43, 45, 46	917512	38	1376807	109
178317	43, 45, 46	917541	86, 88, 89	1473074	20, 22, 23
178318	43, 45, 46	917542	86, 88, 89	1473668	113
178323	49-51	917657	62, 64, 65	1717412	49, 50, 51
178324	50	917658	62, 64, 65	1747145	97, 98
178325	49-51	917659	62, 64, 65	1747147	97, 98
178326	49-51	917802	84	1747276	79, 80
178327	49-51	917803	84	1747277	79, 80

**Part Number Index** (Continued)

Part No.	Page	Part No.	Page	Part No.	Page
1747363	103	1827572	7	1871731	7
1747364	103	1827579	14	1871743	7
1747365	102	1827581	14	1871744	7
1747366	102	1827583	15	1871745	7
1747414	79	1827586	7	1903111	7
1747415	78	1827587	7	1903112	7
1747416	78	1827588	7	1903113	7
1747418	78	1827589	7	1903114	7
1747419	78	1827691	111	1903115	7
1747498	78	1827862	8	1903116	7
1747499	78	1827863	8	1903117	7
1747500	78	1827864	12	1903118	7
1747501	78	1827872	9	1903120	7
1747535	79	1827873	9	1903121	7
1747819	100	1827875	12	1903122	7
1747820	100	1827876	13	1903124	7
1747821	100	1871056	9	1903125	7
1747822	100	1871057	8	1903126	7
1747994	24, 26, 27	1871303	7	1903127	8
1827538	33	1871304	7	1903128	8
1827540	33	1871315	9	1903129	11
1827569	7	1871465	10	1903130	13
1827570	7	1871468	10	1903131	13
1827571	7	1871673	13		

**Application Tooling Part Number Index**

**Note:** This index lists all cataloged parts by base no. only. Complete part nos. (with prefixes and/or suffixes) are shown on the page(s) indicated.

Part No.	Page	Part No.	Page	Part No.	Page
58571	39	234172	37	1762626	7
91558	38	409158	84	1762846	7
91559	38	919041	41	1762847	7
91560	38	919600	37	1762950	7
91561	38	919601	37	1762951	7
91565	38	919602	37	1762952	7
91576	18, 19	1366044	83, 84	1762953	7
91595	18, 19	1366656	83	1891033	7
91596	83, 84	1762119	78	1891035	7
175855	41	1762120	78	1891036	7
234168	41	1762129	78	1891037	7
234170	83, 84	1762130	78		
234171	83, 84	1762625	7		

---

**Engineering Notes**

---



---

**Engineering Notes**

---





---

**Engineering Notes**

---

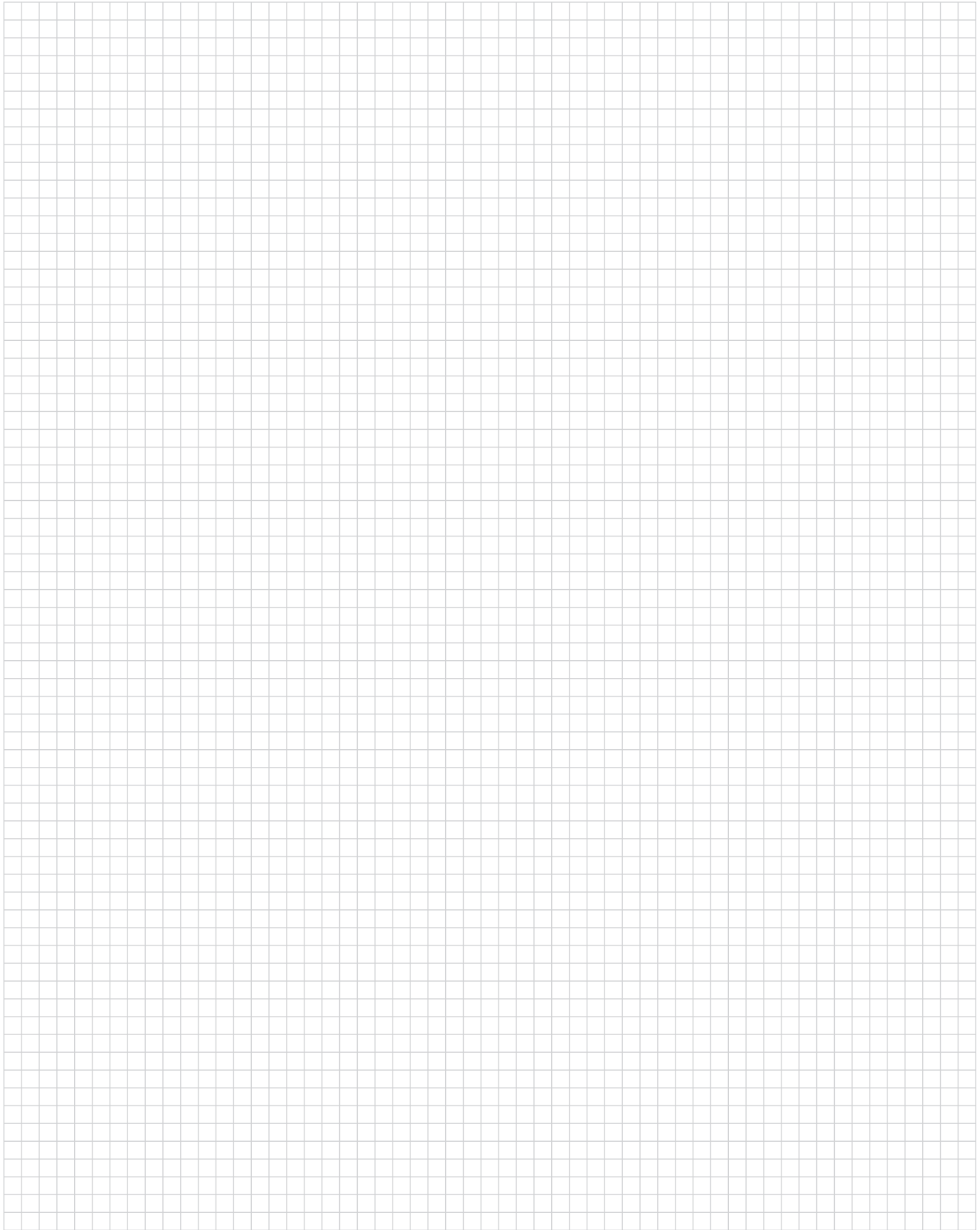

**Americas**

**Argentina** – Buenos Aires  
 Phone: +54-11-4733-2200  
 Fax: +54-11-4733-2211

**Brasil** – São Paulo  
 Phone: +55-11-3611-1311  
 Fax: +55-11-3611-0397

**Canada** – Toronto  
 Phone: +905-475-6222  
 Fax: +905-474-5520

**Product Information Center:  
 (Technical Support)**  
 Phone: +905-470-4425  
 Fax: +905-474-5525

**Colombia** – Bogota  
 Phone: +57-1-231-9398  
 Fax: +57-1-660-0206

**Mexico** – Mexico City  
 Phone: +52-55-1106-0800  
 +01-800-733-8926  
 Fax: +52-55-1106-0901

**United States** – Harrisburg, PA  
 Phone: +717-564-0100  
 Fax: +717-986-7575  
**Product Information Center:  
 (Technical Support)**  
 Phone: +800-522-6752  
 Fax: +717-986-7575

**For Latin/South American  
 Countries not shown**  
 Phone: +54-11-4733-2015  
 Fax: +54-11-4733-2083

**Asia/Pacific**

**Australia** – Sydney  
 Phone: +61-2-9554-2600  
 Fax: +61-2-9502-2556  
**Product Information Center:  
 (Technical Support)**  
 Phone: +61-2-9840-8200  
 Fax: +61-2-9634-6188

**India** – Bangalore  
 Phone: +91-80-285-40800  
 Fax: +91-80-285-40820

**Indonesia** – Jakarta  
 Phone: +65-6482-0311  
 Fax: +65-6482-1012

**Japan** – Toyko  
 Phone: +81-44-844-8111  
 Fax: +81-44-812-3207  
**Product Information Center:  
 (Technical Support)**  
 Phone: +81-44-844-8013  
 Fax: +81-44-812-3200

**Korea** – Seoul  
 Phone: +82-2-3415-4500  
 Fax: +82-2-3486-3810

**Malaysia** – Kuala Lumpur  
 Phone: +60-3-78053055  
 Fax: +60-3-78053066

**New Zealand** – Auckland  
 Phone: +64-9-634-4580  
 Fax: +64-9-634-4586

**Philippines** – Makati City  
 Phone: +632-848-0171  
 Fax: +632-867-8661

**People's Republic of China**  
 Hong Kong  
 Phone: +852-2735-1628  
 Fax: +852-2735-0243

Shanghai  
 Phone: +86-21-2407-1588  
 Fax: +86-21-2407-1599

Taiwan – Taipei  
 Phone: +886-2-8768-2788  
 Fax: +886-2-8768-2268

**Singapore** – Singapore  
 Phone: +65-6482-0311  
 Fax: +65-6482-1012

**Thailand** – Bangkok  
 Phone: +66-2-955-0500  
 Fax: +66-2-955-0505

**Vietnam and Indochina** –  
 Ho Chi Minh City  
 Phone: +84-8 930-5546  
 Fax: +84-8 930-3443

**Europe/Middle East/Africa**

**Austria** – Vienna  
 Phone: +43-1 90 5 60-0  
 Fax: +43-1 90 5 60-1333

**Belgium** – Kessel-Lo  
 Phone: +32-16-35-23-00  
 Fax: +32-16-35-23-52

**Bulgaria** – Sofia  
 Phone: +359-2-971-2152  
 Fax: +359-2-971-2153

**Czech Republic** – Kurim  
 Phone: +420-5-41-162-111  
 Fax: +420-5-41-162-223

**Denmark** – Glostrup  
 Phone: +45-43-480-452  
 Fax: +45-43-441-414

**Egypt** – Cairo  
 Phone: +20-2-29 04 281  
 Fax: +20-2-41 92 334

**Estonia** – Tartu  
 Phone: +372-5138-274  
 Fax: +372-7400-779

**Finland** – Helsinki  
 Phone: +358-95-12-34-20  
 Fax: +358-95-12-34-250

**France** – Cergy-Pontoise  
 Phone: +33-1-3420-8888  
 Fax: +33-1-3420-8600  
**Product Information Center:  
 (Technical Support)**  
 Phone: +33-1-3420-8943  
 Fax: +33-1-3420-8623

**Germany** – Bensheim  
 Phone: +49-6251-133-0  
 Fax: +49-6251-133-1600  
**Product Information Center:  
 (Technical Support)**  
 Phone: +49-6251-133-1999  
 Fax: +49-6251-133-1988

**Germany** – Langen  
 Phone: +49-6103-709-0  
 Fax: +49-6103-709-1223

**Germany** – Speyer  
 Phone: +49-6232-30-0  
 Fax: +49-6232-30-2243

**Germany - HTS Division** – Neunkirchen  
 Phone: +49-2247-305-0  
 Fax: +49-2247-305-122

**Greece** – Athens  
 Phone: +30-210-9370-396/397  
 Fax: +30-210-9370-655

**Hungary** – Budapest  
 Phone: +36-1-289-1000  
 Fax: +36-1-289-1010

**Ireland** – Dublin  
 Phone: +353-1-820-3000  
 Fax: +353-1-820-9790

**Israel** – Yokneam  
 Phone: +972-4-959-0508  
 Fax: +972-4-959-0506

**Italy** – Collegno (Torino)  
 Phone: +39-011-4012-111  
 Fax: +39-011-4031116

**Lithuania** – Vilnius  
 Phone: +370-5-2131-402  
 Fax: +370-5-2131-403

**Netherlands** – 's-Hertogenbosch  
 Phone: +31-73-624-62-46  
 Fax: +31-73-621-23-65  
**Product Information Center:  
 (Technical Support)**  
 Phone: +31-73-6246-999  
 Fax: +31-73-6246-998

**Norway** – Nesbru  
 Phone: +47-66-77-8886  
 Fax: +47-66-77-8855

**Poland** – Warsaw  
 Phone: +48-22-45-76-700  
 Fax: +48-22-45-76-720

**Romania** – Bucharest  
 Phone: +40-21-311-3479/3596  
 Fax: +40-21-312-0574

**Russia** – Moscow  
 Phone: +7-495-926-5506/07/08/09  
 Fax: +7-495-926-5505

**Russia** – St. Petersburg  
 Phone: +7-812-718-8192  
 Fax: +7-812-718-8193

**Slovenia** – Ljubljana  
 Phone: +386-1561-3270  
 Fax: +386-1561-3240

**South Africa** – Port Elizabeth  
 Phone: +2741-503-4500  
 Fax: +2741-581-0440

**Spain** – Barcelona  
 Phone: +34-93-291-0330  
 Fax: +34-93-201-7879  
**Product Information Center:  
 (Technical Support):**  
 Phone: +34-93-291-0330  
 Fax: +34-93-200-3779

**Sweden** – Upplands Väsby  
 Phone: +46-8-50-72-50-00  
 Fax: +46-8-50-72-50-01

**Switzerland** – Steinach  
 Phone: +41-71-447-0447  
 Fax: +41-71-447-0444

**Turkey** – Istanbul  
 Phone: +90-212-281-8181/2/3  
 Fax: +90-212-281-8184

**Ukraine** – Kiev  
 Phone: +380-044-206-2265  
 Fax: +380-044-206-2264

**United Kingdom** – Swindon  
 Phone: +44-8706-080-208  
 Fax: +44-1793-572-516  
**Product Information Center:  
 (Technical Support)**  
 Freephone GB: 0800-267-666  
 Phone: +44-8706-080-208  
 Fax: +44-208-420-8081

**For Middle East/African Countries  
 Not Shown**  
 Phone: +33-1-3420-8866  
 Fax: +33-1-3420-8300

**Tyco Electronics Corporation**  
Harrisburg, PA

tycoelectronics.com

1242132-7.5M-LUG-FP-5-07

