

4

3

2

1

THIS DRAWING IS UNPUBLISHED. RELEASED FOR PUBLICATION DEC. 2004.
 COPYRIGHT © 2004 BY TYCO ELECTRONICS CORPORATION. ALL RIGHTS RESERVED.

LOC	DIST	REVISIONS		
E	B	F	DATE	BY
		B	18AUG05	JMS
		B	ECR-05-006587	FWK

NOTES

- 1. SINGLE PACK IN ACCORDANCE WITH AMP SPEC 107-3275
- 2. 100 TRAY PACK IN ACCORDANCE WITH AMP SPEC 107-3275
- 3. Au PLATING OVER Ni PLATING OVER Cu PLATING
- 4. Ni PLATING OVER Cu PLATING
- 5. HAND TOOL: 9-1478240-0
- 6. DIE SET: 9-1478242-0
- 7. CHARACTERISTICS
 FREQUENCY RANGE: DC-4GHz
 NOMINAL IMPEDANCE: 75 OHMS
 INSULATION RESISTANCE: 5000 MΩHMS
 DIELECTRIC WITHSTAND VOLTAGE: 500V RMS
 CONTACT RESISTANCE: 3.0 mΩHMS
 CENTRE CONTACT
- 8. MECHANICAL CHARACTERISTICS
 DURABILITY: 50 CYCLES
- 9. FOR TECHNICAL DATA REFER TO YOUR LOCAL TYCO ELECTRONICS SALES OFFICE
- 10. ALL DIMENSIONS ARE NOMINAL FOR REFERENCE ONLY UNLESS OTHERWISE STATED

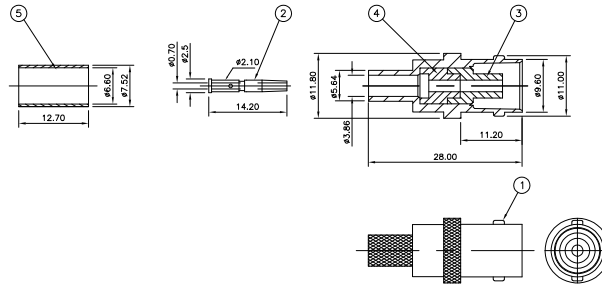

QTY	DESCRIPTION	MATERIAL	DESCRIPTION	ITEM
1	CRIMP SLEEVE	BRASS		5
1	INSULATOR	POLYMETHYLENE		4
1	INSULATOR	POLYMETHYLENE		3
1	CONTACT	PHOSPHOR BRONZE		2
1	BODY	ZINC ALLOY		1
5	MATERIAL	9-15-C		

THIS DRAWING IS A CONTROLLED DOCUMENT.

DIMENSIONS: mm 0 P.L.C. ± 1 P.L.C. ± 2 P.L.C. ± 3 P.L.C. ± 4 P.L.C. ± ANGLES ±	TOLERANCES UNLESS OTHERWISE SPECIFIED FRACTIONS DECIMALS ±.0005 ±.0005 ±.001 ±.001 ±.002 ±.002 ±.005 ±.005 ±.01 ±.01 ±.02 ±.02 ±.05 ±.05 ±.1 ±.1 ±.2 ±.2 ±.5 ±.5 ±1 ±1 ±2 ±2	DIM J. SANDWELL 16JUN04 CHK S. PARLOW 16OCT04 APD S. PARLOW 16OCT04 NAME F. WHEELER-KING PRODUCT SPEC 108-3435 APPLICATION SPEC SEE SHEET 2 WEIGHT - CUSTOMER DRAWING	DIM J. SANDWELL 16JUN04 CHK S. PARLOW 16OCT04 APD S. PARLOW 16OCT04 NAME F. WHEELER-KING PRODUCT SPEC 108-3435 APPLICATION SPEC SEE SHEET 2 WEIGHT - CUSTOMER DRAWING	Tyco Electronics Corporation Bideford, UK, EX39 4HE BNC STRAIGHT JACK CRIMP 75 OHM RG59B/U, 62A/U, 140/U, 210/U, URM90 KX6A, KX25, KX52, KX53 SIZE A2 CASE CODE 00779 DRAWING ID C=1634514 SCALE NTS SHEET 1 OF 2 REV B
--	---	--	--	---

4

3

2

1

THIS DRAWING IS UNPUBLISHED. RELEASED FOR PUBLICATION DEC. 2004.
 © COPYRIGHT 2004 BY TYCO ELECTRONICS CORPORATION. ALL RIGHTS RESERVED.

LOC	DIST	REV	DESCRIPTION	DATE	BY	APPD
E	B	F	LR			
		-	SEE SHEET 1			

COMPONENTS

ITEM NO.	DESCRIPTION	QUANTITY	UNIT
1, 3, & 4	MAIN BODY		
2	CONTACT		
5	CRIMP FERRULES		

ASSEMBLY INSTRUCTION

CABLES: RG59B/U, 62A/U, 140/U, 210/U, URM90 KX6A, KX25, KX52, KX53

STEP 1
1. SLIDE METAL CRIMP FERRULE OVER CABLE

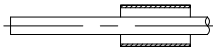

STEP 2
1. STRIP CABLE TO DIMENSIONS AS SHOWN

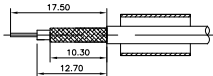

STEP 3
1. FIT CONTACT OVER CENTRE CONDUCTOR TO BUTT AGAINST DIELECTRIC.
2. CRIMP USING TOOL AS NOTES ON PAGE 1.

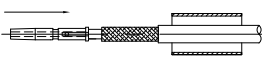

RECOMMENDED CENTRE CONTACT
A/E HEX
1.75

STEP 4
1. PRESS SUB-ASSEMBLY INTO BODY, UNTIL CONTACT IS FULLY LOCATED BY AN AUDIBLE CLICK.
2. ENSURE THAT MAILED HOUSING INSERTS BETWEEN THE DIELECTRIC AND CABLE BRAID.

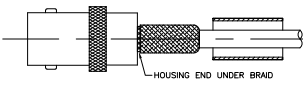

HOUSING END UNDER BRAID

STEP 5
1. SLIDE CRIMP FERRULE ALONG THE CABLE UNTIL IT BUTTS AGAINST THE HOUSING BODY.
2. CRIMP USING TOOL AS NOTED ON PAGE 1.
3. CRIMP DIMENSION AS SHOWN.

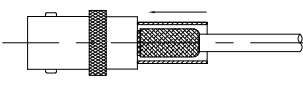

RECOMMENDED CRIMP SLEEVE
A/E HEX
6.50

THIS DRAWING IS A CONTROLLED DOCUMENT.

DESIGNER: J. SANDWELL	DATE: 16/JUN/04	BY: Tyco Electronics Corporation
CHECKED: S. PARLOW	16/06/04	Bideford, UK, EX39 4HE
APPROVED: F. WHEELER-KING	16/06/04	
PRODUCT SPEC: 108-3435		
APPLICATION SPEC: SEE SHEET 2	SIZE: A2	CAGE CODE: 00779
MATERIAL: SEE TABLE	FINISH: SEE TABLE	DRAWING NO: 1634514
		RESTRICTED TO: -
		CUSTOMER DRAWING

SCALE: NTS SHEET 2 OF 2 REV B

AMP 1471-9 REV 31MM2000

1634514

A