

THIS DRAWING IS UNPUBLISHED. RELEASED FOR PUBLICATION 20
 COPYRIGHT 20 BY TYCO ELECTRONICS CORPORATION. ALL RIGHTS RESERVED.
 omnicomponents.com

LOC	DIST	REVISIONS			
P	LTR	DESCRIPTION	DATE	DWN	APVD
J		FIRST ISSUE	02MAY2007	HY	GT
J1		ADDED WIRE & INSULATION RANGE 02MAY07		HY	GT
J2		REVISED PER ECO-09-026346	25NOV09	KK	AEG

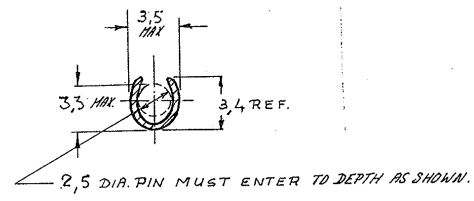
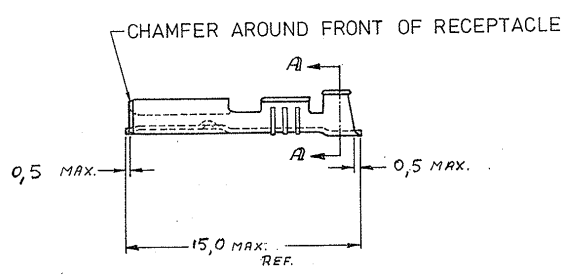

SEC: A-A

1 OBSOLETE PARTS: OBSOLETE CIS STREAMLINING PER D.RENAUD/D.SINISI

1 OBSOLETE	6-160555-0	TIN LEAD	PHOSPH. BRONZE	5-160556-5	0
	5-160555-4	PLAIN	PHOSPH. BRONZE	5-160556-4	0
1 OBSOLETE	5-160555-3	SILVER PLATED	BRASS	5-160556-3	0
	5-160555-2	TIN PLATED	BRASS	5-160556-2	0
1 OBSOLETE	5-160555-1	PLAIN	BRASS	5-160556-1	0
	0-160484-8	TIN LEAD	BRASS	0-160539-7	-
	0-160484-7	PRE-TIN PLATED	PHOSPH. BRONZE	0-160539-6	-
1 OBSOLETE	0-160484-6	TIN PLATED	PHOSPH. BRONZE	0-160539-5	-
	0-160484-3	SILVER PLATED	BRASS	0-160539-3	J
	0-160484-4	TIN PLATED	BRASS	0-160539-2	J
	0-160484-1	PLAIN	BRASS	0-160539-1	J
	STRIP FORM	FINISH	MATERIAL	TYCO P/N	REV

WIRE RANGE 0,5-1,0 mm².
 INSULATION RANGE 2,0-2,5 mm.

<small>THIS DRAWING IS A CONTROLLED DOCUMENT FOR THE ELECTRONICS CORPORATION IT IS SUBJECT TO CHANGE AND THE CONTROLLING ENGINEERING ORGANIZATION SHOULD BE CONTACTED FOR THE LATEST REVISION.</small>		DWN H Yogi	02MAY2007	AMP Italia S.p.A. C.so F.lli Cervi, 15 COLLEGNO (TO)	
DIMENSIONS: mm	TOLERANCES UNLESS OTHERWISE SPECIFIED: 0 PLC ± 1 PLC ±0.3 2 PLC ± 3 PLC ± 4 PLC ± ANGLES ±1°	APVD G. Thico	NAME FASTON* Connector, 2.8 mm series RECEPTACLE CONTACT LOOSE PIECE VERSION	SIZE A 300779	DRAWING NO C-160539
MATERIAL SEE TABLE	FINISH	APPLICATION SPEC	RESTRICTED TO	WEIGHT	CUSTOMER DRAWING
			SCALE 4:1	SHEET 1 OF 1	REV J2