

4

3

2

1

THIS DRAWING IS UNPUBLISHED. RELEASED FOR PUBLICATION SEPT, 2005.
 © COPYRIGHT 2005 BY TYCO ELECTRONICS CORPORATION. ALL RIGHTS RESERVED.

LOC	DIST	REVISIONS			
P	LTR	DESCRIPTION	DATE	DWN	APVD
D		ECR-05-015561	14NOV05	JMS	FWK
E		ECR-08-022547	29AUG08	PK	PB

- NOTES:**
- 1. SINGLE PACK IN ACCORDANCE WITH AMP SPEC 107-3275
 - 2. 100 TRAY PACK IN ACCORDANCE WITH AMP SPEC 107-3275
 - 3. FLASH Au PLATING
 - 4. 0.8µm Au PLATING
 - 5. Ni PLATING
 - 6. THIS ITEM MUST BE WHITE
 - 7. HAND TOOL : 9-1478240-0
 - 8. DIE SET : 9-1478242-0
 - 9. **ELECTRICAL CHARACTERISTICS**
 - FREQUENCY RANGE: DC - 2 GHz
 - NOMINAL IMPEDANCE: 75 Ohm
 - INSULATION RESISTANCE: 5000 MOhm
 - WORKING VOLTAGE: 500 Volts RMS at Sea Level
 - DIELECTRIC WITHSTAND VOLTAGE: 1500 Volts RMS Max
 - CONTACT RESISTANCE: 1.50 mOhm Max
 - CENTRE CONTACT: 0.20 mOhm Max
 - OUTER CONTACT: 1.20 mOhm Max
 - VSWR @ 4GHz: 1.20:1 Max
 - INSERTION LOSS dB @ x 3 GHz: 0.20 Max
 - 10. **MECHANICAL CHARACTERISTICS**
 - COUPLING NUT RETENTION FORCE: 445N Min
 - CABLE RETENTION FORCE: 170N Min
 - DURABILITY: 500 Cycles Min
 - 11. **ENVIRONMENTAL CHARACTERISTICS**
 - OPERATING TEMPERATURE: -65 to +165 DegC

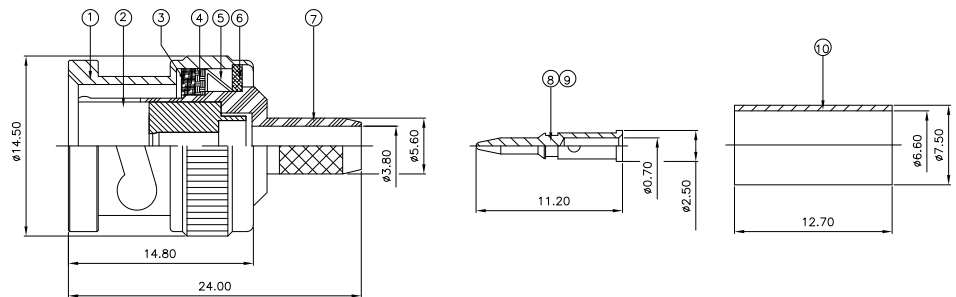

QTY	QTY PER ASSY	QTY PER ASSY	QTY PER ASSY	QTY PER ASSY	MATERIAL	DESCRIPTION	ITEM
1	1	1	1	1	BRASS	FERRULE	10
1	1	-	-	-	BRASS	CONTACT	9
-	-	1	1	1	BRASS	CONTACT	8
1	1	1	1	1	BRASS	BODY	7
1	1	1	1	1	BRASS	WASHER	6
1	1	1	1	1	SPRING STEEL	SPRING	5
1	1	1	1	1	BRASS	WASHER	4
1	1	1	1	1	SILICON RUBBER	GASKET	3
1	1	1	1	1	PTFE	INSULATION	2
1	1	1	1	1	BRASS	SHELL	1
6--1	1--1	6--0	1--0		MATERIAL	DESCRIPTION	ITEM

THIS DRAWING IS A CONTROLLED DOCUMENT.

DIMENSIONS: mm	TOLERANCES UNLESS OTHERWISE SPECIFIED:	DWN J. SANDWELL 12SEPT05	12SEPT05	Tyco Electronics Tyco Electronics Corporation Bideford, UK, EX39 4HE													
	<table border="1"> <tr><td>0 PLC</td><td>±</td></tr> <tr><td>1 PLC</td><td>±</td></tr> <tr><td>2 PLC</td><td>±</td></tr> <tr><td>3 PLC</td><td>±</td></tr> <tr><td>4 PLC</td><td>±</td></tr> <tr><td>ANGLES</td><td>±</td></tr> </table>	0 PLC	±	1 PLC	±	2 PLC	±	3 PLC	±	4 PLC	±	ANGLES	±	CHK S. PARLOW 12SEPT05	12SEPT05	NAME BNC STRAIGHT PLUG CRIMP 75 OHM	
		0 PLC	±														
1 PLC	±																
2 PLC	±																
3 PLC	±																
4 PLC	±																
ANGLES	±																
MATERIAL SEE TABLE	FINISH SEE TABLE	APVD F. WHEELER-KING 12SEPT05	12SEPT05	PRODUCT SPEC 108-3435													
				APPLICATION SPEC 411-3247													
				SIZE A3	CAGE CODE 00779												
				DRAWING NO C=1337428													
				RESTRICTED TO -													
				CUSTOMER DRAWING													
				SCALE NTS	SHEET 1 OF 2												
					REV E												

4

3

2

1

THIS DRAWING IS UNPUBLISHED.

RELEASED FOR PUBLICATION SEPT ,2005.

COPYRIGHT 2005 BY TYCO ELECTRONICS CORPORATION. ALL RIGHTS RESERVED.

LOC	DIST	REVISIONS			
P	LTR	DESCRIPTION	DATE	DWN	APVD
E	B	SEE SHEET 1	-	-	-

ASSEMBLY INSTRUCTION

CABLES: RG59B/U

STEP 1

1. SLIDE METAL CRIMP FERRULE OVER CABLE

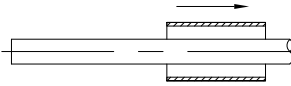

STEP 2

1. STRIP CABLE TO DIMENSIONS AS SHOWN

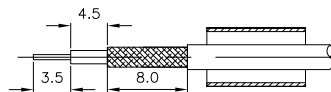

STEP 3

1. FIT CONTACT OVER CENTRE CONDUCTOR TO BUTT AGAINST DIELECTRIC.
2. CRIMP USING TOOL AS NOTES ON PAGE 1.

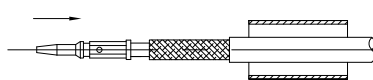
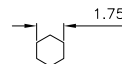
RECOMMENDED CENTRE CONTACT
A/F HEX

STEP 4

1. PRESS SUB-ASSEMBLY INTO BODY, UNTIL CONTACT IS FULLY LOCATED BY AN AUDIBLE CLICK.
2. ENSURE THAT KNURLED HOUSING INSERTS BETWEEN THE DIELECTRIC AND CABLE BRAID.

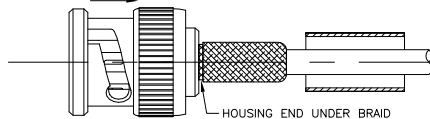

HOUSING END UNDER BRAID

STEP 5

1. SLIDE CRIMP FERRULE ALONG THE CABLE UNTIL IT BUTTS AGAINST THE HOUSING BODY.
2. CRIMP USING TOOL AS NOTED ON PAGE 1.
3. CRIMP DIMENSION AS SHOWN.

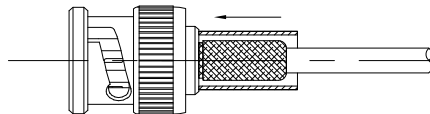
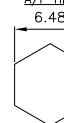
RECOMMENDED CRIMP SLEEVE
A/F HEX

THIS DRAWING IS A CONTROLLED DOCUMENT.

DWN J.SANDWELL 12SEPT05

CHK S.PARLOW 12SEPT05

APVD E.WHEELER-KING 12SEPT05

Tyco Electronics Corporation
Bideford, UK, EX39 4HE

DIMENSIONS:	TOLERANCES UNLESS OTHERWISE SPECIFIED:
mm	
0 PLC	± -
1 PLC	± -
2 PLC	± -
3 PLC	± -
4 PLC	± -
ANGLES	± -
FINISH	



SEE TABLE

SEE TABLE

NAME

PRODUCT SPEC

APPLICATION SPEC

WEIGHT

CUSTOMER DRAWING

S.PARLOW

E.WHEELER-KING

108-3435

411-3247

-

-

-

-

-

-

-

-

-

-

-

-

-

-

-

-

-

-

-

-

-

-

-

-