

PLEASE CHECK WWW.MOLEX.COM FOR LATEST PART INFORMATION

Part Number: [0481460011](#)
Status: **Active**
Overview: [modular_plugs_jacks](#)
Description: Modular Jack, Right Angle, Low Profile, Inverted, Shielded, with LEDs, 8/8, LED Color: Left (Green); Right (Amber), Lead Free

Documents:

[3D Model](#) [Product Specification PS-48146-001 \(PDF\)](#)
[Drawing \(PDF\)](#) [RoHS Certificate of Compliance \(PDF\)](#)

General

Product Family	Modular Jacks/Plugs
Series	48146
Comments	With LED
Component Type	PCB Jack
Magnetic	No
Overview	modular_plugs_jacks
Performance Category	5
Power over Ethernet (PoE)	N/A
Product Name	RJ45

Physical

Boot Color	N/A
Color - Resin	Black
Durability (mating cycles max)	750
Inverted / Top Latch	Yes
Keying to Mating Part	Yes
Lightpipes/LEDs	LEDs
Material - Metal	Brass, Phosphor Bronze
Material - Plating Mating	Gold
Material - Plating Termination	Tin
Material - Resin	High Temperature Thermoplastic
Orientation	Right Angle (Side Entry)
PCB Locator	Yes
PCB Retention	Yes
PCB Thickness Recommended (in)	0.062 In
PCB Thickness Recommended (mm)	1.60 mm
Packaging Type	Tray
Panel Mount	Without Flange
Pitch - Mating Interface (in)	0.080 In
Pitch - Mating Interface (mm)	2.03 mm
Pitch - Term. Interface (in)	0.080 In
Pitch - Term. Interface (mm)	2.03 mm
Plating min: Mating (µin)	50
Plating min: Mating (µm)	1.27
Plating min: Termination (µin)	100
Plating min: Termination (µm)	2.54
Ports	1
Positions / Loaded Contacts	8/8
Surface Mount Compatible (SMC)	No
Temperature Range - Operating	-40°C to +85°C
Termination Interface: Style	Through Hole
Wire/Cable Type	N/A

Electrical

Current - Maximum per Contact	1.5A
-------------------------------	------

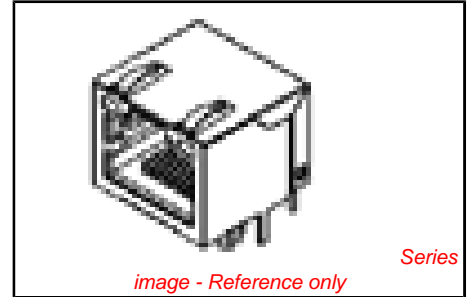

EU RoHS

ELV and RoHS Compliant

REACH SVHC

Not Reviewed

Halogen-Free

Status

Not Reviewed

Need more information on product environmental compliance?

Email productcompliance@molex.com
 For a multiple part number RoHS Certificate of Compliance, [click here](#)

Please visit the [Contact Us](#) section for any non-product compliance questions.

China RoHS



Search Parts in this Series

[48146Series](#)

Mates With

FCC 68 Plugs

Grounding to PCB
Grounding to Panel
Shielded
Voltage - Maximum

No
Panel Ground Tab
Yes
150V AC

Material Info

Reference - Drawing Numbers

Packaging Specification	PK-48146-001
Product Specification	PS-48146-001
Sales Drawing	SD-48146-001
Test Summary	TS-48146-001

This document was generated on 06/07/2010

PLEASE CHECK WWW.MOLEX.COM FOR LATEST PART INFORMATION

10 9 8 7 6 5 4 3 2 1

NOTES:
 1.MATERIAL:
 METAL SHELL: BRASS
 HOUSING: HIGH TEMP THERMOPLASTIC,UL94V-0,COLOR:BLACK
 INSERT: HIGH TEMP THERMOPLASTIC,UL94V-0,COLOR:BLACK
 TERMINAL: PHOSPHOR BRONZE
 2.PLATING:
 TERMINAL:
 CONTACT AREA: GOLD(Au),THICKNESS=50 MICROINCH/1.27 MICROMETER
 SOLDER TAIL: TIN(Sn),THICKNESS=100 MICROINCH MINIMUM,
 UNDER PLATE: NICKEL (Ni).
 METAL SHELL:
 SOLDER TAIL: TIN(Sn),THICKNESS=100 MICROINCH MINIMUM,
 UNDER PLATE: NICKEL (Ni),(SOLDERING AVAILABLE)
 SURFACE APPEARANCE: BRIGHT.
 3.RECOMMENDED PCB THICKNESS: 1.60±0.05
 4.PRODUCT SPECIFICATION REFER TO PS-48146-001
 5.TEST SUMMARY REFER TO TS-48146-001
 6.PACKAGING SPECIFICATION REFER TO PK-48146-001.
 7.LEAD FREE AND ROHS COMPLIANT PRODUCT.

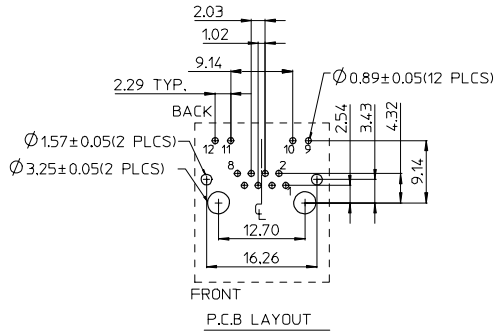
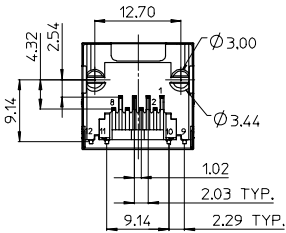
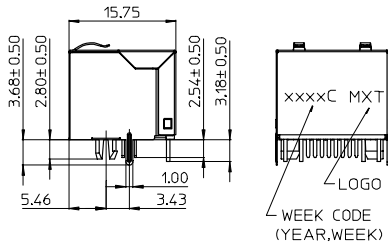
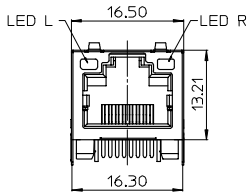

LED ELECTRICAL SPECIFICATION

PARAMETER	GREEN (TYP.)	AMBER (TYP.)	UNITS	TEST CONDITIONS
POWER DISSIPATION	105	100	mW	
REVERSE VOLTAGE	5	5	V	
PEAK WAVELENGTH	565	600	nm	IF=20mA
FORWARD VOLTAGE	2.2 MAX.=2.5	2.1 MAX.=2.5	V	IF=20mA

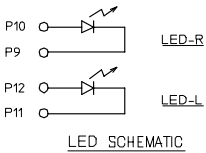

LED SCHEMATIC

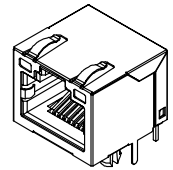
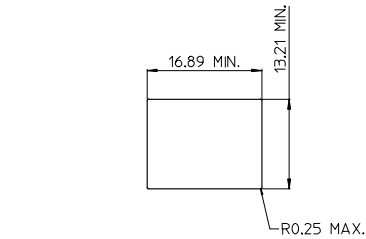

RECOMMENDED PANEL CUTOUT

P/N	LED COLOR	
	LEFT	RIGHT
48146-0001	GREEN	GREEN
48146-0011	GREEN	AMBER
48146-0010	AMBER	GREEN

ADD NEW P/N EC NO. SH2007-0138 DRAWN: LILIN CHKD: CHIKO APPR: WWSCHANG 2006/09/12 2006/09/13 2006/09/13	QUALITY SYMBOLS	GENERAL TOLERANCES (UNLESS SPECIFIED)	DIMENSION STYLE	SCALE	DESIGN UNITS	THIRD ANGLE PROJECTION															
	$\nabla=0$ $\nabla=0$		MM ONLY	1:1	METRIC																
	DESCRIPTION	<table border="1"> <tr> <th></th> <th>mm</th> <th>INCH</th> </tr> <tr> <td>4 PLACES</td> <td>±---</td> <td>±---</td> </tr> <tr> <td>3 PLACES</td> <td>±---</td> <td>±---</td> </tr> <tr> <td>2 PLACES</td> <td>±0.25</td> <td>±---</td> </tr> <tr> <td>1 PLACE</td> <td>±0.25</td> <td>±---</td> </tr> </table>		mm	INCH	4 PLACES	±---	±---	3 PLACES	±---	±---	2 PLACES	±0.25	±---	1 PLACE	±0.25	±---	DRAWN BY: LINDA DATE: 2004/07/27 CHECKED BY: ALL IN DATE: 2004/07/27 APPROVED BY: WWSCHANG DATE: 2004/07/27	TITLE: CATEGORY 5 MODULAR JACK 8 POSITION, 8 CONTACTS		
		mm	INCH																		
4 PLACES	±---	±---																			
3 PLACES	±---	±---																			
2 PLACES	±0.25	±---																			
1 PLACE	±0.25	±---																			
REV	DRAFT WHERE APPLICABLE MUST REMAIN WITHIN DIMENSIONS	SEE TABLE	MATERIAL NO.	DOCUMENT NO.	MOLEX INCORPORATED SD-48146-001																

9 8 7 6 5 4 3 2 1