

**PLEASE CHECK WWW.MOLEX.COM FOR LATEST PART INFORMATION**

**Part Number:** [0901700014](#)  
**Status:** **Active**  
**Description:** 2.54mm (.100") Pitch QF-50™, Strain Relief, DIN 41651, Standard Low Profile, 14 Circuits

**Documents:**

[3D Model](#) [Product Specification PS-99020-0015 \(PDF\)](#)  
[Drawing \(PDF\)](#) [RoHS Certificate of Compliance \(PDF\)](#)

**General**

Product Family Ribbon Cable / Wire Trap Connectors  
 Series 90170  
 Component Type Strain Relief  
 Glow-Wire Compliant No  
 Product Name QF-50™

**Physical**

Circuits (Loaded) N/A  
 Circuits (maximum) 14  
 Color - Resin Black  
 Entry Angle N/A  
 Lock to Mating Part Yes  
 Material - Resin Polyester  
 Number of Rows 2  
 PCB Locator No  
 PCB Retention None  
 Packaging Type Bag  
 Pitch - Mating Interface (in) 0.050 In  
 Pitch - Mating Interface (mm) 1.27 mm  
 Polarized to Mating Part No  
 Stackable No  
 Temperature Range - Operating -25°C to +85°C  
 Wire Insulation Diameter N/A  
 Wire Size AWG N/A  
 Wire/Cable Type Ribbon Cable

**Electrical**

Current - Maximum per Contact 1A  
 Voltage - Maximum 250V AC/DC

**Material Info**

**Reference - Drawing Numbers**

Product Specification PS-99020-0015  
 Sales Drawing SD-90170

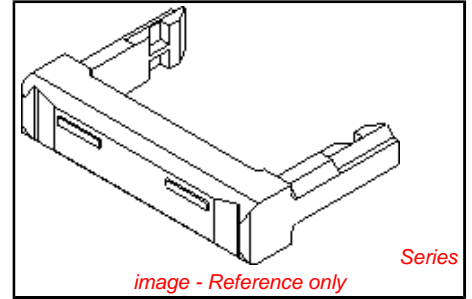

<p><b>EU RoHS</b>  <b>ELV and RoHS</b>  <b>Compliant</b>  <b>REACH SVHC</b>  <b>Contains SVHC: No</b>  <b>Halogen-Free</b>  <b>Status</b>  <b>Not Halogen-Free</b></p>	<p><b>China RoHS</b></p> 
--	--

**Need more information on product environmental compliance?**

Email [productcompliance@molex.com](mailto:productcompliance@molex.com)  
 For a multiple part number RoHS Certificate of Compliance, [click here](#)

Please visit the [Contact Us](#) section for any non-product compliance questions.

**Search Parts in this Series**  
 90170Series

**Use With**  
 5320 , 90635

**PLEASE CHECK WWW.MOLEX.COM FOR LATEST PART INFORMATION**

PART NO.  
SEE CHART  
DWC. REF  
SD-90170

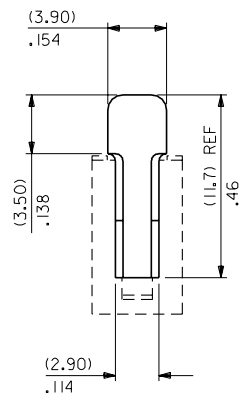
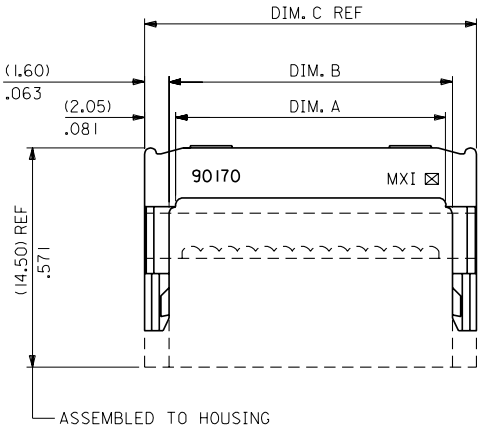
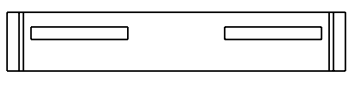

90170-0064	YES	64	(81.81)/3.221	(82.70)/3.256	(85.90)/3.382
-0060	↑	60	(76.73)/3.021	(77.63)/3.056	(80.83)/3.182
-0050		50	(64.03)/2.521	(64.93)/2.556	(63.13)/2.682
-0040		40	(51.33)/2.021	(52.23)/2.056	(55.43)/2.182
-0034		34	(43.71)/1.721	(44.61)/1.756	(47.81)/1.882
-0030		30	(38.63)/1.521	(39.53)/1.556	(42.73)/1.682
-0026		26	(33.55)/1.321	(34.45)/1.356	(37.65)/1.482
-0020		20	(25.93)/1.021	(26.83)/1.056	(30.03)/1.182
-0016		16	(20.85)/.821	(21.75)/.856	(24.95)/.982
-0014	↓	14	(18.31)/.721	(19.21)/.756	(22.41)/.882
90170-0010	YES	10	(13.23)/.521	(14.13)/.556	(17.33)/.682
PART NUMBER	TOOLED	CCTS.	DIM. A (±0.20) ±.008	DIM. B (±0.20) ±.008	DIM. C REF

NOTES  
 1. MATERIAL: G.F. POLYESTER, 94V-0, COLOUR BLACK .  
 2. THIS PART MATES WITH HOUSING ASSEMBLIES, SERIES 5320 5321, 52037, 90573 AND 90574 .

FOR PREVIOUS DRAWING ISSUES SEE MRI.

REDRAWN ON CAD ECN E30020 26 AUGUST 1992 SM	LTR REVISIONS	DIMENSIONS SHOWN ( METRIC ) INCH UNLESS OTHERWISE SPECIFIED TOLERANCES: ANGULAR ± 8° INCH ( METRIC ) 3 PLACE ± .008 2 PLACE ± .020 1 PLACE ± .050 DRAFT WHERE APPL (TABLE MUST REMAIN WITHIN DIMENSIONS) DESIGN DIMENSION (MM) □ (IN) EQUIVALENT DIMENSION (SECONDARY) □ (MM) □ (IN)	DRWG BY KC CHK'D BY APP'D BY SCALE 4:1
---	------------------	---	---

REVISE ONLY ON CAD SYSTEM		SH.	REV.
CAD/CAM FILENAME SD90170X1 DCW	THIS DRAWING CONTAINS INFORMATION THAT IS PROPRIETARY TO MOLEX INC. & SHOULD NOT BE USED WITHOUT WRITTEN PERMISSION		
TITLE QIK-FLECS, DIN STANDARD LOW PROFILE STRAIN RELIEF			
MOLEX EUROPE		SHEET NO. 1 OF 1	DATE 87/07/17
PART NO. SEE CHART	DWG NO. SD-90170	SIZE B	

7132-1283