

**PLEASE CHECK WWW.MOLEX.COM FOR LATEST PART INFORMATION**

**Part Number:** **0500128000**  
**Status:** **Active**  
**Description:** 2.00mm (.079") Pitch Crimp Terminal, Reel, for 51006 Housing

**Documents:**

<a href="#">3D Model</a>	<a href="#">Product Specification PS-51005-001 (PDF)</a>
<a href="#">Drawing (PDF)</a>	<a href="#">RoHS Certificate of Compliance (PDF)</a>

**General**

Product Family	Crimp Terminals
Series	50012
Crimp Quality Equipment	Yes
Product Name	N/A

**Physical**

Gender	Male
Material - Metal	Phosphor Bronze
Material - Plating Mating	Tin
Material - Plating Termination	Tin
Packaging Type	Reel
Plating min: Mating (µm)	36
Plating min: Mating (µm)	0.90
Plating min: Termination (µm)	36
Plating min: Termination (µm)	0.90
Termination Interface: Style	Crimp or Compression
Wire Insulation Diameter	0.90-1.15mm (.035-.045")
Wire Size AWG	24, 26, 28
Wire Size mm <sup>2</sup>	N/A

**Electrical**

Current - Maximum per Contact	2A
Voltage - Maximum	125V

**Material Info**

**Reference - Drawing Numbers**

Product Specification	PS-51005-001
Sales Drawing	SD-50012-001

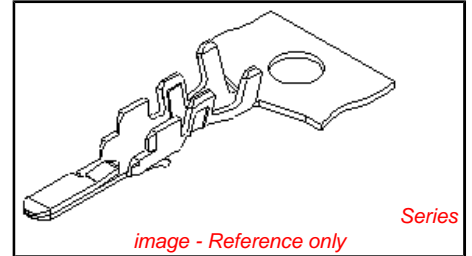

**EU RoHS**

**ELV and RoHS  
Compliant**  
**REACH SVHC**  
**Contains SVHC: No**  
**Halogen-Free  
Status**  
**Halogen-Free**

**China RoHS**



**Need more information on product environmental compliance?**

Email [productcompliance@molex.com](mailto:productcompliance@molex.com)  
 For a multiple part number RoHS Certificate of Compliance, [click here](#)

Please visit the [Contact Us](#) section for any non-product compliance questions.

**Search Parts in this Series**  
50012Series

**Mates With**  
50013

**Use With**  
51006

**Application Tooling | FAQ**

*Tooling specifications and manuals are found by selecting the products below. Crimp Height Specifications are then contained in the Application Tooling Specification document.*

**Global**

Description	Product #
Hand Crimp Tool, UL	<a href="#">0638117800</a>
Approved	
T2 Terminator Die	<a href="#">0638515000</a>
FineAdjust™	<a href="#">0638615000</a>
Applicator	

**Japan**

Description	Product #
-------------	-----------

Applicator for M211A [0570453000](#)  
Bench Press, 24-28  
AWG, for 50012  
Crimp Terminal

This document was generated on 04/15/2010

**PLEASE CHECK [WWW.MOLEX.COM](http://WWW.MOLEX.COM) FOR LATEST PART INFORMATION**

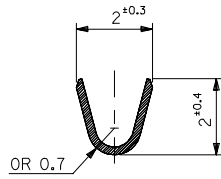
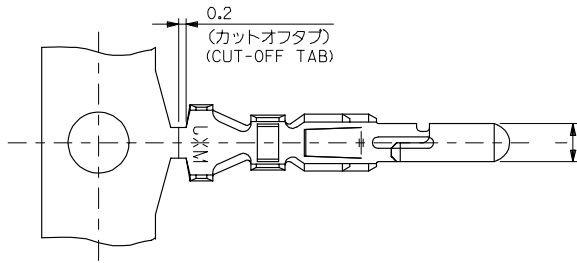

SECT.A-A

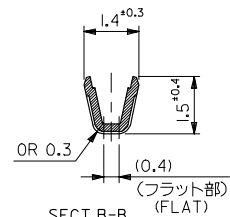

SECT.B-B

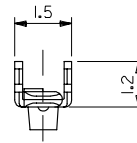
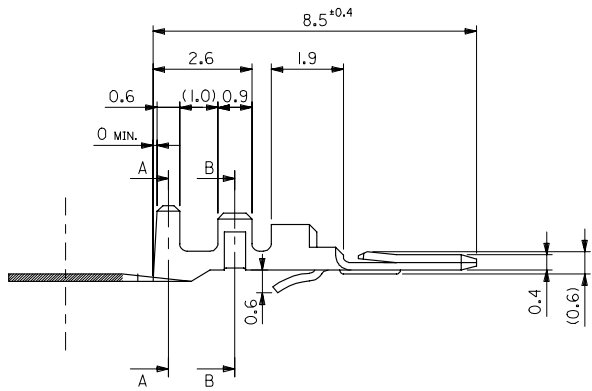

注記  
NOTES

- 適合ハウジング : 51006  
APPLICABLE HOUSING : 51006
- 嵌合相手 : 50013  
MATE WITH : 50013
- ELV 及 RoHS 適合品  
ELV AND RoHS COMPLIANT.

材料 MATERIAL	リン青銅 銅メッキ (t=0.2) PHOS. BRO. PRE-TINNED (t=0.2)
仕上げ FINISH	—
適用導線範囲 WIRE RANGE	AWG#24 - #28
被覆外径 INS. RANGE	φ0.9 - φ1.15

REVISED	EC NO. J2008-0075	2007/07/16
DRW: HIRABEI	2007/07/17	
CHK: THIRUYANA	2007/07/17	
APP: NUKITA	2007/07/17	
DESCRIPTION		

GENERAL TOLERANCES (UNLESS SPECIFIED)	
10 UNDER	± 0.2
10 OVER 30 UNDER	± 0.25
30 OVER	± 0.3
ANGULAR	± 3 °
DRAFT WHERE APPLICABLE MUST REMAIN WITHIN DIMENSIONS	

DIMENSION STYLE MM ONLY	
DRAWN BY	T. YASUI
DATE	'95/08/21
CHECKED BY	H. HIRAMOTO
DATE	'95/08/22
APPROVED BY	M. FUKUSHIMA
DATE	'95/08/22
MATERIAL NO.	
SIZE	A3

SCALE	10:1
DESIGN UNITS	METRIC
THIRD ANGLE PROJECTION	☑
TITLE	
2.0 WIRE TO WIRE CONN. CRIMP PIN	
MOLEX INCORPORATED	
DOCUMENT NO.	SD-50012-001
SHEET NO.	1 OF 1