

Soberton Inc.

EM9445, EM9445P

Omnidirectional Electret Condenser Microphone

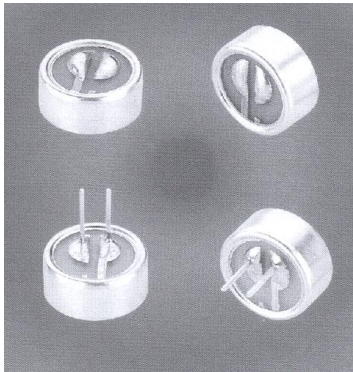

Sensitivity	0dB = 1V/Pa. 1KHz
Directivity	Omnidirectional
Impedance	Low Impedance
Current Consumption	Max. 0.5mA
Standard Operation Voltage	4.5V
Sensitivity Reduction	Within -3dB at 1.5V
S/N Ratio	More than 60dB
Sensitivity Range	-36 ± 2dB, -38 ± 2dB, -40 ± 2dB, -42 ± 2dB, -44 ± 2dB, -46 ± 2dB

Typical Frequency Response Curve:

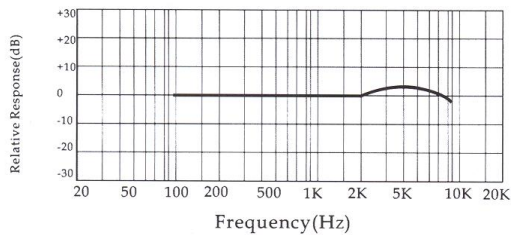

EM9445

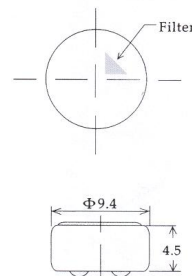

EM9445P

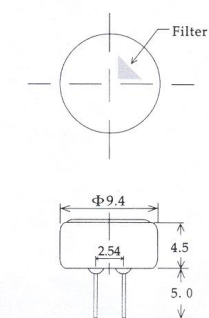

Schematic Diagram:

