



CMPS5061
 CMPS5062
 CMPS5063
 CMPS5064

**SURFACE MOUNT
 SILICON CONTROLLED RECTIFIER**



SOT-23 CASE

CentralTM Semiconductor Corp.

DESCRIPTION:

The CENTRAL SEMICONDUCTOR CMPS5061 Series types are epoxy molded PNP Silicon Controlled Rectifiers manufactured in an SOT-23 case, designed for control systems and sensing circuit applications.

MARKING CODES: CMPS5061: P2A
 CMPS5062: P2B
 CMPS5063: P2C
 CMPS5064: P2D

MAXIMUM RATINGS: (T_A=25°C)

Peak Repetitive Off-State Voltage
 Peak Repetitive Reverse Voltage
 RMS On-State Current
 Average On-State Current (T_C=67°C)
 Power Dissipation
 Operating Junction Temperature
 Storage Temperature
 Thermal Resistance

SYMBOL	CMPS 5061	CMPS 5062	CMPS 5063	CMPS 5064	UNITS
V _{DRM}	100	200	300	400	V
V _R RM	100	200	300	400	V
I _T (RMS)		0.80			A
I _T (AV)		0.51			A
P _D		350			mW
T _J		-65 to +125			°C
T _{stg}		-65 to +150			°C
θ _{JA}		286			°C/W

ELECTRICAL CHARACTERISTICS: (T_A=25°C)

SYMBOL	TEST CONDITIONS	<u>CMPS5061</u> <u>CMPS5062</u> <u>CMPS5063</u> <u>CMPS5064</u>				UNITS	
		MIN	MAX	MIN	MAX		
I _{DRM}	V _D =Rated V _{DRM} , R _{GK} =1.0KΩ	-	1.0	-	1.0	μA	
I _{RRM}	V _D =Rated V _{DRM} , R _{GK} =1.0KΩ	-	1.0	-	1.0	μA	
I _{DRM}	V _D =Rated V _{DRM} , R _{GK} =1.0KΩ, T _C =125°C	-	50	-	50	μA	
I _{RRM}	V _D =Rated V _{DRM} , R _{GK} =1.0KΩ, T _C =125°C	-	50	-	50	μA	
V _{TM}	I _T =1.2A	-	1.7	-	1.7	V	
I _{GT}	V _D =7.0V, R _L =100Ω	-	200	-	200	μA	
V _{GT}	V _D =7.0V, R _L =100Ω	-	0.8	-	0.8	V	
V _{GD}	V _D = Rated V _{DRM} , R _L =100Ω, T _C =125°C	0.1	-	0.1	-	0.1	V
I _H	R _{GK} =1.0KΩ	-	5.0	-	5.0	mA	
t _{ON}	V _D = Rated V _{DRM} , I _{GT} =1.0mA, R _{GK} =1.0KΩ, di/dt=6.0A/μs		2.8 TYP		2.8 TYP		μs

R8 (5-August 2009)

**SURFACE MOUNT
SILICON CONTROLLED RECTIFIER**

SOT-23 CASE - MECHANICAL OUTLINE

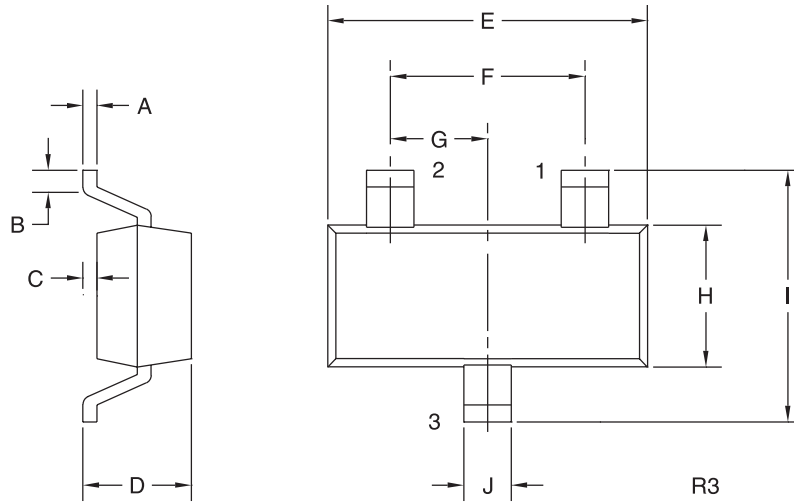

LEAD CODE:

- 1) CATHODE
- 2) GATE
- 3) ANODE

MARKING CODES:

- CMPS5061: P2A
- CMPS5062: P2B
- CMPS5063: P2C
- CMPS5064: P2D

DIMENSIONS				
SYMBOL	INCHES		MILLIMETERS	
	MIN	MAX	MIN	MAX
A	0.003	0.007	0.08	0.18
B	0.006	-	0.15	-
C	-	0.005	-	0.13
D	0.035	0.043	0.89	1.09
E	0.110	0.120	2.80	3.05
F	0.075		1.90	
G	0.037		0.95	
H	0.047	0.055	1.19	1.40
I	0.083	0.098	2.10	2.49
J	0.014	0.020	0.35	0.50

SOT-23 (REV: R3)

R8 (5-August 2009)