

**PLEASE CHECK WWW.MOLEX.COM FOR LATEST PART INFORMATION**

**Part Number:** [0357182110](#)  
**Status:** **Active**  
**Description:** 4.75mm (.187") Tab Safe Lock Terminal, Quick Disconnect, Female, 0.81mm (.032") Tab Thickness, Wire Range 16-20 AWG (1.31-0.52mm<sup>2</sup>), Pre-Tin Plated

**Documents:**

[Drawing \(PDF\)](#) [RoHS Certificate of Compliance \(PDF\)](#)  
[Product Specification PS-35718-1210 \(PDF\)](#)

**Agency Certification**

TUV R9451159

**General**

Product Family Quick Disconnects  
 Series [35718](#)  
 Crimp Quality Equipment Yes  
 Product Name Safelock  
 Type Quick Disconnect

**Physical**

Barrel Type Open  
 Gender Female  
 Glow-Wire Compliant No  
 Insulation None  
 Lock to Mating Part Yes  
 Material - Metal Brass  
 Material - Plating Mating Tin  
 Material - Plating Termination Tin  
 Orientation Straight  
 Packaging Type Reel  
 Plating min: Mating (µin) 40  
 Plating min: Mating (µm) 1  
 Plating min: Termination (µin) 40  
 Plating min: Termination (µm) 1  
 Polarized to Mating Part No  
 Tab Thickness 0.81mm (.032")  
 Tab Width 4.75mm (.187")  
 Temperature Range - Operating -40°C to +105°C  
 Termination Interface: Style Crimp or Compression  
 Wire Insulation Diameter 2.50mm (.098") max.  
 Wire Size AWG 16, 18, 20  
 Wire Size mm<sup>2</sup> 0.50 - 1.30

**Electrical**

Voltage - Maximum 250V

**Material Info**

**Reference - Drawing Numbers**

Product Specification PS-35718-1210  
 Sales Drawing SD-35718-210

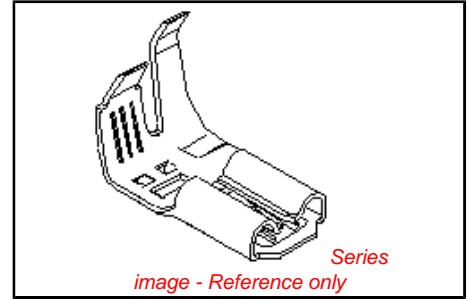

**EU RoHS**

**ELV and RoHS Compliant**  
**REACH SVHC Contains SVHC: No**  
**Halogen-Free Status**  
**Halogen-Free**

**China RoHS**



**Need more information on product environmental compliance?**

Email [productcompliance@molex.com](mailto:productcompliance@molex.com)  
 For a multiple part number RoHS Certificate of Compliance, [click here](#)

Please visit the [Contact Us](#) section for any non-product compliance questions.

**Search Parts in this Series**  
[35718Series](#)

**Use With**  
 4.75mm (.187") Tab

**Application Tooling | FAQ**

*Tooling specifications and manuals are found by selecting the products below. Crimp Height Specifications are then contained in the Application Tooling Specification document.*

**Global**

| Description          | Product #  |
|----------------------|------------|
| Mini-Mac™            | 0638012800 |
| Applicator Rear Feed |            |

**PLEASE CHECK WWW.MOLEX.COM FOR LATEST PART INFORMATION**

DO NOT SCALE DRAWING DIMENSION IN METRIC

PROJECT NO.

SIMILAR ITEM

DWG. NO.  
SD-35718-210

B

C

D

E

F

8 7 6 5 4 3 2 1

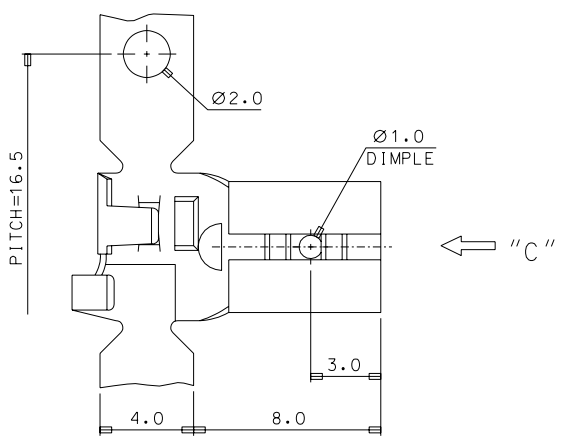

NOTES

1. MATERIAL : BRASS, 0.35mm THICKNESS
2. FINISH : 35718-2100 (UNPLATED)  
35718-2110 (POST PLATED TIN)
3. APPLICABLE WIRE RANGE : AWG #20 - #16

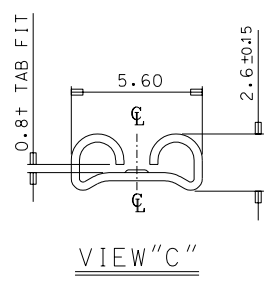
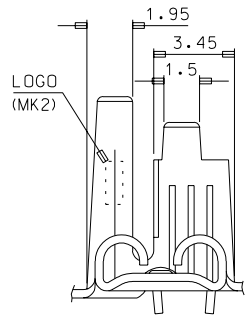
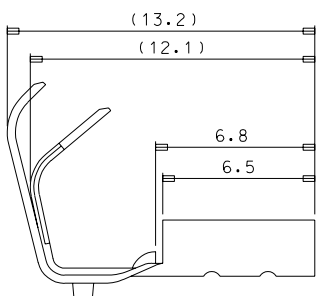

|  |   |   |            |  |  |   |                     |           |
|--|---|---|------------|--|--|---|---------------------|-----------|
| REDRAWN<br>EC NO. KOR2004-0117<br>DRWN: C.B.CHIN 04/03/08<br>CHFK: W.Y.YANG<br>APPR: C.W.LEE | QUALITY SYMBOLS<br>MAJOR $\nabla = 0$<br>CRITICAL $\triangle = 0$ | GENERAL TOLERANCES:<br>(UNLESS SPECIFIED)   |            | SCALE 6:1                              | DESIGN UNITS<br><input checked="" type="checkbox"/> MM <input type="checkbox"/> INCH | THIRD ANGLE PROJECTION<br><input type="checkbox"/> MM <input type="checkbox"/> INCH <input checked="" type="checkbox"/> MM ONLY | SHT                 | REV       |
|  |   | 4 PLACES $\pm 0.$ $\pm$<br>3 PLACES $\pm 0.$ $\pm$<br>2 PLACES $\pm 0.20$ $\pm$<br>1 PLACE $\pm 0.30$ $\pm$ | mm    INCH | DRAWN BY & DATE<br>C.B.CHIN 04/02/12   | TITLE:<br>.187 FLAG RECEPTANCE TERMINAL<br>(0.8+ TAB)                                |   | REVISE ON CAD ONLY  |           |
| A  | DESCRIPTION   | ANGULAR: $\pm 1^\circ$<br>DRAFT WHERE APPLICABLE MUST REMAIN WITHIN DIMENSIONS                              |            | CHECKED BY & DATE<br>W.Y.YANG 04/02/12 | MOLEX INCORPORATED   |   | SHEET NO.<br>1 OF 1 | SIZE<br>B |
|  |   |   |            | CAD FILENAME<br>S7182110.DGN           | MATERIAL NO.<br>SEE NOTES  | DRAWING NO.<br>SD-35718-210   | MX-A3               |           |