

Features

- Compact type
- Radiation size 1.3mm × 2.9mm
- Surface mount lead configuration

Ordering Information

Type NO.	Marking	Package Code
SDZ5V1	Z2	SOT-23

Outline Dimensions

unit : mm

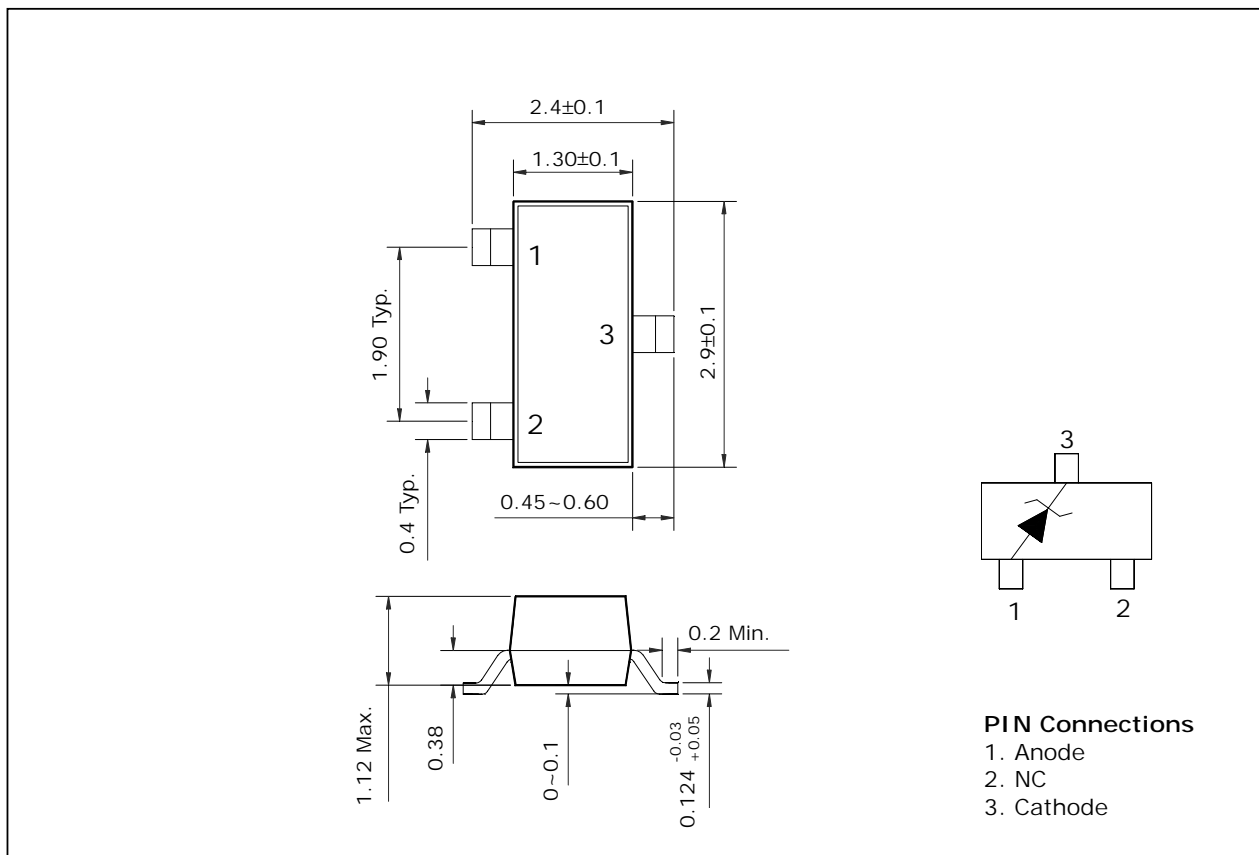

Absolute maximum ratings**(Ta=25°C)**

Characteristic	Symbol	Ratings	Unit
Power dissipation	P_D	200	mW
Junction temperature	T_j	150	°C
Storage temperature	T_{stg}	-55 ~ 150	°C

Electrical Characteristics**(Ta=25°C)**

Characteristic	Symbol	Test Condition	Min.	Typ.	Max.	Unit
Zener voltage	V_Z	$I_Z=5mA$	4.88	-	5.32	V
Dynamic impedance	Z_{zT}	$I_Z=5mA$	-	-	50	Ω
KNEE dynamic impedance	Z_{zK}	$I_Z=0.25mA$	-	-	2050	Ω
Reverse current	I_R	$V_R=2V$	-	-	2	μA

Electrical Characteristic Curves

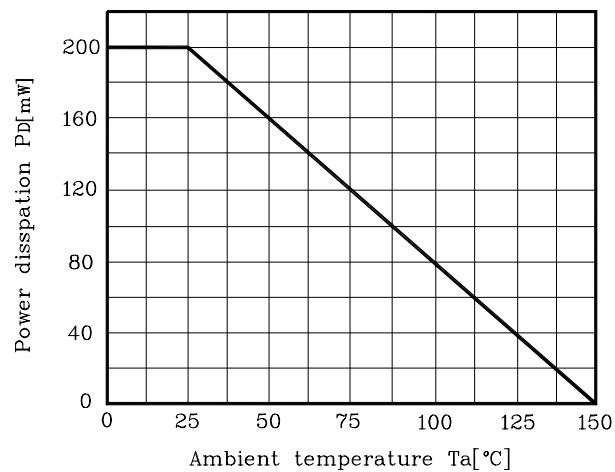
Fig. 1 P_D - T_a Fig. 2 I_Z - V_Z 