

SLF6018-TYPE

SMD Power Inductor

Shape

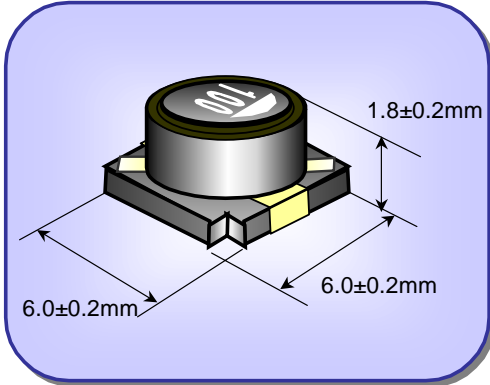

Features :

- Miniature Size :
Mount Area : 6.0mmX6.0mm
Low Profile : 2.0mm Max. height
- Generic use for portable DC/DC Converter.
- High Magnetic Shield Construction should actualize High Resolution for EMC Protection.
- Automatic Mounting in Tape & Reel Package.

Applications :

VCR Camera, PDA, HDD, LCD Display,
Cellular Phone, Cordless Telephone, etc.

Dimensions & Recommended PCB Pattern

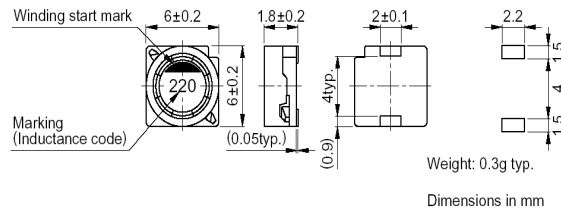

Electrical Characteristics

| Item Descriptions | Inductance | Inductance Tolerance | Test Freq. | DC Resistance | Rated DC Current | |
|---------------------|------------|----------------------|------------|-------------------------|------------------|---------------|
| | [μ H] | [%] | [kHz] | [Ω] $\pm 20\%$ | IDC1 [A] max. | IDC2 [A] typ. |
| SLF6018T- 4R7MR96-K | 4.7 | ± 20 | 1 | 0.17 | 1.70 | 0.96 |
| SLF6018T- 6R8MR87-K | 6.8 | ± 20 | 1 | 0.20 | 1.40 | 0.87 |
| SLF6018T- 100MR68-K | 10.0 | ± 20 | 1 | 0.32 | 1.10 | 0.68 |
| SLF6018T- 150MR56-K | 15.0 | ± 20 | 1 | 0.49 | 0.93 | 0.56 |
| SLF6018T- 220MR49-K | 22.0 | ± 20 | 1 | 0.65 | 0.76 | 0.49 |
| SLF6018T- 330MR38-K | 33.0 | ± 20 | 1 | 1.0 | 0.68 | 0.38 |
| SLF6018T- 470MR36-K | 47.0 | ± 20 | 1 | 1.2 | 0.58 | 0.36 |
| SLF6018T- 680MR33-K | 68.0 | ± 20 | 1 | 1.5 | 0.48 | 0.33 |
| SLF6018T- 101MR30-K | 100.0 | ± 20 | 1 | 3.2 | 0.30 | 0.30 |

§ Rated DC current : the less value which is IDC1 or IDC2

Idc1 : Rated Current based on inductance change (-30% reduction from initial value)

Idc2 : Rated Current based on temperature rise (25 typical)