

Electrical / Environmental

HM67

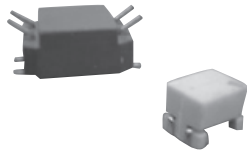

Surface Mount Common Mode Chokes

- Operating Temperature Range -40°C to +125°C
- Ambient Temperature, Maximum 85°C
- Temperature Rise, Maximum 40°C
- Dielectric Withstanding Voltage 300Vdc

Schematic

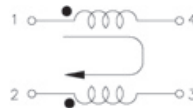

Specifications

Part Number	Terminals	Common Mode Inductance	Inductance Leakage	Rated Current mA	DCR ⁽²⁾	Marking Code	Figure
		@ 100 kHz - 0.1 V (1-4 or 2-3) μ H	@ 100 kHz - 0.1 Vrms (1-4) ⁽¹⁾ Typ. μ H		Max. m Ω		
HM67-B5R0	1-4, 2-3	5.0 \pm 30%	0.08	1000	7.2	A	1
HM67-B110	1-4, 2-3	11.0 \pm 30%	0.10	500	5.8	B	1
HM67-S250	1-4, 2-3	25.0 \pm 30%	1.60	500	9.8	C	1
HM67-B510	1-4, 2-3	51.0 \pm 30%	1.90	500	7.2	D	1
HM67-S510	1-4, 2-3	51.0 \pm 30%	2.80	500	9.4	E	1
HM67-B471	1-4, 2-3	470.0 \pm 30%	0.80	500	8.2	F	1
HM67-B102 ⁽³⁾	1-4, 2-3	1000.0 +50%, -30%	0.16	500	9.4	G	1
HM67-B222 ⁽³⁾	1-4, 2-3	2200.0 +50%, -30%	0.16	400	8.2	H	1
HM67-B472 ⁽³⁾	1-4, 2-3	4700.0 +50%, -30%	0.24	200	9.8	I	1
HM67-10510	1-4, 2-3	51.0 \pm 30%	2.40	200	403	0510	2

- Notes: (1) Leakage inductance is measured with pin 2 & 3 shorted.
(2) DC resistance is measured at 25°C.
(3) Maximum operating temperature is +85°C.

Packaging

Standard: Embossed Tape & Reel

Reel:	Diameter:	Figure 1 & 2	=	13" (330.2mm)
	Capacity:	Figure 1	=	400 Units
		Figure 2	=	2000 Units

Ordering Information

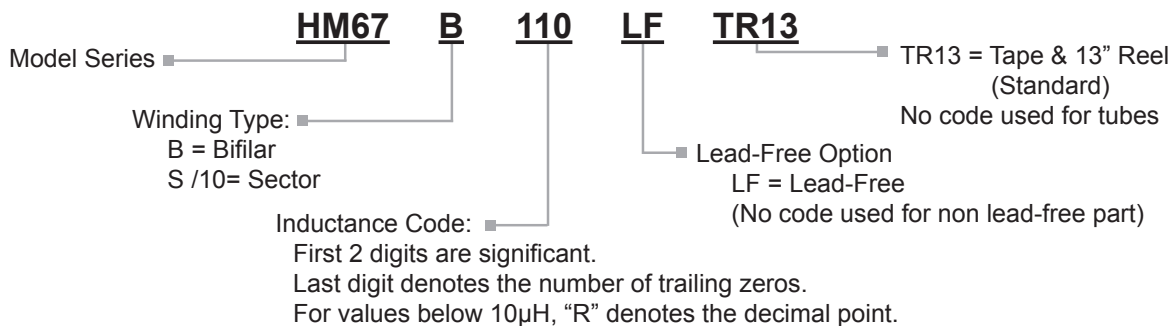

Outline Dimensions (Inch/mm)

Figure 1

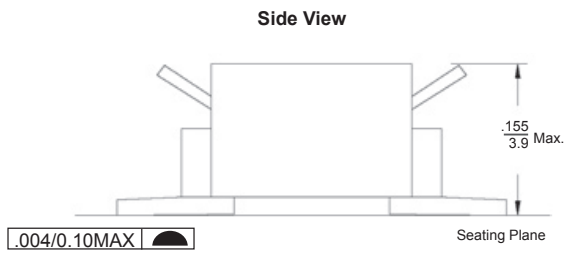
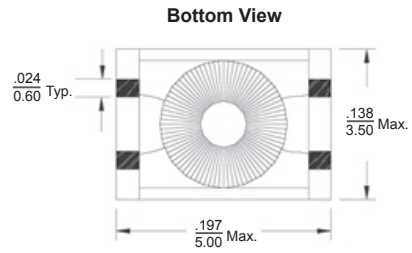
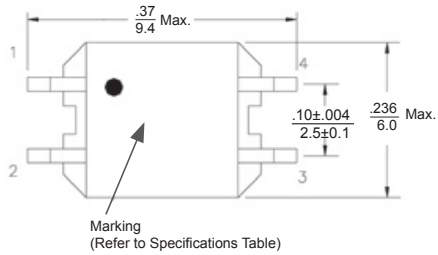

Figure 2



Top View



Top View

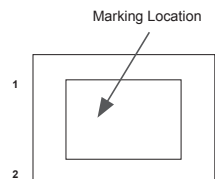

Side View

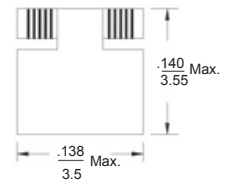

Recommended Solder Pad Layout

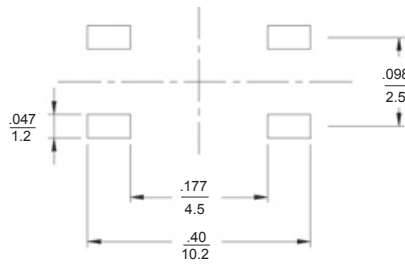

Recommended Solder Pad Layout

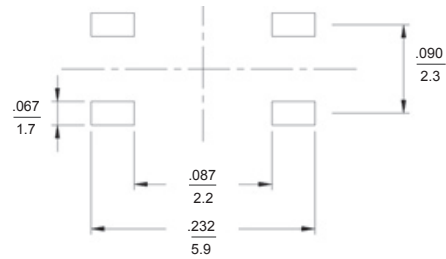

Electrical Characteristics @ 25 °C

(A) Attenuation vs. Frequency Graphs

HM67-B5R0

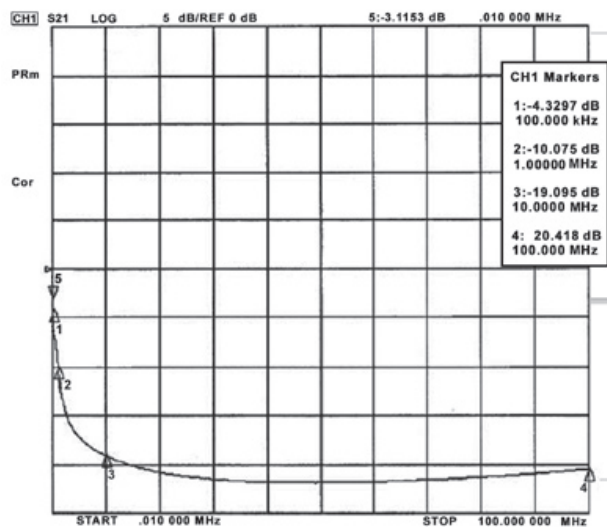

HM67-S250

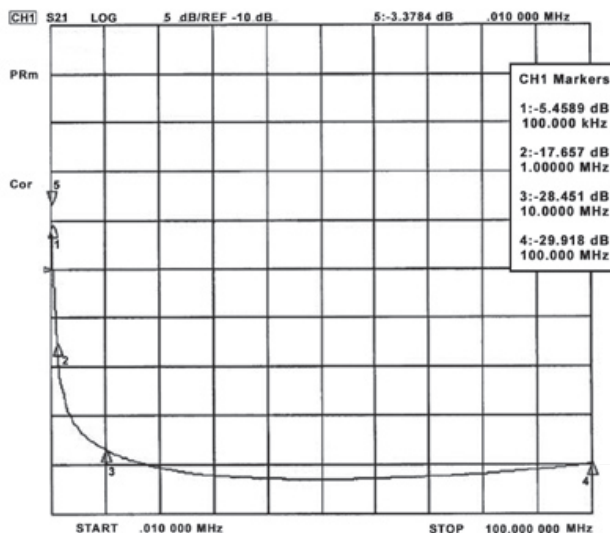

HM67-B110

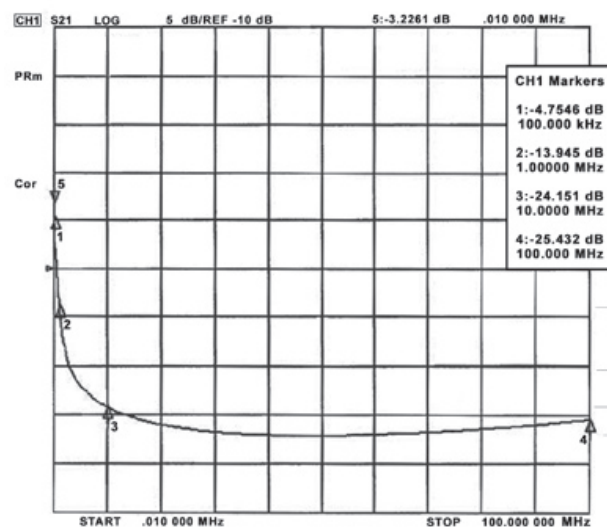

HM67-B510

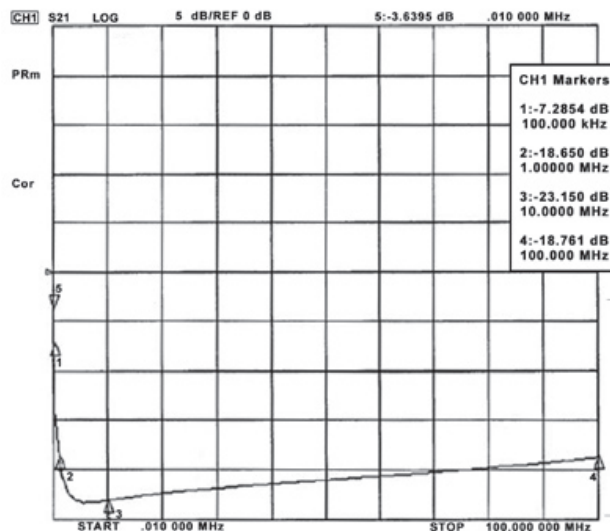

Electrical Characteristics @ 25 °C (Cont'd)

HM67-S510

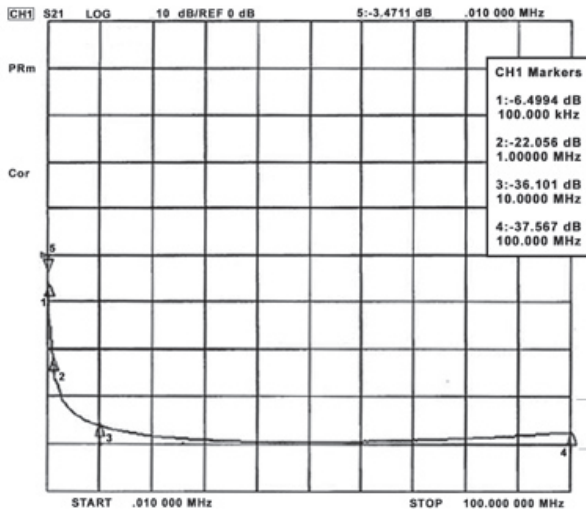

HM67-B102

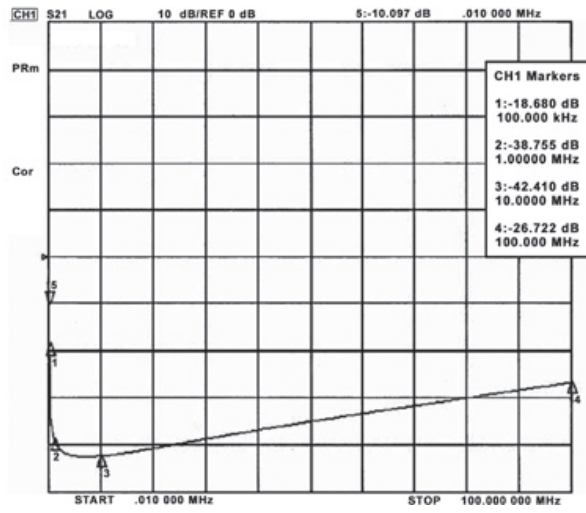

HM67-B471

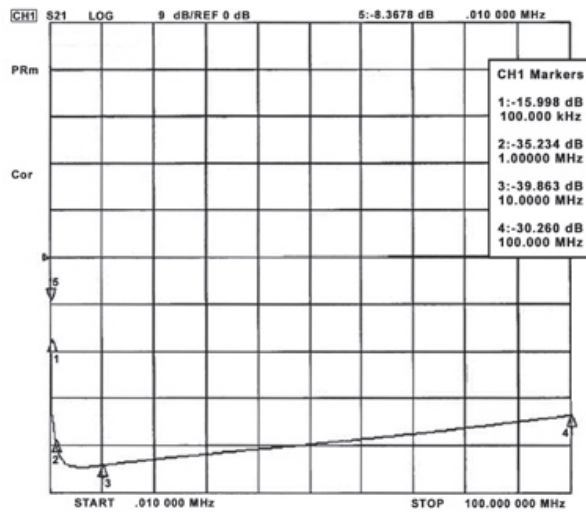

HM67-B222

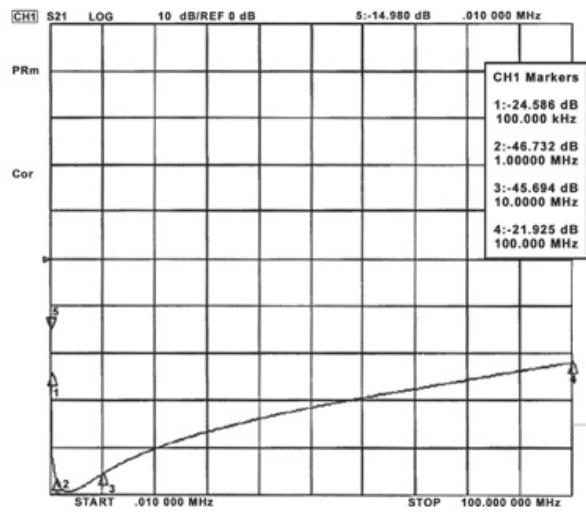

HM67-B472

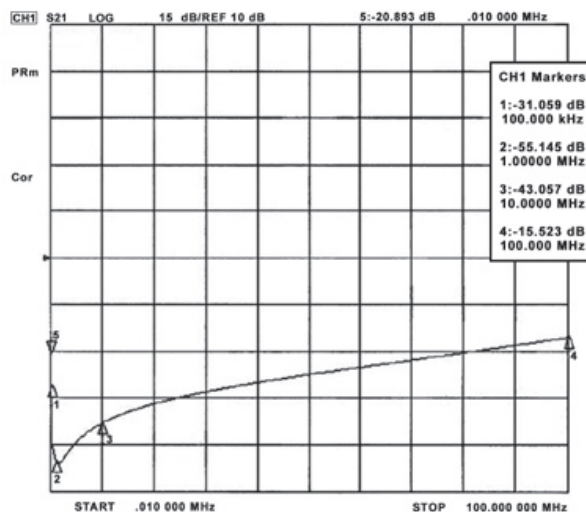

Electrical Characteristics @ 25 °C (Cont'd)

(B) Insertion Loss vs. Frequency Graph

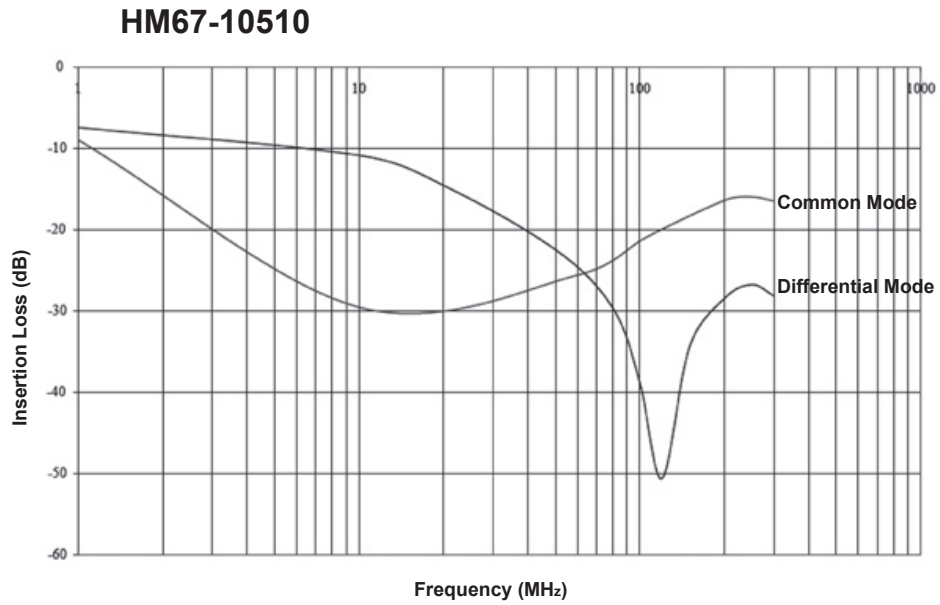

(C) Current Derating Curve

