

Specifications

Insulation Resistance:	1,000M Ω min. at 500V DC
Dielectric Withstanding Voltage:	700V AC for 1 minute
Contact Resistance:	30m Ω max. at 10mA/20mV max.
Operating Temperature Range:	-55°C to +170°C
Mating Cycles:	10,000 insertions min.
Pin Count:	72 contact pins

Materials and Finish

Housing: Polyetherimide (PEI), glass-filled
 Contacts: Beryllium Copper (BeCu)
 Plating: Gold over Nickel

Features

- Card thickness 1.00mm

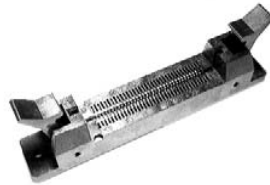

Part Number (Details)

IC-554 - 1 - MF

Series No.

1 = 72 Pins

MF = Flanged
 Unmarked = Not Flanged

Outline Socket Dimensions

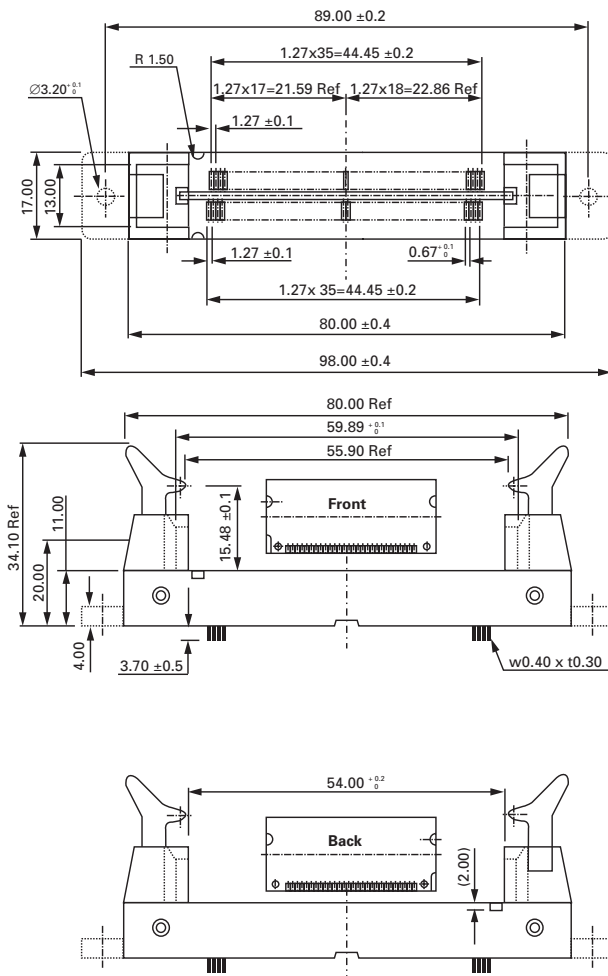

Recommended PC Board Layout

Top View from Socket

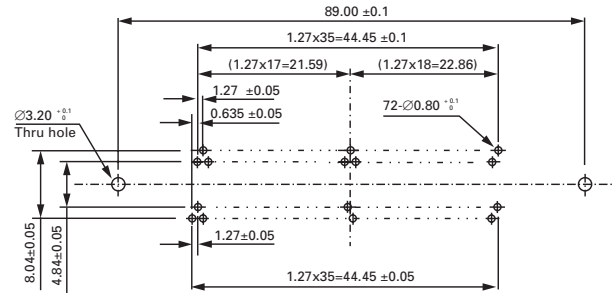

Matching Module Dimensions

