



TAI-SAW TECHNOLOGY CO., LTD.

No. 3, Industrial 2nd Rd., Ping-Chen Industrial District,
Tao-Yuan, 324, Taiwan, R.O.C.

TEL: 886-3-4690038 FAX: 886-3-4697532

E-mail: ttsales@mail.taisaw.com Web: www.taisaw.com

Approval Sheet for Product Specification

Issued Date:

Product Name: 480 MHz IF SAW Filter (SMD 7.0×5.0 mm)

TST Parts No.: TB0400A

Customer Parts No.: _____

Company: _____
Division: _____
Approved by : _____
Date: _____

Checked by: _____ Andy Lee

Approval by: _____ Francis Chen

Date: _____ 2006,11,1



TAI-SAW TECHNOLOGY CO., LTD.

No.3, Industrial 2nd Rd., Ping-Chen Industrial District, Taoyuan, Taiwan, R.O.C.

TEL: 886-3-4690038 FAX: 886-3-4697532

E-mail: tstsales3@mail.taisaw.com Web: www.taisaw.com

SAW Filter 480MHz (SMD 7.0×5.0 mm)

MODEL NO.: TB0400A

Rev. No. 2

A. MAXIMUM RATING:

1. Operating Temperature: -10°C to 60°C
2. Storage Temperature: -40°C to 85°C
3. Input Power Level: 10 dBm

RoHS Compliant
Lead free
Lead-free soldering

B. Characteristics :

1. Ambient Temperature : 23°C

Item	Unit	Min.	Type.	Max.
Center frequency, Fc	MHz	-	480	-
Insertion Loss, IL	dB	-	15.3	22
3 dB Bandwidth	MHz	9	12.1	-
35 dB Bandwidth	MHz	-	20.0	22
Passband Ripple 476.4 - 483.6 MHz	dB	-	0.30	1
Group Delay Variation 475.5 - 484.5 MHz	nsec	-	14	50
Source Impedance	Ohm	-	50	-
Load Impedance	Ohm	-	50	-
Temperature Coefficient	ppm/°C	-	-23	-
Substrate Material	-	-	LiTaO3	-

C. TEST FIXTURE :

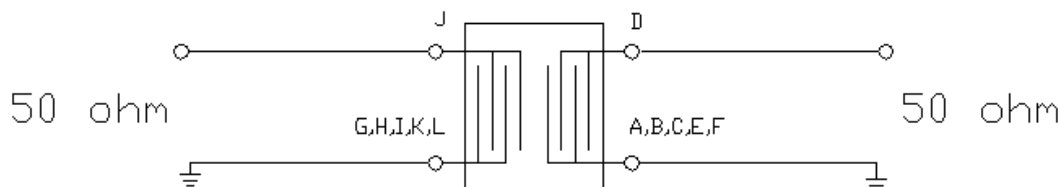

D. Frequency Characteristics :

(1) S21 Response:(span 100MHz)

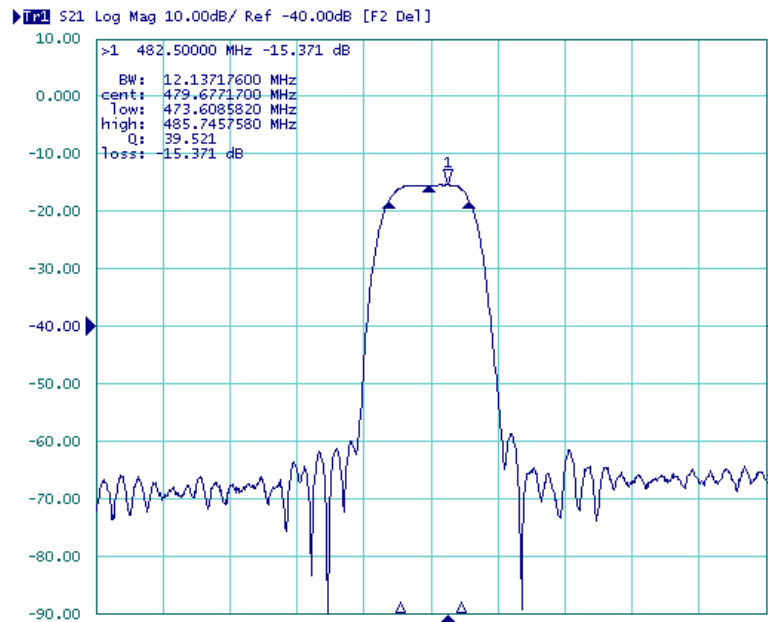

Horizontal: 100MHz/Div Vertical: 10dB/Div

(2) Pass band Response:(span 20MHz)

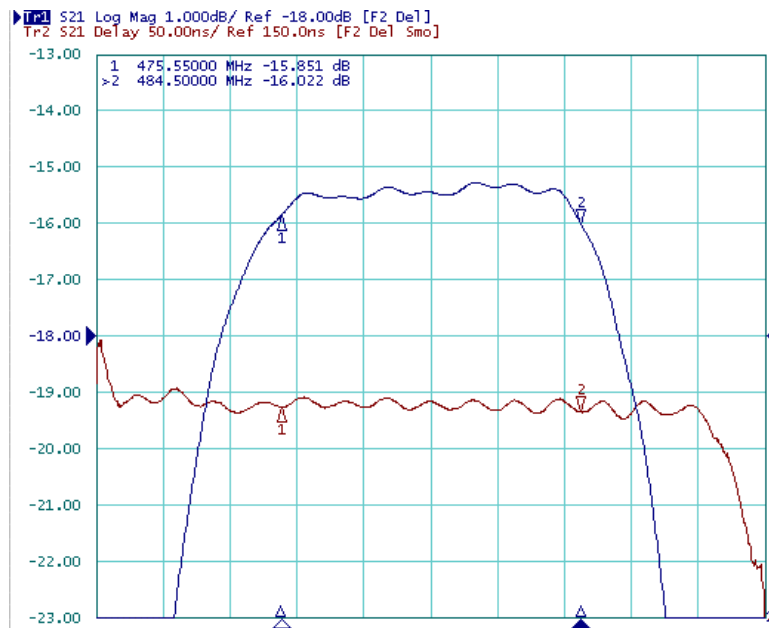

Horizontal : 0.3MHz/Div Vertical 1: 1dB/Div Vertical 2: 50nS/Div

E. Outline Drawing:

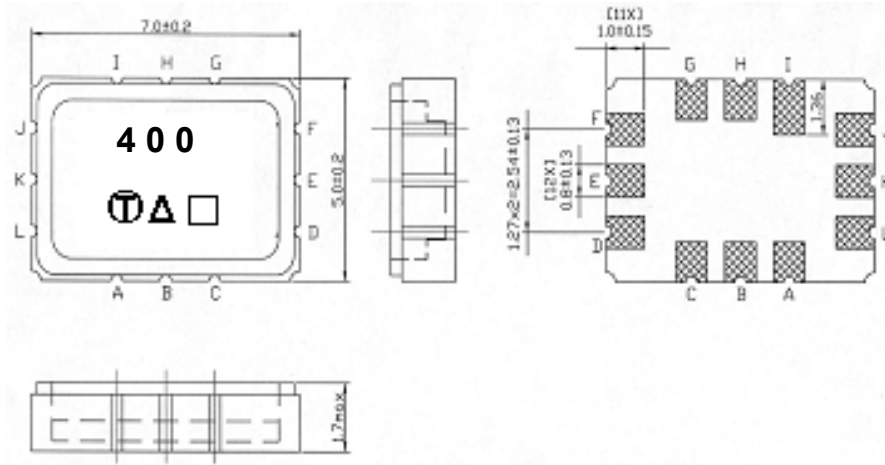

- Pin D : Balanced Input +
- Pin C : Balanced Input -
- Pin J : Blanced Onput +
- Pin I : Blanced Onput -
- Pin A, B, E, F, G, H, K, L : To be Ground
- : Week Code (Follow the table from planner each year)
- Unit : mm
- △ : Product / Year Code

Year	2005 2009	2006 2010	2007 2011	2008 2012
Product Code	B	b	<u>B</u>	<u>b</u>

F. PCB Footprint:

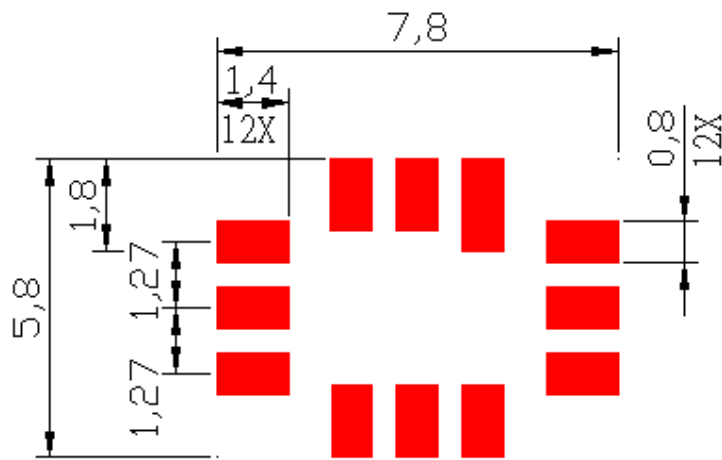

G. PACKING:

1. REEL DIMENSION

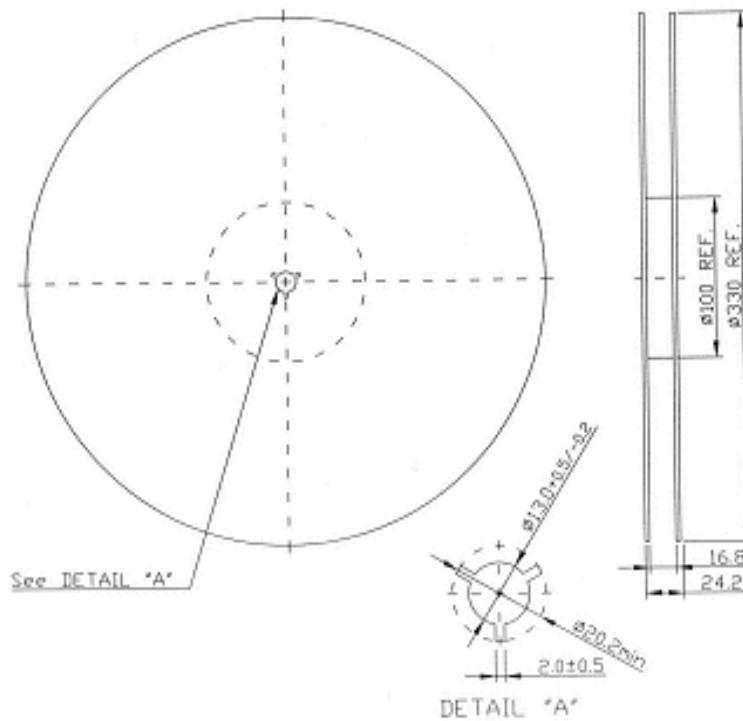

2. TAPE DIMENSION

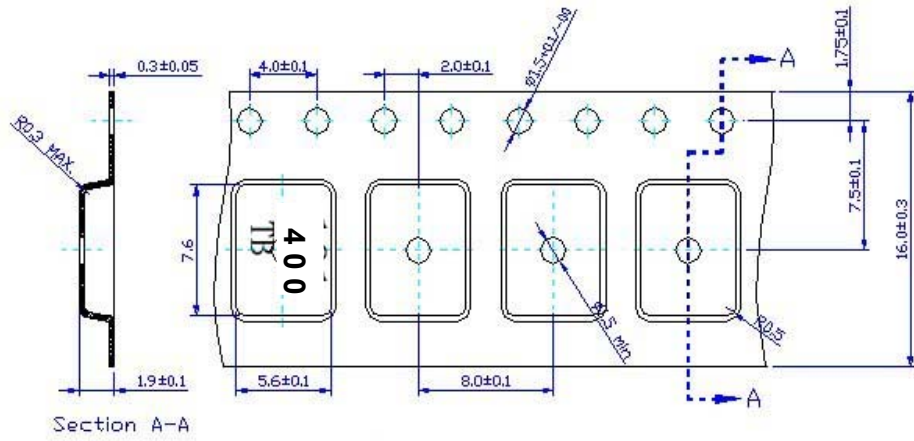

Direction of feet 