



TAI-SAW TECHNOLOGY CO., LTD.

No. 3, Industrial 2nd Rd., Ping-Chen Industrial District,
Taoyuan, 324, Taiwan, R.O.C.

TEL: 886-3-4690038 FAX: 886-3-4697532

E-mail: ttsales@mail.taisaw.com Web: www.taisaw.com

Approval Sheet For Product Specification

Issued Date:

Product Name: IF SAW Filter 380 MHz

TST Parts No.:TB0198A

Customer Parts No.: _____

Company: _____
Division: _____
Approved by : _____
Date: _____

Checked by: Andy Lee

Approval by: Francis Chen

Date: 2003/9/24



TAI-SAW TECHNOLOGY CO., LTD.

No. 3, Industrial 2nd Rd., Ping-Chen Industrial District,
Taoyuan, 324, Taiwan, R.O.C.

TEL: 886-3-4690038 FAX: 886-3-4697532

E-mail: tstsales@mail.taisaw.com Web: www.taisaw.com

IF SAW Filter 380 MHz SMD 7X5mm

MODEL NO.: TB0198A

REV. NO.1

A. MAXIMUM RATING:

1. Input power level: 0 dBm
2. Operating Temperature: -10 °C ~ +85 °C
3. Storage Temperature: -40 °C ~ +85 °C

RoHS Compliant
Lead free
Lead-free soldering

B. Characteristics :

1. Ambient Temperature: 25 °C

Characteristics		Value			Note
		Min.	Typ.	Max.	
Center frequency	F_C MHz	-	380	-	-
Minimum Insertion loss	I.L. dB	-	12.8	16	-
Passband Ripple (378~382MHz)	dB	-	0.5	1	-
Group Delay Ripple (378~382MHz)	dB		40	100	
Phase linearity (378~382MHz)	rms		1.2	4	
Attenuation:(Reference level from minimum insertion loss)					dB
1)	F_C-2 MHz... F_C+2 MHz	dB	0.51	1	-
2)	F_C-250 MHz ~ F_C-30 MHz	dB	40	55	-
3)	F_C-30 MHz ~ F_C-16 MHz	dB	35	54	-
4)	F_C-16 MHz ~ F_C-4 MHz	dB	30	32	-
5)	F_C+4 MHz ~ F_C+16 MHz	dB	30	32	-
6)	F_C+16 MHz ~ F_C+30 MHz	dB	35	53	-
7)	F_C+30 MHz ~ F_C+250 MHz	dB	40	55	-

C. Measurement Circuit:

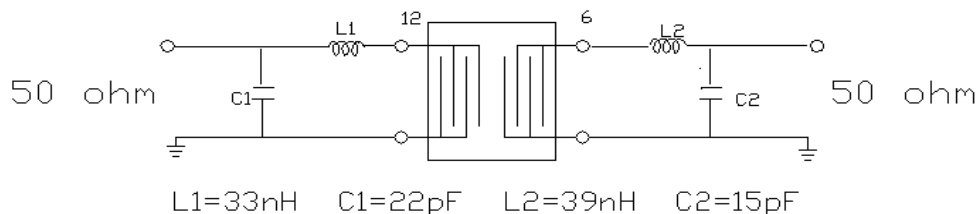

D. Frequency Characteristics :

1. S21 Response

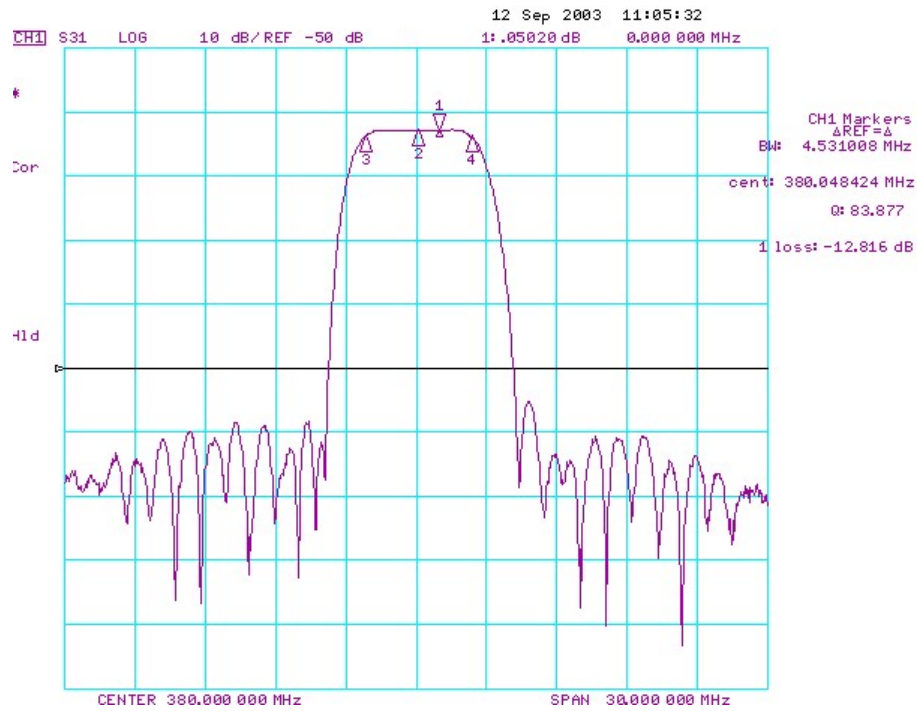

Fig1. Horizontal: 3MHz/Div Vertical: 10dB/Div

2. S21 Response (Group delay ripple of Passband)

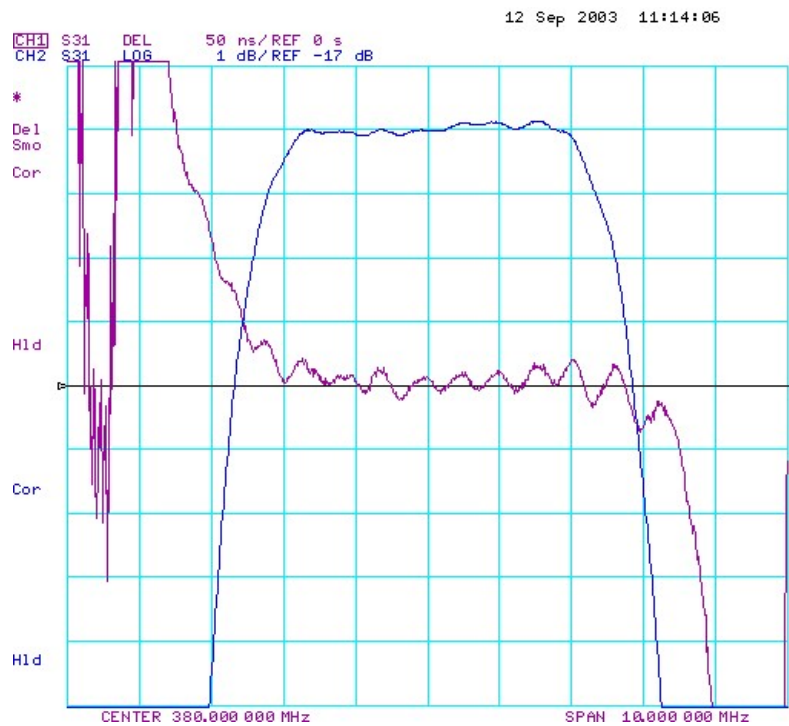

Fig2. Horizontal: 1MHz/Div Vertical: 1dB/Div
 Vertical: 50nS/Div

3. S21 Response (Phase linearity of Passband)

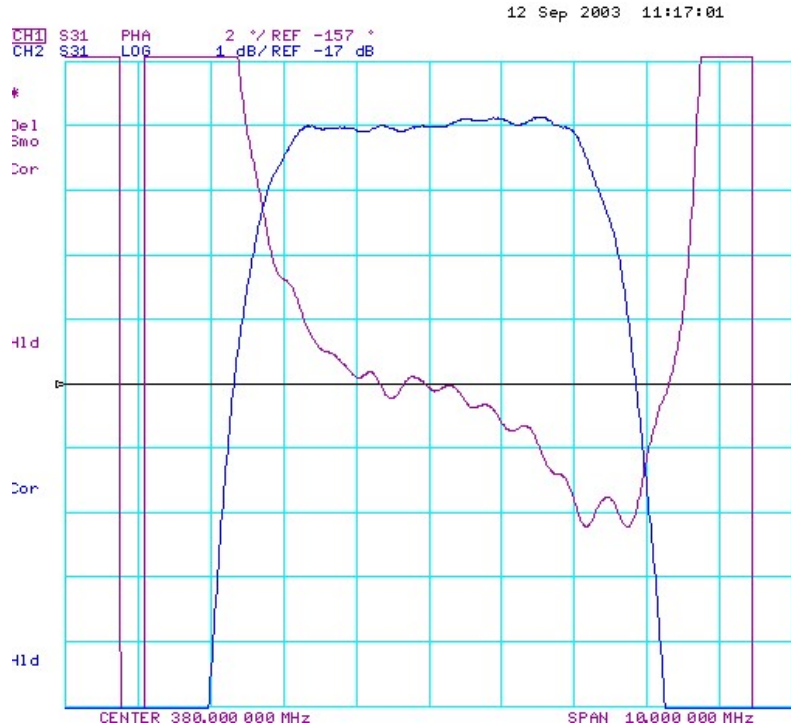
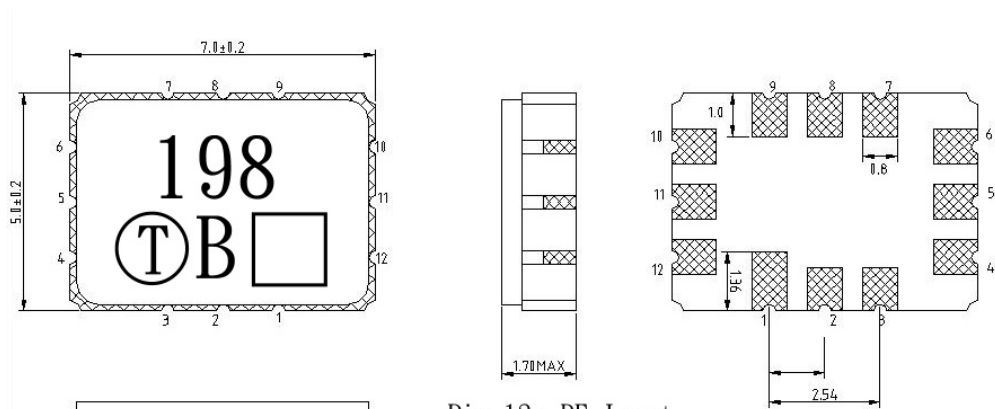

Fig3. Horizontal: 1MHz/Div Vertical: 1dB/Div
 Vertical: 2 degree/Div

E. Outline Drawing:



- Pin 12: RF Input
- Pin 1: RF Input Return
- Pin 6: RF Output
- Pin 7: RF Output Return
- Pin 2, 3, 4, 5, 8, 9, 10, 11: To be Ground
- : Datecode
- Unit : mm

F. PACKING:

1. REEL DIMENSION

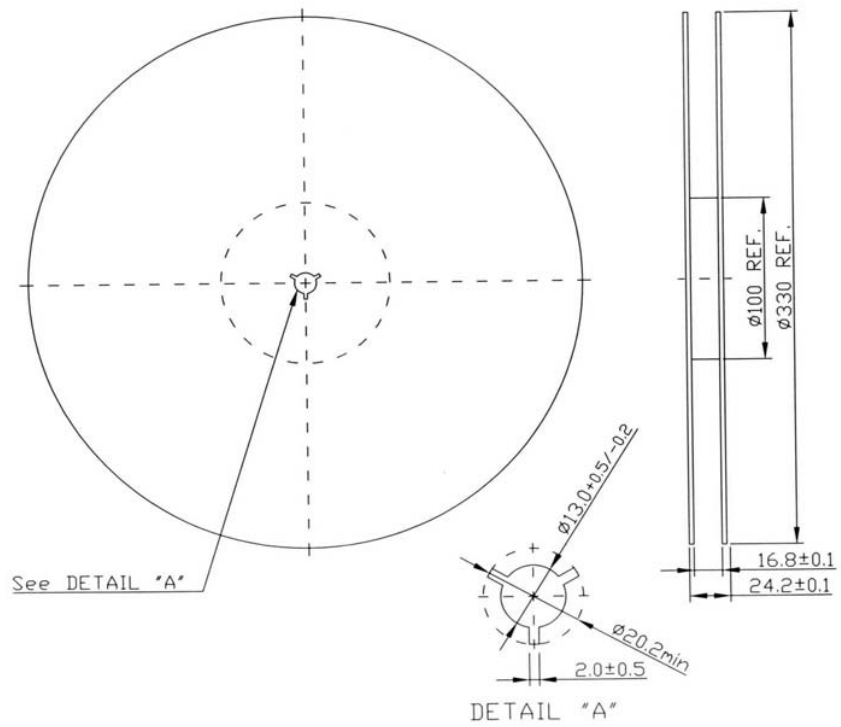

2. TAPE DIMENSION

