

IC-Fassungen, Low cost-Version, Raster 2.54mm

IC-sockets, low cost version, pitch 2.54mm

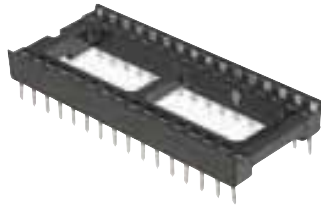

Isolierkörper
Polyester, glasfaserverstärkt,
UL 94V-0

Kontakte
Phosphorbronze, verzinkt

Betriebstemperatur
-55°C bis + 105°C

Strombelastbarkeit
1A

Durchschlagspannung
1000V AC (1min)

Insulator
Polyester, glass reinforced
UL 94V-0

Contacts
Phosphor bronze, tin plated

Operating temperature
-55°C to +105°C

Current rating
1A

Withstanding voltage
1000V AC (1min)

No. of Contacts	Qty per Tube	Dimensions		
		A	B	C
06	80	7.62	10.0	7.62
08	60	10.06	9.96	7.62
14	34	17.68	9.96	7.62
16	30	20.22	9.96	7.62
18	26	22.76	9.96	7.62
20	24	22.86	9.96	7.62
22	21	27.80	9.96	7.62
22*	21	27.70	12.62	10.16
24	20	30.38	17.68	15.24
24**	20	30.38	17.68	7.62
28	17	35.46	17.68	15.24
28**	17	35.46	17.68	7.62
32	15	40.50	17.68	15.24
40	12	50.70	17.68	15.24

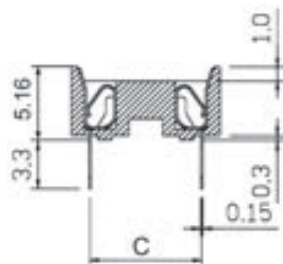
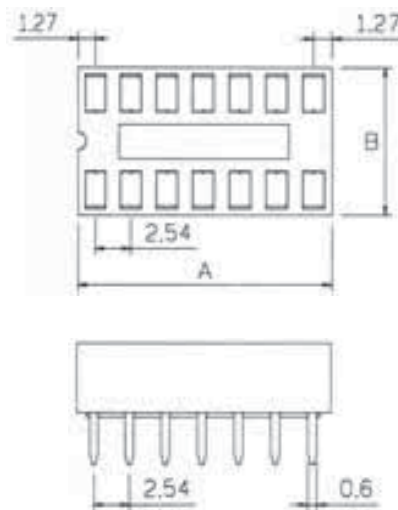

Bestellcode : **A** - **x** - **LC** - **x**
Ordercode :

Bitte „x“ durch die unten geeignete Option ersetzen
Please replace „x“ with appropriate option listed below

1. 2.

1.

Polzahl

06, 08, 14, 16, 18, 20, 22, 24, 28, 32, 40

No. of contacts

06, 08, 14, 16, 18, 20, 22, 24, 28, 32, 40

2.

Ausführung

TT -Standard
T2* -Gesamtbreite(B) des Isolierkörpers 12.62mm
(nur 22-polig verfügbar)
7-T** -Raster 7.62mm (nur 24 und 28 polig)
TR -gesickt

Version

TT -Standard
T2* -width(B) of the Isobody 12.62mm
(only 22-poles available)
7-T** -pitch 7.62mm (only 24 and 28 poles)
TR -retentive legs