

SHV03 THRU SHV08

HIGH VOLTAGE SILICON RECTIFIER

VOLTAGE: 3000- 8000V

CURRENT: 5mA

FEATURES

- Low power loss, high efficiency
- Low leakage
- Low forward voltage
- High current capability
- High speed switching
- High reliability

MECHANICAL DATA

- **Case:** Molded plastic
- **Epoxy:** UL 94V-0 rate flame retardant
- **Lead:** MIL-STD- 202E, Method 208 guaranteed
- **Polarity:** Color band denotes cathode end
- **Mounting position:** Any

SHV

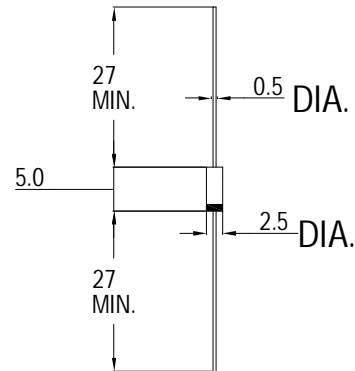

Dimensions in inches and (millimeters)

MAXIMUM RATINGS AND ELECTRICAL CHARACTERISTICS

Ratings at 25°C ambient temperature unless otherwise specified.

Single phase, half wave, 60Hz, resistive or inductive load.

For capacitive load, derate current by 20%.

	SYMBOL	SHV03	SHV06	SHV08	units
Maximum Recurrent Peak Reverse Voltage	V_{RRM}	3000	6000	8000	V
Maximum RMS Voltage	V_{RMS}	2100	4200	5600	V
Maximum DC Blocking Voltage	V_{DC}	3000	6000	8000	V
Maximum Average Forward Rectified Current at $T_A=50^\circ\text{C}$	I_o	5.0			mA
Peak Forward Surge Current 8.3ms single half sine-wave superimposed on rate load (JEDEC method)	I_{FSM}	0.5			A
Maximum Instantaneous Forward Voltage at 0.01A DC	V_F	12	24	50	V
Maximum DC Reverse Current at Rated DC Blocking Voltage $T_A=25^\circ\text{C}$	I_R	5.0			μA
Maximum Reverse Recovery Time (Note)	t_{rr}	80			nS

Notes: Test Conditions: $I_F=2\text{mA}$, $I_{RM}=4\text{mA}$.