

REV A	AUTH MR	DATE 2/28/00	INITIAL RELEASE
REV B	AUTH RL	DATE 6/4/03	REVISED TABLE: LINE 5: A WAS 1.8, B WAS 2.0, C WAS .90, D WAS 1.0, E WAS 1.31, F WAS 1.0 G WAS .50
REV C	AUTH RL	DATE 9/12/03	REVISED TABLE: LINE 5 WAS 2.00, B WAS 1.50 C WAS 1.00, D WAS 1.00, E WAS 1.31, F WAS 1.00, G WAS: .60
REV D	AUTH RL	DATE 08/20/07	TITLE BLOCK UPDATED

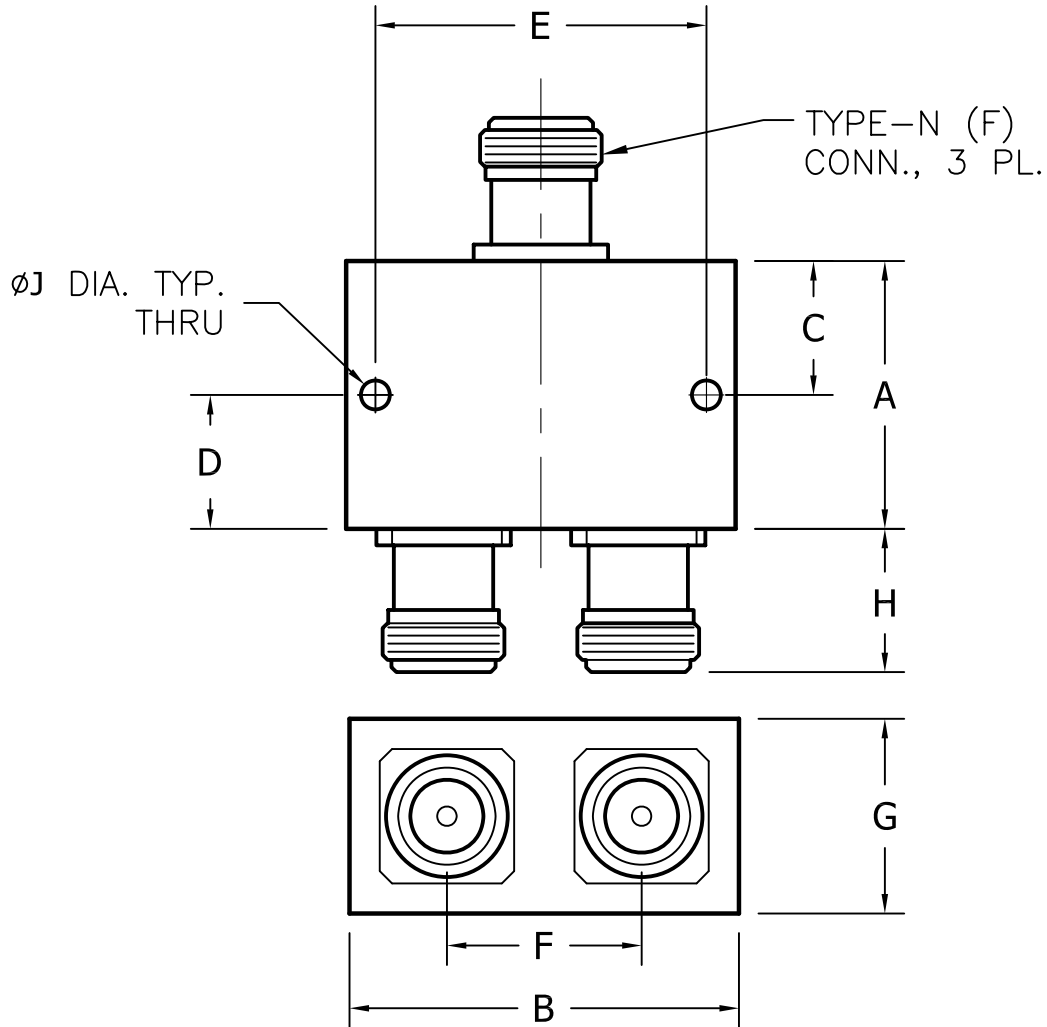

DIMENSIONS IN INCHES									
FIG	A	B	C	D	E	F	G	H	J
1	2.00	2.00	1.00	1.00	1.500	1.00	0.75	0.77	0.125
2	1.00	2.00	0.50	0.50	1.700	1.00	1.00	0.77	0.125
3	1.38	2.00	0.69	0.69	1.700	1.00	1.00	0.77	0.149
4	1.20	1.50	0.60	0.60	1.000	1.00	0.40	0.95	0.104
5	1.80	2.00	0.90	0.90	1.750	1.18	0.50	0.95	0.105

THIRD ANGLE PROJECTION:		APPROVALS	DATE		ADVANCED TECHNICAL MATERIALS, INC.		THE INFORMATION IN THIS DRAWING IS PROPRIETARY AND SHALL NOT BE USED OR DISCLOSED WITHOUT THE PRIOR WRITTEN CONSENT OF ATM, INC. DO NOT SCALE DWG.	
UNLESS OTHERWISE NOTED, DIMENSIONS ARE IN INCHES, TOLERANCES ARE: FRACTIONS: ±1/64 ANGLES: ±1/2°		DRAWN M ROTUNDA	2/28/00		TEL: (631) 289-0363 FAX: (631) 289-0358		www.atmmicrowave.com	
BASIC DIMENSION		DECIMALS 2 PLACE 3 PLACE		APRVD.		OUTLINE, TYPE-N POWER COMBINER/DIVIDER, 2 WAY		REVISION D
UNDER 6"	±.02	±.005	MATERIAL PER ORDER		SIZE A	CAGE CODE 0R8N4	ATM DWG # 2350W	
6" - 12"	±.03	±.010	TREATMENT -		SCALE	NONE	MODEL # P22X	SHEET 1/1
OVER 12"	±.06	±.015	FINISH -					