

#### MINI HDMI, RIGHT ANGLE, SMT

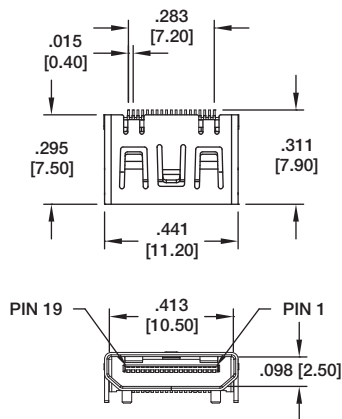

MHDMI-S-RA-1-SMT

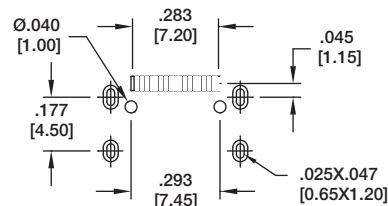

Recommended PCB Layout

#### RIGHT ANGLE THRU-HOLE

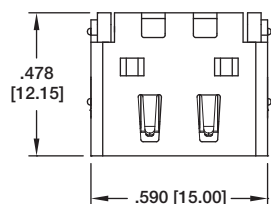

HDMI-S-RA-1

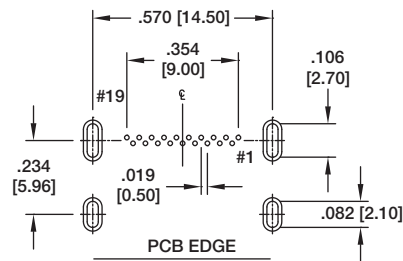
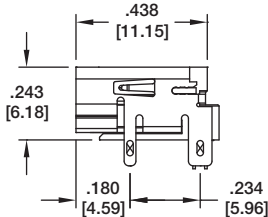
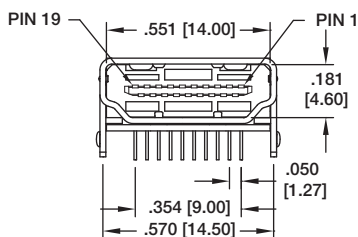

Recommended PCB Layout

#### HDMI RIGHT ANGLE

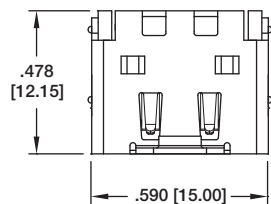

HDMI-S-RA-1-MF

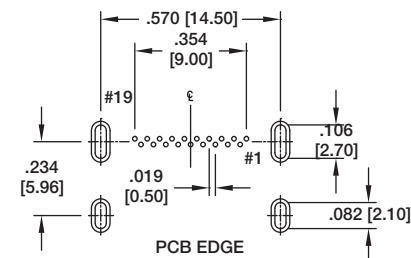
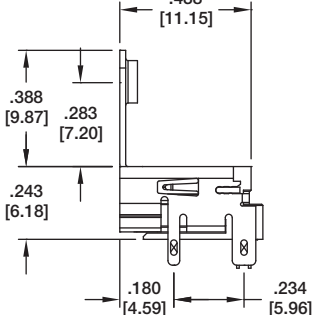
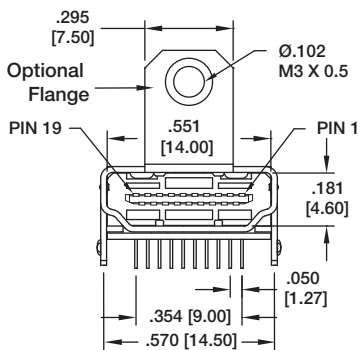

Recommended PCB Layout