



P/N: AD-6600S DATA SHEET

Feature



- For use with ADSL Application
- Minimum inter winding breakdown voltage of 600 Vrms for 1 minute between line center tap or pin 1 and 2
- Small EP13 Package in SMD Type
- Operating Temperature: -10°C to +60°C.
- Storage Temperature: -25°C to +75°C.

Electrical Specifications @ 25°C							
Part Number	Application	Turn Ratio (±2%) Chip:Line	OCL (mH ±6%) @ 10 KHz, 0.1 V (1-5), (2+4) shorted	Leakage Inductance (uH Max) (1-5)@ 100 KHz, 0.1 V		Longitudinal Balance (dB Max) 20KHz -500kHz	
AD-6600S	SMT	1:5.4	3	15		-55	
Additional Specifications							
Part Number	Isolation Voltage (Vrms)	Inter winding Capacitance (pF Max)	Insertion Loss (dB Max) @ 100KHz	DCR(Ω Max)		Return Loss (dB Min) 40kHz-500kHz	Harmonic Distortion (dB max) 5kHz Fundamental
		Chip:Line		Chip side	Line side		
AD-6600S	1500	150	-0.5	0.35	4.0	-15	-76

Schematic

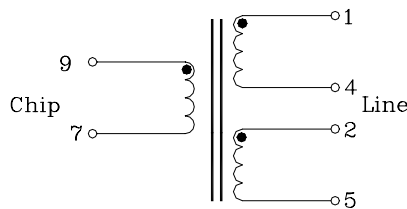

Mechanical

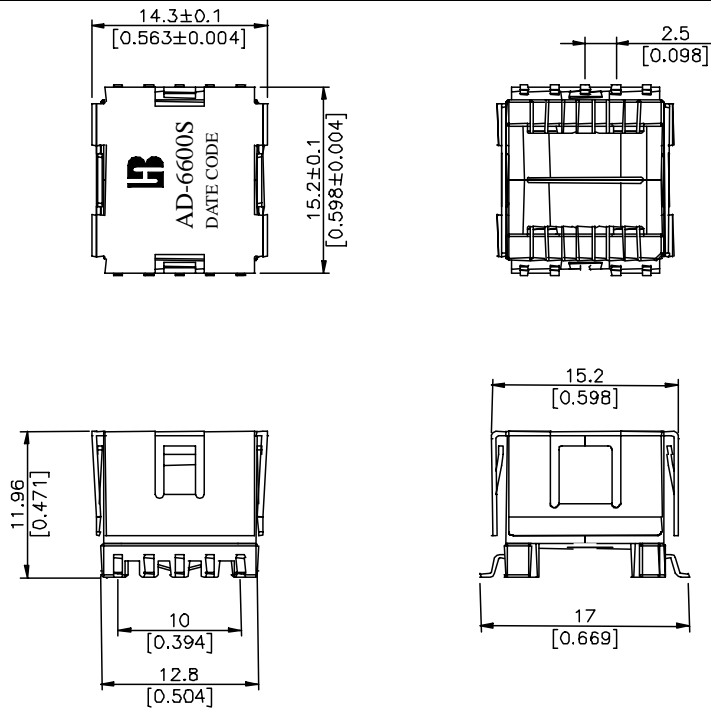

Units: mm [Inches] Tolerance: xx.x0±0.25 [0.010]
0.xx±0.05 [0.002]