

## High Frequency, Surface Mount Inductor



### FEATURES

- High self-resonant frequency values
- High Q values at higher frequencies
- Wirewound construction
- Tape and reel packaging for automatic handling, 2000/reel
- Compatible with vapor phase and infrared reflow soldering

**RoHS**  
COMPLIANT

### STANDARD ELECTRICAL SPECIFICATIONS

| IND. (nH) | TOL.             | TEST FREQ. L (MHz) | Q MIN. | TEST FREQ. Q (MHz) | SELF-RESONANT FREQ. MIN. (MHz) | DCR MAX. (Ohms) | RATED DC CURRENT (mA) |
|-----------|------------------|--------------------|--------|--------------------|--------------------------------|-----------------|-----------------------|
| 2.2       | ± 0.3 nH, 0.2 nH | 250                | 50     | 1000               | 6000                           | 0.06            | 800                   |
| 2.7       | ± 0.3 nH, 0.2 nH | 250                | 35     | 1000               | 6000                           | 0.08            | 800                   |
| 3.3       | ± 0.3 nH, 0.2 nH | 250                | 60     | 1000               | 6000                           | 0.08            | 800                   |
| 3.9       | ± 0.3 nH, 0.2 nH | 250                | 60     | 1000               | 6000                           | 0.06            | 600                   |
| 4.7       | ± 0.3 nH, 0.2 nH | 250                | 60     | 1000               | 5800                           | 0.06            | 600                   |
| 5.6       | ± 5%, 2%         | 250                | 60     | 1000               | 5800                           | 0.08            | 600                   |
| 6.8       | ± 5%, 2%         | 250                | 60     | 1000               | 5500                           | 0.06            | 600                   |
| 8.2       | ± 5%, 2%         | 250                | 60     | 1000               | 5500                           | 0.06            | 600                   |
| 10        | ± 5%, 2%         | 250                | 60     | 500                | 4800                           | 0.08            | 600                   |
| 12        | ± 5%, 2%         | 250                | 60     | 500                | 4100                           | 0.08            | 600                   |
| 15        | ± 5%, 2%         | 250                | 60     | 500                | 3600                           | 0.08            | 600                   |
| 18        | ± 5%, 2%         | 250                | 60     | 500                | 3400                           | 0.08            | 600                   |
| 22        | ± 5%, 2%         | 250                | 60     | 500                | 3300                           | 0.10            | 600                   |
| 27        | ± 5%, 2%         | 250                | 60     | 500                | 2600                           | 0.12            | 600                   |
| 33        | ± 5%, 2%         | 250                | 60     | 500                | 2400                           | 0.15            | 500                   |
| 39        | ± 5%, 2%         | 250                | 60     | 500                | 2100                           | 0.18            | 500                   |
| 47        | ± 5%, 2%         | 200                | 60     | 500                | 1700                           | 0.15            | 500                   |
| 56        | ± 5%, 2%         | 200                | 60     | 500                | 1600                           | 0.25            | 500                   |
| 68        | ± 5%, 2%         | 200                | 60     | 500                | 1450                           | 0.27            | 500                   |
| 82        | ± 5%, 2%         | 150                | 60     | 500                | 1350                           | 0.32            | 500                   |
| 100       | ± 5%, 2%         | 150                | 60     | 500                | 1200                           | 0.43            | 500                   |
| 120       | ± 5%, 2%         | 150                | 50     | 250                | 1100                           | 0.48            | 500                   |
| 150       | ± 5%, 2%         | 100                | 50     | 250                | 950                            | 0.56            | 400                   |
| 180       | ± 5%, 2%         | 100                | 50     | 250                | 900                            | 0.78            | 400                   |
| 220       | ± 5%, 2%         | 100                | 50     | 250                | 860                            | 1.00            | 400                   |
| 270       | ± 5%, 2%         | 100                | 45     | 250                | 850                            | 1.46            | 350                   |
| 330       | ± 5%, 2%         | 100                | 45     | 250                | 800                            | 1.65            | 300                   |
| 390       | ± 5%, 2%         | 100                | 45     | 250                | 780                            | 2.20            | 210                   |
| 470       | ± 5%             | 25.2               | 45     | 100                | 375                            | 0.95            | 500                   |
| 560       | ± 5%             | 25.2               | 45     | 100                | 340                            | 1.10            | 450                   |
| 680       | ± 5%             | 25.2               | 35     | 100                | 188                            | 1.20            | 400                   |
| 820       | ± 5%             | 25.2               | 35     | 100                | 215                            | 1.50            | 300                   |
| 1000      | ± 5%             | 25.2               | 35     | 50                 | 200                            | 2.13            | 180                   |
| 1200      | ± 5%             | 7.96               | 15     | 7.96               | 200                            | 2.38            | 150                   |
| 1500      | ± 5%             | 7.96               | 15     | 7.96               | 200                            | 2.90            | 130                   |
| 1800      | ± 5%             | 7.96               | 15     | 7.96               | 120                            | 3.00            | 120                   |
| 2200      | ± 5%             | 7.96               | 15     | 7.96               | 110                            | 3.10            | 110                   |
| 2700      | ± 5%             | 7.96               | 15     | 7.96               | 100                            | 3.50            | 100                   |
| 3300      | ± 5%             | 7.96               | 15     | 7.96               | 70                             | 2.30            | 210                   |
| 3900      | ± 5%             | 7.96               | 15     | 7.96               | 60                             | 2.50            | 200                   |
| 4700      | ± 5%             | 7.96               | 15     | 7.96               | 50                             | 2.80            | 180                   |
| 5600      | ± 5%             | 7.96               | 15     | 7.96               | 45                             | 3.00            | 160                   |
| 6800      | ± 5%             | 7.96               | 15     | 7.96               | 45                             | 3.20            | 130                   |
| 8200      | ± 5%             | 7.96               | 15     | 7.96               | 40                             | 3.50            | 120                   |
| 10 000    | ± 5%             | 2.52               | 10     | 2.52               | 40                             | 5.00            | 80                    |

### ELECTRICAL SPECIFICATIONS

**Inductance Range:** 2.2 nH to 10 000 nH  
**Inductance Tolerance:** 0.3 nH for 2.2 - 4.7 nH  
 ± 5% for 5.6 nH to 10 000 nH  
**Temperature Range:** - 40 °C to 125 °C  
**Core Material:** Ceramic for 2.2 nH to 390 nH  
 Ferrite for 470 nH to 10 000 nH

### TEST EQUIPMENT

- Inductance and Q measured on HP4286A (2.2 nH - 390 nH) and HP4285A (470 nH - 10 000 nH)
- SRF measured on HP8753E
- DCR measured on HP4338B

### DIMENSIONS in inches [millimeters]

|                               |                               |                               |
|-------------------------------|-------------------------------|-------------------------------|
|                               |                               |                               |
| <b>L</b>                      | <b>W</b>                      | <b>S</b>                      |
| 0.079 ± 0.008<br>[2.00 ± 0.2] | 0.050 ± 0.008<br>[1.25 ± 0.2] | 0.016 ± 0.008<br>[0.40 ± 0.2] |
|                               |                               |                               |
| <b>U</b>                      |                               | <b>T</b>                      |
| 0.02<br>[0.5]                 |                               | 0.048 ± 0.008<br>[1.20 ± 0.2] |

### DESCRIPTION

**IMC-0805-01**      **10 nH**      **± 5%**      **ER**      **e4\***  
 MODEL      INDUCTANCE VALUE      INDUCTANCE TOLERANCE      PACKAGE CODE      JEDEC LEAD (Pb)-FREE STANDARD

\*NOTE: For parts within 2.2 nH to 390 nH please use e4 for JEDEC lead (Pb)-free standard. For parts within 470 nH to 10 000 nH please use e3 for JEDEC lead (Pb)-free standard.

### GLOBAL PART NUMBER

|       |   |   |      |   |   |              |                  |   |   |      |        |   |   |   |
|-------|---|---|------|---|---|--------------|------------------|---|---|------|--------|---|---|---|
| I     | M | C | 0    | 8 | 0 | 5            | E                | R | 1 | 0    | N      | J | 0 | 1 |
| MODEL |   |   | SIZE |   |   | PACKAGE CODE | INDUCTANCE VALUE |   |   | TOL. | SERIES |   |   |   |

**PERFORMANCE GRAPHS**

IMC-0805-01

Q VS FREQUENCY

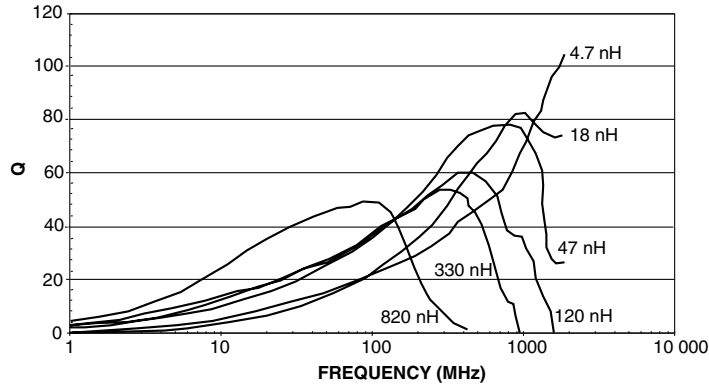

IMC-0805-01

INDUCTANCE VS FREQUENCY

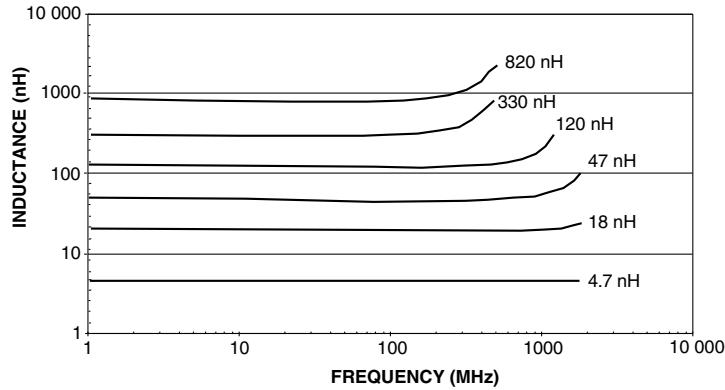

**TAPE AND REEL SPECIFICATIONS** in inches [millimeters]

REEL DIMENSIONS

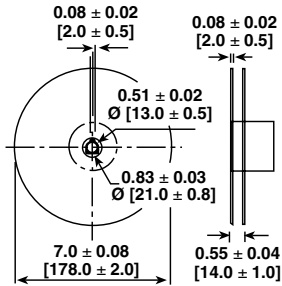

TAPE DIMENSIONS

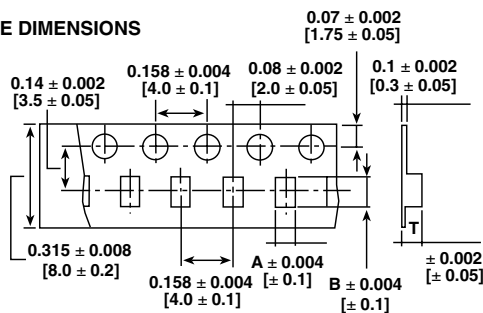

RECOMMENDED PATTERN

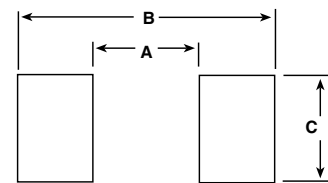

| MODEL       | UNITS PER REEL | MODEL       | A              | B              | T              | MODEL       | A               | B              | C               |
|-------------|----------------|-------------|----------------|----------------|----------------|-------------|-----------------|----------------|-----------------|
| IMC-0805-01 | 2000           | IMC-0805-01 | 0.055<br>[1.4] | 0.091<br>[2.3] | 0.055<br>[1.4] | IMC-0805-01 | 0.047<br>[1.20] | 0.102<br>[2.6] | 0.047<br>[1.20] |



## Disclaimer

All product specifications and data are subject to change without notice.

Vishay Intertechnology, Inc., its affiliates, agents, and employees, and all persons acting on its or their behalf (collectively, "Vishay"), disclaim any and all liability for any errors, inaccuracies or incompleteness contained herein or in any other disclosure relating to any product.

Vishay disclaims any and all liability arising out of the use or application of any product described herein or of any information provided herein to the maximum extent permitted by law. The product specifications do not expand or otherwise modify Vishay's terms and conditions of purchase, including but not limited to the warranty expressed therein, which apply to these products.

No license, express or implied, by estoppel or otherwise, to any intellectual property rights is granted by this document or by any conduct of Vishay.

The products shown herein are not designed for use in medical, life-saving, or life-sustaining applications unless otherwise expressly indicated. Customers using or selling Vishay products not expressly indicated for use in such applications do so entirely at their own risk and agree to fully indemnify Vishay for any damages arising or resulting from such use or sale. Please contact authorized Vishay personnel to obtain written terms and conditions regarding products designed for such applications.

Product names and markings noted herein may be trademarks of their respective owners.