



SPECIFICATIONS

| | |
|-----------------------|------------------------|
| Electrical Ratings | 50mA @ 48VDC |
| Electrical Life | 100,000 cycles typical |
| Contact Resistance | < 50 mΩ initial |
| Actuation Force | 160 +/- 50gF |
| Actuator Travel | .25 +/- .1mm |
| Dielectric Strength | 1000Vrms min |
| Insulation Resistance | > 100MΩ min |
| Operating Temperature | -40°C to 85°C |
| Storage Temperature | -40°C to 85°C |

MATERIALS

| | |
|-----------|--------------------------------|
| Actuator | 4/6 Nylon |
| Housing | 4/6 Nylon |
| Cover | Steel |
| Contacts | Phosphor Bronze, Silver Plated |
| Terminals | Brass, Silver Plated |

ORDERING INFORMATION

| | | |
|-------------------------------------|---------------|------------|
| 1. Series: | CS1109 | 2.9 |
| CS1109 | | |
| CS1109A w/ grounding tab | | |
| 2. Actuator Length "L" (mm): | | |
| 2.6 | | |
| 2.9 | | |
| 3.1 | | |

DIMENSIONS

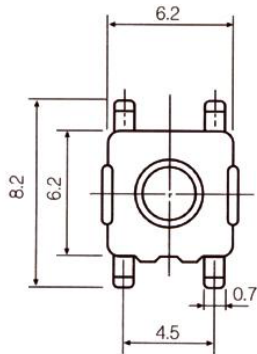

CS1109

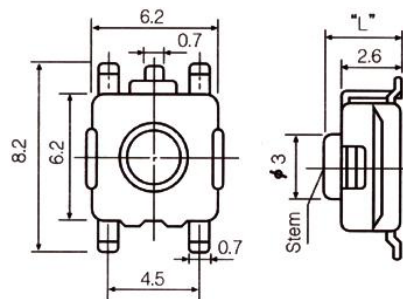

CS1109A

| Part Number | "L" (mm) |
|-------------|----------|
| CS11092.6 | 2.6 |
| CS11092.9 | 2.9 |
| CS11093.1 | 3.1 |

| Part Number | "L" (mm) |
|-------------|----------|
| CS1109A2.6 | 2.6 |
| CS1109A2.9 | 2.9 |
| CS1109A3.1 | 3.1 |

