

**PLEASE CHECK WWW.MOLEX.COM FOR LATEST PART INFORMATION**

**Part Number:** [0190230008](#)  
**Status:** **Active**  
**Description:** InsulKrimp™ Quick Disconnect, Male, for 10-12 (5.00-3.30) Wire, Box, Tab 6.35mm (.250") x 0.81mm (.032")

**Documents:**

- [Drawing \(PDF\)](#) [RoHS Certificate of Compliance \(PDF\)](#)
- [Product Specification PS-19902-008 \(PDF\)](#)

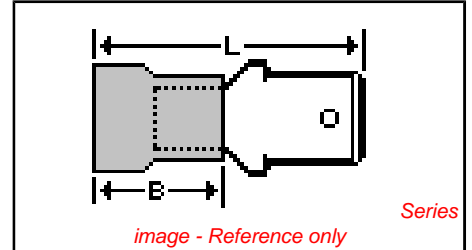

**Agency Certification**

|     |         |
|-----|---------|
| CSA | LR18689 |
| UL  | E79133  |

**General**

|                         |                   |
|-------------------------|-------------------|
| Product Family          | Quick Disconnects |
| Series                  | 19023             |
| Comments                | Funnel Entry      |
| Crimp Quality Equipment | Yes               |
| MolexKits               | Yes               |
| Product Name            | InsulKrimp™       |
| Type                    | Quick Disconnect  |

**Physical**

|                               |                     |
|-------------------------------|---------------------|
| Barrel Type                   | Closed              |
| Color - Resin                 | Natural             |
| Flammability                  | 94V-2               |
| Gender                        | Male                |
| Glow-Wire Compliant           | No                  |
| Insulation                    | PVC                 |
| Lock to Mating Part           | None                |
| Material - Metal              | Copper              |
| Material - Resin              | PVC                 |
| Orientation                   | Straight            |
| Packaging Type                | Bag                 |
| Polarized to Mating Part      | No                  |
| Tab Thickness                 | 0.81mm (.032")      |
| Tab Width                     | 6.35mm (.250")      |
| Temperature Range - Operating | -50°C to +105°C     |
| Wire Insulation Diameter      | 6.40mm (.250") max. |
| Wire Size AWG                 | 10, 12              |
| Wire Size mm²                 | 3.30 - 5.00         |

**Electrical**

|                   |      |
|-------------------|------|
| Voltage - Maximum | 600V |
|-------------------|------|

**Material Info**

|                 |         |
|-----------------|---------|
| Old Part Number | CMCT-2X |
|-----------------|---------|

**Reference - Drawing Numbers**

|                       |              |
|-----------------------|--------------|
| Product Specification | PS-19902-008 |
| Sales Drawing         | SD-19023-004 |

**EU RoHS**

**ELV and RoHS Compliant**  
**REACH SVHC**  
 Not Reviewed  
**Halogen-Free Status**  
**Not Reviewed**

**China RoHS**



**Need more information on product environmental compliance?**

Email [productcompliance@molex.com](mailto:productcompliance@molex.com)  
 For a multiple part number RoHS Certificate of Compliance, [click here](#)

Please visit the [Contact Us](#) section for any non-product compliance questions.

**Search Parts in this Series**  
[19023Series](#)

**PLEASE CHECK WWW.MOLEX.COM FOR LATEST PART INFORMATION**

| 10                       | 9                           | 8                       | 7                          | 6                                     | 5                     | 4      | 3          | 2           | 19023      |             |                           |         |         |                           |                                |                 |
|--------------------------|-----------------------------|-------------------------|----------------------------|---------------------------------------|-----------------------|--------|------------|-------------|------------|-------------|---------------------------|---------|---------|---------------------------|--------------------------------|-----------------|
| LOOSE PC MATERIAL NUMBER | LOOSE PC ENGINEERING NUMBER | ON TAPE MATERIAL NUMBER | ON TAPE ENGINEERING NUMBER | WIRE RANGE                            | TAB SIZE REFERENCE    | COLOR  | ID MIN     | B MAX       | MWID       | L MAX       | W $\pm \frac{.005}{0.13}$ | A MIN   | H MAX   | C $\pm \frac{.007}{0.18}$ | TERMINAL MAT'L. THICKNESS REF. | TERMINAL FINISH |
| 190230005                | AMCT-2X                     | 190230006               | AMCT-2XT                   | 22-18AWG (0.38-0.96mm <sup>2</sup> )  | .250x.032 (6.35x0.81) | RED    | .062 /1.57 | .450 /11.43 | .145 /3.68 | .92 /23.4   | .250/6.35                 | .30/7.6 | .14/3.6 | .075/1.91                 | BRASS .032/0.81                | ZINC CHROMATE   |
| 190230012                | MCT-2X                      | 190230014               | MCT-2XT                    | 16-14 AWG (1.23-1.94mm <sup>2</sup> ) | .250x.032 (6.35x0.81) | BLUE   | .081 /2.06 | .450 /11.43 | .175 /4.44 | .92 /23.4   | .250/6.35                 | .30/7.6 | .14/3.6 | .075/1.91                 | BRASS .032/0.81                | ZINC CHROMATE   |
| 190230008                | CMCT-2X                     | 190230009               | CMCT-2XT                   | 12-10 AWG (3.09-5.01mm <sup>2</sup> ) | .250x.032 (6.35x0.81) | YELLOW | .128 /3.25 | .550 /13.97 | .245/6.22  | 1.10 /27.94 | .250/6.35                 | .30/7.6 | .14/3.6 | .075/1.91                 | BRASS .032/0.81                | ZINC CHROMATE   |
| 190230003                | AMCT-27X                    | 190230004               | AMCT-27XT                  | 22-18AWG (0.38-0.96mm <sup>2</sup> )  | .187x.020 (4.75x0.51) | RED    | .062 /1.57 | .450 /11.43 | .145 /3.68 | .82 /23.4   | .187/4.75                 | .24/6.1 | .13/3.3 | .055/1.40                 | BRASS .020/0.51                | ZINC CHROMATE   |
| 190230010                | MCT-27X                     | 190230011               | MCT-27XT                   | 16-14 AWG (1.23-1.94mm <sup>2</sup> ) | .187x.020 (4.75x0.51) | BLUE   | .081 /2.06 | .450 /11.43 | .175 /4.44 | .82 /23.4   | .187/4.75                 | .24/6.1 | .13/3.3 | .055/1.40                 | BRASS .020/0.51                | ZINC CHROMATE   |

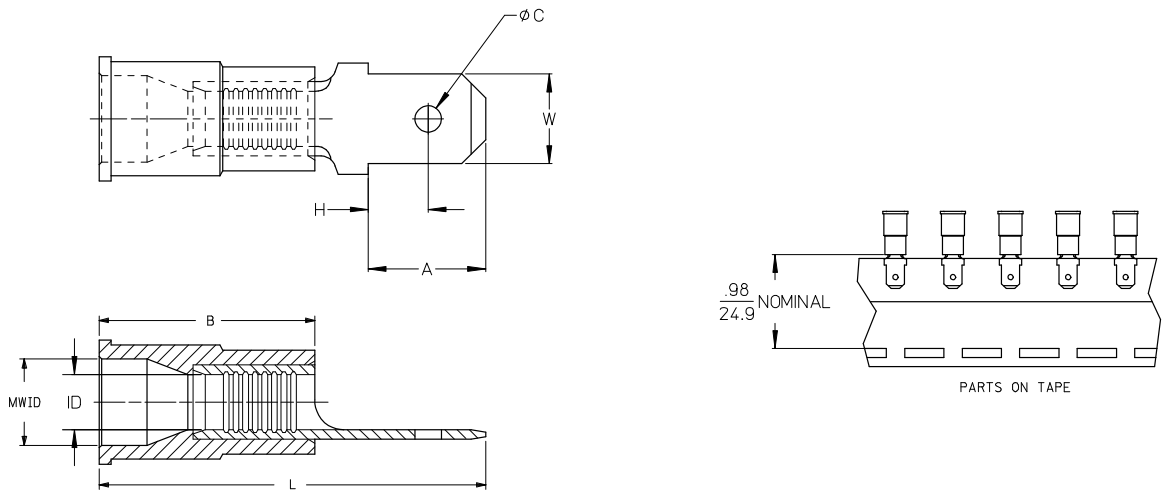

© (ALL NOTES)

- NOTES:
1. MALE QD MATERIAL: SEE CHART
  2. MALE QD FINISH: SEE CHART
  3. INSULATION MATERIAL: PVC
  4. TAB DIMENSIONS CONFORM TO UL310 SPECIFICATIONS.
  5. PART IS ROHS COMPLIANT.

|  |                          |   |   |                           |   |                        |  |
|--|--------------------------|---|---|---------------------------|---|------------------------|--|
| REDRWN W/MATL & FIN CHG<br>EC NO: ETC2007-0081<br>DRW: WHEHLE 2008/01/28<br>CHKD: JMCNEIL 2008/01/28<br>APPR: JMCNEIL 2008/02/13 | QUALITY SYMBOLS          | GENERAL TOLERANCES (UNLESS SPECIFIED)   | DIMENSION STYLE IN/MM ©   | SCALE ---                 | DESIGN UNITS INCH   | THIRD ANGLE PROJECTION |  |
|  | $\nabla=0$<br>$\nabla=0$ | 4 PLACES ± --- ± ---<br>3 PLACES ± --- ± ---<br>2 PLACES ± --- ± ---<br>1 PLACE ± --- ± ---<br>ANGULAR ± ---° | DRAWN BY RCM DATE 1991/01/25<br>CHECKED BY DATE ---<br>APPROVED BY DATE --- | TITLE                     | MALE QUICK DISCONNECT, INSULKRIMP   |                        |  |
|  |                          | DRAFT WHERE APPLICABLE MUST REMAIN WITHIN DIMENSIONS  | MATERIAL NO. SEE CHART  | DOCUMENT NO. SD-19023-004 | MOLEX INCORPORATED<br>THIS DRAWING CONTAINS INFORMATION THAT IS PROPRIETARY TO MOLEX INCORPORATED AND SHOULD NOT BE USED WITHOUT WRITTEN PERMISSION |                        |  |
|  |                          |   | SIZE B  |                           | SHEET NO. 1 OF 1  |                        |  |