

# Customer Information Sheet

DRAWING No.: M20-615XX05 SHEET 2 OF 2 IF IN DOUBT - ASK (C) NOT TO SCALE THIRD ANGLE PROJECTION ALL DIMENSIONS IN mm

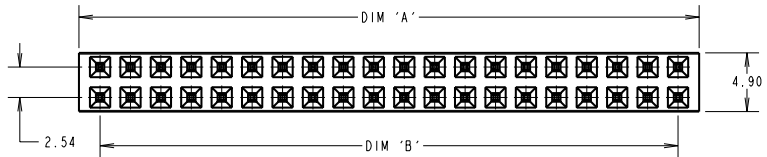

PART No.	No. OF WAYS	DIM 'A'	DIM 'B'	DIM 'C'
M20-6150405	4+4	11.18	7.62	10.16
M20-6152005	20+20	51.82	48.26	50.80
M20-6153205	32+32	82.30	78.74	81.28

**SPECIFICATIONS:**  
**MATERIAL:**  
 MOULDING = PPS UL94V-0 BLACK  
 CONTACTS = PHOSPHOR BRONZE  
**FINISH:**  
 CONTACTS = 0.25µ GOLD OVER NICKEL  
**ELECTRICAL:**  
 CURRENT RATING = 1 AMP MAX  
 VOLTAGE RATING = 12V DC  
 CONTACT RESISTANCE = 30 mΩ MAX, 50 mΩ MAX AFTER CONDITIONING  
 INSULATION RESISTANCE = 5,000 MΩ MIN  
 DIELECTRIC STRENGTH = 1000V AC FOR 1 MINUTE  
**MECHANICAL:**  
 DURABILITY = 10 OPERATIONS  
 INSERTION FORCE (CONTACT) = 2N/PIN MAX  
 WITHDRAWAL FORCE (CONTACT) = 0.25N/PIN MIN  
 INSERTION FORCE (BOARD) = 80N/PIN MAX  
 WITHDRAWAL FORCE (BOARD) = 20N/PIN MIN  
**ENVIRONMENTAL:**  
 TEMPERATURE RANGE = -55°C TO +105°C  
**PACKING:**  
 TUBE FOR CONNECTOR & PLASTIC BAG FOR SPACER

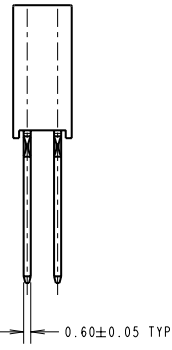
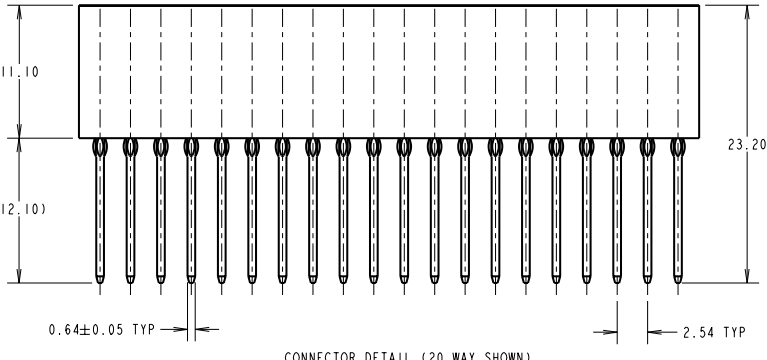

- NOTES:**
- ALL TOLERANCES ARE ±0.20 UNLESS OTHERWISE STATED.
  - FOR COMPLETE SPECIFICATION, SEE COMPONENT SPECIFICATION C039XX (LATEST ISSUE).
  - RECOMMENDED PCB PLATED-THROUGH HOLE SIZE:  
 DRILLED HOLE =  $\varnothing 1.15 \pm 0.02$ mm,  
 PLATING THICKNESSES = 25-75µ COPPER, 3µ MIN NICKEL/GOLD,  
 FINAL PLATED HOLE =  $\varnothing 1.09 - 1.00$ mm.
  - CONTACT DEPTH = 2.63mm.

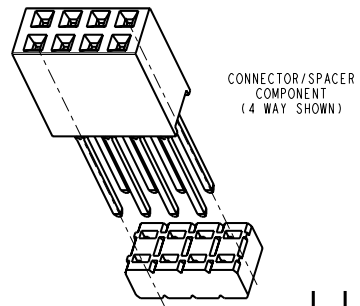

CONNECTOR/SPACER COMPONENT (4 WAY SHOWN)

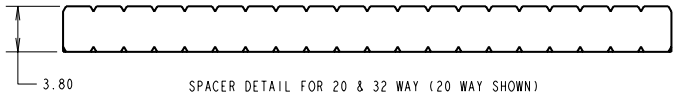
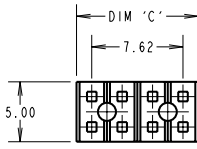
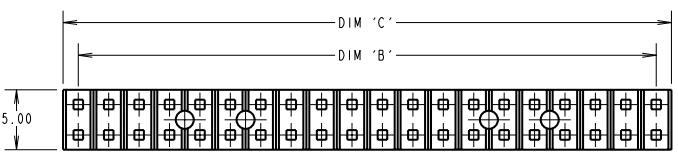

SPACER DETAIL FOR 20 & 32 WAY (20 WAY SHOWN)



SPACER DETAIL FOR 4 WAY

ORDER CODE:  
**M20-615XX05**  
 No. OF WAYS PER ROW  
 04, 20, 32

CP	8	03.12.09	10582
NAME	ISS.	DATE	C/NOTE
APPROVED: C.PENROSE			
CHECKED: R.ADEE			
DRAWN: W. J. BOURNE			
CUSTOMER REF.:			
ASSEMBLY DRG:			

<b>HARWIN</b>			THIS DRAWING AND ANY INFORMATION OR DESCRIPTIVE MATTER SET OUT HEREON ARE CONFIDENTIAL AND COPYRIGHT PROPERTY OF THE HARWIN GROUP AND MUST NOT BE DISCLOSED, LOANED, COPIED OR USED FOR MANUFACTURING, TENDERING OR FOR ANY OTHER PURPOSE WITHOUT THEIR WRITTEN PERMISSION.	TOLERANCES X = ±1mm X, Y = ±0.25mm X, Y, Z = ±0.07mm ANGLES = ±5° UNLESS STATED	MATERIAL: SEE ABOVE FINISH: SEE ABOVE S/AREA: mm <sup>2</sup>	TITLE: PCI04 PRESS-FIT CONNECTOR & SPACER (STACKTHROUGH) DRAWING NUMBER: <b>M20-615XX05</b>	SHT 2 OF 2
HARWIN USA TEL: 603 893 5376 FAX: 603 893 5396 mis@harwin.com	HARWIN Europe (UK) TEL: 023 9231 4545 FAX: 023 9231 4590 mis@harwin.co.uk	HARWIN Asia TEL: +65 6 779 4909 FAX: +65 6 779 3868 mis@harwin.com.sg					