

Fixed Attenuators - 2W power (SMA type)

AT-1900 Series



■ Features

1.Small Size

Use of alumina for the attenuation element assures light weight and is cost effective.

2.SMA coupling

Several configurations of SMA plug/jack couplings are available in stainless steel, assuring durability.

3.High Reliability

Proven and stable performance characteristic under varying temperature, humidity and adverse environmental conditions.

■ Product Specifications

Ratings	Frequency range Characteristic impedance Maximum Input Power	DC to 8.0GHz 50 ohms 2W	Operating temperature Operating Humidity	-30°C ~ +65°C 95% max.
---------	--	-------------------------------	---	---------------------------

Item	Characteristic Requirement	Conditions
1.Vibration	No electrical discontinuity of 1 μs or more. No damage, cracks, or parts dislocation.	Frequency of 10 to 2000 Hz, overall amplitude of 1.52 mm, acceleration of 98 m/s ² for 4 hours in each of 3 directions
2.Shock		Acceleration of 490 m/s ² , sine half-wave waveform, 3 cycles in each of the 3 axis
3.Temperature cycle	No damage, cracks, or parts dislocation.	Temperature : -35°C → +15°C to +35°C → +85°C → +15°C to +35°C Time : 30 → 15 max. → 30 → 15 max. (Minutes) 5 cycles

●The test method conforms to MIL-STD-202.

■ Material

Component	Material	Finish
Body	Stainless steel	Passivated
Insulator	PTFE	—
Male contact	Brass	Gold plated
Female contact	Beryllium copper	Gold plated
Outer conductor (interior)	Aluminum	Nickel plated
Couplings	Stainless steel	Passivated
Radiator	Aluminum	Black alumite
Attenuation element	Alumina	—

■ Ordering Information

AT - 19 03 (40)
 ① ② ③ ④

① Fixed attenuator	③ Attenuation 03 : 3dB 06 : 6dB 10 : 10dB
② Series Name and coupling type: SMA plug / jack	④ (40): RoHS Compliant

AT-1900 Series Fixed Attenuators - 2W power (SMA type)

Specifications

Part Number	Frequency Range (GHz)	Attenuation (dB)	V.S.W.R. (Max)	Impedance (ohms)	Power (W)	Connectors	Weight (g)	RoHS
AT-1903(40)	DC~4	3±0.3	1.25	50	2	SMA type plug / jack	40	YES
	4~8	3±0.5						
AT-1906(40)	DC~4	6±0.3	1.25	50	2	SMA type plug / jack	40	
	4~8	6±0.5						
AT-1910(40)	DC~4	10±0.5	1.3	50	2	SMA type plug / jack	40	
	4~8	10±1						

External Dimensions

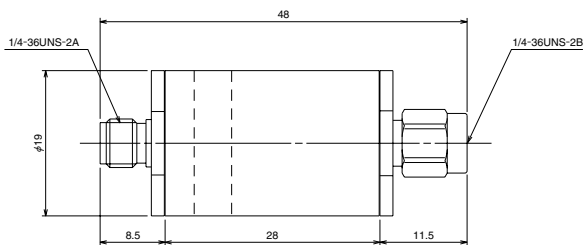

AT-1900 Type

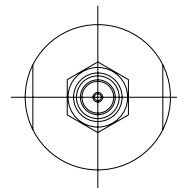

Typical Data

