

PLEASE CHECK WWW.MOLEX.COM FOR LATEST PART INFORMATION

Part Number: [0190430009](#)
Status: **Active**
Description: Double Male / Single Female Quick Disconnect Adapter, .187 x .020 Tab Size, Non-Plated

Documents:

[Drawing \(PDF\)](#) [RoHS Certificate of Compliance \(PDF\)](#)

General

Product Family	Quick Disconnects
Series	19043
Crimp Quality Equipment	Yes
Product Name	Adapter
Type	Quick Disconnect

Physical

Barrel Type	N/A
Gender	Dual
Glow-Wire Compliant	No
Insulation	None
Lock to Mating Part	None
Material - Plating Mating	Tin
Material - Plating Termination	Tin
Orientation	Straight
Packaging Type	Bag
Plating min: Mating (µin)	100
Plating min: Mating (µm)	2.5
Plating min: Termination (µin)	100
Plating min: Termination (µm)	2.5
Tab Thickness	0.51mm (.020")
Tab Width	4.75mm (.187")
Termination Interface: Style	N/A
Wire Insulation Diameter	N/A
Wire Size AWG	N/A

Electrical

Voltage - Maximum	N/A
-------------------	-----

Material Info

Old Part Number	MMFA-187
-----------------	----------

Reference - Drawing Numbers

Sales Drawing	SD-19043-002
---------------	--------------

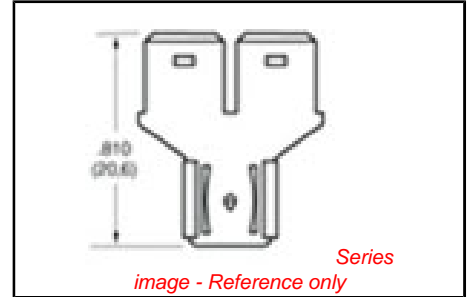

<p>EU RoHS ELV and RoHS Compliant REACH SVHC Not Reviewed Halogen-Free Status Not Reviewed</p>	<p>China RoHS</p> 
<p>Need more information on product environmental compliance?</p> <p>Email productcompliance@molex.com For a multiple part number RoHS Certificate of Compliance, click here</p> <p>Please visit the Contact Us section for any non-product compliance questions.</p>	

Search Parts in this Series
[19043Series](#)

PLEASE CHECK WWW.MOLEX.COM FOR LATEST PART INFORMATION

SD-19043-002

6	5	4	3	2	1
MATERIAL NUMBER	ENGINEERING NUMBER	PLATING	CARRIER		
190430009	MMFA-187	TIN PLATED	LOOSE PIECE		

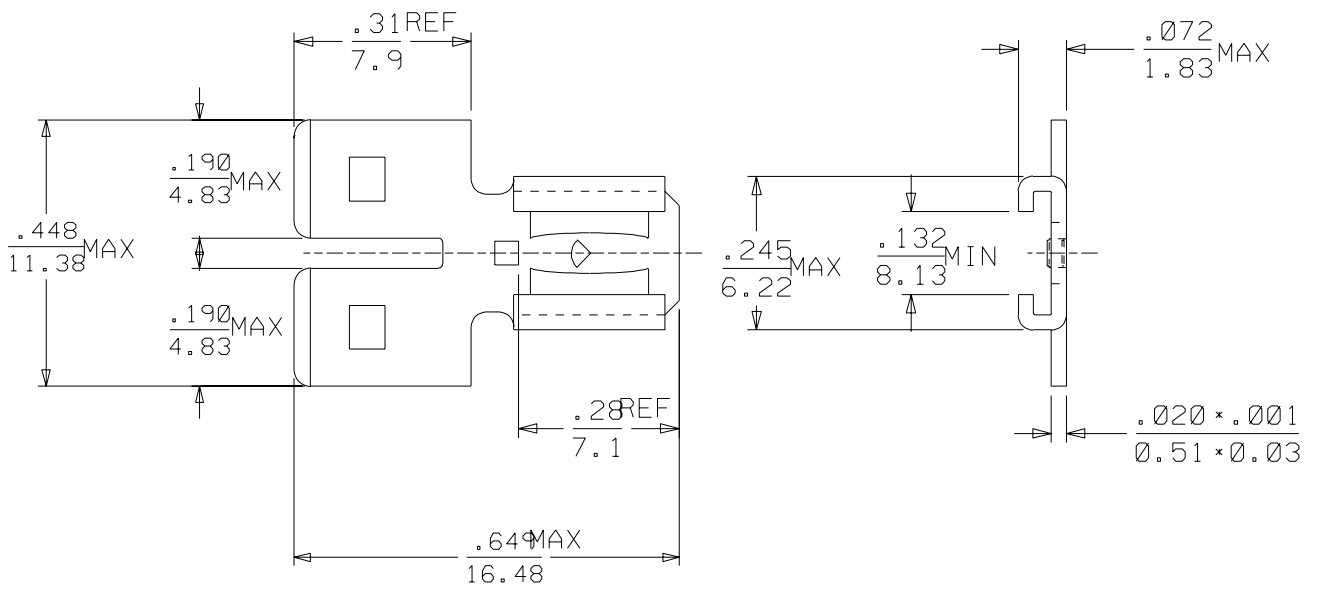

SALES DRAWING

- NOTES:
- MATERIAL: BRASS
 - PLATING SEE CHART.

REL TO PRODUCTION EC NO: ETC2002-0055 DRAWN BY: 01/09/18 CHK: HEB 01/09/18 APPR: RWD 01/09/18	QUALITY SYMBOLS MAJOR $\nabla=0$ CRITICAL $\nabla c=0$	GENERAL TOLERANCES: (UNLESS SPECIFIED)		SCALE 4:1	DESIGN UNITS <input type="checkbox"/> mm <input checked="" type="checkbox"/> INCH	THIRD ANGLE PROJECTION	DIMENSIONS: <input type="checkbox"/> mm <input checked="" type="checkbox"/> INCH <input type="checkbox"/> mm ONLY	SHT	REV	
		4 PLACES $\pm 0.$	$\pm .$	DRAWN BY & DATE BRE 01/08/24		TITLE: DBL MALE/SINGLE FEMALE QUICK DISCONNECT .187 X .020 TAB SIZE				
		3 PLACES $\pm 0.$	$\pm .005$	CHECKED BY & DATE HEB 01/08/24		MOLEX INCORPORATED				
		2 PLACES ± 0.13	$\pm .01$	APPROVED BY & DATE RWD 01/08/24		CAD FILENAME SD-19043-002.DGN	MATERIAL NO. SEE CHART	DRAWING NO. SD-19043-002	SHEET NO. 1 OF 1	SIZE A
1 PLACE ± 0.25	$\pm .$	ANGULAR: $\pm 1/2^\circ$		DRAFT WHERE APPLICABLE MUST REMAIN WITHIN DIMENSIONS					THIS DRAWING CONTAINS INFORMATION THAT IS PROPRIETARY TO MOLEX INCORPORATED AND SHOULD NOT BE USED WITHOUT WRITTEN PERMISSION.	

LBORD.DGN REV A
96/06/12 LEVEL 3

5

4

3

2

1