

PLEASE CHECK WWW.MOLEX.COM FOR LATEST PART INFORMATION

Part Number: [0190430020](#)
Status: **Active**
Description: Double Male / Single Female Quick Disconnect Adapter, .250 x .032 Tab Size

Documents:

[Drawing \(PDF\)](#) [RoHS Certificate of Compliance \(PDF\)](#)

General

Product Family	Quick Disconnects
Series	19043
Crimp Quality Equipment	Yes
Product Name	Adapter
Type	Quick Disconnect

Physical

Barrel Type	Closed
Gender	Dual
Glow-Wire Compliant	No
Insulation	None
Lock to Mating Part	None
Material - Metal	Brass
Material - Plating Mating	Tin
Material - Plating Termination	Tin
Orientation	Straight
Packaging Type	Bag
Plating min: Mating (µin)	160
Plating min: Mating (µm)	4
Plating min: Termination (µin)	160
Plating min: Termination (µm)	4
Polarized to Mating Part	No
Tab Thickness	0.81mm (.032")
Tab Width	6.35mm (.250")
Wire Insulation Diameter	N/A
Wire Size AWG	N/A

Electrical

Voltage - Maximum	N/A
-------------------	-----

Material Info

Old Part Number	MMFA-1
-----------------	--------

Reference - Drawing Numbers

Sales Drawing	SD-19043-001
---------------	--------------

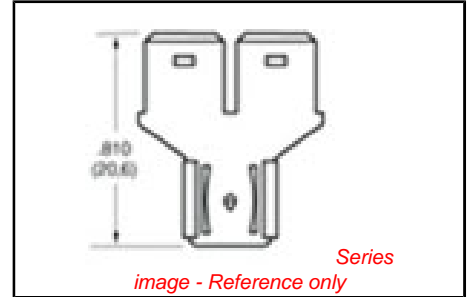

EU RoHS

ELV and RoHS Compliant

REACH SVHC

Contains SVHC: No

Halogen-Free

Status

Not Reviewed

Need more information on product environmental compliance?

Email productcompliance@molex.com
 For a multiple part number RoHS Certificate of Compliance, [click here](#)

Please visit the [Contact Us](#) section for any non-product compliance questions.

China RoHS



Search Parts in this Series
[19043Series](#)

PLEASE CHECK WWW.MOLEX.COM FOR LATEST PART INFORMATION

SD-19043-001

6	5	4	3	2
MATERIAL NUMBER	ENGINEERING NUMBER	PLATING	CARRIER	
I90430001	MMFA	NON-PLATED	LOOSE PIECE	
I90430020	MMFA-1	TIN PLATED	LOOSE PIECE	2

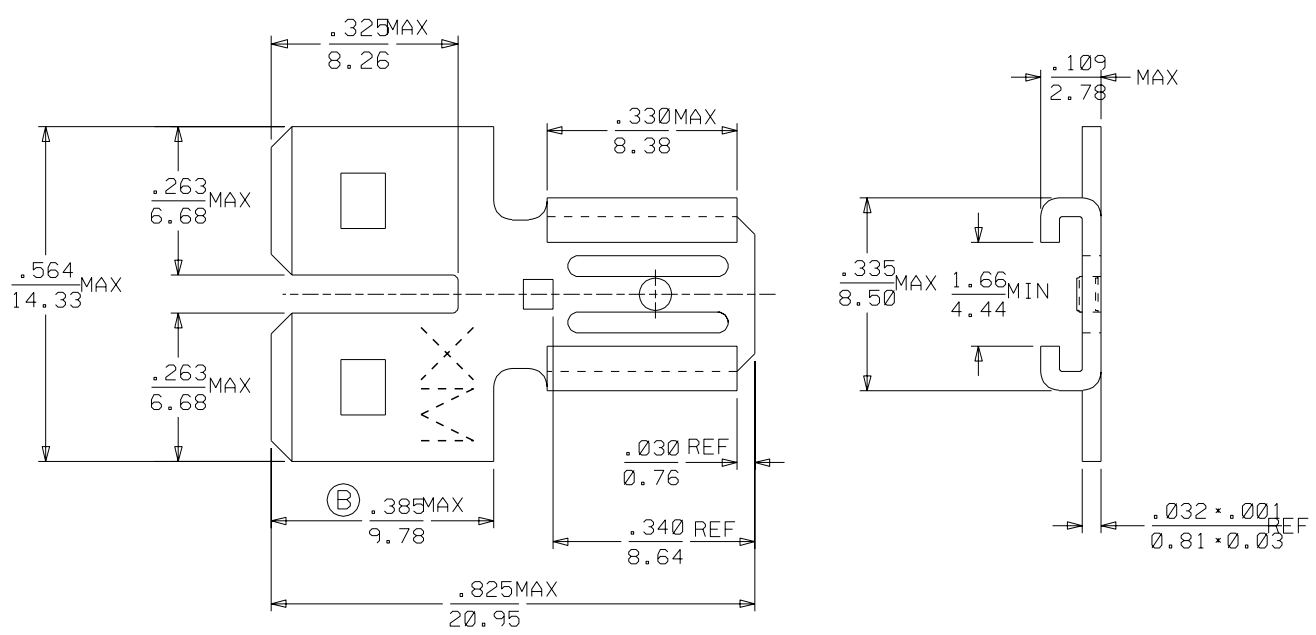

SALES DRAWING

- NOTES:
- MATERIAL: BRASS
 - PLATING SEE CHART.

ADDED MAX EC NO. ETC2003-0214 DRAWN BY: 01/07/25 CHK: HEB 01/07/25 APPR: RWD 01/07/25	QUALITY SYMBOLS MAJOR = 0 CRITICAL C = 0	GENERAL TOLERANCES: (UNLESS SPECIFIED)		SCALE 4:1	DESIGN UNITS <input type="checkbox"/> mm <input checked="" type="checkbox"/> INCH	DIMENSIONS: <input type="checkbox"/> mm <input checked="" type="checkbox"/> INCH <input type="checkbox"/> mm ONLY	SHT REV	
		4 PLACES ±0. ±.	3 PLACES ±0. ±.	2 PLACES ±0. ±.	1 PLACE ±0. ±.	DRAWN BY & DATE EDB 01/04/04	TITLE: DBL MALE/SINGLE FEMALE QUICK DISCONNECT .250 X .032 TAB SIZE	
		ANGULAR: ± °				CHECKED BY & DATE RWD 01/04/04	MOLEX INCORPORATED	
		DRAFT WHERE APPLICABLE MUST REMAIN WITHIN DIMENSIONS				APPROVED BY & DATE RWD 01/04/04	CAD FILENAME SD1904300.DGN	MATERIAL NO. SEE CHART

LBORD.DGN REV A 96/06/12 LEVEL 3

THIS DRAWING CONTAINS INFORMATION THAT IS PROPRIETARY TO MOLEX INCORPORATED AND SHOULD NOT BE USED WITHOUT WRITTEN PERMISSION.