

PLEASE CHECK WWW.MOLEX.COM FOR LATEST PART INFORMATION

Part Number: [0190430001](#)
Status: **Active**
Description: Double Male / Single Female Quick Disconnect Adapter, .250 x .032 Tab Size, Non-Plated

Documents:

[Drawing \(PDF\)](#) [RoHS Certificate of Compliance \(PDF\)](#)

General

Product Family	Quick Disconnects
Series	19043
Crimp Quality Equipment	Yes
MolexKits	Yes
Product Name	Adapter
Type	Quick Disconnect

Physical

Barrel Type	N/A
Gender	Dual
Glow-Wire Compliant	No
Insulation	None
Lock to Mating Part	None
Material - Metal	Brass
Orientation	Straight
Packaging Type	Bag
Tab Thickness	0.81mm (.032")
Tab Width	6.35mm (.250")
Termination Interface: Style	N/A
Wire Insulation Diameter	N/A
Wire Size AWG	N/A

Electrical

Voltage - Maximum	N/A
-------------------	-----

Material Info

Old Part Number	MMFA
-----------------	------

Reference - Drawing Numbers

Sales Drawing	SD-19043-001
---------------	--------------

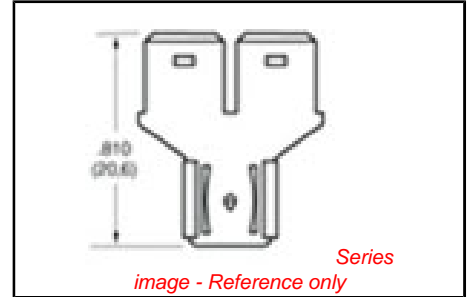

<p>EU RoHS ELV and RoHS Compliant REACH SVHC Contains SVHC: No Halogen-Free Status Halogen-Free</p>	<p>China RoHS</p> 
<p>Need more information on product environmental compliance?</p> <p>Email productcompliance@molex.com For a multiple part number RoHS Certificate of Compliance, click here</p> <p>Please visit the Contact Us section for any non-product compliance questions.</p>	

Search Parts in this Series
[19043Series](#)

PLEASE CHECK WWW.MOLEX.COM FOR LATEST PART INFORMATION

SD-19043-001

6	5	4	3	2
MATERIAL NUMBER	ENGINEERING NUMBER	PLATING	CARRIER	
I90430001	MMFA	NON-PLATED	LOOSE PIECE	
I90430020	MMFA-1	TIN PLATED	LOOSE PIECE	2

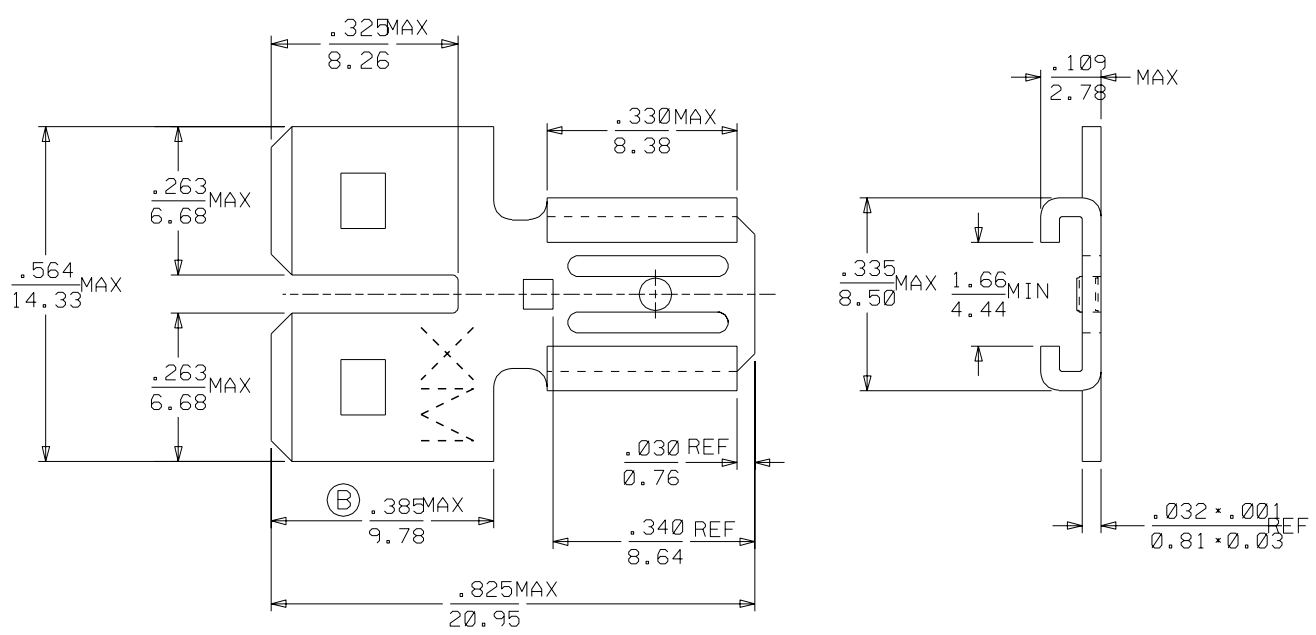

SALES DRAWING

- NOTES:
- MATERIAL: BRASS
 - PLATING SEE CHART.

ADDED MAX EC NO. ETC2003-0214 DRAWN BY: 01/07/25 CHK: HEB 01/07/25 APPR: RWD 01/07/25 B REV	QUALITY SYMBOLS MAJOR = 0 CRITICAL C = 0	GENERAL TOLERANCES: (UNLESS SPECIFIED)		SCALE 4:1	DESIGN UNITS <input type="checkbox"/> mm <input checked="" type="checkbox"/> INCH	DIMENSIONS: <input type="checkbox"/> mm <input checked="" type="checkbox"/> INCH <input type="checkbox"/> mm ONLY	SHT REV	
		4 PLACES ±0. ±.	3 PLACES ±0. ±.	2 PLACES ±0. ±.	1 PLACE ±0. ±.	DRAWN BY & DATE EDB 01/04/04	TITLE: DBL MALE/SINGLE FEMALE QUICK DISCONNECT .250 X .032 TAB SIZE	
		ANGULAR: ± °		DRAFT WHERE APPLICABLE MUST REMAIN WITHIN DIMENSIONS		CHECKED BY & DATE RWD 01/04/04	APPROVED BY & DATE RWD 01/04/04	
				CAD FILENAME SD1904300.DGN	MATERIAL NO. SEE CHART	DRAWING NO. SD-19043-001	SHEET NO. 1 OF 1	SIZE A

LBORD.DGN REV A 96/06/12 LEVEL 3