

male

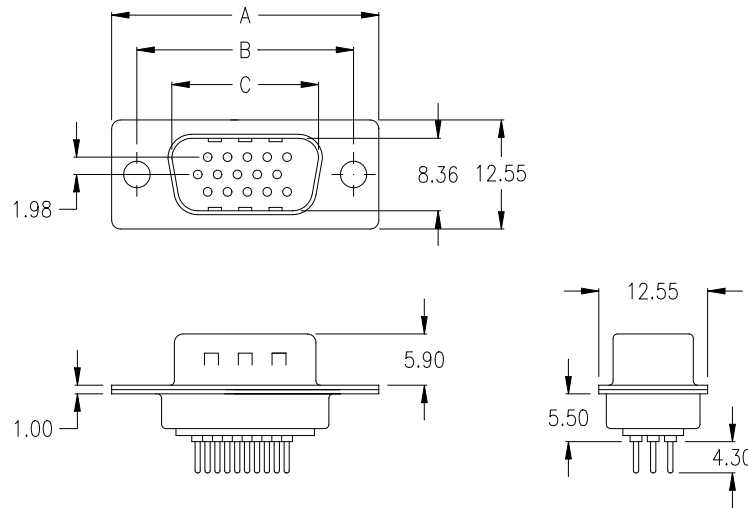

Ordering Code

SHM - xxx - S111 - 95 / XXX

No. of contacts

Option

Plating: **-95** = tin/leadfree/gold

General Specification page 72

No. of contacts	Dimension		
	A	B	C
015	30.81 1.213	24.99 .984	16.92 .666
026	39.14 1.541	33.32 1.312	25.25 .994
044	53.04 2.088	47.04 1.852	38.96 1.534
062	69.32 2.729	63.50 2.500	55.42 2.182

Options

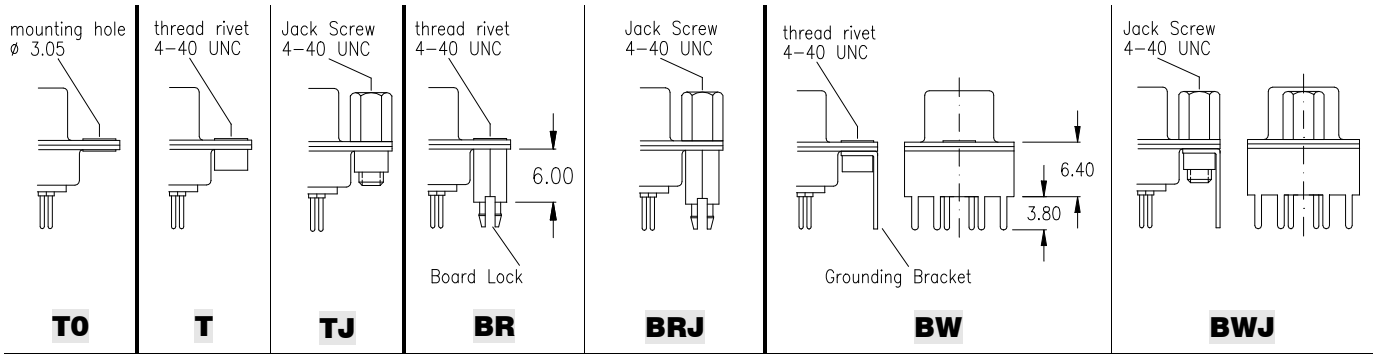

PCB Layout „male“

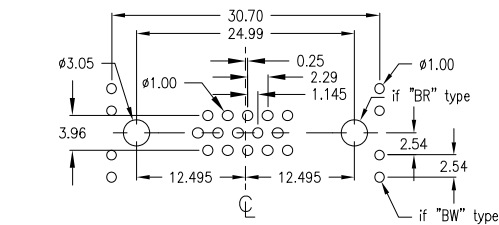

15 pin

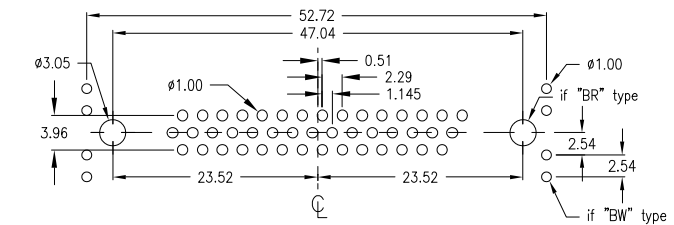

44 pin

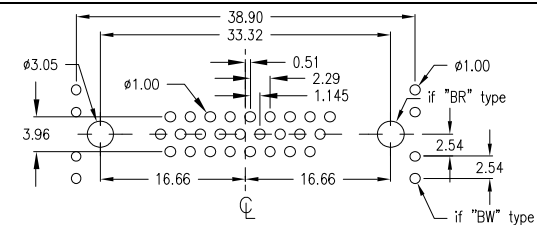

26 pin

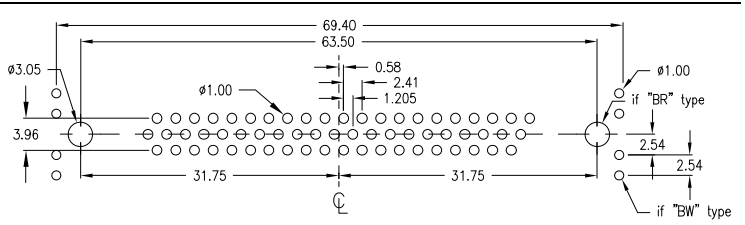

62 pin