

SM6050N

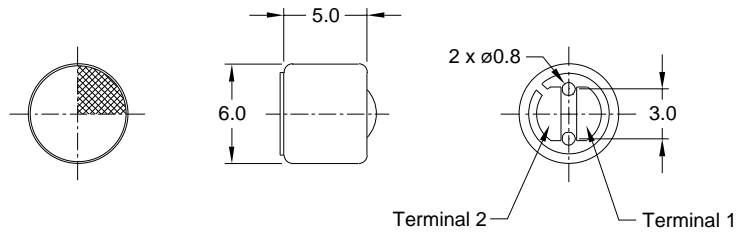

SM9752N

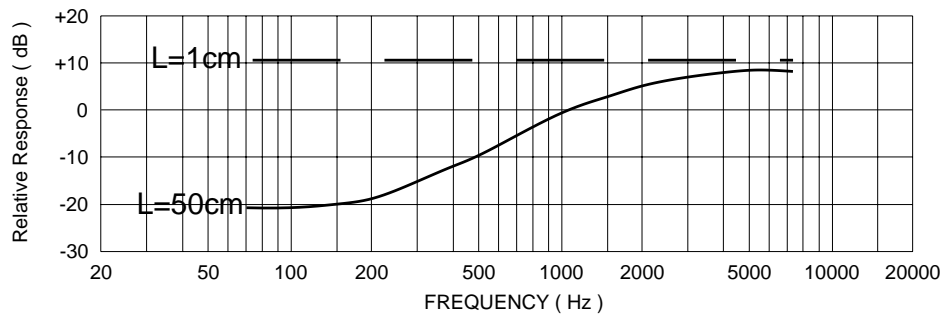
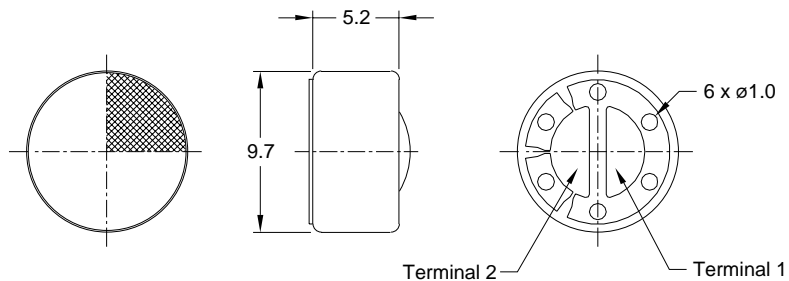

SPECIFICATIONS	
IMPEDANCE	Low impedance
DIRECTIVITY	Noise Cancelling
S/N RATIO	More than 58dB
SENSITIVITY REDUCTION	Within -3dB at 1 Volt
FREQUENCY RANGE	50 Hz to 5,000 Hz
STANDARD OPERATING VOLTAGE	1.5 Volt
CURRENT CONSUMPTION	Maximum 500 μ A

PART NUMBER TABLE		
SENSITIVITY (0dB=1V/pa, 1kHz)	(Vs=1.5V, RL=680 Ω)	
	SM6050Nx	SM9752Nx
-47 \pm 4dB	SM6050N474	SM9752N474
-51 \pm 4dB	SM6050N514	SM9752N514

