

SERIES 10X43HCA HIGH POWER LED

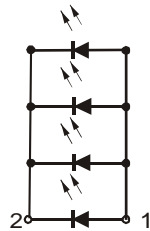

1. Anode
2. Cathode

PACKAGE DIMENSIONS (UNIT: mm)

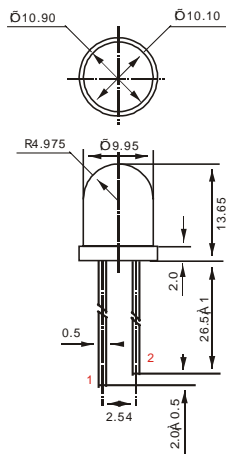
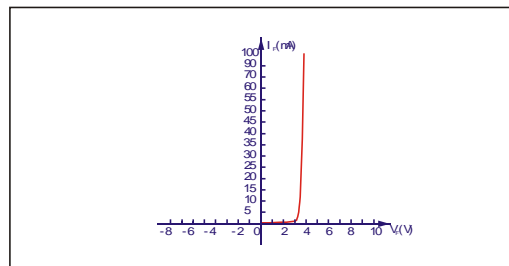
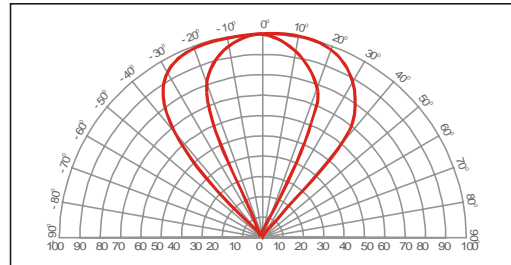

Electro-Optical Characteristics (Ta=25°C)

Items	Epoxy Package	Lead frame	Emitting Color	Wavelength	Electro-Optical Characteristics			
				λ_p	V_F	I_F	I_v (mcd)	
				(nm)	(V)	(mA)	50°	80°
10W43HCA-H	flange	Normal	White	—	<4.0	80	15000	13000
10B43HCA-H	flange	Normal	Blue	465-470	<4.0	80	10000	8000
10G43HCA-H	flange	Normal	Green	520-540	<3.8	80	18000	15000
10R43HCA-H	flange	Normal	Red	620-630	<2.2	80	8000	7000
10Y43HCA-H	flange	Normal	Yellow	580-590	<2.2	80	9000	7500

Absolute maximum ratings (Ta=25°C)

Parameter	Symbol	Testing Conditions				Unit
			Min	Typ	Max	
Power Dissipation	P_D	—	—	—	100	mW
Reverse Current	V_R	$I_R \leq 30 \mu A$	—	—	6.0	V
Working Temperature	T_{OPR}	—	—	—	+70	°C
Soldering Temperature	T_{STG}	—	—	—	100	°C
Soldering Temperature	T_{SLD}	260°C (5 s)				

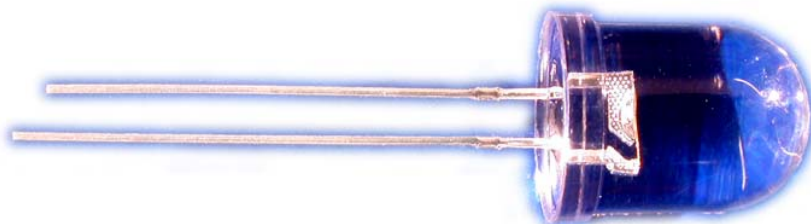

ROITHNER LASERTECHNIK

A-1040 Vienna, Austria
Schoenbrunner Strasse 7
Tel.: +43-1-586 52 43 - 0
Fax.: +43-1-586 52 43 44
office@roithner-laser.com
www.roithner-laser.com