

Surface Mount LED, 0678 Multicolor Series

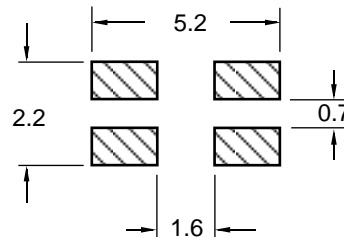

The 0670 series lamps are miniature chip type designed for surface mounting. These lamps are the so-called "Top LED" type, measuring approximately 2.8 x 3.6 mm. These lamps are available in EIA481 tape and reel packaging with approximately 2000 pcs per reel. For tape and reel packaging the series number is 0678.

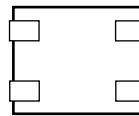
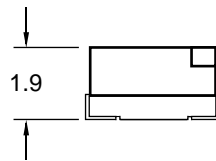
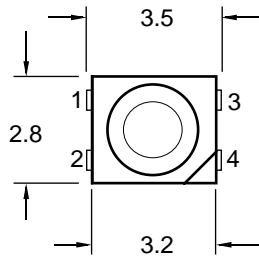

Recommended
reflow
solder pattern

Pin assignments:

- Bi-color: 1. Green cathode
2. Red anode
3. Green anode
4. Red cathode

- Full color: 1. Red cathode
2. Common Anode
3. Blue cathode
4. Green cathode



RoHS Compliant
Aug 2004

GENERAL INFORMATION

| | |
|------------------------------|----------------------|
| Operating Temperature Range | -40 °C to +85 °C |
| Storage Temperature Range | -40 °C to +90 °C |
| Reflow Soldering Temperature | 260 °C for 5 sec max |

APPLICATION INFORMATION (ALL RATINGS AT 25 °C AMBIENT)

| Part No. | Emitted Color | Peak | $\Delta\lambda$ | Absolute Maximum Ratings | | | | | E/O Characteristics | | | | | |
|--------------|---------------|-----------|-----------------|--------------------------|---------|-----|-----|----|----------------------|-----------------------|-----|-----------------------|-----|-----------------|
| | | λ | | Pd | If (mA) | | Ir | Vr | Vf (V) @ If=20mA | | | Iv (mcd) @ If=20mA | | $2\Theta_{1/2}$ |
| | | (nm) | | | (mW) | dc | | | 1/10 duty @ 1 kHz | @ Vr=5V (μ A) | (V) | Min | Typ | |
| IVRVGC0678 | Red | 640 | 45 | 70 | 25 | 90 | 100 | 5 | - | 2.0 | 2.8 | 6 | 10 | 120 |
| | Green | 570 | 30 | 70 | 25 | 90 | 100 | 5 | - | 2.1 | 2.8 | 15 | 25 | 120 |
| ISRUGC0678 | Red | 660 | 20 | 100 | 30 | 200 | 100 | 5 | - | 1.7 | 2.4 | 19 | 32 | 120 |
| | Green | 570 | 30 | 70 | 30 | 90 | 100 | 5 | - | 2.1 | 2.8 | 16 | 28 | 120 |
| ISRVGC0678 | Red | 660 | 20 | 100 | 30 | 200 | 100 | 5 | - | 1.7 | 2.4 | 19 | 32 | 120 |
| | Green | 570 | 30 | 70 | 25 | 90 | 100 | 5 | - | 2.1 | 2.8 | 15 | 25 | 120 |
| ISRUGUBC0678 | Red | 660 | 20 | 100 | 30 | 200 | 100 | 5 | - | 1.7 | 2.4 | 17 | 28 | 120 |
| | Green | 570 | 30 | 70 | 30 | 90 | 100 | 5 | - | 2.1 | 2.8 | 17 | 28 | 120 |
| | Blue | 430 | 65 | 100 | 30 | 100 | 100 | 5 | - | 4.5 | 5.5 | 32 | 46 | 120 |
| ISRVGUBC0678 | Red | 660 | 20 | 100 | 30 | 200 | 100 | 5 | - | 1.7 | 2.4 | 17 | 28 | 120 |
| | Green | 570 | 30 | 70 | 25 | 90 | 100 | 5 | - | 2.1 | 2.8 | 16 | 26 | 120 |
| | Blue | 430 | 65 | 100 | 30 | 100 | 100 | 4 | 3.5 | 4.5 | 5.5 | 32 | 46 | 120 |

Specifications subject to change without notice. Dimensions are in mm \pm 0.3 unless stated otherwise. *reversed polarity

IDEA, Inc., 1351 Titan Way, Brea, CA 92821 Ph:714-525-3302, 800-LED-IDEA; Fax: 714-525-3304 0508

009S-0670m