

LA120X Semiconductor Fuses

1200 VAC • Very Fast Acting • 1/2 – 30 Amperes



Littelfuse LA120X semiconductor protection fuses, rated 1/2 through 30A, 1200 VAC are popular for use in traction drive auxiliary circuits and similar applications. LA120X fuses are also suitable for use on 1000VDC auxiliary circuits with low time constants.

Features

- 1000 Volt DC rating for a wide range of circuits.
- Compact size fits in where competitive sizes will not fit.

Applications

Protection of traction drive auxiliary circuits, etc.

Dimensions

In Inches (mm in parentheses)

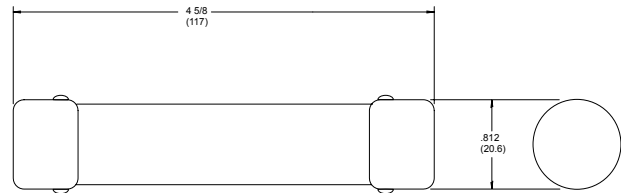

Ordering Information

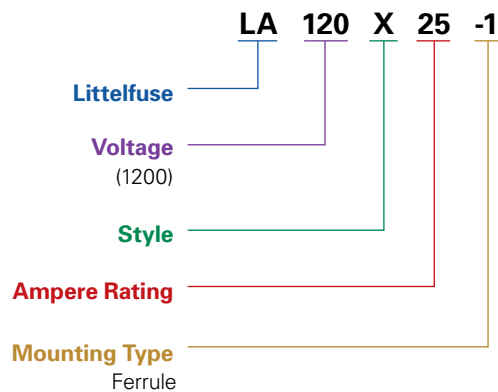

Catalog Numbers & Technical Data

Ampere Rating	Littelfuse Catalog Number	Mounting Type	Maximum Clearing I ² t @1200 VAC (A ² S)
1/2	LA120A1/2-1	1	1.9
1	LA120X1-1	1	7.5
2	LA120X2-1	1	30
3	LA120X3-1	1	69
4	LA120X4-1	1	120
5	LA120X5-1	1	190
6	LA120X6-1	1	280
10	LA120X10-1	1	970
15	LA120X15-1	1	2100
20	LA120X20-1	1	3700
25	LA120X25-1	1	5700
30	LA120X30-1	1	8300

Specifications

Voltage Rating: AC: 1200 Volts
DC: 1000 Volts
Interrupting Rating: 100,000 Amperes
Ampere Range: 1/2 – 30 Amperes

Note: Mounting type 1 can use 109002 and 129002 clips.

Special Purpose Fuses