

Model(型號): ROTARY POTENTIOMETER-----R15S11CP1

► Download PDF file



Features:(特點):

Small size ,high dependability, resistance ip to 15gf;cm

Applications(作用):

Remote control circuit.

Dimensions(規格圖):

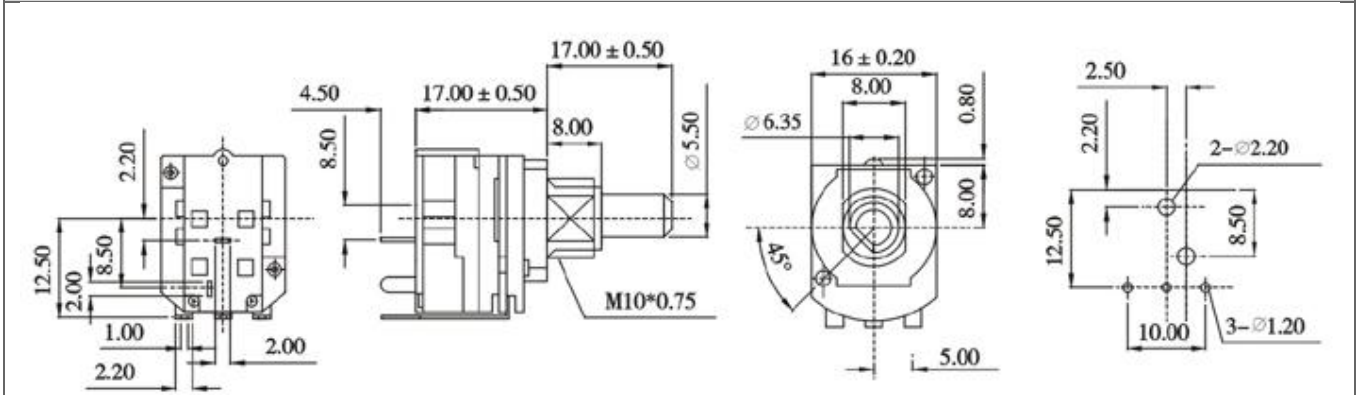

Specifications(規格)

Electrical Characteristics [ 電氣性能 ]

Total resistance [ 全阻抗值 ]	1Ω~2MΩ
Total resistance tolerance [ 全阻抗值容許差 ]	±20%
Ratings power(w) [ 額定功率 ]	B curve 0.033W,except B 0.017W
Restings taper[阻抗變化特性]	A,B,*C
Residual resistance [殘留阻值]	Less than 1%of total resistance
Sliding noise [滑動雜音]	47mV Max.
Withstanding voltage [耐電壓]	AC4200V.(交流峰值)
Insulation resistance [絕緣阻抗]	1GΩ Min. at DC 500V.
Max. operating voltage [最高使用電壓]	linear Taper B AC 200V, except B AC 150V.

Mechanical Characteristics [ 機械性能 ]

Overall rotational angle	270 ±10°
Operation torque [ 回轉力矩 ]	20~150gf . cm
Rotation stopper strength [ 止動強度 ]	6.0Kgf . cm Min.
Push-pull strength[推 拉強度]	6.0Kgf . cm Min.

Endurance Characteristics [ 耐久性能 ]

Rotational life [ 回轉壽命 ]	More than10,000 cycles
--------------------------	------------------------