

RoHS Compliant

## Features

- Charge sensitivity type shock sensor
- 25 degree inclined angle
- Small size, low profile, high sensitivity
- Tape and reel packaging available
- Reflow solderable

## Applications

- Data Protection for Disc Media such as HDD, DVD, CD-R/ RW etc.
- Other shock sensors.

## How to Order

PS A C 48 2 S - R  
 ① ② ③ ④ ⑤ ⑥ ⑦

- ① Series
- ② Terminal Structure
- ③ For consumer use
- ④ Size
- ⑤ Inclined Angle (2: 25°)
- ⑥ Electrical Characteristics
- ⑦ Packaging (R: Tape and Reel)

## Dimensions

(Unit: mm)

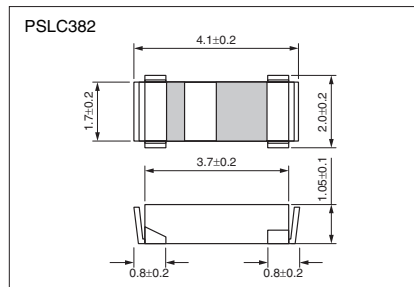
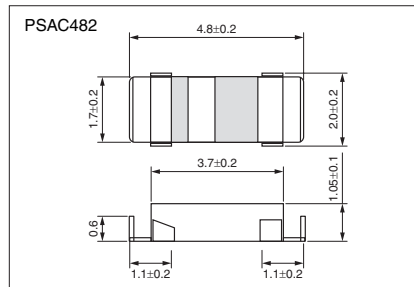

## Recommended Land Pattern

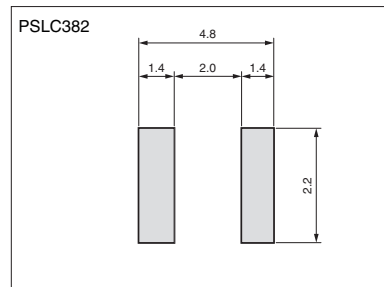
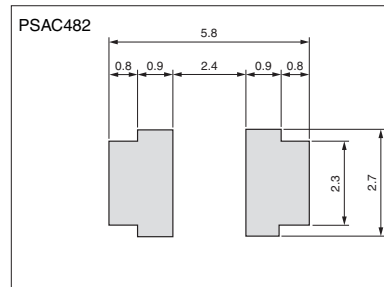

## Recommended Reflow Profile

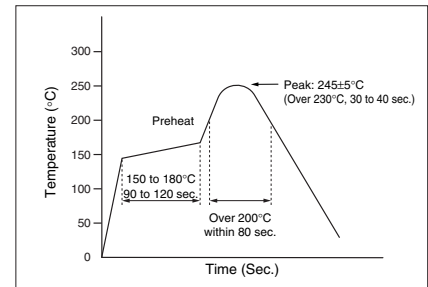

## Packaging

(Unit: mm)

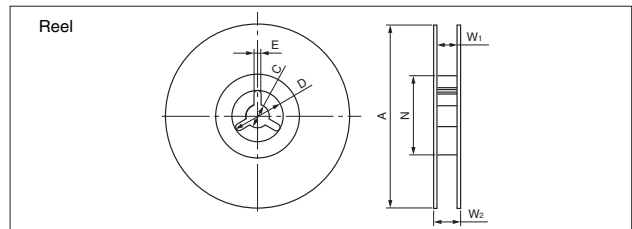
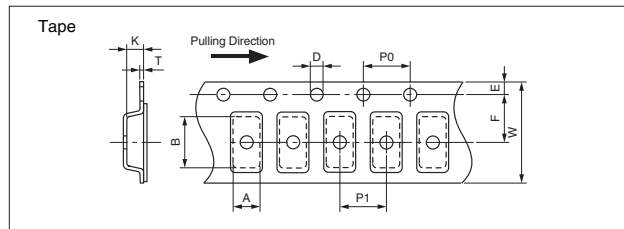

Part No.	Symbol	A	B	W	E	F
PSAC482	Dimension	2.5±0.1	5.1±0.1	12.0	1.75±0.1	5.5±0.05
PSLC382		2.25±0.1	4.4±0.1	+0.3/-0.1		
Part No.	Symbol	P0	P1	D	K	T
PSAC482	Dimension	4.0±0.1	4.0±0.1	1.5	1.25±0.1	0.3±0.05
PSLC382				+0.1/-0		

Symbol	A	N	W <sub>1</sub>	W <sub>2</sub>
Dimension	180±5.0	60 min.	12.5 +2.0/-0.0	20.5 max.
Symbol	C	D	E	
Dimension	13.0±0.2	21.0±0.8	2.0±0.5	

- PSAC482 3500 pcs./ Reel
- PSLC382 3000 pcs./ Reel

## Specifications

Part No.	Item	Inclined Angle (degree)	Capacitance (pF)	Charge Sensitivity (pC/ G)	Resonant Frequency (kHz)	Isolated Resistance (GΩ)	Non-linearity (%)
PSAC482S-R		25±3	315±30%	0.23±30%	23±30%	0.5 min.	5 max.
PSLC382S-R		25±3	315±30%	0.23±30%	23±30%	0.5 min.	5 max.