

CTLSH1-40M322

**SURFACE MOUNT
HIGH CURRENT, LOW V_F
SILICON SCHOTTKY RECTIFIER**

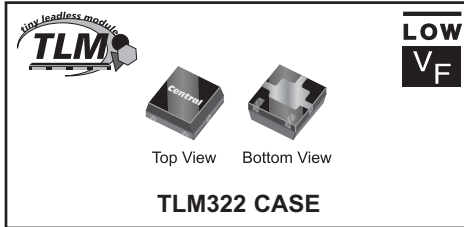

www.centrasemi.com



• Device is **Halogen Free** by design

APPLICATIONS:

- DC/DC Converters
- Reverse Battery Protection
- Battery powered devices including Cell Phones, PDAs, Digital Cameras, MP3 Players, etc.

MAXIMUM RATINGS: (T_A=25°C)

Peak Repetitive Reverse Voltage
 Continuous Forward Current
 Peak Repetitive Forward Current, tp≤1.0ms
 Peak Forward Surge Current, tp=8.0ms
 Power Dissipation (Note 1)
 Operating and Storage Junction Temperature
 Thermal Resistance (Note 1)

FEATURES:

- High Current (I_F=1.0A)
- Low Forward Voltage Drop (V_F=0.55V MAX @ 1.0A)
- High Thermal Efficiency

SYMBOL

SYMBOL		UNITS
V _{RRM}	40	V
I _F	1.0	A
I _{FRM}	3.5	A
I _{FSM}	10	A
P _D	1.45	W
T _J , T _{stg}	-65 to +150	°C
θ _{JA}	86.2	°C/W

ELECTRICAL CHARACTERISTICS: (T_A=25°C unless otherwise noted)

SYMBOL	TEST CONDITIONS	MIN	TYP	MAX	UNITS
I _R	V _R =5.0V			10	μA
I _R	V _R =8.0V			20	μA
I _R	V _R =15V			50	μA
I _R	V _R =40V			0.2	mA
I _R	V _R =40V, T _A =100°C			20	mA
BV _R	I _R =100μA	40			V
V _F	I _F =10mA			0.29	V
V _F	I _F =100mA			0.36	V
V _F	I _F =500mA			0.45	V
V _F	I _F =1.0A			0.55	V
C _J	V _R =4.0V, f=1.0MHz		50		pF
t _{rr}	I _F =I _R =500mA, I _{rr} =50mA, R _L =50Ω		15		ns

Notes: (1) FR-4 Epoxy PC Board with copper mounting pad area of 21mm².

R4 (19-February 2010)

CTLSH1-40M322

**SURFACE MOUNT
HIGH CURRENT, LOW V_F
SILICON SCHOTTKY RECTIFIER**



TLM322 CASE - MECHANICAL OUTLINE

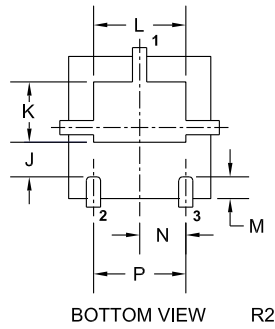
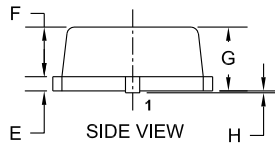
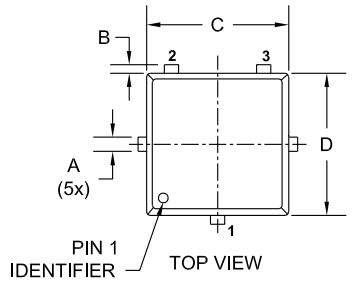

PIN CONFIGURATION

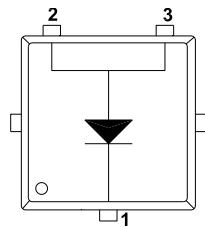

SYMBOL	INCHES		MILLIMETERS	
	MIN	MAX	MIN	MAX
A	0.007	0.012	0.17	0.30
B	---	0.005	---	0.125
C	0.075	0.083	1.90	2.10
D	0.075	0.083	1.90	2.10
E	0.006	0.010	0.15	0.25
F	0.026	0.030	0.65	0.75
G	0.031	0.039	0.80	1.00
H	0.000	0.002	0.00	0.05
J	0.024		0.60	
K	0.031	0.035	0.79	0.89
L	0.048	0.056	1.22	1.42
M	0.008	0.018	0.20	0.45
N	0.026		0.65	
P	0.051		1.30	

TLM322 (REV:R2)

**SUGGESTED MOUNTING PADS
For Maximum Power Dissipation
(Dimensions in mm)**

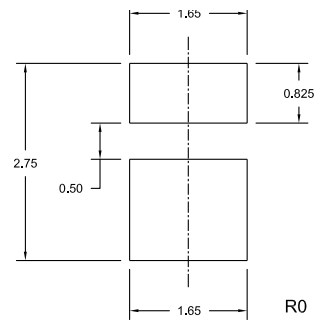

For standard mounting refer
to TLM322 Package Details

LEAD CODE:

- 1) Cathode
- 2) Anode
- 3) Anode

MARKING CODE: CBA

R4 (19-February 2010)