

# Slide Switches

## SMT Slide Switches with LED Illumination

## SB54 Series

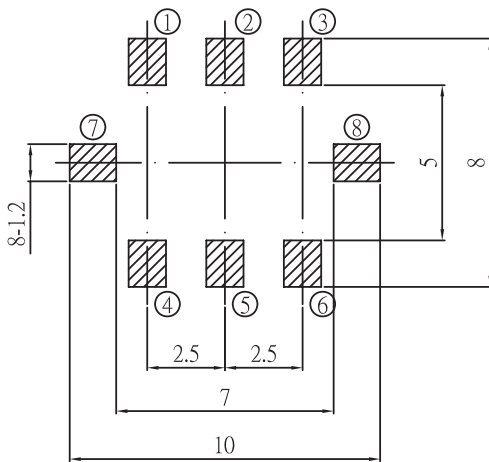
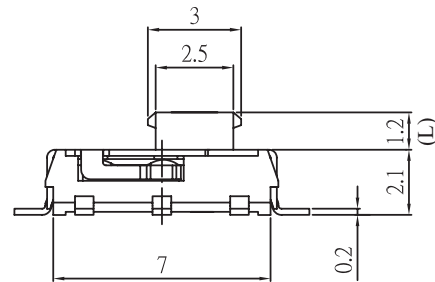
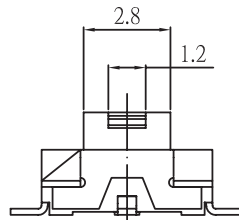
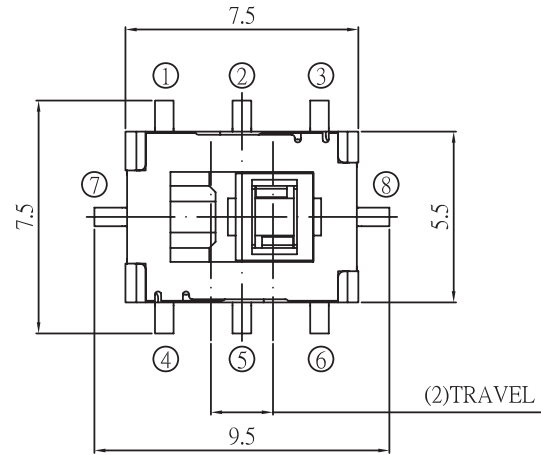
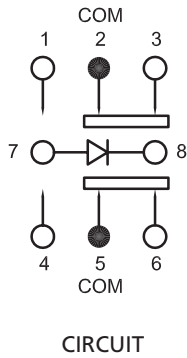

P.C.B. LAYOUT

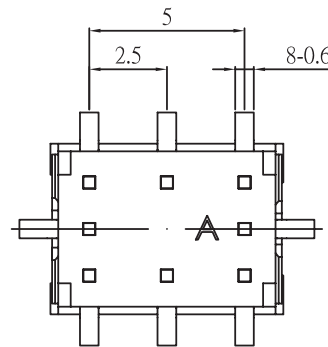

DIMENSION	TOLERANCE
BELOW 10 mm	± 0.3
10-100 mm	± 0.5
ABOVE 100 mm	± 0.8
ANGLE	± 3°

### How to order:

SB54

**1 TERMINATION:**  
M SMT

**4 TIMING:**  
N Non-Shorting

**7 ACTUATOR TYPE:**  
S L = 1.2 mm (Standard)

**9 COLOR OF LED:**  
N Without LED

**2 POLE:**  
D 2 Poles

**5 FRAME:**  
S Standard Type

**8 BRIGHTNESS LED:**  
N Without LED  
S Ultra Bright (Standard)

G Blue  
F Green  
C Red  
B White  
E Yellow

**3 POSITION:**  
2 2 Positions

**6 ACTUATOR MATERIAL:**  
6 PA6T

### General Specifications:

- > Poles: 3P2T
- > Actuating: Slide Switch Momentary
- > Contact Rating: 0.3A 6VDC
- > Contact Resistance: 50 mohm Max.
- > Insulation Resistance: 100 Mohm Min. at 500VDC
- > Dielectric Strength: 500 VAC for 1 Minute
- > Operating Force: 200 gf
- > Operating Live: 10,000 Cycles
- > Operating Temperature: -20°C to +70°C
- > Total Travel: 2.0mm +/- 0.2mm